



General Safety Information

⚠ WARNING – To avoid serious injuries:

- Obtain and read the service instructions carefully prior to installing the parts. Loose, worn, or damaged parts may cause serious injury to the rider. We strongly recommend only using genuine Shimano replacement parts.
- Read these Technical Service Instructions carefully, and keep them in a safe place for later reference.

⚠ CAUTION – To avoid serious injuries:

- Be sure to shift the lever one gear at a time, and reduce the force being applied to the pedals during shifting. If you try to force operation of the shifting lever while the pedals are being turned strongly, your feet may come off the pedals and the bicycle may topple over, which could result in serious injury.
- Never place your foot on the bell crank. Doing so may cause problems with gear shifting.

NOTE:

- For maximum performance we highly recommend Shimano lubricants and maintenance products.
- Parts are not guaranteed against natural wear or deterioration resulting from normal use.

Shifting lever operation

After you release your finger from lever A / button B once shifting is complete, the lever or button will always return to its original position.

- ⚠ Starting/Riding on sandy or rough road surfaces/
Riding up slopes/Carrying heavy loads/
Riding into head winds/When the light is illuminated
- ⚠ Riding on flat road surfaces
- ⚠ Riding at high speeds

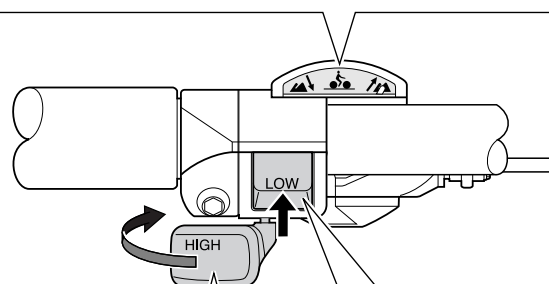

Lever A:
Pedaling becomes
heavier.
(Indicator moves
toward ⚠)

Button B:
Pedaling becomes
lighter.
(Indicator moves
toward ⚠)

SI-6JL0A

ST-C530
SM-BC05

Shifting Lever

Bell Crank

Technical Service Instructions

SHIMANO
NEXAVE
C530

Be sure to read these service instructions in conjunction with the service instructions for the Inter-3 freehub before use.

Installation of the shifting lever

Use a 5 mm Allen key to install the shifting lever.

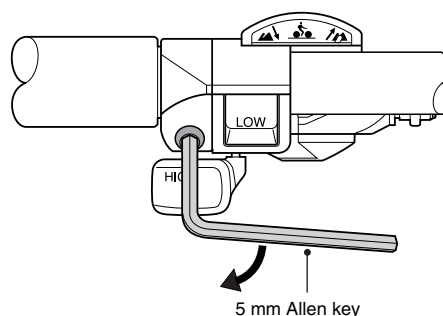



Tightening torque:
6 – 8 N·m {60 – 80 kgf·cm}

Installation of the shifting cable

Use a cable with one inner cable drum as the shifting cable.

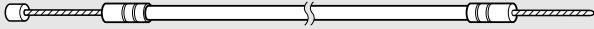
SIS-SP40 (4 mm dia.)



1. Set the shifting lever to .

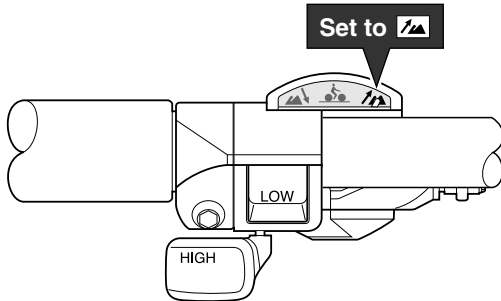

Shifting lever side

2. Use a Phillips screwdriver to remove the wire end hooking cover.

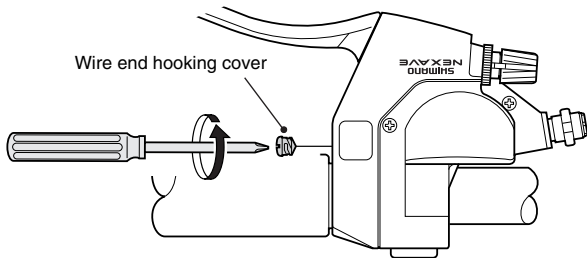

3. Pass the inner cable through the wire end hooking hole. Note that the route of the inner cable makes a bend inside the shifting lever at this time. After this, insert the outer casing into the cable adjusting bolt.

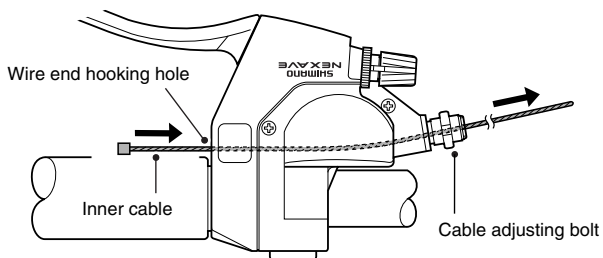

4. Use a Phillips screwdriver to install the wire end hooking cover. Be careful not to tighten the wire end hooking cover too firmly at this time. If it is tightened too firmly, the thread may be damaged.

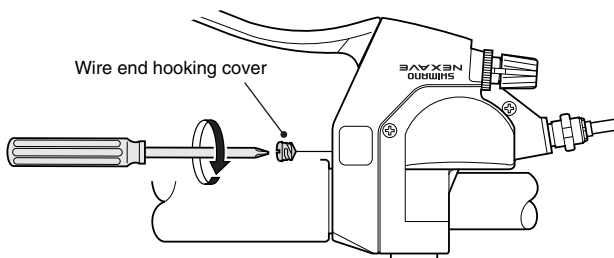

Tightening torque:
0.3 – 0.5 N·m {3 – 5 kgf·cm}

Bell crank side

5. Loosen the cover fixing screw, and then remove the bell crank cover.

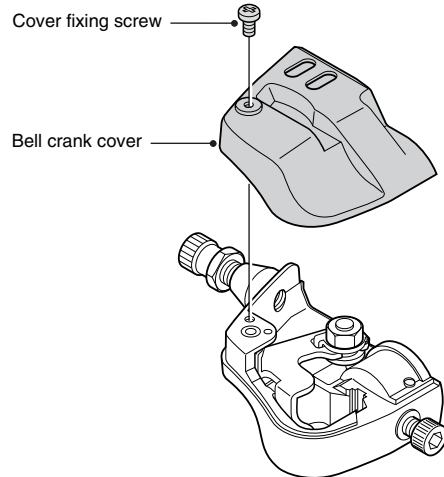

6. Set the inner cable into the link of the main bell crank unit.

- 1) Loosen the inner cable fixing nut on the main bell crank unit. Next, pass the inner cable through the cable adjusting bolt and then place it in between the link and the inner cable fixing plate.

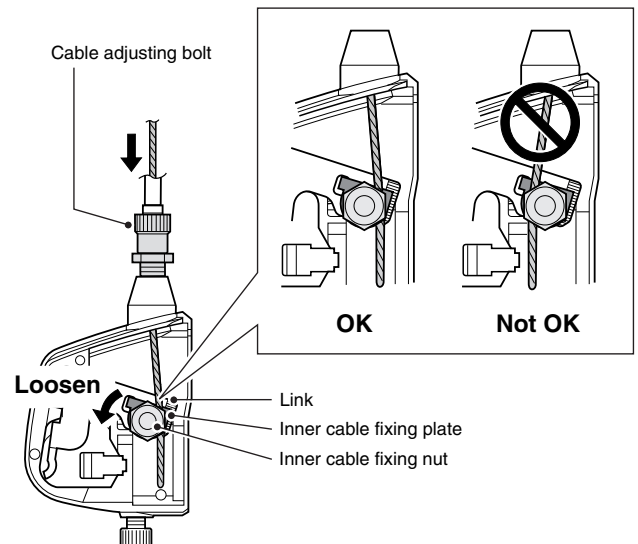

- 2) Set the shifting lever to .
Next, pull the inner cable so that the edges of the link on the main bell crank unit are between the two white lines on the window, and then tighten the inner cable fixing nut at that position.

Tightening torque:
4 – 6 N·m {40 – 60 kgf·cm}

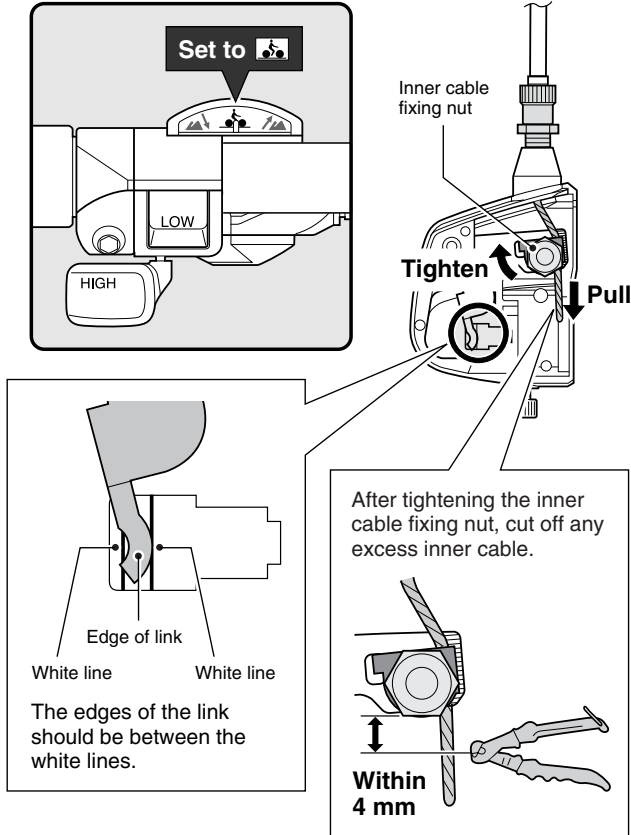

2. While pushing the main bell crank unit onto the hub axle, align the serrations inside the main bell crank unit with the hub nut, and then push the main bell crank unit on until it touches the end of the hub axle. In this position, tighten the main unit installation bolt onto the hub axle.

Tightening torque:
3 – 5 N·m {30 – 50 kgf·cm}

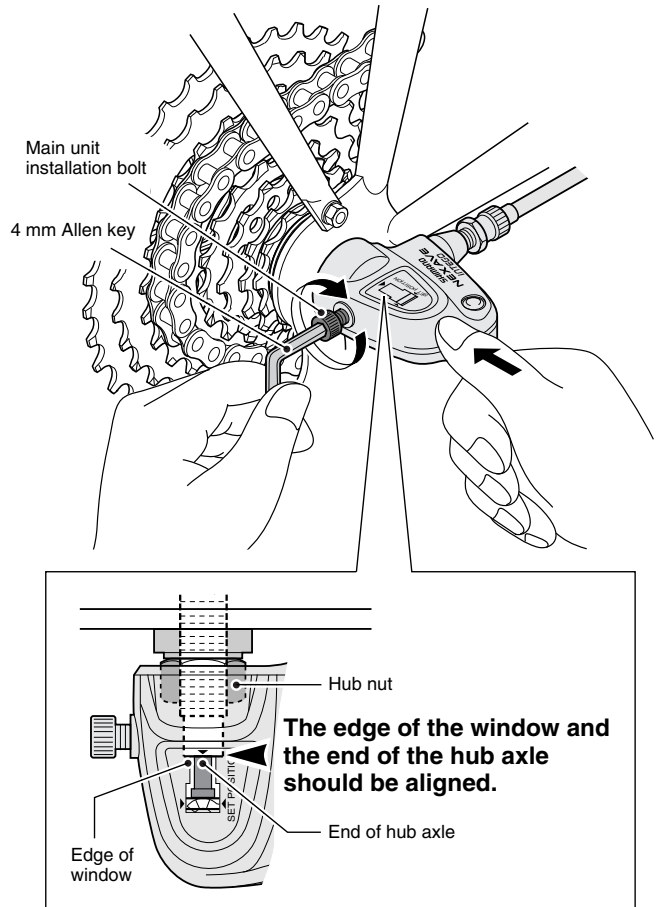

7. Replace the bell crank cover and tighten the cover fixing screw.

Installation of bell crank

1. Insert the push rod into the hub axle.

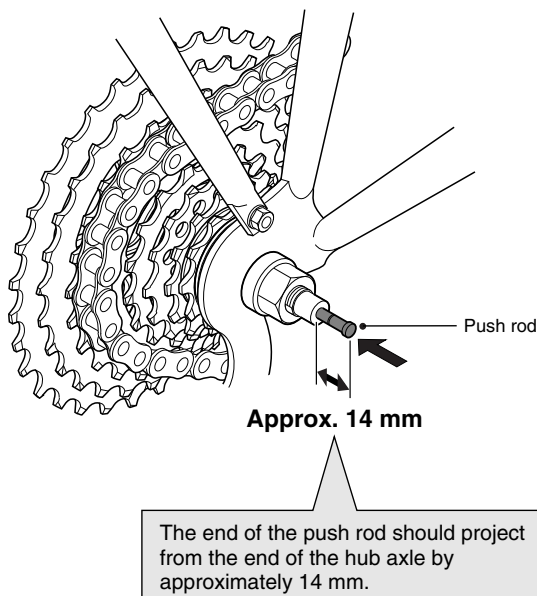

Adjusting bell crank

1. Set the shifting lever to . Next, turn the cable adjusting bolt until the red line on the push rod is aligned with the end of the hub axle.

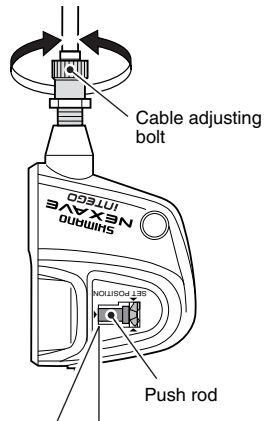
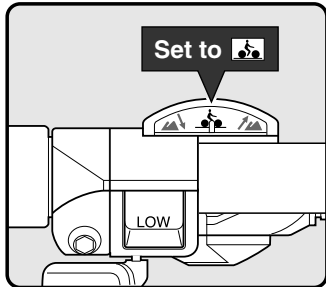

The red line on the push rod and the end of the hub axle should be aligned.

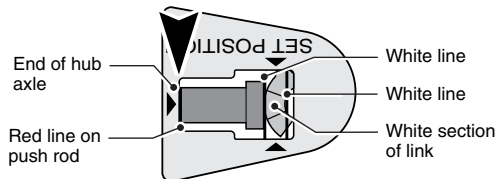

If the red line on the push rod is not visible, adjust so that the white section of the link is between the two white lines on the window.

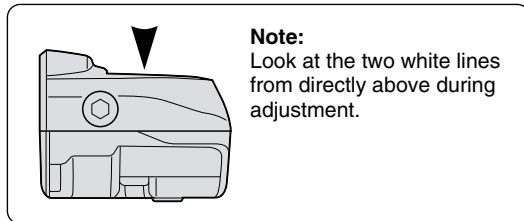

2. While turning the crank arm, move the shifting lever from to and then from back to two or three times to check the gear shifting. Set the shifting lever back to and check that the red line on the push rod is aligned with the end of the hub axle.

If they are not aligned, turn the cable adjusting bolt to make fine adjustments.

3. After adjusting the bell crank, tighten the cable adjusting nut to secure the cable adjusting bolt.

Cable adjusting nut

Tightening torque:
1.5 – 2.5 N·m {15 – 25 kgf·cm}

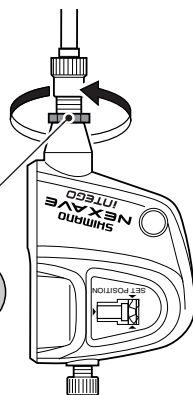

Securing the shifting cable to the frame

Secure the cable to the frame with the outer casing bands.

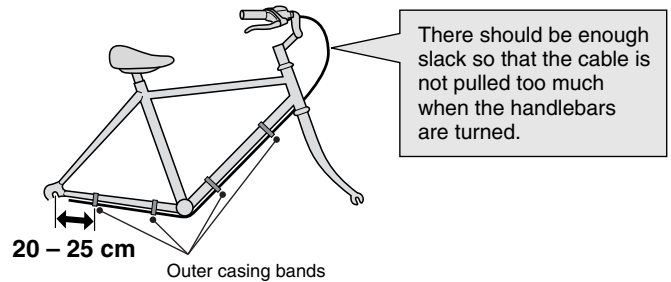

These service instructions explain how to use and maintain the Shimano bicycle parts which have been used on your new bicycle. For any questions regarding your bicycle or other matters which are not related to Shimano parts, please contact the place of purchase or the bicycle manufacturer.

These service instructions are printed on recycled paper.

Please note: Specifications are subject to change for improvement without notice. (English)

SHIMANO®

SHIMANO AMERICAN CORPORATION

One Holland, Irvine, California 92618, U.S.A. Phone: +1-949-951-5003

SHIMANO EUROPE HOLDING B.V.

Industrieweg 24, 8071 CT Nunspeet, The Netherlands Phone: +31-341-272222

SHIMANO INC.

3-77 Oimatsu-cho, Sakai, Osaka 590-8577, Japan

© Sep. 2003 by Shimano Inc. PIT. SZK. Printed in Japan

