



SI-78C0C

# HP-5500 HP-5501

Head Parts

## SERVICE INSTRUCTIONS

Before use, read these instructions carefully, and follow them for correct use.

### ■ Assembly dimensions

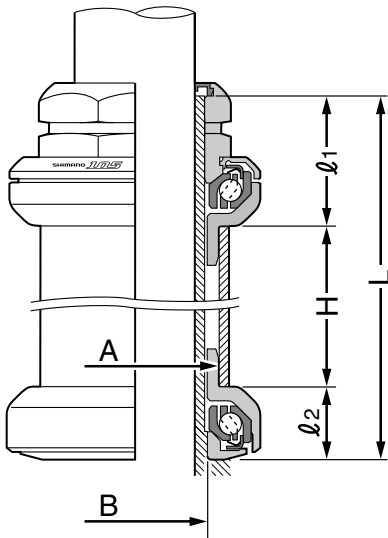
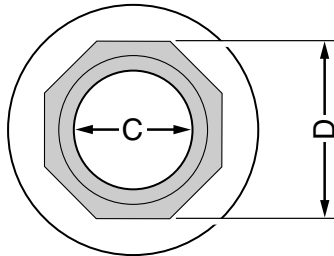

JIS: Japanese Industrial Standards H: Head tube length

Thread dimensions	Lock washer	A	B	C	D	l <sub>1</sub>	l <sub>2</sub>	L
B.C.1" × 24T		φ 30.0 mm (JIS)	φ 27.0 mm (JIS)	φ 22.3 mm	32.0 mm	24.1 mm	13.5 mm	H + 37.6 mm
		φ 30.2 mm	φ 26.4 mm φ 27.0 mm					

## Assembly notes

Lock nut with stem seal

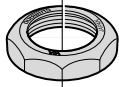

Lock washer

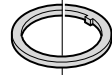

Upper head cone housing

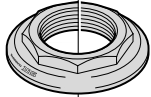

**Be careful of the setting direction.**

Cartridge type bearing

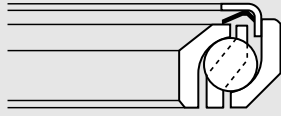
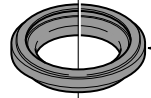

Upper head cup housing

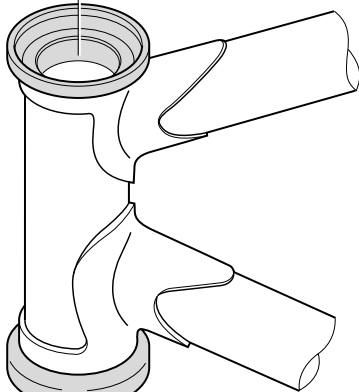

Lower head cup housing



Cartridge type bearing

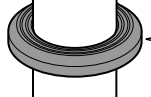

**Be careful of the setting direction.**

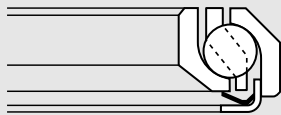

Lower head cone housing

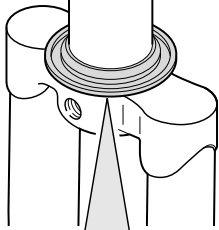

Use the press-fitting tool (sold separately) to install the lower head cone housing.

**TL-HP50 (1")**



These service instructions are printed on recycled paper.  
Please note: Specifications are subject to change for improvement without notice. (English)

**SHIMANO AMERICAN CORPORATION**

One Holland Irvine CA 92618 U.S.A. Phone 949-951-5003

**SHIMANO EUROPA**

Industrieweg 24 NL-8071 CT Nunspeet, Holland Phone 31-341-272222

**SHIMANO INC.**

3-77 Oimatsucho, Sakai, Osaka, Japan Phone 072-223-3243

© Jan. 2002 by Shimano Inc. PIT. IZM. Printed in Japan

