

# SL-RS41-7T SL-RS31-7T

## REVO SHIFT (Shifting lever)

Before use, read these instructions carefully, and follow them for correct use.

### ⚠ WARNING

- Use neutral detergent to clean the chain. Do not use alkali-based or acid based detergent such as rust cleaners as it may result in damage and/or failure of the chain.
- Use the reinforced connecting pin only for connecting the narrow type of chain.
- There are two different types of reinforced connecting pin available. Be sure to check the table below before selecting which pin to use. If connecting pins other than reinforced connecting pins are used, or if a reinforced connecting pin or tool which is not suitable for the type of chain is used, sufficient connection force may not be obtained, which could cause the chain to break or fall off.

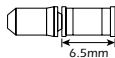
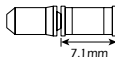
Chain	Reinforced connecting pin	Chain tool
9-speed super narrow chain such as CN-7701 / CN-HG93	 Silver 6.5mm	TL-CN31/TL-CN22
8- / 7- / 6-speed narrow chain such as CN-HG50 / CN-IG51	 Black 7.1mm	TL-CN31/TL-CN22 and TL-CN30/TL-CN21

- If it is necessary to adjust the length of the chain due to a change in the number of sprocket teeth, make the cut at some other place than the place where the chain has been joined using a reinforced connecting pin or an end pin. The chain will be damaged if it is cut at a place where it has been joined with a reinforced connecting pin or an end pin.

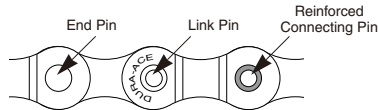

- Obtain, read and carefully service instructions when installing parts. A loose, worn, or damaged parts may cause injury to the rider. We strongly recommend that only genuine Shimano replacement parts be used.

### Note

- Adjust the RD-C050, C030 Rapid Rise rear derailleur (reverse spring type) from the low side.
- Because the high cable resistance of a frame with internal cable routing would impair the SIS function, this type of frame should not be used.
- Use an outer casing which still has some length to spare even when the handlebars are turned all the way to both sides. Furthermore, check that the shifting lever does not touch the bicycle frame when the handlebars are turned all the way.
- Grease the inner cable and the inside of the outer casing before use to ensure that they slide properly.
- For smooth operation, use the specified outer casing and bottom bracket cable guide.
- Operation of the levers related to gear shifting should be made only when the front chainwheel is turning.
- Read these Service Instructions together with the Front Drive System Service Instructions.
- The ID-C050 gear indicator, SC-C050 speedmeter, SC-C051 odometer and SC-C052 clock and stopwatch are available as separate items. Please ask your bicycle dealer for further details.
- For maximum performance we highly recommend Shimano lubricants and maintenance products.
- For any questions regarding methods of installation, adjustment, maintenance or operation, please contact a professional bicycle dealer.

In order to realize the best performance, we recommend that the following combination be used.

Series	C050	
CI DECK	ID-C050-7R	
Gears	Right	SIS 7-gears
REVO SHIFT	SL-RS41-7T / SL-RS31-7T	
Outer casing	SIS	
Rear derailleur	RD-C050 / RD-C030	
Type	Smart cage	
Freewheel	MF-ZH37 / MF-HG50-7	
Chain	CN-HG50 / CN-UG50	
Bottom bracket cable guide	SM-SP18 / SM-BT18	

## Specifications

### Rear Derailleur

Model number	RD-C050	RD-C030
Type	Smart cage	Smart cage
Total capacity	43T	43T
Largest sprocket	34T	34T
Smallest sprocket	11T	11T
Front chainwheel tooth difference	20T	20T

### Freewheel tooth configurations

Model number	Gears	Group name	Tooth combination
MF-HG50-7	7	by	11, 13, 15, 18, 21, 24, 34T
MF-ZH37	7	cy	13, 15, 17, 19, 21, 24, 34T

### CI-DECK

Model number	Shift lever	Rear derailleur	Use
ID-C050-7R	SL-RS41-7T / SL-RS31-7T	Rapid Rise	Rear 7-gears

## Mounting the shifting lever

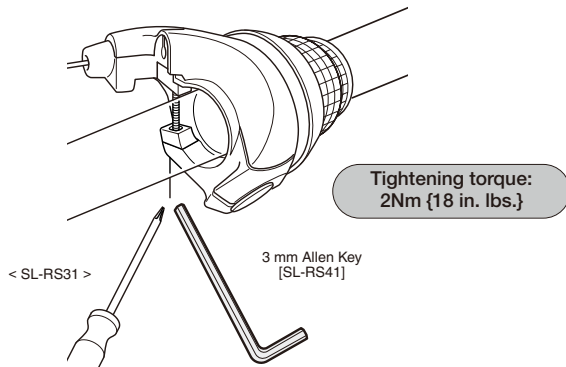

Install the brake lever in a position where it will not obstruct brake operation. Do not use in a combination which causes brake operation to be obstructed.

## Gear shifting operation

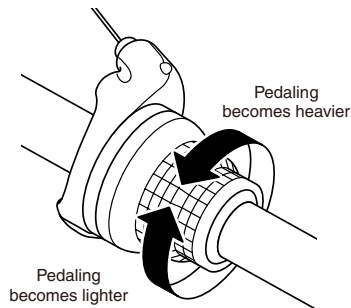

## Installation of the rear derailleur

### Direct-mount type

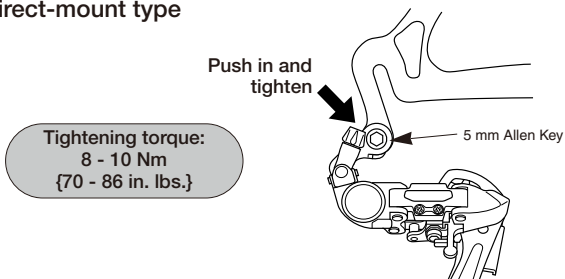

### Bracket type

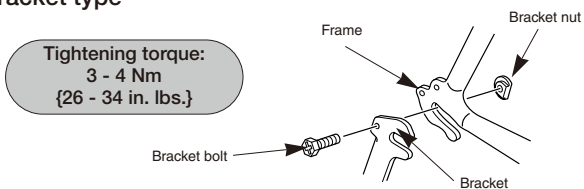

## Chain length

Add 2 links (with the chain on both the largest sprocket and the largest chainring)

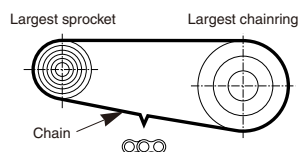

## Installation of the chain

1. Install the chain with the Pro-Set alignment block still attached. After installing, remove the Pro-Set alignment block.

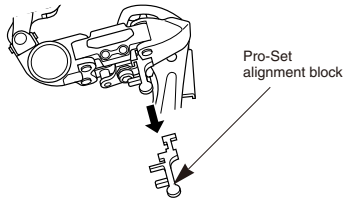

2. Turn the crank arm to set the derailleur to the low position.

### Checking the chain connection

For chains, insert the chain gauge (TL-CN24) into the inner link which is next to the chain connecting pin to check that the inner link width is correct.

Check that the connecting pin protrudes past the outer link by the same amount on both sides, and that the amount of protrusion is 0.2 mm or more.

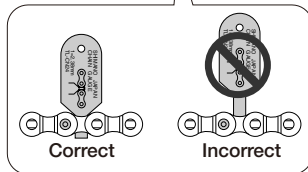
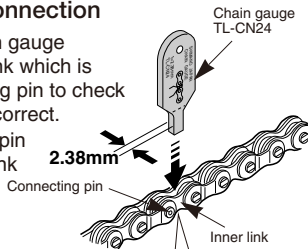

$A, B \geq 0.2\text{mm}$

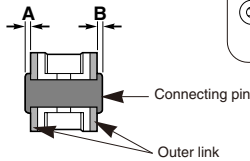

## Adjustment

### 1. Low adjustment

Turn the low adjustment screw so that the guide pulley moves to a position directly in line with the largest sprocket.

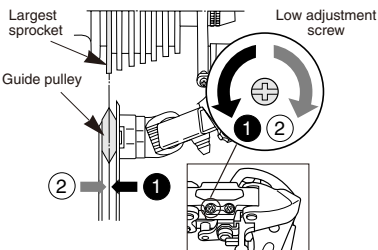

### 2. Top adjustment

Turn the crank arm while pulling the derailleur with your hand to move the derailleur to the top position, and then turn the top adjustment screw to adjust so that the guide pulley is in line with the outer line of the smallest sprocket when looking from the rear.

Turn the crank arm to set the derailleur to the low position.

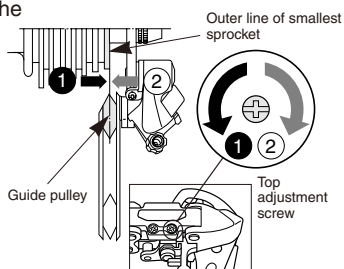

### 3. Securing the outer cable and inner cable

#### Inserting the inner cable

Insert the inner cable into the outer casing from the end with the marking on it. Apply grease from the end with the marking in order to maintain cable operating efficiency.



#### < RD-C050 >

Place the outer casing so that it does not touch the basket and mudguard, otherwise it may cause a problem with the performance of the derailleur.

Set the outer casing so that its length is as follows.

#### • If routing the casing upward:

(The chain should be on the largest chainring and on the largest sprocket.)

Add 10 mm to the length of the outer casing from the end that is inserted into the outer casing holder to the end which is inserted into the link.

#### Chain position

Largest sprocket Largest chainring

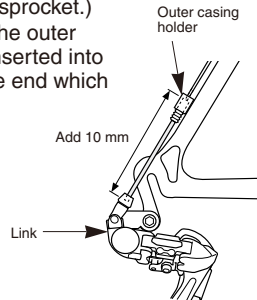
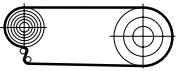

#### • If routing the casing downward:

(The chain should be on the largest chainring and on the largest sprocket.)

Set the length of the outer casing so that it describes a smooth arc, and so that the link stops in a position where there is a small gap between the link and the link stop.

#### Chain position

Largest sprocket Largest chainring

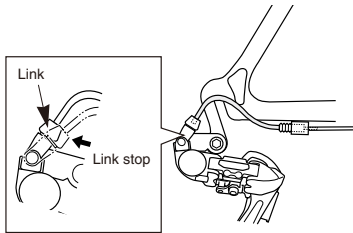
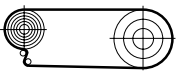

Connect the inner cable to the derailleur as shown in the illustration.

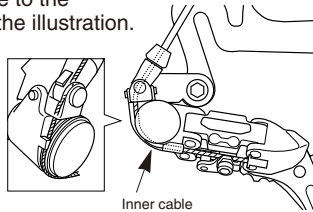

#### Cutting the outer casing

When cutting the outer casing, cut the opposite end to the end with the marking. After cutting the outer casing, make the end round so that the inside of the hole has a uniform diameter.



Attach the same outer end cap to the cut end of the outer casing.

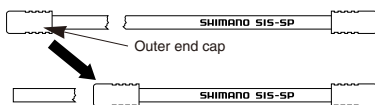

**Note:**

Be sure that the cable is securely in the groove.

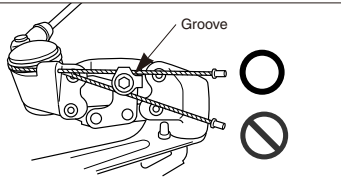

Connect the cable to the rear derailleur and, after taking up the initial slack in the cable, re-secure to the rear derailleur as shown in the illustration.

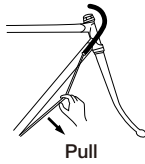

**Tightening torque:**  
5 - 7 Nm {44 - 60 in. lbs.}

#### 4. SIS adjustment

Operate the Revoshift while turning the crank arm to move the derailleur to the largest sprocket. Then operate the Revoshift once to move the derailleur to the 2nd-gear sprocket. After this, operate the Revoshift just as far as the extent of play, and then turn the crank arm.

When changing to 3rd 2 3 	When no noise is heard at all 2 3 
 adjustment bolt Turn the cable adjustment bolt clockwise to tighten it until the chain returns to the 2nd sprocket.	 adjustment bolt Turn the cable adjustment bolt counterclockwise to loosen it until the chain touches a sprocket and generates noise.

#### Best setting

The best setting is when the cable adjustment bolt is tightened (turned clockwise) until noise occurs without the Revoshift being operated, and then loosened (turned counterclockwise) 90 - 180 degrees from that point.

Operate the Revoshift to change gears, and check that no noise occurs in any of the gear positions.

For the best SIS performance, periodically lubricate all power-transmission parts.

### Installation of the freewheel

To install

To disassemble

**Tightening torque:**  
30 Nm {260 in. lbs.}

Freewheel removal tool  
TL-FW30

## Replacing the inner cable

Replace the inner cable by carrying out steps ① to ③ as shown in the illustrations.

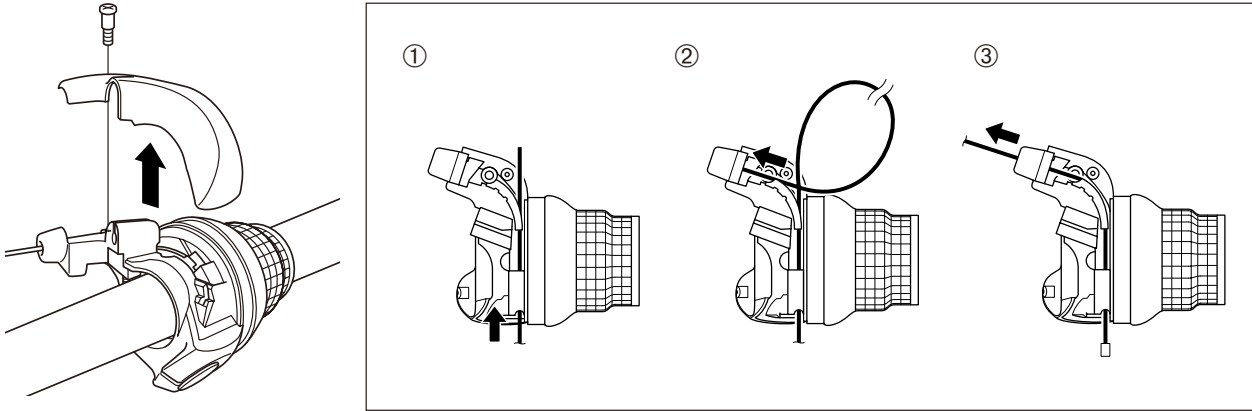

## Installation of the switch

Remove the switch cap and install the switch as shown in the illustration.

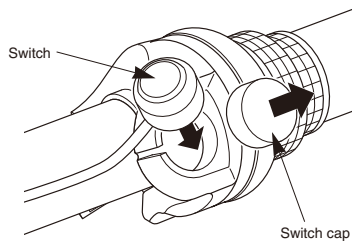

This service instruction explains how to use and maintain the Shimano bicycle parts which have been used on your new bicycle. For any questions regarding your bicycle or other matters which are not related to Shimano parts, please contact the place of purchase or the bicycle manufacturer.

# SHIMANO®

**SHIMANO AMERICAN CORPORATION**

One Holland Irvine CA 92618 U.S.A. Phone 949-951-5003

**SHIMANO EUROPA**

Industrieweg 24 NL-8071 CT Nunspeet Holland Phone 31-341-272222

**SHIMANO INC.**

77 Oimatsu-cho 3-cho Sakai Osaka 590-8577 Japan

Please note: specifications are subject to change for improvement without notice. (English)  
©Sep. 2001 by Shimano Inc. XBC SZK Printed in Malaysia

