



Death to Invaders

DEATH TO INVADERS

Marzocchi Suspension Products 2006

Marzocchi





We Ride ★

IT'S OUR PASSION. At Marzocchi, our products are built for riders by riders. Testing doesn't end with R&D. Everyone at Marzocchi loves to ride. We're givin'er every time we can hop on our mountain bikes or motorcycles. We stand by our premium suspension because we all know first hand how well it works. With rider input from our top athletes and our Marzocchi employees, we're able to deliver a range of suspension products that fit all types of riders at any skill level.

BOTTOM LINE, as riders It's our passion and our purpose to give you the finest suspension products for your bike or motorcycle.





It's time to choose sides. There's a line
in the dirt and now it's up to you
to decide. Some will claim,
but few have a heritage like ours.

Marzocchi's been throwing down
since we first came on the scene with
the Bomber line. It was brave new
thinking for suspension. More travel
and durability were new concepts back
in the early 1990's. We were killing
it with Wade, Richie, Tippie, and the
other legends at the helm. They laid
the foundation, and together with
our current batch of Soulrider's, we
continue to build on that tradition.

2006 is where we draw the line. With
over 27 different models, there's a
Marzocchi that's right for you.
Go with the original. Ride Marzocchi.



MARZOCCHI
SUSPENSION PRODUCTS 2006

DEATH TO INVADERS

OUR CREW OF RIDERS REPRESENTS SOME OF THE BEST RIDERS IN MOUNTAIN BIKING. WE SUPPORT OUR PROFESSIONAL ATHLETES IN EVERY DISCIPLINE OF RIDING, SUCH AS FREERIDING, DIRT JUMPING, DOWNHILL RACING, URBAN PARK RIDING, MARATHON RACING AND EVEN RIDING TRIALS. ALL OF THESE RIDERS HAVE TWO THINGS IN COMMON, A LOVE FOR THE SPORT AND MARZOCCHI SUSPENSION. WE HAVE SUPPORTED THE MOUNTAIN BIKING SCENE SINCE THE BEGINNING. OUR QUALITY SUSPENSION SHOWS A COMMITMENT TO THE SOULRIDERS AS WELL AS ANY RIDER WHO WANTS THE BEST IN MOUNTAIN BIKING SUSPENSION.



BOURDON



JOHN



RICHIE



THOMAS



WADE



RYAN

SOUL RIDERS



DARIN



GABETH



SHAUNS



PAUL



FAB'EN



RANDY



REDON



DAVE



WHAT KIND OF RIDER ARE YOU?

Riding along hilly trails where some bumps and smaller obstacles, such as rocks, roots or depressions, may be encountered.

Riding basing more emphasis on XC riding and larger obstacles and smaller jumps.

For use on paved, gravel and dirt roads, along with some hilly trails where some bumps and smaller obstacles, such as rocks, roots or depressions, may be encountered.

This riding style is for skilled riders and involves aggressive slopes, large obstacles and moderate jumps.

This "BMX" or "motocross" style riding is only for the most skilled riders and involves jumping from one mound of dirt to another. It also includes riding over and around "urban obstacles" such as man-made or other concrete structures.

This discipline is only for professional or highly skilled riders. It includes for relatively high jumps or "drops" and negotiating larger obstacles such as boulders, fallen trees or holes.

XC

AM

TK

FR

DT

DH
FRX

FORKS SHOULD BE USED ONLY WITH PROPER BRAKES, AS WELL AS FRAMES, WHEELS AND OTHER COMPONENTS SPECIFICALLY DESIGNED FOR THE RIDING STYLE. THE BRAKES MUST BE ATTACHED TO THE DESIGNATED MOUNTING POINTS PROVIDED ON THE FORK. NEVER MAKE ANY MODIFICATION TO YOUR FORK TO ATTACH ANY EQUIPMENT.

DON'T BE A FORK ABUSER! Marzocchi suspension forks are among the most durable and technologically advanced forks on the market today. However, no fork can withstand misuse, abuse or improper use that can cause the forks to fail.

It is critical that you equip your frame with a fork that is appropriate for the frames' anticipated riding style. Please see Marzocchi's Intended Use Chart which identifies the correct forks for various riding styles.

Failure to properly match the forks to your frames could cause the forks to fail, resulting in a loss of bicycle control and, possibly, serious injury to the rider. In addition, an improper match will void your forks' warranty. Choose wisely!

FORK NAME	XC	AM	TK	FR	DJ	DH	FRX
MARATHON RACE	•						
MARATHON SL	•						
MARATHON XC	•						
MX PRO RACE	•						
MX PRO SL	•						
MX PRO ETA & TAS	•						
MX COMP	•						
MX COMP ETA	•						
GRAN FONDO 3	•						
TXC 1			•				
TXC 2			•				
TXC ECC			•				
ALL MOUNATIN SL		•					
ALL MOUNTAIN 1		•					
ALL MOUNTAIN 2		•					
ALL MOUNTAIN 3		•					
AM 3		•					
Z.1 FR SL				•			
Z.1 LIGHT				•			
Z.1 SPORT				•			
Z.1 SPORT ETA				•			
DROP OFF 3				•			
DROP OFF 4				•			
66 SL							•
66 RC2X							•
66 LIGHT ETA							•
66 VF2							•
D-STREET 24"					•		
DIRT JUMPER 1					•		
DIRT JUMPER 2					•		
DIRT JUMPER 3					•		
DIRT JUMPER 3 STD					•		
DIRT JAM PRO					•		
888 RC2X						•	•
888 VF2						•	•
JUNIOR T						•	
MONSTER T						•	



FORK TECH



MARZOCCHI'S OPEN BATH DAMPING

Marzocchi's legendary Open Bath Design dates to even before Marzocchi's inception in 1949 when the original Marzocchi brothers insisted that their Ducati suspension designs only utilize Open Bath Systems. Over the years, we've fine-tuned our proven Open Bath Technology, delivering consistent high-end performance that's become the benchmark for mountain bike suspension.

MAGNESIUM MONOLITE CASTING

Other than the DJ Street 24" model, all Marzocchi fork models use a magnesium monolite lower casting. We use a low-rise arch design (lowest arch span among our competitors) that offers the greatest amount of stiffness/strength. We've also infused our Italian-style into the design for an incredible aesthetic to the fork. In addition, we've put a post mount for your disc brake system for solid stopping power.



ALL NEW RC2 DAMPING

The new RC2 damping gives the rider increased trail tunability. It features two separate compression adjustments to tune both position and speed sensitivity. Position sensitive compression can be tuned to give the rider anti-dive tuning. The speed sensitive compression valve gives the rider complete control for bigger drops and hard landings. It allows the rider to tune their fork for all conditions.

ALL NEW VF2 DAMPING

Our new VF2 damping offers even more tunability than last year. It is both an external compression adjustment and an external rebound adjuster. The externally adjustable VF2 valves are spring loaded and gives the rider total control, even in the worst conditions. These can be found in 888, 66VF2, Dirt Jumper and All Mountain series forks.

RIDER TECH



ETA Extension Travel Adjustment

As you climb, simply flick a switch and the suspension will compress to the ideal height (depending on the riders weight). However, unlike a lockout mechanism, you'll still have 30mm of travel to soak up some of the rough stuff.

Available on select models in the following fork lines:
Marathon, MX, Z.1, All Mountain, and the 66.



TAS Travel Adjust System

You now have 20mm of travel adjustment your fingertips. It's that easy. Unlike ETA, this function is solely for the rider to dial in the initial travel set-up for overall ride height or balancing out the rear.

Available on select models in the following fork lines:
Marathon, MX, Z.1, All Mountain, and the 66.



TST Terrain Selection Technology

Adjust your damping according to the conditions of the trail. There are five settings specially suited for climbing, all mountain, and descending. On the trail, simply turn the dial to the corresponding trail type and you're on your way.

Available on select models in the following fork lines:
Marathon and All Mountain

We vigorously test all of our rider tech before it goes on a Marzocchi product. These aren't just gimmicks. They're trail tested features that can improve your ride and give you a custom feel that's uniquely Marzocchi.



Marathon Series

Marathon Race



- 80mm Travel (Dedicated Cartridge)
- Dual Hydraulic Compression & Rebound Damping
- Open Bath Lubrication
- External Positive & Negative Air Preload
- 5-Position TST Bladder System For Compression & Lock-Up
- External Rebound Adjuster (Bottom)
- Progressive Air Bottom Out
- Doppio Air System (Positive/Negative)
- New for 2006 CNC'd Superlight Marathon Crown Holes For Lighter Weight
- New for 2006 Magnesium Marathon Monolite One Piece Arch & Sliders
- Shorter w/ Spacers
- ø30mm Alloy Tapered Tubes
- Alloy XC Steer Tube
- Disc Brake Post Mount
- Standard Drop-Outs
- Remote TST Control (5 Positions)



Gretchen Reeves

Marathon racers demand a light, functional fork that's built to last. The Marzocchi Marathon is the ideal suspension product. It provides durable, smooth operation mile after mile. The Marathon series features our own terrain selection technology which gives you 5 modes from climbing to descending to control your damping. We've trail-tested the Marathon on the most grueling courses including the infamous Trans Alps challenge. Our results speak for themselves, just ask a few of our champions.

Marathon SL



- 100mm to 120mm Travel (One Cartridge w/ Different Pressure on Negative Chamber)
- Dual Hydraulic Compression & Rebound Damping
- Open Bath Lubrication
- External Positive & Negative Air Preload (Doppio Air)
- 5-Position TST Bladder System For Compression & Lock-Up
- External Rebound Adjuster (Bottom)
- Progressive Air Bottom Out
- Air Preload (Bottom)
- New Redesigned Doppio Air System (Positive/Negative)
- New for 2006 CNC'd Superlight Marathon Crown Holes For Lighter Weight
- New for 2006 Magnesium Marathon Monolite One Piece Arch & Sliders
- ø30mm Alloy Tapered Tubes
- Alloy XC Steer Tube
- Disc Brake Post Mount
- Standard Drop-Outs
- Optional Feature:
- Remote TST Control (5 Positions)



Marathon XC



- 100mm to 120mm Travel
- Travel Adjustment System
- Dual Hydraulic Compression & Rebound Damping
- Open Bath Lubrication
- External Air Preload
- 5-Position TST Bladder System For Compression & Lock-Up
- External Rebound Adjuster (Multi-Click Bottom)
- Extension Travel
- Adjustment ETA (Top)
- TAS From 100 to 120mm (Bottom)
- One Side: Air (TST)
- One Side: Coil (ETA & TAS)
- New for 2006 Superlight Marathon Crown Holes for Lighter Weight
- New For 2006 Magnesium Marathon Monolite One Piece Arch & Sliders
- ø30mm Alloy Tapered Tubes
- Alloy XC Steer Tube
- Disc Brake Post Mount
- Standard Drop-Outs
- Optional Feature:
- Remote TST Control (5 Positions)

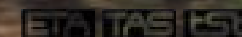



When it comes to the MX series, it's all about versatility. We saw the need to create a fork with an aggressive XC damping with a lightweight feel. The MX delivers consistent, predictable handling under various trail conditions.



MX PRO RACE

- 85mm Travel (Dedicated)
- One Side: SSV Damping System (Plastic)
- One Side: Long Negative Coil Spring
- External Air Preload w/o Adapter
- Single External Rebound Adjuster
- Air
- New for 2006 Superlight Marathon Crown
- New for 2006 Magnesium Marathon Monolite One Piece Arch & Sliders
- ø30mm Alloy Stanchions
- Tapered tubes
- Alloy XC Steer Tube
- Disc Brake Post Mount
- Standard Drop-Outs

ETA TAS



MX COMP

- 85mm or 105mm Travel
- One Side: SSV Damping System
- One Side: Long Negative Coil Spring
- External Air Preload w/o Adapter
- Internal Rebound Adjuster
- Air
- New for 2006 Superlight Marathon Crown
- New for 2006 Magnesium Marathon Monolite One Piece Arch & Sliders
- ø30mm Alloy Stanchions
- Steel Steer Tube
- Disc Brake Post Mount
- Standard Drop-Outs



MX COMP ETA

- 105mm or 120mm Travel
- One Side: SSV Damping System
- One Side: ETA
- External Air Preload w/o Adapter
- Internal Rebound Adjuster
- Air
- New for 2006 Superlight Marathon Crown
- New for 2006 Magnesium Marathon Monolite One Piece Arch & Sliders
- ø30mm Alloy Stanchions
- Alloy XC Steer Tube
- Disc Brake Post Mount
- Standard Drop-Outs

ETA TAS



MX PRO SL

- 105mm Travel
- One Side: Hydraulic Compression & Rebound Damping
- One Side: Long Negative Coil Spring
- External Air Preload w/o Adaptor
- 5-Position TST Bladder System for Compression & Lock-Up
- External Rebound Adjuster (Bottom)
- Air
- NEW for 2006 Superlight Marathon Crown
- NEW for 2006 Magnesium Marathon Monolite One Piece Arch & Sliders
- ø30mm Alloy Stanchions
- Tapered Tubes
- Alloy XC Steer Tube
- Disc Brake Post Mount
- Standard Drop-Outs

Optional Feature:

- Remote TST Control - 5 Positions

tst



MX PRO ETA & TAS

- 105mm to 120mm Travel
- One Side: SSV Damping System (Plastic)
- One Side: ETA & TAS
- 100mm to 120mm
- External Air Preload w/o Adapter
- Single External Rebound Adjuster
- Air
- New for 2006 Superlight Marathon Crown
- New for 2006 Magnesium Marathon Monolite One Piece Arch & Sliders
- ø30mm Alloy Stanchions
- Alloy XC Steer Tube
- Disc Brake Post Mount
- Standard Drop-Outs

ETA TAS



Gran FONDO TXC SERIES

This is the fork for both trail versatility and excellent value. It's an honest hard working fork that will give you consistent performance mile after mile. With Italian style and Marzocchi quality, this is the perfect fork for the price-conscious cross country trailblazer.

Whether it's a short day trip to a surrounding towns or out for the weekend with a group of friends, Marzocchi has the perfect suspension for your trekking bike. The magnesium lowers are the same quality as our Marathon line, but with fender mounts and a dynamo generator mount, we've made a fork that's unique to trekking.



GRAN FONDO 3

- 105mm Travel
- New Dual Open Bath SSV System Piston Rod
- External Air Preload
- Internal Rebound Adj.
- Both Sides: Air
- MY05 Marathon Design 6061
- Magnesium Marathon Monolite
- ø30mm Alloy Stanchions
- Steel Steer Tube
- Disc Brake XC INTL STD 6" Rotor Setup
- Standard Drop-Outs



TXC 1

- 60mm Travel
- Air System
- External Air Preload
- Internal Rebound Adjuster
- Air
- Forged Design
- Low-Rider Mount
- Magnesium Monolite One Piece W/ Fender Mount & Dynamo Generator Mount
- ø28mm Alloy Stanchions
- Alloy Steer Tube (300mm)
- Disc Brake INTL STD & DRUM Brake Mount
- Standard Drop-Outs



TXC 2

- 60mm Travel
- One Side: Air
- One Side: Coil/MCU
- External Preload
- Internal Rebound Adjuster
- One Side: Air
- One Side: Coil/MCU
- Forged Design
- Low-Rider Mount
- Magnesium Monolite One Piece W/ Fender Mount & Dynamo Generator Mount
- ø28mm Alloy Stanchions
- Alloy Steer Tube (300mm)
- INTL STD & DRUM Brake Mount
- Standard Drop-Outs



TXC ECC

- 80mm Travel
- Air System
- External Air Preload
- Internal Rebound Adjuster
- ECC - Extension Control Cartridge
- Air
- Forged Design
- Low-Rider Mount
- Magnesium Monolite One Piece W/ Fender Mount & Dynamo Generator Mount
- ø28mm Alloy Stanchions
- Alloy Steer Tube (300mm)
- Disc Brake INTL STD & DRUM Brake Mount
- Standard Drop-Outs

The Marzocchi All Mountain is truly built for the entire mountain. Climbing is a joy and descending is pure bliss. At a mere 5 pounds, the All Mountain 1 is one of the lightest long travel single crown forks on the mountain. It is fully adjustable from initial setup to on-the-fly trail tuning. Marzocchi delivers the entire package for your all mountain needs.



ALL MOUNTAIN SL

- 130mm to 150mm (One Cartridge w/ Different Pressure on Negative Chamber)
- Dual Hydraulic Compression & Rebound Damping
- Open Bath Lubrication
- External Positive & Negative Air Preload
- 5-Position TST Bladder System For Compression & Lock-Up
- External Rebound Adjuster (Bottom)
- Progressive Air Bottom Out Air Preload (Bottom)
- New Redesigned Doppio Air System (Positive/Negative)
- New Forged Crown Specific For All Mountain Use
- New All Mountain Magnesium Monolite
- ø32mm Alloy Black Tapered Tubes
- Alloy FR Steer Tube
- Brake Disc Post Mount
- Standard Drop-Outs

Optional Features:

- New AM Integrated Fender
- Remote TST Control (5 Position)



ALL MOUNTAIN 1

- 130mm to 150mm Travel Adjustment System
- Dual Hydraulic Compression & Rebound Damping
- Open Bath Lubrication
- External Air Preload
- 5-Position TST Bladder System for Compression & Lock-Up
- External Rebound Adjuster (Bottom)
- ETA (Top)
- TAS From 130mm to 150mm (Bottom)
- One Side: Air (TST)
- One Side: Coil (ETA & TAS)
- New Forged Crown Specific for All Mountain Use
- New All Mountain Magnesium Monolite
- ø32mm Alloy Black Tapered Tubes
- Alloy FR Steer Tube
- Disc Break Post Mount
- Standard Drop-Outs

Optional Features:

- New AM Integrated Fender
- Remote TST Control (5 Positions)



ALL MOUNTAIN 2

- 130mm to 150mm Travel
- New SSV System
- Open Bath Lubrication
- External Air Preload w/o Adapter
- Single Rebound Adjuster
- ETA + TAS 130 > 150mm
- Air
- Long Negative Coil Spring
- New Forged Crown Specific For All Mountain Use
- New All Mountain Magnesium Monolite
- ø32mm Alloy Black Stanchions
- Alloy FR Steer Tube
- Disc Brake Post Mount
- Standard Drop-Outs

Optional Feature:

- New AM Integrated Fender



ALL MOUNTAIN 3

- 130mm Travel
- Dual SSV System
- Open Bath Lubrication
- External Air Preload w/o Adapter
- Single Rebound Adjuster
- One Side: Air
- One Side: Long Negative Coil Spring
- New Forged Crown Specific for All Mountain Use
- New All Mountain Magnesium Monolite
- ø32mm Alloy Black Stanchions
- Alloy FR Steer Tube
- Disc Brake Post Mount
- Standard Drop-Outs

Optional Feature:

- New AM Integrated Fender



All Mountain Series



AM Series

The AM series line brings you light weight All Mountain performance without the heavy price.

With features such as externally adjustable damping and ETA, the AM is ready for anything on your local trail.



AM 3

- 130mm Travel
- One Side: New Adjustable Alloy Piston Rod
- One Side: Plastic Piston Rod
- External Air Preload
- External Rebound Adjuster
- Air
- MY05 All Mountain Crown w/ Drilled Holes
- Magnesium FR Monolite
- ø32mm Alloy Stanchions
- Reinforced Steel Steer Tube
- Disc Brake Mount XC INTL STD 6" Rotor Setup
- Standard Drop-Outs
- Optional Feature:
 - Integrated Fender



DEATH TO INVADERS

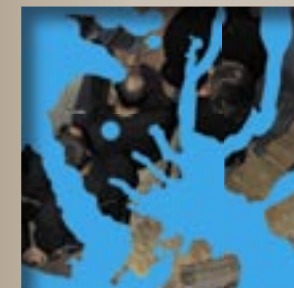
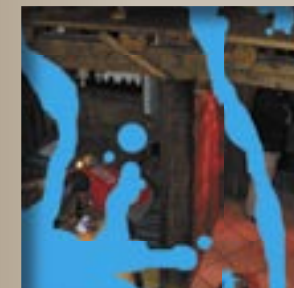
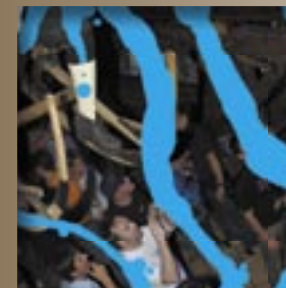
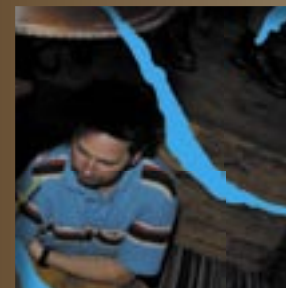
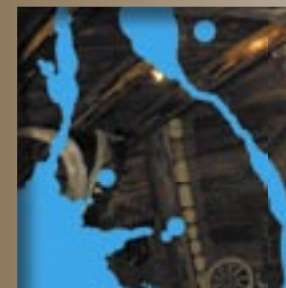
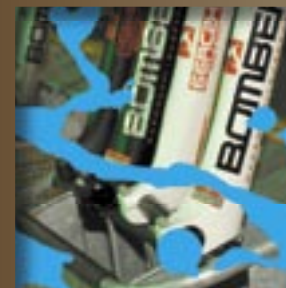
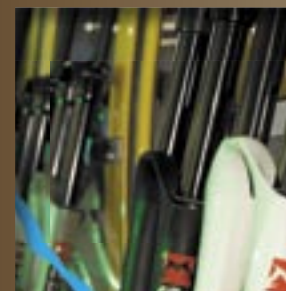
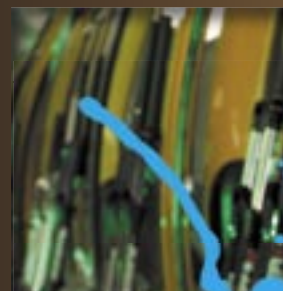

MARZOTTI
Euro Sessions 2006
Saalbach, Austria

Z.1 SERIES



Z.1 FR SL

- 130mm to 150mm (One Cartridge w/ Different Pressure on Negative Chamber)
- New Hydraulic Compression & Rebound Damping RC2
- Open Bath Lubrication
- External Positive & Negative Air Preload (Doppio Air)
- RC2 System for Compression (Bottom) & Rebound (Top)
- Progressive Air Bottom Out
- New Redesigned Doppio Air System (Positive/Negative)
- Forged FR Crown w/ Cryofit Design
- Magnesium FR Monolite One Piece Arch & Sliders
- ø32mm Alloy Tapered Tubes
- Alloy FR Steer Tube
- Disc Brake INTL STD
- New 20mm Drop-Outs
- Through Axle

Optional Feature:

- Integrated Fender

RC2



Z.1 LIGHT ETA

- 150mm Travel
- NEW Dual Hydraulic Compression & Rebound Damping RC2
- One Side: ETA
- Open Bath Lubrication
- External Air Preload
- RC2 System for Compression (Bottom) & Rebound (Top)
- One Side: Air
- One Side: Coil
- Forged FR Crown w/ Cryofit Design
- Magnesium FR Monolite One Piece Arch & Sliders
- ø32mm Alloy Stanchions
- Alloy FR Steer Tube
- Disc Brake INTL STD
- New 20mm Drop-Outs
- Through Axle

Optional Feature:

- Integrated Fender

ETA RC2



Z.1 SPORT

- 130mm Travel
- New SSV System
- Open Bath Lubrication
- External Air Preload w/o Adaptor
- Single External Rebound Adjustment (Bottom)
- Single Ext. Compression Adj. (Bottom)
- Coil Springs
- Forged FR Crown w/ Cryofit Design
- Magnesium FR Monolite One Piece Arch & Sliders
- ø32mm Alloy Stanchions
- Alloy FR Steer Tube
- Disc Brake INTL STD
- New 20mm Drop-Outs
- Through Axle

Optional Feature:

- Integrated Fender



Z.1 SPORT ETA

- 150mm Travel
- New SSV System
- Open Bath Lubrication
- ETA
- External Air Preload w/o Adaptor
- Single External Rebound Adjustment (Bottom)
- Coil Springs
- Forged FR Crown w/ Cryofit Design
- Magnesium FR Monolite One Piece Arch & Sliders
- ø32mm Alloy Stanchions
- Alloy FR Steer Tube
- Disc Brake INTL STD
- New 20mm Drop-Outs
- Through Axle

Optional Feature:

- Integrated Fender

ETA

XC TK Z.1 FR DU F



When we first debuted this fork, it changed the course of mountain biking. This year we've pulled out all the stops to make a fork that's worthy of it's original namesake. It's built on a stout platform with new 20mm drop-outs. We've expanded the line to three different models to suit your riding style. From freeriders to racers, there's a Z.1 that's perfect for you. It's Cedric's choice on raceday, so you know the Z.1 is still the best in the business.

- 150mm Travel
- One Side: New Adjustable Alloy Piston Rod
- One Side: Plastic Piston Rod
- External Air Preload
- External Rebound Adjuster
- One Side: Air
- One Side: Coil
- Forged FR Crown w/ "M" Design
- Magnesium FR Monolite
- Alloy Stanchions
- Reinforced Steel Steer Tube
- Disc Brake XC INTL STD 6" Rotor Setup
- 20mm Dedicated Drop-Outs
- Through Axle

Optional Feature:

- Integrated Fender

- 130mm Travel
- One Side: New Adjustable Alloy Piston Rod
- One Side: Plastic Piston Rod
- External Air Preload
- Internal Rebound Adjuster
- One Side: Air
- One Side: Coil
- Forged FR Crown w/ "M" Design
- Magnesium FR Monolite
- ø32mm Alloy Stanchions
- Reinforced Steel Steer Tube
- Disc Brake Mount XCD INTL STD 6" Rotor Setup
- Standard Drop-Outs

Optional Feature:

- Integrated Fender

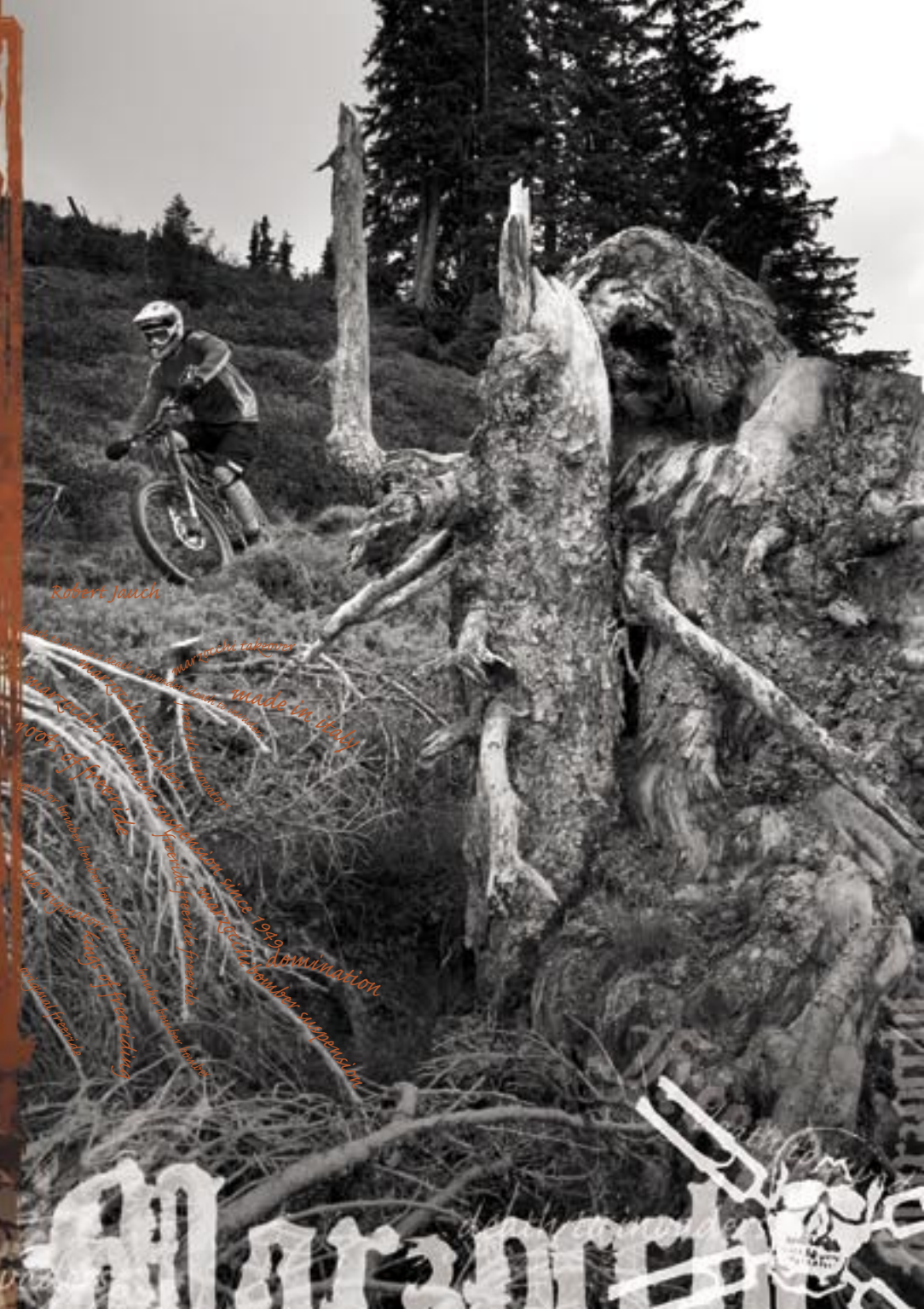

Robert Jauch

[illegible]



DIRT JUMPER 24

- 80mm Travel
- Dual SSV System
- External Air Preload
- Coil Springs
- Forged FR Crown W/ Cryofit "M" Design
- Forged Aluminum Alloy Arch & Sliders
- Special Design for 24" Wheels
- New Machining for Peg
- ø32mm Steel Stanchions
- Reinforced Steel Steer Tube
- Disc Brake INTL STD
- New 20mm Drop-Outs
- Through Axle

Optional Features:

- Integrated Fender
- Steel Grind Plates



DIRT JUMPER 1

- 100mm Travel
- One Side: New Alloy SSV
- One Side: Alloy Piston Rod
- External Air Preload w/o Adapter
- External Rebound Adjuster
- External Compression Adjustment
- Coil Springs
- New Forged Crown w/ Bolts To Remove Lower from Crown
- Magnesium FR Monolite One Piece Arch & Sliders
- New ø32mm Alloy Stanchions
- Reinforced Alloy Steer Tube
- Disc Brake INTL STD
- New 20mm Drop-Outs
- Through Axle



DIRT JUMPER 2

- 100mm Travel
- One Side: New Alloy SSV
- One Side: Alloy Piston Rod
- Moto System
- External Air Preload w/o Adapter
- External Rebound Adjustment
- Coil Springs
- New Forged Crown w/ Bolts To Remove Lower from Crown
- Magnesium FR Monolite One Piece Arch & Sliders
- New ø32mm Alloy Stanchions
- Reinforced Alloy Steer Tube
- Disc Brake INTL STD
- New 20mm Drop-Outs
- Through Axle



DIRT JUMPER 3

- 100mm Travel
- One Side: New Alloy SSV
- One Side: Alloy Piston Rod
- Moto System
- External Air Preload w/o Adapter
- Internal Rebound Adjuster
- Coil Springs
- New Forged Crown w/ Bolts To Remove Lower from Crown
- Magnesium FR Monolite One Piece Arch & Sliders
- New ø32mm Alloy Stanchions
- Reinforced Steel Steer Tube
- Disc Brake INTL STD
- 20mm Drop-Outs
- Through Axle



DIRT JUMPER 3 STD. DROP-OUTS

- 100mm Travel
- One Side: New Alloy SSV
- One Side: Alloy Piston Rod
- Moto System
- External Air Preload w/o Adapter
- Internal Rebound Adjuster
- Coil Springs
- New Forged Crown w/ Bolts
- Magnesium FR Monolite One Piece Arch & Sliders
- New ø32mm Alloy Stanchions
- Reinforced Steel Steer Tube
- Disc Brake INTL STD
- Standard (MY05) Drop-Outs



DIRT JAM PRO

- 100mm Travel
- One Side: Alloy SSV System w/ Air
- One Side: Long Coil
- External Air Preload
- New Internal Rebound Adjuster
- One Side: Long Coil Spring
- One Side: Air
- Forged FR Design
- Magnesium FR Monolite One Piece Arch & Sliders
- ø32mm CR-MO Steel Stanchions
- Reinforced Steel Steer Tube
- Disc Brake XC INTL STD 6" Rotor Setup
- Standard Drop-Outs

DIRT JUMPER SERIES

Who really offers a TRUE Dirt Jumper fork other than Marzocchi? How about a suspension fork that's geared SPECIFICALLY for a park rider who wants to run a 24" wheel with a standard 14mm peg?

In every category, including dirt jumping and urban assault, Marzocchi delivers quality suspension with the latest technology. This year our dirt jumpers have external rebound adjustment, and an easy air preload. The D-Street comes with an axle that FITS any 14mm peg, and it comes with steel grind plates to protect the bottom of your drop-out.

john cowan

paul basagoitia
2x crankworx
slopestyle champion

randy spangler

XC TK 41 FR DJ DH FRX



DEATH TO INVAAS



SERIES

TR DU DH FRX



66 911

- 150mm to 170mm (One Cartridge w/ Different Pressure On Negative Chamber)
- New Hydraulic Compression & Rebound Damping RC2
- Open Bath Lubrication
- External Positive & Negative Air Preload (Doppio Air)
- RC2 System for Compression (Bottom) & Rebound (Top)
- Progressive Air Bottom Out
- New Redesigned Doppio Air System (Positive/Negative)
- New Forged Crown W/ Cryofit "M" Design
- Lighter w/ Holes
- New Magnesium 66 Monolite
- 30mm Shorter
- ø35mm Alloy Tapered Tubes
- Alloy Steer Tube
- Disc Brake Post Mount
- 8" Rotor Setup w/ Adaptor
- 20mm Dedicated Axle
- Optional Feature:
- Integrated Fender



66 RC2X

- 150mm or 170mm Travel
- New Hydraulic Low Speed Compression & Rebound Damping RC2
- New High Speed Compression Adj. X
- Open Bath Lubrication
- Both Systems Combined Make the New RC2X Cartridge Damping System
- External Air Preload
- RC2 System for Compression (Bottom) & Rebound Adjust (Top)
- X System for High Speed Compression (Top)
- Coil Springs
- New Forged Crown W/ Cryofit "M" Design
- New Magnesium 66 Monolite
- 30mm Shorter
- ø35mm Alloy Tapered Tubes
- Alloy Steer Tube
- Disc Brake Post Mount
- 8" Rotor Setup w/ Adaptor
- 20mm Dedicated Axle
- Optional Feature:
- Integrated Fender



66 META 911

- 170mm Travel
- New Hydraulic Compression & Rebound Damping RC2
- One Side: Aluminum Piston Rod
- Open Bath Lubrication
- External Air Preload
- RC2 System for Compression (Bottom) & Rebound (Top)
- ETA Cartridge
- One Side: Air
- One Side: Coil
- New Forged Crown w/ Cryofit "M" Design
- New Magnesium 66 Monolite
- 30mm Shorter
- ø35mm Alloy Straight Tubes
- Alloy Steer Tube
- Disc Brake Post Mount
- 8" Rotor Setup w/ Adaptor
- 20mm Dedicated Axle
- Optional Feature:
- Integrated Fender



66 VF2

- 170mm Travel
- New Alloy SSV
- External Air Preload w/o Adaptor
- Single External Rebound Adjustment (Bottom)
- Single External Compression Adj. (Bottom)
- Coil Springs
- New Forged Crown w/ Cryofit Design
- New Magnesium 66 Monolite
- 30mm Shorter, No Internal Machining
- ø35mm Alloy Straight Tubes
- Alloy Steer Tube
- Disc Brake Post Mount
- 20mm Drop-Outs w/ Dedicated Axle
- Optional Feature:
- Integrated Fender



Imagine a fork that has the instincts and pedigree of a 888, but in a single crown. This year Marzocchi presents a new and improved 66 for 2006. It's evolution continues with a new Magnesium lower, new crown, and disc brake post mounts. The 66 series now has four models to suit your riding style. Progressive freeriders demand a fork that works on the big drops with the freedom of a single crown. The 66 series delivers.

DEATH TO MANDERS



MONSTER T

- 200mm Travel
- Hydraulic Cartridge w/ HSCV
- Open Bath Lubrication
- Right Leg: External Rebound (Top) External Compression Adj. (Bottom)
- Left Leg: External High Speed Compression Adjustment (Bottom)
- Coil Springs
- Forged Alloy 3 Bolt Design
- Forged BAM
- Forged Aluminum Alloy
- ø40mm Alloy Stanchions
- Alloy Steer Tube
- Disc Brake Post Mount 8" Rotor Setup
- 20mm Drop-Outs w/ Dedicated Axle
- Optional Feature:
- Direct Mount Handlebar Clamp



JUNIOR T

- 170mm Travel
- Dual SSV System
- Open Bath Lubrication
- External Preload Adjustment
- External Rebound Adjustment
- Coil Springs
- Forged Top Clamp w/ Bolts
- Forged FR Crown w/ Bolts
- Magnesium Monolite One Piece Arch & Sliders FR Design
- ø32mm Alloy Stanchions
- Alloy FR Steer Tube
- Disc Brake INTL STD
- Standard Drop-Outs
- Optional Features:
- Dedicated Axle
- Integrated Fender
- Direct Mount Handlebar Clamp
- New 20mm Drop-Outs



888 RC2X

- 200mm Travel
- New Hydraulic Low Speed Compression & Rebound Damping RC2
- New High Speed Compression Adj. X
- Open Bath Lubrication
- Both Systems Combined Make the New RC2X Cartridge Damping System
- Dual Air Volume Adj. & Preload Adjuster
- RC2 System for Compression (Bottom) & Rebound Adjustment (Top)
- X System for High Speed Compression (Top)
- Coil Springs
- New Flat Forged Top Clamp w/ Bolts
- New Fender
- New Flat Forged Crown w/ Bolts
- MY05 Magnesium Monolite One Piece Arch & Sliders
- ø35mm Alloy Stanchions
- Straight Tubes Between Lower & Upper Crowns
- Alloy Steer Tube
- Disc Brake DH INTL STD
- 8" Rotor Setup w/ Adaptor
- 20mm Dedicated Axle
- Optional Feature:
- Direct Mount Handlebar Clamp

RC2X



888 VF2

- 200mm Travel
- SSVF
- Motorcycle System
- New Single External Rebound Adjustment (Bottom)
- New Single External Compression Adjustment (Bottom)
- Coil Springs
- New Flat Forged Top Clamp w/ Bolts
- New Fender
- New Flat Forged Crown w/ Bolts
- MY05 Magnesium Monolite One Piece Arch & Sliders XFR Design
- ø35mm Alloy Stanchions
- Straight Tubes Between Lower & Upper Crowns
- Alloy Steer Tube
- Disc Brake DH INTL STD
- 8" Rotor Setup w/ Adaptor
- 20mm Dedicated Axle
- Optional Feature:
- Direct Mount Handlebar Clamp

FREERIDE AND DOWNHILL SERIES

We take our freeride and downhill suspension very seriously. From the Junior T to the 888's, it doesn't go to market until we've tested it to its very limits. The 888's garnered accolades in all the major freeride contests. In fact, Fabien Barel won a world championship on this fork.

This year Marzocchi offers you the very best in freeride technology that's been tested on the trails and trusted by the pros.





ROCO

FEATURES

- ADJUSTABLE HIGH SPEED COMPRESSION VALVING
- ADJUSTABLE REBOUND
- ADJUSTABLE AIR PRESSURE - 180-225PSI
- 1/2" EYELET BUSHING (COMPATIBLE W/ MOST OTHER SHOCK MAKERS)
- STANDARD SPRING SIZES (COMPATIBLE W/ MOST OTHER SHOCK MAKERS)
- NO WEAR SHAFT, BODY & PISTON GLIDE BUSHINGS TO ELIMINATE WEAR AND KEEP DAMPING CONSISTENT
- REBUILDABLE W/O ANY SPECIAL TOOLS
- FULL SUPPORT FOR REPAIRS & REBUILDS

SPRING

- Cr-Si spr.K 34.4 - 113 N/mm (225 - 650 lb/in)

DAMPING

- Air Pressure (Fixed Reservoir Cap)
- Oil Damping Via Piston & Shims

ADJUSTMENT

- External Spring Preload
- External Rebound
- External High Speed Compression

SHAFT/PISTON

- 1/2" Steel Alloy, Chromed

EYELET

- Alloy w/ 1/2" Teflon / Steel Bushing

BODY

- Alloy w/ 1/2" Teflon / Steel Bushing

TRAVEL

76.2mm (3.0")
70mm (2.75")
70mm (2.75")
63.5mm (2.5")
51mm (2.0")
51mm (2.0")

EYE TO EYE

241.3mm (9.5")
228.6mm (9.0")
222mm (8.75")
215.5mm (8.5")
200mm (7.875")
190.5mm (7.5")





TIRE & SPARE PARTS

In addition to the front fork, tires are an extension of a bike's suspension. So, it was only a matter of time before we created a tire to compliment our quality suspension products. Marzocchi offers the Bomber tire in a 2.3" and a 2.6" size. We're also excited to offer it in our new D40 soft compound which was perfected on the wet rooty trails of the North Shore.

We've got everything you need to keep your fork in proper working order. Keep things running smoothly by using genuine Marzocchi spare parts for all your fork repair and maintenance.

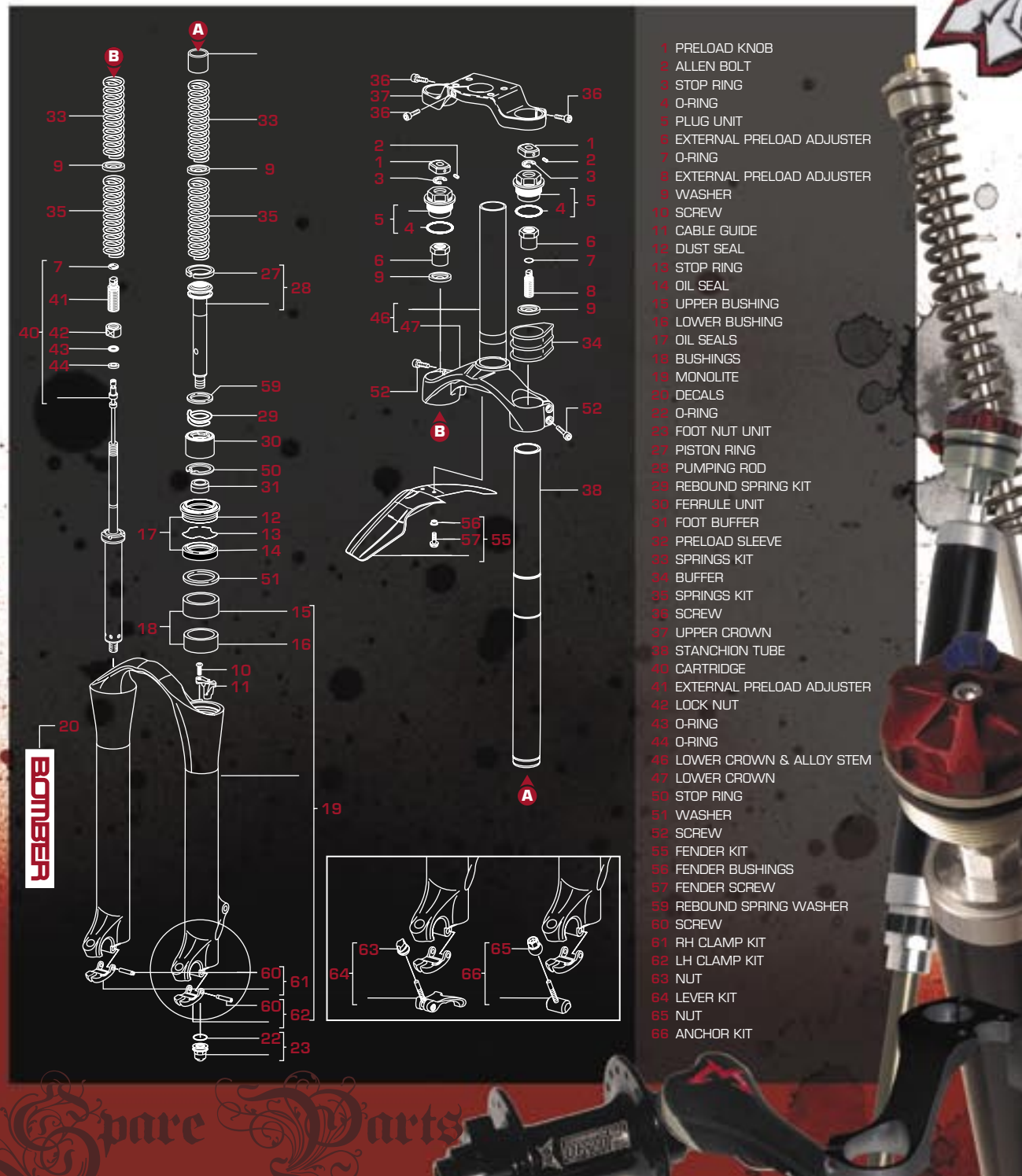

MARZOCCHI S.p.A.

[physical] Via Grazia, 2
40069 Zola Predosa
Bologna, Italy
[tel] ++39 051 6168711
[fax] ++39 051 758857

MARZOCCHI USA

[physical] 25213 Anza Drive
Valencia, California 91355
[tel] 661 257 6630
[fax] 661 257 6636

MARZOCCHI ASIA

[physical] 36F-A2, No 760
Chung Ming South Road
Taichung, Taiwan, R.O.C.
[tel] +886 4 22634382
[fax] +886 4 22634380

MARZOCCHI CANADA

[physical] 1450 Rupert Street
North Vancouver, BC V7J 1E9
[tel] 604 986 3675
[fax] 604 986 3672

WARNING: THIS CATALOG DEPICTS PROFESSIONAL RIDERS UNDER STRICTLY CONTROLLED CONDITIONS WITH ALL NECESSARY SAFETY EQUIPMENT. DO NOT ATTEMPT ANY OF THE STUNTS OR OTHER RIDING MANEUVERS SHOWN IN THIS CATALOG. FAILURE OF A COMPONENT OF YOUR BICYCLE COULD OCCUR, RESULTING IN AN ACCIDENT, PERSONAL INJURY OR EVEN DEATH. PLEASE BE SURE TO SELECT AND USE YOUR MARZOCCHI FORKS IN STRICT COMPLIANCE WITH THE WARNINGS AND INSTRUCTIONS PROVIDED IN THE OWNER'S MANUAL.