



Park ToolTM

ST. PAUL, MN

EST. 1963

2009



Park Tool

25 NEW PRODUCTS

3	106 Work Tray	48	PDR-6 Double Wall Display	30	TW-6 Ratcheting "Click-Type" Torque Wrench
3	106-AC Accessory Collar	25	PH-T1 P-Handled Torx® Compatible Star Shaped Driver Set		
2	BBB-2 Big Blue Book of Bike Repair - 2nd Edition	36	PP-1 Hydraulic Brake Piston Press		
2	BBB-2TG Instructors Guide for Park Tool School	30	SBS-1 Socket & Bit Set		
32	BBT-39 Bottom Bracket Bearing Tool Set	33	SS-15 Single Speed Spanner		
16	BTR-1 Tool Roll	50	SWH-1 Hoodie Sweatshirt		
33	CCP-22 Crank Puller	29	SCW-28 28mm Cone Wrench		
33	CCP-44 Crank Puller	12	SW-20 Master Mechanic Spoke Wrench		
33	CWP-7 Compact Crank Puller	12	SW-22 Master Mechanic Spoke Wrench		
46	DAG-2 Derailleur Hanger Alignment Gauge	46	TNS-15 Threadless Nut Setter		
18	DC-1 Digital Caliper	30	TW-5 Ratcheting "Click-Type" Torque Wrench		
18	DS-2 Tabletop Digital Scale				
31	HCW-11 Crank & Bottom Bracket Wrench				

Park Tool Company // 6 Long Lake Road // St. Paul, MN // 55115-6824 USA
Tel: (651) 777-6868 // Fax: (651) 777-5559 // www.parktool.com



INDEX

50	Aprons
29	Axle Vises
19	Backpacks
30-32	Bottom Bracket Tools
36-37	Brake Tools
39	Chain Cleaning & Measuring
40	Chain Tools
28	Chain Whips
38	Cleaning & Lubrication
29	Cone Wrenches
33	Crank Tools
48	Display Systems
15	Floor Pumps
41-47	Frame & Fork Tools
28	Freewheel/Cassette Removers
17-18	General Tools
16	Hand Pumps
35	Headset Tools
25-27	Hex Wrenches
29	Hub & Axle Tools
23-24	Multi-Tools
50	Park Tool Apparel
49	Park Tool Gear
2	Park Tool School
34	Pedal Tools
31	Pin Spanners
3-5	Portable Repair Stands
6	Portable Workbench
8	Repair Stand Clamps & Parts
7-9	Repair Stands & Accessories
12	Spoke Wrenches
13-14	Tire Tools and Inner Tube Repair
19-22	Tool Kits
30	Torque Wrenches
1	Warranty Information
11	Wheel Tools
10	Wheel Truing Stands



Park Tool Web Site – www.parktool.com

www.parktool.com is considered by many mechanics to be the most useful site in the bicycle industry.

- Up to date specs and photos of our entire product line
- Exploded view drawings and part numbers for most Park Tool products
- Downloadable versions of this catalog in French, German, Spanish and Chinese
- Over 100 detailed, printable instructions and photos for almost any bicycle maintenance task or repair
- A virtual tour of our factory in St. Paul, MN
- "Tool Locator" for helping select the right tool for the job
- Dealer locator with special Park Tool School references and links
- Recommended tool lists for mechanics of various levels of expertise
- One on one technical support through e-mail

Park Tool Limited Lifetime Warranty



Park Tool Company backs its tools with a limited lifetime warranty. If a Park Tool product fails to perform its intended purpose, under normal usage, due to defects in material or workmanship, the tool will be repaired or replaced at our option. Tools that are worn from normal use, or damaged due to accident, abuse, neglect, or modification are not covered by the warranty. When possible, tools not covered under warranty will be repaired for a reasonable charge. This warranty does not cover consequential damage or cost of injury incurred by the user. Park Tool Pumps are warranted for one year from date of purchase. Tools for warranty consideration should be returned to the point of purchase or to Park Tool Company.

To our customers... there's just something about fixing a bike, fixing a problem. Figure out what's wrong, then dig in and make it better. It's still one of my favorite things to do. Sure, bikes and components have changed a lot over the 30 years I've been in the bike industry but in a lot of ways, a bike is a bike. I still love to work on bikes just as I did growing up in my father's shop here in Minnesota. Granted, it's a lot more fun now than when it was my job, but even then bicycle repair was the perfect combination of semi-complex mechanical tests and simple jobs like fixing a flat tire. Working on bicycles seems to be just the right balance of easy fixes and tricky procedures. It's a two-wheeled transporter, a kid's status symbol and a finely engineered racing machine. The bicycle is perfect... unless it needs to be fixed. Luckily, there are people (you know who you are) who love to fix bikes. We make tools for those people: Professional race and shop mechanics, weekend warrior home mechanics, "that guy" in the neighborhood who works on anything with two wheels and pedals, the commuter who needs to fix a flat on the way to work or the kid who just loves to take things apart (and hopefully put them back together).

As we head into 2009 with another strong lineup of new tools (20) we're often reminded of our responsibility to the industry and to the people who love to fix bikes. Now, more than ever we know that as the #1 bicycle tool company in the world we have to do our best to stay current with the industry's mechanical advances, to make the best tools possible, and to help people learn more about their bikes. Yes, we love to fix bikes, but more than that we love making tools to fix bikes.

It's a great day to fix a bike!
Eric Hawkins, President

The rest of the story... John 1:12-13

¹²Yet to all who received Him, to those who believed in His name, He gave the right to become children of God—¹³children born not of natural descent, nor of human decision or a husband's will, but born of God.





Big Blue Book of Bike Repair - 2nd Edition

BBB-2

Big Blue just got bigger and better! Freshly updated to include new topics, techniques and equipment. Packed with hundreds of photos and hundreds of procedures, the BBB-2 provides both the novice and veteran mechanic the information needed to perform nearly any repair from trailside repairs to complete overhauls. Written by Park Tool Director of Education Calvin Jones, the Big Blue Book is the perfect reference guide and step-by-step repair manual for nearly any bike, including road, mountain, bmx, and single-speed. We wrote the book on bicycle repair.



The Park Tool School

Repair clinics are a great way for bike shops to show their expertise, attract new customers, and help current customers keep their bikes running smoothly. The Park Tool School is a program and curriculum designed to make the planning and teaching of repair clinics easy. A skilled shop staff, a copy of the BBB-2TG Instructor's Guide, and a BBB-2 Big Blue Book of Bicycle Repair for each clinic participant are all it takes to get started. Bike shops offering the Park Tool School are posted on the Park Tool web site, where those interested can access a list of participating shops.



Instructors Guide for Park Tool School

BBB-2TG

The BBB-2TG Instructor's Guide is written by Calvin Jones, Park Tool's Director of Education Programs. Using his 30 years experience as a mechanic, educator, and writer, Calvin provides all the time-proven information a shop staff needs for a successful Park Tool School clinic. The first half of this indispensable guide covers all phases of planning, organizing, promoting, and teaching a clinic. The second half provides detailed, step-by-step repair procedures, which are supplemented by hundreds of photos, teaching tips, lecture notes, course outlines, and demonstration ideas. The BBB-2TG includes Park Tool School student participation certificates, promotional poster, sample registration forms, and more.

www.parktool.com

Folding Repair Stands

Each of these three Folding Stands is designed to fold small, adjust in height and clamp a huge variety of tubing and tubing sizes. The unique three-point leg system creates an extremely solid base capable of handling nearly any bike.

- Height adjusts from 39" to 57" (99cm to 145cm)
- Clamps adjust to fit tubes from 7/8" to 3" (24mm to 76mm) and utilize a narrow 3 1/2" (89cm) clamping surface to fit into tight places
- Replaceable jaw covers (#1185K)
- Clamp rotates 360 degrees for ea to any part of the bike
- Adjustable clamp pressure prevents damage to thin wall tubes
- Folds to 41" (104cm) in length for portability and storage
- Durable, wrinkle finish power coat

Home Mechanic Repair Stand

PCS-9

Park Tool quality in an entry-level stand.



PCS-10 & 11 Folded

Home Mechanic Repair Stand

PCS-10

Built with a few upgrades from the PCS-9 to make set up, take down and use, quicker and easier.

- Quick adjust, cam-type clamp allows single action clamping
- Quick release height adjustment
- Quick release and locking sliding yoke for fast folding and extra stability
- World famous composite top tube for smooth rotation and solid locking
- Spring buttons lock folding legs in place
- Exclusive receiver pod accessory system integrated into the top tube and height adjustment collar to allow easy installation of PTH-1 Paper Towel Holder.

Storage and Travel Bag: BAG-15

Super Lite Repair Stand

PCS-11

Same great features as the PCS-10 yet 35% lighter. Nicely upgraded with an aluminum clamp body and extruded aluminum structural tubing. **The PCS-11 weighs a scant 14 lbs (6.4kg)** for the ultimate in lightweight portability. The PCS-11 is sure to be a favorite of race teams and on-the-go mechanics worldwide.

Storage and Travel Bag: BAG-15

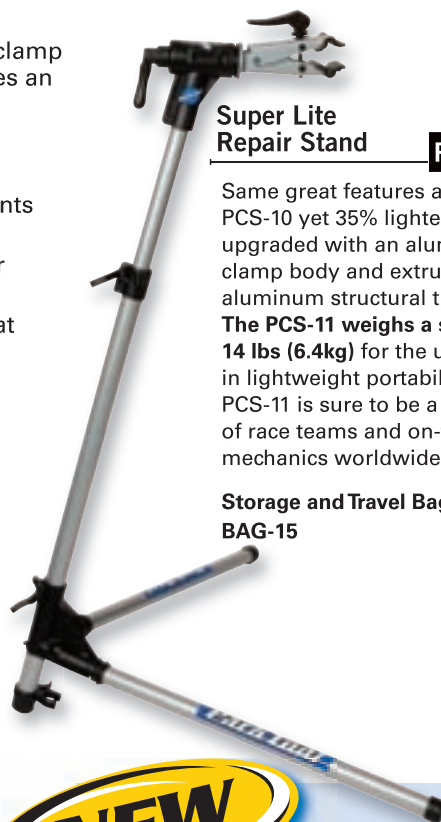

Tray **106**

A great work stand accessory built to keep tools, lubes and spare parts right at your fingertips. The #106 installs easily utilizing our exclusive receiver pod accessory system found on the PRS-15, PCS-10 and PCS-11, as well as PCS-1, PCS-4 and PCS-9 when used with part #106-AC Accessory Collar (available separately). Perfect for the races, ride support or as a convenient way to keep tools and supplies handy.

Features:

- Universal, large compartment
- Small compartment
- Lube holder
- Integrated tab system holds plastic market bag for trash
- Universal tool/towel bar
- Two receiver pods to accept accessories
- Easy on and off

Accessory Collar

106-AC

Easily adapts a PCS-1, PCS-4 or PCS-9 to accept #106 Work Tray or PTH-1 Paper Towel Holder.



Investing in a high quality repair stand is the first step toward building a high quality workstation. Over the past 40 years we've built hundreds of thousands of repair stands for home mechanics, shop mechanics, and professional race mechanics all over the world. Many of the PRS-1 stands we built in the 1960's are still in use daily, and we're constantly striving to improve and update our newest generation of stands. Each of our models offer different features and benefits to ensure a model for nearly every purpose. All of our stands are made to allow full rotation to ensure a comfortable working position at all times. We also offer a complete line of replacement parts to keep your investment running smoothly. Ask any professional mechanic about their stand and you're bound to hear "Park Tool" as the response. Insist on the quality and innovation of genuine Park Tool repair stands. Designed and built to last for years of use.

Professional Race Stand

PRS-15

The PRS-15 is designed to be the finest folding repair stand made. Manufactured from the best materials to provide years of reliable service, the PRS-15 is lightweight, portable, and fully adjustable. The PRS-15 works with any bike and can be quickly turned into a complete mobile workstation by adding the optional Truing Stand and Paper Towel Holder accessories. Ideal for anyone wanting a premium quality repair stand that can be used in the workshop or packed and used at a race or event.

- Five-point leg system adjusts to create a super stable base on smooth or rough surfaces
- Shop quality 100-15X Extreme Range Clamp quickly adjusts
- Clamping height quickly adjusts from 40" to 60" (102cm to 152cm)
- Oversized aluminum upright tube is elliptically-shaped and heat-treated to resist flexing
- Quickly folds to 44" (112cm) for portability and storage
- Replaceable jaw
- Weighs just 22 lbs to fit tubes from 7/8" to 3" (24mm to 76mm)
- Fully adjustable clamping pressure prevents damage to thin-walled tubes
- Clamp rotates 360 degrees for easy access to any part of bike
- Narrow jaws allow clamping in tight access areas



PRS-15 Folded



Clamping height quickly adjusts from 44 to 60 inches 102cm to 152cm



Travel & Storage Bag

BAG-15

Heavyweight nylon bag with shoulder strap for transporting and storing the PRS-15 Race Stand. Also fits PCS-10 and PCS-11.



Paper Towel Holder

PTH-1

Paper towels are always handy for cleaning hands and parts. Keep them within reach with the PTH-1. Fits into the Receiver Ports of any PRS-15, PCS-10 and PCS-11 to hold a standard roll of paper towels. Also works great for hanging clothing, wheels, tires, etc.



Truing Stand Attachment

TS-15

The TS-15 attaches onto the PRS-15 Professional Race Stand for accurate truing of wheels up to 29" Simple, lightweight, and compact. Wheel dishing (centering) is performed by simply flipping the wheel in the TS-15.

Team Race Stand PRS-20

The PRS-20 Team Race Stand is a compact, Euro-style work stand that securely holds the bike without clamping the frame tubes or seat post. Ideal for bikes with ultra lightweight frame tubes and seatposts, and for bikes with tight access areas that can't be clamped. Originally designed for the mechanics of the Tour de France-winning US Postal Service Pro Cycling Team, the PRS-20 is now available to professional and home mechanics everywhere.

- Quick release mounts hold bike securely by the front or rear dropouts
- New, taller vinyl-covered cradle to create extra clearance between bottom bracket and stand
- 360 degree horizontal rotation allows easy access to both sides of bike
- Folds to 33" (84cm) for easy transport and storage
- Stable tripod base
- Bottom bracket height quickly adjusts from 28" to 38" (71cm to 96cm)
- Durable blue powder coat finish. High wear parts are chrome plated
- New, extra long, quick release retention strap to stabilize bottom bracket

Storage and Travel Bag: BAG-20*PRS-20 Mounted to rear dropouts***BAG-20**
fits PRS-20
& PRS-21*PRS-20 Folded***Super Lite Team Race Stand PRS-21**

Same great stability, versatility and features as the PRS-20, yet weighs only 13.5 lbs (6.2 kg), 35% less than the PRS-20. Built using the perfect combination of steel for strength in joints and pivots, and aluminum to save weight. The PRS-21 is the perfect stand to choose when size and weight are important. Ideal for the traveling mechanic or any mechanic who has to have the best and lightest.

Storage and Travel Bag: BAG-20**Bottom Bracket Cradle Stand - Shop Version PRS-23**

The perfect way to hold bikes without touching the frame or seat post by supporting the bike from under the bottom bracket and securing the front or rear dropouts. Utilizing the same great design (PRS-20) found in professional race pits worldwide, the PRS-23 is a heavy-duty shop version built for the every day rigors of continuous work. Featuring a 65 lb (29 kg) base plate the PRS-23 is rock solid, rotates 360° horizontally, height adjustable (22.6" to 35.5" (57.5-90cm), and is compatible with just about any bike. Great for carbon tube and aero-shaped bikes.

Stand without base: PRS-23LB



Portable Workbench **PB-1**

Perfect for taking to races and rides, the PB-1 is a workbench that folds for easy transport and storage. Features a large 36" x 23" work surface (91.5cm x 58.5cm) with specially sized slots, holes, and ports for holding tools, shop towels, lubes, and accessories (such as the PTH-1 Paper Towel Holder). Heavy duty steel legs provide a rock solid base for heavy tools and supplies.

Folded: 42.5" x 23" x 7"
(108cm x 58.5cm x 18cm)

Set Up: 36" x 23" x 32.5"
(91.5cm x 58.5cm x 82.5cm)

Two Wheel Hand Truck Kit for PB-1 Portable Workbench **PB-5**

The PB-5 transforms the PB-1 Portable Workbench into a two wheel hand truck for hauling a tool box and other heavy supplies. Wheels and carrying shelf fold to stay out of the way when not in use.

Repair Stand and Truing Stand for PB-1 Portable Workbench **PB-7**

The PB-7 Repair Stand and Truing Stand quickly mount to the PB-1 Portable Workbench to create a complete workstation! The repair stand securely clamps the front fork dropouts and bottom bracket for quick repairs and adjustments on most road and mountain bikes. The truing stand attachment allows truing of wheels up to 29". Wheel dishing (centering) is performed by simply flipping wheel in stand.

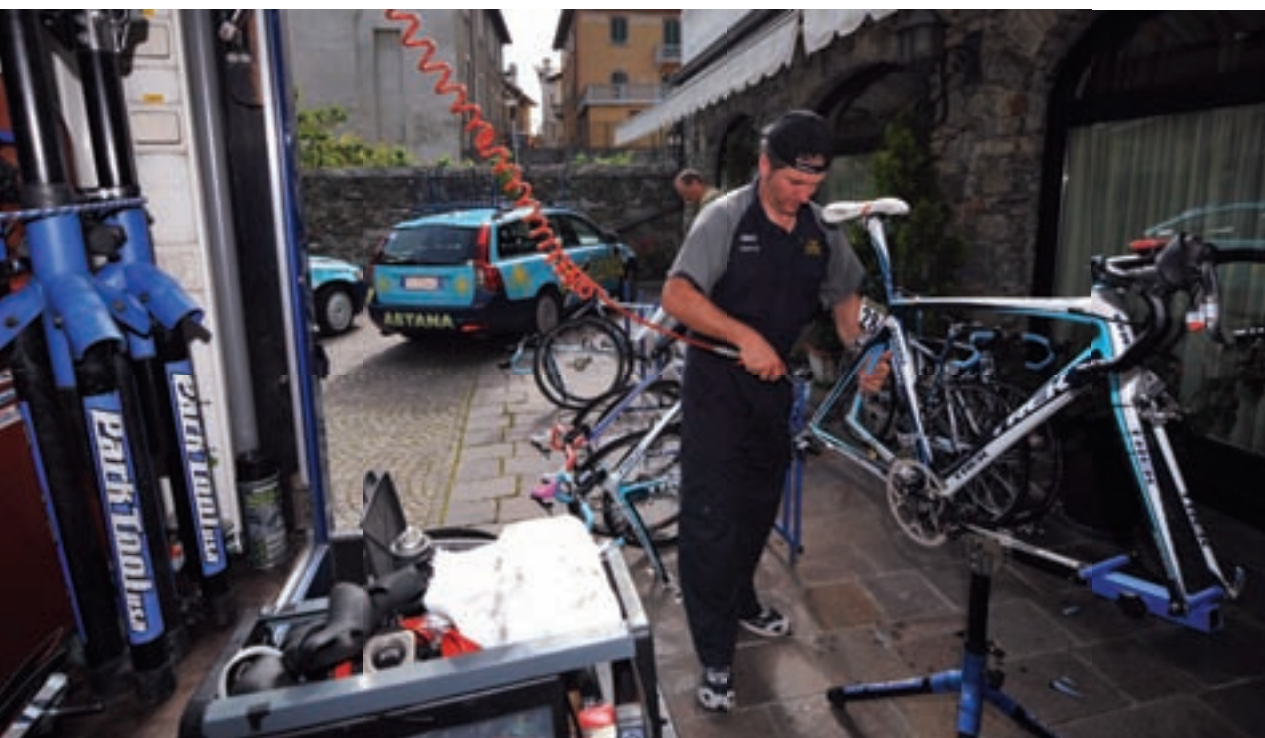

Park Tool Co. is the official tool supplier for:

Jelly Belly
Team CSC
Team BMC
Colavita Sutter
Giant
GT
Santa Cruz
Rite Aid Pro
Symmetrics
Kelly Benefits / Medfast
KHS
USA Cycling
Monster / Iron Horse
Fox
Mavic
Hayes
Astana
Silence Lotto
Chinese National Team
Webcor Pro
Intense Cycles
e-13
Norco
High Road/ Columbia
Gerolsteiner
Cheerwine
Team Rubicon/Livestrong

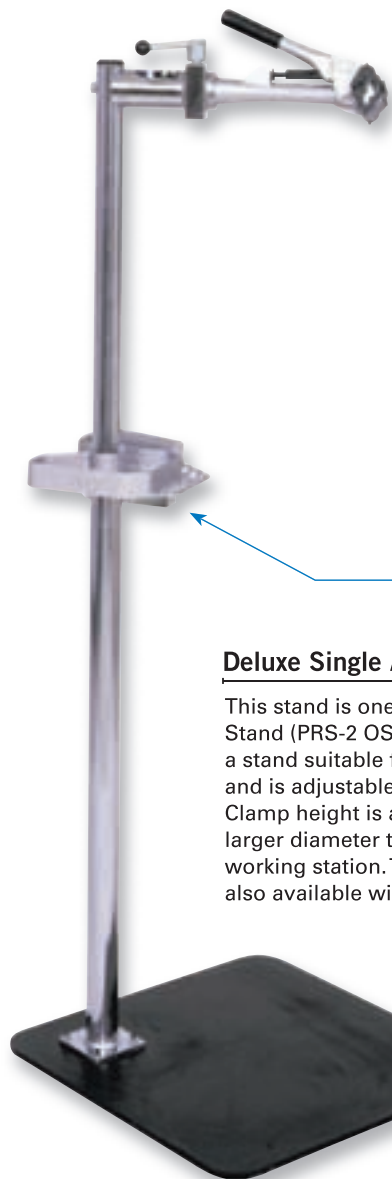

Deluxe Double Arm Repair Stand

PRS-2 OS

The industry standard for the past 30 years. Outstanding stability and a working height range of 50" to 62" (127-158cm)—high enough and stable enough to position the bike at a comfortable working height even when clamping on the seat post. The clamps rotate 360 degrees, allowing the bicycle to be positioned at any angle, and can be adjusted for frame tubes up to 1-5/8". Because the stand itself also rotates horizontally 360 degrees, one bicycle can be swung out of the way, allowing the other clamp to be used for "rush" repair jobs. The entire framework is heavily chrome plated and the steel base (115lbs / 52kg) is painted. The stand is also available without the base (#PRS-2 OSLB).

TOOL
TRAY
INCLUDED

Deluxe Single Arm Repair Stand

PRS-3 OS

This stand is one-half of the ParkTool Deluxe Double Arm Repair Stand (PRS-2 OS), and incorporates most of the same features in a stand suitable for smaller areas. The clamp rotates 360 degrees and is adjustable for virtually any size frame tubing up to 1-5/8". Clamp height is adjustable from 50" to 62" (127-158cm). Uses larger diameter tubing and a 65 pound base to ensure a rigid working station. The PRS-3 OS is heavily chrome plated and is also available without the base (#PRS-3 OSLB).

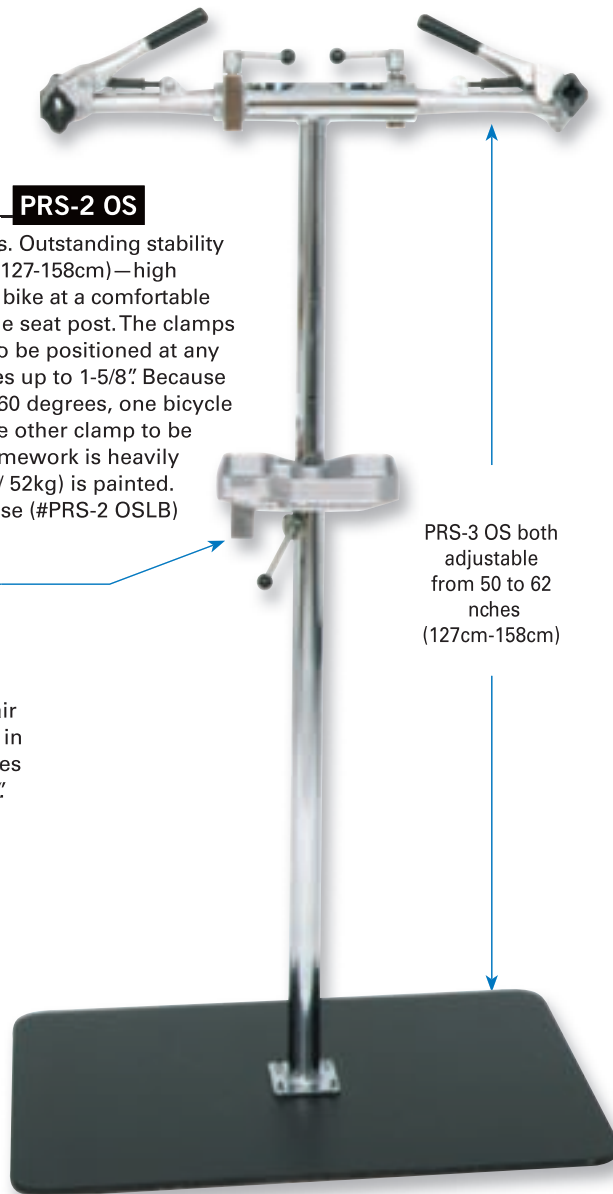

PRS-3 OS both
adjustable
from 50 to 62
inches
(127cm-158cm)



Work Tray*

104

This large tray is ideal for holding small parts and tools. It features deep sides so small items stay put. A variety of slots and holes hold any tool. Fits PCS-1, PCS-4, PCS-9, PCS-10, PCS-11, PRS-2, PRS-3, PRS-6, PRS-11 & PRS-12.



Cast Aluminum Tool Tray*

105

The 105 is a handy and sturdy cast aluminum tray with deep-walled compartments and assorted slots for holding tools, lubes, and small parts. Fits all PRS-2, PRS-2 OS, PRS-3, PRS-3 OS, and PRS-13 Shop Stands, as well as PRS-6, PCS-1, and PCS-4 Repair Stands manufactured after 6/96.



Tool Kaddy*

TK-2

This handy unit is perfect for storing frequently used tools right at your fingertips. The Tool Kaddy rotates to bring needed items up close, features deep pockets, and includes 12 hooks. The TK-2 mounts easily using the included mounting hardware on ParkTool Repair Stands PRS-2, 3, 4, 11, 12 and 13, including OS models.



Floor Plate

FP-2

Permanently and securely attach your ParkTool Repair Stand to the floor of your shop with our Floor Mounting Plate. Made with an 8" square of steel, it attaches to stand with four bolts, which are included.

*Tools not included

Replacement clamps fit frame tubes from 1" to 1-5/8" (25 to 41mm), allow for cable routing on the top tube, and feature replaceable jaw covers. 100-8C fits 15/16" to 1 1/4" (24mm to 33mm).

100-1C

Spring Linkage Clamp fits PCS-1 and PCS-2 stands made after 6/96.



100-2C

Spring Linkage Clamp fits PCS-1 and PCS-2 stands made before 6/96.



100-3C

Adjustable Linkage Clamp fits PRS-2, PRS-2 OS, PRS-3, PRS-3 OS, PRS-4, PRS-4W and PRS-4 OS stands. Fits PRS-5 stands made before 6/96.



100-5C

Adjustable Linkage Clamp fits PCS-4, PRS-5, PRS-6, and PRS-7 stands made after 6/96.



100-8C

Spring Linkage Clamp fits PRS-6, PRS-7, and PRS-8 stands made before 6/96.



100-8Y

Spring Linkage Clamp fits all model stands listed for 100-3C.



Repair Kit for 100-3C Clamp PRS-CRK

The most common replacement parts for our shop clamp 100-3C (shown above).

Includes a complete adjusting linkage #122S (#122S includes #118S, #117S-1, #121S and #136), 2-#116S cap screws, a #108S-2 pin and clips, and 2-#107S-2 pins and clips.

Replacement Clamp Covers

Available in eight models to fit all Park Tool Repair Stand clamps.

- **468G:** Fits PCS-1 and PCS-2 with double cable reliefs
- **468B:** Fits PRS-2 through PRS-8 and PCS-4 with double cable reliefs
- **467B:** Fits PRS-2 through PRS-8 with single cable relief
- **467G:** Fits PCS-1 and PCS-2 with single cable relief
- **466:** Fits original clamps with plastic-dipped jaws. Old plastic should be removed before installing new covers
- **1002:** Fits 100-3X and 100-5X clamp
- **1259:** Fits PRS-15, 100-4X, 100-6X and 100-15X clamps
- **1185K:** Fits PCS-9, PCS-10, PCS-11, and PCS-12 clamps

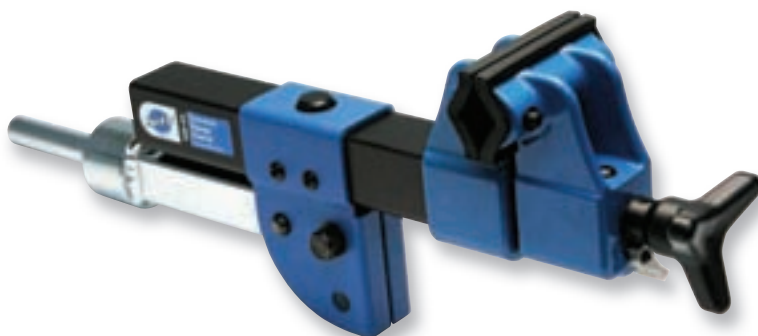

Extreme Range Clamp 100-4X

Our most versatile clamp, the 100-4X fits our heavy duty shop stands and works on nearly any bike, no matter what the size or shape of the frame tube.

- Clamps oversized, square, rectangular, and even aero shaped tubes
- Quickly adjusts from 7/8" to 4"
- Pivots 90 degrees to clamp either top and bottom or left and right sides of tube
- Adjustable clamping pressure prevents damage to thin-wall tubes
- Narrow jaws for clamping in tight access areas
- Replaceable jaw covers (part #1259)
- Fits any PRS-2, PRS-2 OS, PRS-3, PRS-3 OS, PRS-4, PRS-4 OS, PRS-4W, PRS-11, or PRS-12 Repair Stand

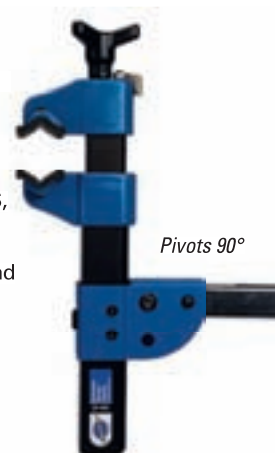

Extreme Range Clamp 100-6X

Similar to 100-4X to fit PRS-5, PRS-7, PCS-4 with composite top tube, PCS-1 and PCS-2 made after 12/2001.

Extreme Range Clamp 100-15X

Replacement clamp for PRS-15 repair stand.

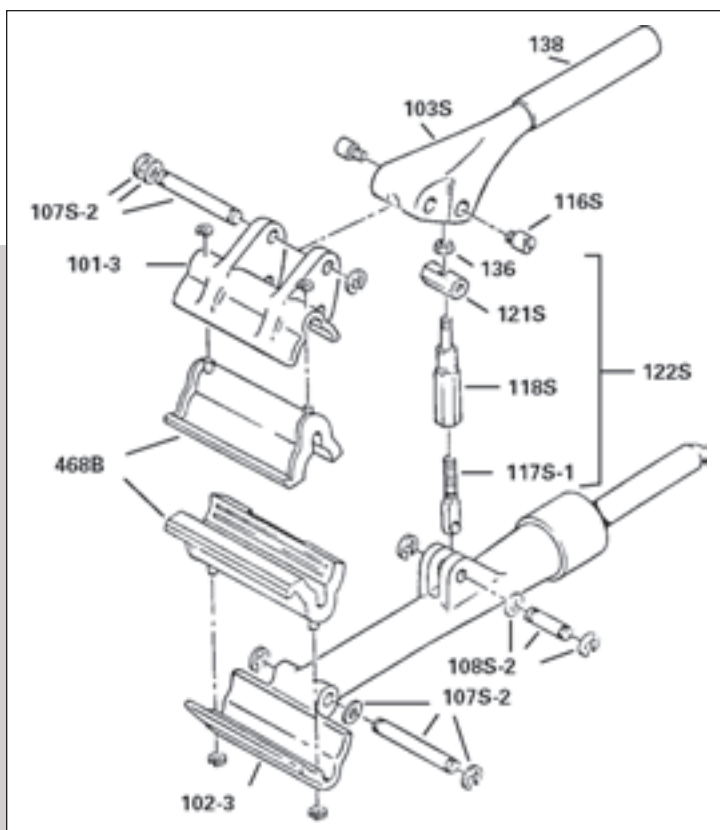

Deluxe Wall Mount Repair Stand **PRS-4W**

Designed to be easily mounted to any post or wall stud, the PRS-4W is a shop quality stand using the same clamp and locking system as the PRS-2 OS, PRS-3 OS, and PRS-4 OS. Powder coat finish. (Mounting bolts not included).

Home Mechanic Bench Mount Repair Stand **PCS-12**

A bench mount version of our popular PCS-10 Home Mechanic Repair Stand. Features a quick adjusting cam-type clamp that fits tubes up to 76mm (3") and rotates 360 degrees for easy access to any part of the bike. Clamping pressure is fully adjustable to prevent damage to thin walled tubes. Durable powder coat finish. Mounts to any flat surface (mounting bolts not included).

Bench Mount Repair Stand **PRS-7**

Easily mounted on any workbench. Uses the same adjustable linkage clamp and locking system as the PCS-4. Mounting flange has four holes, allowing use of bolts or lag bolts to mount. Durable powder coated finish. (Mounting bolts not included).

Deluxe Bench Mount Repair Stand **PRS-4 OS**

The Deluxe Bench Mount Stand uses the same clamp as the PRS-2 OS, PRS-3 OS, PRS-4W. The clamp rotates 360 degrees, allowing the bike to be positioned at any angle. Mounts easily to any flat surface. (Mounting bolts not included).



Handlebar Holder **HBH-2**

The Handlebar Holder is designed to prevent the handlebar and front wheel from rotating when a bike is mounted in a ParkTool Repair Stand. Updated to fit handlebars with a diameter up to 32mm and oversized top tubes up to 50mm, the HBH-2 works on almost any road or mountain bike.

Machine Thread (5/16"-18) Storage Hook, Wood Thread Storage Hook **#450 • #451**

ParkTool storage hooks are perfect for hanging bikes, wheels, etc. Made from 5/16" steel rod. Vinyl coated to prevent scratching.



Internal Seat Tube Clamp **ISC-4**

Clamping directly to freshly painted or ultra thin-walled frame tubing can cause inadvertent damage. The ISC-4 securely holds most bikes without clamping on any frame tube. To use, simply insert the ISC-4 into the frame's seat tube, tighten the knob, and clamp into any ParkTool Repair Stand. The ISC-4's hex-shaped shaft resists twisting while clamped in the stand. Works with a huge range of seat tube sizes—anything with an inside diameter of 24mm to 32mm.





Home Mechanic Wheel Truing Stand **TS-8**

Designed especially for the home mechanic, the TS-8 allows accurate wheel truing at an economical price. Accepts wheels from 16" to 29" with or without the tire mounted. Innovative sliding dropout allows quick wheel installation, no matter what the hub width (up to 170mm). Dishing (centering) is performed by simply flipping the wheel in the stand. Constructed from heavy gauge steel to resist flexing, the TS-8 can be used freestanding or bolted to a bench for extra stability.



Truing Stand Upright Extensions **TS-2EXT**

TS-2EXT Truing Stand Upright Extensions install in seconds on any TS-2 Truing Stand, allowing the stand to be used on wheels with hubs up to 160mm wide (tandem and downhill bikes), as well as on 700C wheels with a 29" mountain bike tire installed. In addition, specially sized bosses on the TS-2EXT serve as adaptors so the TS-2 Truing Stand can be used with wheels using 20mm through axle hubs.



Truing Stand Tilting Base **TSB-2**

We've designed the Tilting Base specifically for use with our Park Tool TS-2 Professional Wheel Truing Stand. It allows for adjustment of the truing stand 20 degrees forward or backward for comfortable use at any bench height. The handy bins in the front of the Tilting Base are specially designed to hold Park Tool Spoke Wrenches and other small items such as spoke nipples.



Professional Wheel Truing Stand **TS-2**

The Park Tool Professional Truing Stand is the stand to choose for heavy shop use. Accepts wheels from 16" to 27" with or without tire removed. Both axle-holding uprights move simultaneously, always centering wheel. Calipers and caliper arm are spring-loaded to prevent jamming with badly out-of-true wheels. Made of heavy chrome plated steel with nylon bushings at pivot points. Can be bench-mounted or vise-held. The standard of the industry. If a forward or backward tilt is desired, use with Truing Stand Tilting Base (TSB-2). For precision work, the TS-2 should be used with a dishing gauge.

Centering Gauge for TS-2 and TS-3

1554-1



Wheel Alignment Gauge **WAG-4**

For a wheel to perform properly, it is important for the rim to be centered between the locknuts of the hub, or "dished." To check this, and to make precision adjustments, a wheel alignment gauge (also called a "dishing tool") is a must. The WAG-4 allows easy checking of the dish on road, mountain, or BMX wheels from 16" to 29". It works with any hub width and its innovative design even allows it to be accurately used with the tire still on the wheel. An accurate and truly versatile wheel alignment gauge that belongs along side every truing stand.



Portable Wheel Dishing Gauge **WAG-3**

The WAG-3 accurately checks the dish, or offset, on all 26", 27", and 700C wheels. Measurements are taken comparing one side of the wheel to the other to determine if the rim is in the center of the hub. Easily disassembles to fit into most tool boxes. Perfect for the race or home mechanic.

Spoke Tension Meter **TM-1**

The key to wheels that are strong and reliable is having spokes that are properly and uniformly tensioned. The TM-1 Tension Meter accurately and reliably measures the absolute tension of each of the spokes in a wheel, as well as the relative tension between all the spokes in a wheel. Easy to use and priced affordably, the TM-1 works on nearly any bicycle spoke—no matter what the diameter, material, or shape. Not just for the experienced mechanic, the TM-1 is for anyone building or truing wheels, diagnosing wheel problems, or assembling new bikes. It's a tool that belongs on every workbench. Includes an indispensable laminated tension chart to convert tool readings to actual measured tension for nearly any spoke.



Spoke, Bearing, & Cotter Gauge **SBC-1**

This handy shop aid is ideal for sizing spokes, ball bearings and crank cotters. To use, just hang the head of the spoke in the oblong hole and read its length on the scale. For crank cotters and ball bearings it works just like a gauge for drill bits. Spoke lengths are in both metric and fractional markings. Made of anodized aluminum with embossed markings to allow easy reading and long life.

Spoke Wrench

SW-0 through SW-3

Professional quality, precision-sized spoke wrenches are hardened and nickel plated for long service. Park Tool Spoke Wrenches are vinyl coated in one of four colors indicating the size at a glance. Park Tool Spoke Wrenches are marked "Park Tool USA."

- **SW-0 (Black):** 80 ga./127" nipple / 3.23mm
- **SW-1 (Green):** 80 ga./130" nipple / 3.30mm
- **SW-2 (Red):** 80 ga./136" nipple / 3.45mm
- **SW-3 (Blue):** 105 ga./156" nipple / 3.96mm

Packaged carded: SW-0C through SW-2C

BEWARE OF POOR FITTING IMITATIONS!

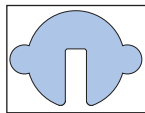

Spoke wrench
bottom view

Four Sided Spoke Wrench

SW-40 • SW-42

Unique four-sided design provides extra strength and support and helps prevent slipping and deformation of Aluminum nipples. A different approach using the same world famous design and high quality materials as our three-sided spoke wrenches.

- **SW-40 (Black):** 80 ga./127" nipple / 3.23mm
- **SW-42 (Red):** 80 ga./136" nipple / 3.45mm

Packaged carded: SW-40C, SW-42C

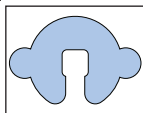

Spoke
bottom view



Spoke Wrench for Mavic Wheel Systems

SW-13

Comfortable, vinyl dipped, two-sided Spoke Wrench is designed to easily access Mavic fittings. Fits both Mavic 9mm threaded eyelets and 7mm integrated nipples.

Packaged carded: SW-13C



Spoke Wrench for Shimano Wheel Systems

SW-14

Two-sided and vinyl dipped, featuring 4.3mm and 4.4mm openings to fit all Shimano Wheel System nipples.

Packaged carded: SW-14C



3-Way Internal Nipple Wrench

SW-15

Our innovative 3-way "Y" wrench featuring three different sized wrenches to fit internal spoke nipples. Featuring a square drive, plus 5mm and 5.5mm hexes that slip perfectly into the tight surroundings of most rims. The SW-15 works on wheels made by numerous manufacturers including, but not limited to: FSA, Blackwell, Planet-X, HED, Rolf, Bontrager, Campagnolo and Mavic. **Note:** Wheel manufacturer's specifications change without notice.

Packaged carded: SW-15C



Master Mechanic Spoke Wrench

SW-20 • SW-22

Destined to become a classic! The Master Mechanic spoke wrench is an investment cast workhorse poured from the best steel, precisely machined, heat treated for hardness then polished and plated. The result is a smooth, solid steel spoke wrench designed and built to fit perfectly in your hand and provide years of every day service. A classic, and maybe your new favorite tool!

- **SW-20 (Black):** .127"
- **SW-22 (Red):** .136"

Packaged carded: SW-20C, SW-22C



Triple Spoke Wrench

SW-7

The precision sized SW-7 fits the three most popular spoke nipple sizes on the market. Sizes equal to SW-0, 1, 2. The SW-7 is nickel plated for years of service. Designed for the home mechanic.

Packaged carded: SW-7C



Adjustable Spoke Wrench

SW-10

The SW-10 Adjustable Spoke Wrench helps remove tight (stubborn) or rounded nipples. Hardened, nickel plated investment casting gives superior strength and durability. Fits any of the 80 gauge sizes listed for SW-0 through SW-2.



Tire Lever Set **TL-4**

Wide and flat, compact and lightweight, the perfect take-along lever. The TL-4 is just the right size to stash in a bag or jersey pocket yet strong enough to remove some of the toughest tires, including most tubeless tires. Sold in pairs carded or in a retail countertop display box.

Packaged carded: TL-4C
Display box (25 qty): TL-4



Heavy Duty Steel Tire Lever Set **TL-5**

The TL-5 Heavy Duty Tire Lever Set is designed for use on the toughest tire and rim combinations. Made of forged steel, these beefy levers are a full 8" (20.3 cm) long for superior leverage. Specially designed tip engages tire bead so it can be removed with just two levers. Ideal for difficult to remove downhill and freestyle tires. Set of two.

Packaged carded: TL-5C



Tire Lever Set **TL-1**

Sold in sets of three, Park Tool Tire Levers are made of nylon to ensure long life and damage-free operation. The unique design of the TL-1 actually lifts the tire away from the rim and keeps the tube from being pinched. These blue levers are available carded (TL-1C), or in a 25-set counter display.

Packaged carded: TL-1C
Display box (25 qty): TL-1



Tire Seater **PTS-1**

This tool is designed to quickly and easily "seat" stubborn tires. During inflation, tire beads often slip below the rim edge and are difficult to pull out. Simply place the non-slip jaws on the tire and lift out. The Park Tool Tire Seater adjusts to various tire widths. It's chrome plated and the handles are vinyl coated for comfort.

Shop Tire Tool **TL-10**

Install **and** remove! The heavy duty TL-10 Shop Tire Tool quickly and easily removes almost any bicycle tire (20" and larger) from the rim and then mounts the tire with the same ease. The TL-10 simply hooks under the tire bead and then rotates around the rim to completely dismount the tire. To mount the tire, attach the installation portion of the tool and again just rotate around the rim. Save time with each tire repair you perform. Not a take-along tire lever, the TL-10 is a heavy-duty tire tool designed for use in the shop.



Tire & Tube Repair Kit**TR-1**

Our popular GP-2 Super Patch Kit and TL-1 Tire Levers packaged together as a kit. Three Tire Levers and a box with six patches and one piece of sandpaper on a blister card.

Packaged carded: TR-1C

**Vulcanizing Patch Kit****VP-1**

The VP-1 Patch Kit includes six thin and flexible patches with tapered edges to blend with the tube's profile. Four round patches are 25mm in diameter for smaller holes. Two oval patches, 25mm x 35mm, are for wider cuts. A tube of self-vulcanizing fluid bonds the patch to the tube at the molecular level. Each kit is packaged in a small plastic box with sandpaper for cleaning the tube and instructions. Available individually carded or in a handy 36 kit countertop display.

Packaged carded: VP-1C

Display box (36 qty): VP-1

**Pre-Glued Super Patch Kit****GP-2**

One of our most successful products ever! We worked with 3M to produce a self-adhesive tube patch that stretches, flexes, twists, and turns right along with the tube. No messy glue, no bulky packaging. Lightly roughen tube with the included sandpaper, clean, apply patch, and you're ready to go. Six patches with sandpaper in a neat little carry along box. Available individually carded (GP-2C) or in a handy 48 kit countertop display.

Packaged carded: GP-2C

Display box (48 qty): GP-2

**Emergency Tire Boot****TB-2**

The fastest, easiest, and most secure way to repair a cut or worn tire sidewall. The TB-2 is produced using a strong, waterproof vinyl membrane with fiber weave reinforcement to keep the inner tube in place. A super strong pressure sensitive adhesive assures the 76mm x 44mm boot stays in place in any tire, road or mountain, high or low pressure. A true ride saver.

Packaged carded: TB-2C





Professional Mechanic Floor Pump

PFP-4

The PFP-4 is a heavy duty floor pump, packed with features and built for years of dependable service.

- Smooth operating aluminum barrel
- Alloy thumb lock lever
- Dual head fits both Presta and Schrader valves
- Molded base with aluminum inserts
- Oversized, ergonomically-designed handle with "soft touch" rubber grips
- Top-mounted, industrial quality, brass pressure gauge
- Extra long, high pressure hose
- Ball inflating needle



Home Mechanic Floor Pump

PFP-3

The PFP-3 is a high performance, feature-packed pump at a great price. Perfect for the home mechanic.

- Smooth operating steel barrel
- Composite head fits Presta, Schrader, and Dunlop valves without switching internal parts
- Thumb lock creates an air-tight seal
- Industrial quality brass pressure gauge
- Gauge is mid-mounted for easy reading
- Reinforced high pressure hose
- Stable three-point composite base
- Includes inflating needle

Pocket Protector Micro Pump **PMP-3**

This super small micro pump fits in just about any bag, jersey pocket or mounts directly to the frame. Ideal to take along when space and weight are an issue. It's small but it works like a champ with either Presta or Schrader valves. Aluminum barrel with a locking dual head and soft touch, dual density, flip out handle. (Max. pressure: 100 psi / 7 bars)



Half-Pint Mini Pump **PMP-4**

Just small enough to carry or clip on to the bike and just big enough to pump efficiently the PMP-4 dual head mini pump is built like all our tools - solid! All aluminum barrel construction ensures long life and smooth operation. Soft touch grips and a flip-out handle make it easy on the hands. The PMP-4 is Presta and Schrader valve compatible and includes mounting hardware. (Max. pressure: 90 psi / 6 bars)



Expands from 17" (43cm) = 47cm frame to 22" (56cm) = 62cm frame

Dial Adjust Frame Pump **PMP-5**

One size does fit all. A full-length frame pump that securely locks into nearly any frame. The PMP-5 quickly adjusts (no tools needed) to fit small to large size frames so riders can use one pump for multiple bikes and retailers can stock just one frame pump. All aluminum barrel construction ensures long life and fluid operation. The PMP-5 is Presta and Schrader valve compatible and features a dual density, soft touch flip-out handle for smooth, comfortable pumping. One pump, multiple bikes, fast and easy! (Max. pressure: 160 psi / 11 bars)

Patent pending



Tool Roll **BTR-1**

Ride saving essentials in a tight tool roll, perfect for just about any rider. The BTR-1 features the essential tools needed to fix a flat and make trail or roadside adjustments wrapped in a well-organized, protective tool roll. Just the right size to slide into most medium to large sized saddle bags and wedge packs. The BTR-1 includes the following:

- Cordura tool roll with cinch strap
- GP-2 Pre-Glued Patch Kit
- PMP-3 Pocket Protector Micro Pump
- TL-4 Tire Lever Set
- IB-1 I-Beam Fold-up Tool Set
- TB-2 Emergency Tire Boot
- High pressure inflation gauge





Bench Top Small Parts Holder **JH-1**

A great place to keep small parts, cable end caps, grease, and whatever else you can think of. Stainless steel construction with a clear acrylic hinged top and four removable bins. 12" x 5.5" x 3.5" (30.5cm x 14cm x 9cm)

Magnetic Parts Bowl **MB-1**

This bench top accessory keeps small parts accessible and all in one place. 6" (15cm) in diameter and featuring an extra strong magnet, the MB-1 is available only in world famous Park Tool Blue.



Hacksaw **SAW-1**

All aluminum die cast frame construction, blade tension adjuster and comfortable handle make this the perfect hacksaw for the shop. SAW-1 includes one blade and accepts any 12" (300mm) hacksaw blade.



Shop Hammer **HMR-2**

The perfect shop hammer! Designed and built specifically for bicycle work, the HMR-2 features a unique, two-sided head with both a steel and rubber striking surface, a reinforced fiberglass handle shaft, and a soft, comfortable molded handle. Sometimes a hammer is the perfect tool!



12" Adjustable Wrench **PAW-12**

Big and powerful, the PAW-12 (12") is forged from carbon steel, chrome plated, and features a comfortable vinyl dipped handle. Jaws open to 36mm and feature a laser engraved measurement scale.



Utility Knife **UK-1**

It folds, it cuts, it hangs on your belt and best of all...it's blue. Perfect for the shop, garage, toolbox or saddlebag. The UK-1 is a combination of aluminum and stainless steel and uses readily available hardware store utility knife blades. It also features a secure, quick-change blade system that locks open and closed.

Packaged carded: UK-1C



Tape Measure **RR-12**

Small and handy, the RR-12 features a tough, composite housing and both Metric and English readings up to 12 feet (3.65 M).

Packaged carded: RR-12C



Screwdrivers **SD-0 • SD-2 • SD-3 • SD-6**

Shop quality screwdrivers designed for comfort and durability. Featuring dual density grips and heat-treated, chrome vanadium tips and shafts.

- SD-0: #0 Phillips • SD-2: #2 Phillips • SD-3: 3mm flat blade
- SD-6: 6mm flat blade

Shop Screwdriver Set **SD-SET**

All four of our shop grade screwdrivers in one handy set.

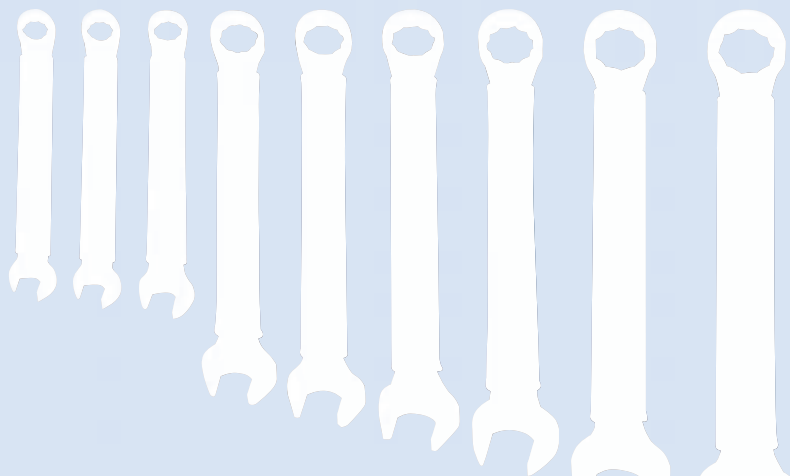

Metric Wrench Set **MW-SET**

World famous ParkTool quality wrapped up in a great set of metric combination wrenches. The MW-SET includes 6mm to 15mm 12-point box/open end wrenches. Forged from chrome vanadium steel, chrome plated, meticulously polished, then center dipped in ParkTool blue vinyl for a positive grip. Strong, comfortable, and beautiful!



Digital Scale **DS-1**

A versatile digital scale built to accurately weigh bikes, frames, and components. Uniquely designed to be clamped solidly into a repair stand or hung from a hook or branch. Measures in pounds to the ounce and kilograms to the hundredth. Includes a dual position, silicone coated hanging hook.

Tabletop Digital Scale **DS-2**

Complimented a Gram Scale, this highly accurate tabletop scale is perfect for weighing small parts and components in grams or ounces.

- Accurate to within 2g/ 1000g, 2g/ 2000g, 3g/ 3000g
- Tare feature to exclude weight of container
- Switches easily between grams and ounces
- 3000 gram (106 oz) capacity
- Battery included



Digital Caliper **DC-1**

Accurately measure seat posts, head tubes, bearings, spoke diameters and just about anything else you can think of. The DC-1 is precision made instrument built with stainless steel mechanisms and a rugged ABS composite body. The tool's ability to measure in inch fractions as well as metric and decimal standard makes it an indispensable shop tool.

Features:

- Large LCD display
- Display metric, decimal standard and fractional standard to 1/128"
- Measures external, internal, depth and stepped dimensions
- Resolution: +/- 0.01mm/0.0005"/1/128"
- Accuracy: +/- 0.02mm/0.001 (-100mm)
- Repeatability: +/- 0.01mm/0.0005"
- Protective case and battery included



Professional Tool Kit **PK-63**

Designed as a "do it all" kit for the home mechanic or as a solid starter kit for the professional shop mechanic, the PK-63 is a very special 63-piece collection of our very finest shop tools. While it includes the tools needed to perform almost any basic repair or adjustment on the bike, the PK-63 also includes the specialty tools to perform many advanced repair tasks, such as installing and removing headset races, installing crown races, cutting fork steerer tubes, straightening derailleur hangers, tapping threaded frame braze-ons, dishing wheels, and more. The entire kit comes in a tough, oversized toolbox, which has plenty of extra room for additional tools and spare parts.



Portable Race / Ride Kit **RK-41**

A custom built backpack that transforms into a portable workstation right before your eyes. We've built the ultimate event kit using the latest backpack technology and the best tools available.

- Secure tool holders, pockets and straps specifically designed to hold and transport the most used tools.
- A large, open interior with a variety of extra utility pockets and flexible compression netting designed to secure odd shaped items.
- Ingenious fold out interior creates a convenient tool board that makes it easy to set up a workstation at any race, ride or home workshop.
- Padded shoulder straps and waist belt distribute the weight evenly and make transport a breeze.
- Forty-one Park Tool brand specialty and general hand tools, designed to tackle a huge variety of mechanical and maintenance procedures.

Backpack Workstation **BW-1**

Same great backpack as the RK-41 without the tools. Choose your own set, or fill the BW-1 with tools you already own.

Patent Pending



Advanced Mechanic Tool Kit **AK-37**

Designed specifically for the home mechanic who wants the best, the AK-37 Advanced Mechanic Tool Kit is a special 37-piece collection of our finest “shop quality” tools, all packaged in a tough tool box. The AK-37 includes all the most frequently used tools, as well as some items a mechanic should not be without—basically, everything needed to perform most repair and maintenance tasks, from brake adjustments to headset overhauls, on the majority of current model bikes.



Home Mechanic Starter Kit **SK-1**

A great way to start a tool collection! The perfect combination of tools to help the novice home mechanic clean, adjust, maintain and do some basic repairs on their bike. The SK-1 includes eleven genuine Park Tool products plus a custom Park Tool toolbox.

Essential Tool Kit **WTK-1**

Designed for the casual cyclist, the economical WTK-1 contains the tools needed for many basic adjustments and repairs at home or on the road. Includes: 3, 4, 5, 6mm hex wrenches; tire levers; patch kit; straight blade screwdriver, and a small adjustable wrench—all housed in a compact, ready-to-go tool wallet.

Packaged carded: WTK-1C

www.parktool.com

Master Mechanic Tool Set MK-187

Big Kahuna, The Real Deal, Big Ticket, The Chief, El Grande, Fat Cat, The Grand Poobah, All The Marbles, The Real Mac Daddy, The Big Show, The King, The Whole Shootin' Match... Whatever you call it, this is it! The tool set... to end all tool sets. Pretty much anything and everything we could think of is included in this collection. Designed for the professional, full service mechanic the MK-187 is a complete set of professional level tools, fixtures, gauges, and accessories. The perfect way to start a repair business, open or expand a bike shop, or create the ultimate home workshop. Over 187 shop quality tools from the only company in the world capable of such a feat. Tool Envy. It's a beautiful thing!



Park #	Tool	SK 1	AK 37	RK 41	PK 63	MK 187
690-XL	Facing Cutter For Low Profile Headsets - For HTR-1					X
750	Centering Cone Adapter - For HTR-1					X
754	33.8mm (1-1/8") Reamer - For HTR-1					X
768	43.8mm Pilot - For HTR-1					X
769	Head Tube Reaming Extension - For HTR-1					X
ASC-1	Anti-Seize Compound, 4 oz.					X
AV-1	Axle Vise					X
AV-4	Heavy Duty Axle and Pedal Vise					X
AW5-1	Hex Wrench Set, 4, 5, 6mm	X	X	X		X
AW5-3	Hex Wrench Set 2, 2.5, 3mm		X			X
AW5-10	Hex Set, 1.5, 2, 2.5, 3, 4, 5, 6mm			X		X
AW5-12	Fold-up Metric/Fractional Hex Wrench Set					X
BBT-4	Bottom Bracket Tool - for 6- notch Campagnolo		X	X		X
BBT-5	Bottom Bracket/ Cassette Locking Tool for Campagnolo (12-tooth)		X	X	X	X
BBT-7	Locking Wrench - XTR and Dura Ace					X
BBT-9	Bottom Bracket Tool - Hollowtech II 16-notch external bearing cups		X	X	X	X
BBT-18	Bottom Bracket Tool for 8-notch Shimano and Isis drive		X	X	X	X
BBT-19	Bottom Bracket Tool - (with 3/8" drive) for 16-notch external bearing cups					X
BBT-22	Bottom Bracket Tool for 30-tooth splined Shimano and Isis drive		X	X	X	X
BBT-39	BB Bearing Tool Set					X
BCB-4	Bike Cleaning Brush Set					X
BFS-1	Bottom Bracket Facing Set					X
BO-2	Bottle Opener					X
BT-2	Fourth Hand Brake Tool					X
BTS-1	Bottom Bracket Tapping and Facing Set					X
CBW-1	Open End Wrench, 8/10mm		X	X	X	X
CBW-4	Open End Wrench, 9/11mm		X	X	X	X
CC-2	Chain Checker					X
CC-3	Chain Wear Indicator		X			X
CCP-22	Crank Puller					X
CCP-44	Crank Puller					X
CCW-5	Crank Bolt Wrench, 14mm and 8mm		X	X	X	X
CL-1	Synthetic Blend Chain Lube: 4 oz. (118 mL)		X	X	X	X
CM-5	Cyclone Chain Scrubber		X	X	X	X
CN-10	Cable & Housing Cutter		X	X	X	X
CNW-2	Chaining Nut Wrench		X	X	X	X
CRC-1	Crown Race Cutting Tool					X
CRP-1	Universal Crown Race Puller					X
CRS-1	Crown Race Setting System					X
CRS-15	1.5" Crown Race Setting System					X
CT-3	Screw Type Chain Tool		X	X	X	X
CT-4	Master Chain Tool					X
CT-5	Mini Chain/Brute Chain Tool		X			X
CT-7	Screw Type Chain Tool - For BMX and Freestyle					X
CTP	Replacement Chain Tool Pin					5
CWP-7	Universal Crank Puller and 8mm Wrench		X	X		X
DAG-2	Deraillleur Hanger Alignment Gauge					X
DC-1	Digital Caliper					X
DCW-1	Cone Wrench, 13/14mm			X		X
DCW-2	Cone Wrench 15/16mm			X		X
DCW-3	Cone Wrench 17/18mm			X		X
DCW-4	Cone Wrench, 13/15mm			X		X
DS-1	Digital Scale					X
DS-2	Tabletop Digital Scale					X
DT-1	Disc Mounting Facing Tool					X
Park #	Tool	SK 1	AK 37	RK 41	PK 63	MK 187
DT-2	Rotor Truing Fork					X
DT-3	Rotor Truing Gauge					X
FAG-2	Frame Alignment Gauge					X
FFG-2	Frame and Fork End Alignment Gauge Set					X
FFS-2	Frame and Fork Straightener					X
FR-1	Freewheel Remover: Shimano, Sachs Aris, Sun Race					X
FR-2	Freewheel Remover: Sun Tour 2 Notch					X
FR-3	Freewheel Remover: Sun Tour 4 Notch					X
FR-4	Freewheel Remover: Atom, Regina, splined Zeus					X
FR-5	Cassette Locking Tool for Shimano, SRAM etc.		X	X	X	X
FR-5G	Cassette Locking Tool with Guide Pin					X
FR-6	Freewheel Remover: BMX Freewheels with 13/24 TPI					X
FR-7	Freewheel Remover: Falcon					X
FR-8	Freewheel Remover: BMX Freewheels with 30x1mm threads					X
FRW-1	Freewheel Remover Wrench					X
FTS-1	Fork Threading Set					X
GP-2	Super Patch Kit					X
GSC-1	Gear Clean Brush		X	X	X	X
HBH-2	Handlebar Holder					X
HCW-4	Box-End 36mm and Bottom Bracket Pin Spanner					X
HCW-5	Double-sided Bottom Bracket Locking Hook Spanner					X
HCW-7	30mm and 32mm Head Wrench					X
HCW-9	36mm and 40mm "Oversize" Head Wrench					X
HCW-11	16mm "Slotted" and "Raised" Adjusting Cup BB Wrench					X
HCW-15	36/32mm Headset Wrench					X
HCW-16	Chain Whip/ 15mm Pedal Wrench					X
HHP-2	Bearing Cup Press					X
HMR-2	Shop Hammer					X
HR-10	Hex Wrench: 10mm					X
HR-12	Hex Wrench: 12mm					X
HR-14	Hex Wrench: 14mm					X
HT-6	Hex Tool: 6mm					X
HT-8	Hex Tool: 8mm					X
HT-10	Hex Tool: 10mm					X
HTR-1	Head Tube Reaming and Facing Set					X
HW-2	Professional Headset Locknut Wrench 32mm and 36mm					X
ISC-4	Internal Seat Tube Clamp: 25mm and up					X
JH-1	Bench Top Small Parts Holder					X
KS-1	Kickstand Tool					X
MB-1	Magnetic Bowl					X
MLP-1	Master Link Pliers					X
MW-Set	Metric Wrench Set					X
PAW-12	Adjustable Wrench: 12"					X
PH-1	P-Handled Hex Wrench Set w/ Holder (Set of 8)					X
PH-11	P-Handled Hex Wrench: 11mm					X
PH-12	P-Handled Hex Wrench: 12mm					X
PH-T25	P-Handled T25 Wrench					X
PH-T11	P-Handled Star-Shaped Wrench Set					X
PP-1	Hydraulic Brake Piston Press					X
PPL-1	PolyLube 1000 Lubricant, 4 oz.		X			X
PPL-2	PolyLube 1000 Grease in one pound tube					X
PTS-1	Tire Seating Tool					X
PW-3	Pedal Wrench					X
PW-4	Professional Pedal Wrench					X
PW-5	Home Mechanic Pedal Wrench		X			X
RR-12	Tape Measure					X
RT-1	Headset Cup Remover					X
RT-2	Steering Race Remover					X
SA-3	Heavy Duty Shop Apron					X
SAW-1	Hack Saw					X



Rescue Tool **MTB-3**

The MTB-3 Rescue Tool is a premium quality multi-tool with the design and innovative features you'd expect from the top name in bicycle tools. Small and light enough to slip into a pocket or seat pack, the MTB-3 contains 22 tools, each carefully selected for nearly any repair on the road or trail. Manufactured to the highest standards, all tools are finely polished stainless steel or nickel plated steel. Unique three-piece design (patent # 6,622,329) makes each tool easy to access and easy to use. Super tough nylon handles provide excellent grip when using tools. Includes nylon carrying case with embroidered Park Tool logo.

Tools included:

- Chain tool
- Tire levers (2)
- Phillips head screwdriver
- Straight blade screwdriver
- T25 Torx® compatible star-shaped driver
- 1.5, 2, 2.5, 3, 4, 5, 6, & 8mm hex wrenches
- 8, 9, and 10mm box end wrenches
- Bottle opener
- .127", .130", & .136" spoke renches
- Pedal wrench
- Serrated knife

Packaged carded: MTB-3C



Rescue Tool **MTB-7**

An outstanding value, the quality MTB-7 Rescue Tool is packed with 21 useful tools for emergency repairs on the road or trail. Includes nylon carrying case with embroidered Park Tool logo. Tools included:

- 2, 2.5, 3, 4, 5, 6, & 8mm hex wrenches
- Tire levers (2)
- Phillips head screwdriver
- Straight blade screwdriver
- T25 Torx® compatible star-shaped driver
- .127", .130", & .136" spoke wrenches
- 8, 9, & 10mm box end wrenches
- Chainring nut wrench
- Dust cap remover
- Serrated knife
- Bottle opener

Packaged carded: MTB-7C

www.parktool.com

Torx® is a registered trademark of Acument Intellectual Property, LLC



I-Beam Mini Fold-Up with Chain Tool **IB-3**

A complete take-along tool combining our award winning I-Beam technology with a full complement of emergency tools. The IB-3 includes all the tools included in the IB-2 plus a composite wrapped tire lever, spoke wrenches and a 10-speed compatible chain tool. A portable workshop designed to get you back on the bike!

Packaged carded: IB-3C

Park Tool Fold Up Hex Wrench Sets use a multi-position composite handle that is comfortable, lightweight, slip-resistant, and 40% stronger than steel handles. Hexes are made from Bondhus Protanium industrial tool steel, through hardened and tempered for long life.



I-Beam Mini Fold Up Hex Wrench/Screwdriver Set

IB-1

Perfect for taking on rides, the strong, compact, lightweight IB-1 features our unique I-Beam handle surrounded by 3, 4, 5, 6 and 8mm hex wrenches and a straight blade screwdriver.

Packaged carded: IB-1C

Torx® Compatible Star-Shaped Driver Set

TWS-2

The TWS-2 includes the star-shaped wrench sizes currently being used on components such as disc brakes, pedals and chain rings (T7, T9, T10, T15, T20, T25, T27, T30 and T40) in a convenient fold-up set.

Packaged carded:
TWS-2C



AWS-12

2mm, 3mm, 4mm, 5mm, 6mm, 3/16", 7/32", & 1/4" Hex Wrench Set

Packaged carded:
AWS-12C



I-Beam Mini Fold Up Hex Wrench /Screwdriver/Star Driver Set

IB-2

The IB-2 features our unique I-Beam handle with 1.5, 2, 2.5, 3, 4, 5, 6, & 8mm hex wrenches; a T25 Torx® compatible star-shaped driver; and a straight blade screwdriver. Strong, compact, and lightweight, the IB-2 is a great tool for taking on the road or trail.

Packaged carded: IB-2C

AWS-11

3mm, 4mm, 5mm, 6mm, 8mm, & 10mm Hex Wrench Set

Packaged carded:
AWS-11C



Multi-Tool

MT-1

The MT-1 is a high quality multi-tool that is uncomplicated, easy to use, and effective. Made of investment cast steel and electroless nickel plated for durability, the MT-1 features 3mm, 4mm, 5mm, 6mm, and 8mm hex wrenches; 8mm, 9mm, and 10mm socket wrenches; and a straight blade screwdriver. Each of the nine tools is carefully positioned so the MT-1 can be effectively used on those "tough to get to" nuts, bolts, and screws.

Packaged carded: MT-1C

AWS-10

1.5mm, 2mm, 2.5mm, 3mm, 4mm, 5mm, & 6mm Hex Wrench Set

Packaged carded:
AWS-10C



AWS-9

4mm, 5mm, and 6mm Hex Wrench Set with Phillips and straight blade screwdrivers

Packaged carded:
AWS-9C



FREE CUSTOMIZING

Ask your distributor about our custom laser-engraving program. Your shop name or logo permanently engraved for free on IB-1 and IB-2 I-Beam Tools or UK-1 Utility knife with a qualifying order.



Torx® is a registered trademark of Acument Intellectual Property, LLC

www.parktool.com





P-Handled Hex Wrench Set with Bench Mount / Wall Mount Wrench Holder

PH-1

These thoughtfully designed P-handled hex wrenches fit the task at hand, as well as they fit in your hand.

The long shaft of each wrench is fitted with a Bondhus Balldriver for those hard to reach bolt heads.

The short end of the wrench is neatly chamfered and extends from the handle for use when fully tightening bolts in high torque applications.

Shaft lengths are optimally selected to minimize the wind-up and flex experienced with longer wrenches. The hex wrenches are made from high torque industrial steel and through hardened for long life. Special "speed bearing" attachment facilitates installation and removal of long-threaded socket head bolts and nuts. The offset P-handles are made from a durable nylon material and are ergonomically-designed for comfortable use. All the wrenches fit neatly in the included bench mount/wall mount holder. The PH-1 set includes 2, 2.5, 3, 4, 5, 6, 8 and 10mm sizes.

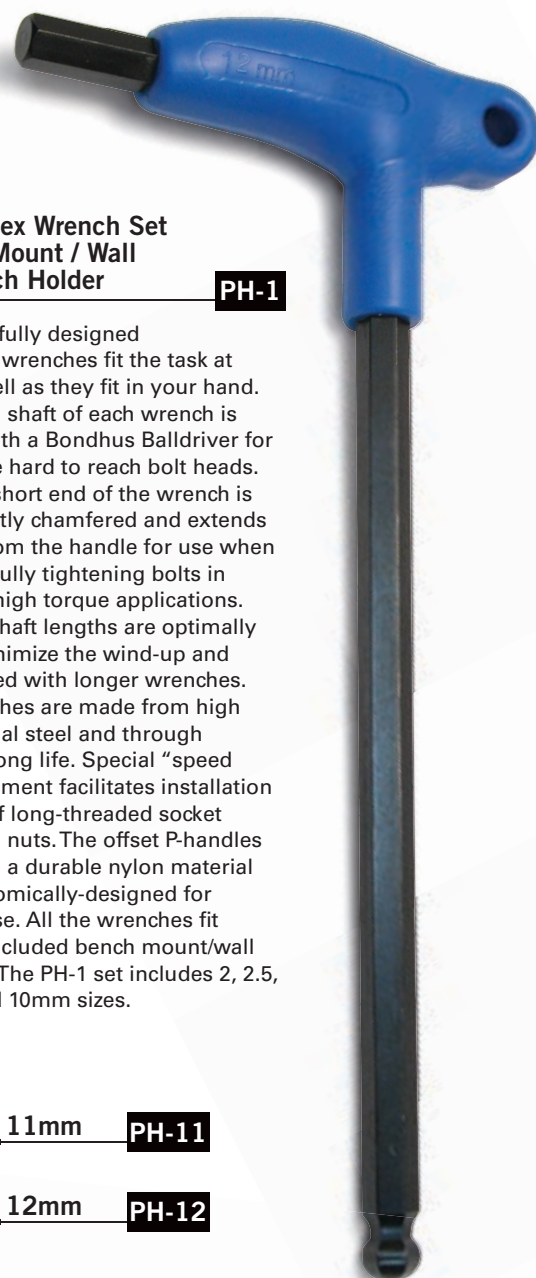

Individual sizes available separately

2mm	PH-2	3mm	PH-3	5mm	PH-5	8mm	PH-8	11mm	PH-11
2.5mm	PH-2.5	4mm	PH-4	6mm	PH-6	10mm	PH-10	12mm	PH-12

P-Handled Torx® Compatible Star Shaped Driver Set **PH-T1**

A complete set of Star-shaped wrenches to fit Torx®-style fasteners, the PHT wrenches feature our proprietary "P" handles, designed for comfort, control and leverage. Made from high torque industrial steel and through hardened for long life, the set of eight includes a wall/bench top tool holder and the following sized wrenches: T6, T8, T10, T15, T20, T25, T30 and T40.

Individual sizes available separately

6mm	PH-T6	8mm	PH-T8
10mm	PH-T10	15mm	PH-T15
20mm	PH-T20	25mm	PH-T25
30mm	PH-T30	40mm	PH-T40



Torx® is a registered trademark of Acument Intellectual Property, LLC

NEW



Professional L-Shaped Hex Wrench Set **HXS-1**

The same shop quality L-shaped hex wrenches as the HXS-2, but without the bench mount/wall mount holder.

8mm Hex Wrench **HR-8**

A long-handled L-shaped wrench for installing and removing crank bolts with an 8mm socket. Made from industrial quality high torque steel and through hardened for long life. "Speed Bearing" attachment for quick installation and removal of long threaded bolts.

Packaged carded: HR-8C

11mm, 12mm & 14mm Hex Wrenches **HR-11 • HR-12 • HR-14**

11mm, 12mm, and 14mm hex wrenches are necessary for removing the freehub bodies from several popular brands of hubs (Mavic, Sun Race, Sovos, and others). ParkTool HR-11, HR-12, and HR-14 are through hardened industrial quality steel with chamfered tips for a precision fit.



Professional L-Shaped Hex Wrench Set with Holder **HXS-2**

These shop quality L-shaped hex wrenches have a genuine Bondhus balldriver tip on the long arm (excluding 8 and 10mm) for hard to reach bolt heads and a straight tip on the short arm for high torque applications. Wrench tips are precision chamfered for a clean, tight fit. Special "speed bearing" attachment facilitates installation and removal of long-threaded bolts. Wrenches are made from industrial quality Bondhus Protanium high torque steel through hardened for long life. Set includes 2, 2.5, 3, 4, 5, 6, 8, and 10mm sizes. Bench mount/wall mount holder keeps wrenches organized and is fan-shaped for easy access to all wrench sizes.



Hex Tools **HT-6 • HT-8 • HT-10**

Specially designed for cranks, free hubs and pedals the HT tools are built for speed, leverage and comfort. Our dual density, ergonomically designed screwdriver handle molded over an extra long, extra deep, super strong hex. It may be your new favorite tool!

HT-6 6mm **HT-8** 8mm **HT-10** 10mm

Three-Way Hex Wrench Sets

Park Tool introduced the bicycle world to the three-way hex wrench set over 25 years ago. Updated in 2007, the AWS-1 and AWS-8 have color-coded hex wrenches that allow sizes to be quickly identified, as well as a redesigned center handle that fits perfectly in the palm of the hand. Hexes are made from Bondhus Protanium industrial steel and are through hardened and tempered for long life.

AWS-1

4mm, 5mm, & 6mm Hex Wrench Set.

Packaged carded: AWS-1C

AWS-3

2mm, 2.5mm, & 3mm Hex Wrench Set.

Packaged carded:
AWS-3C

AWS-8

4mm, 5mm, & 6mm
Hex Wrench Set with
balldriver tips.

Packaged carded: AWS-8C

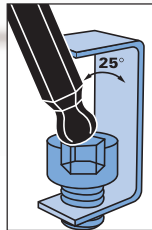

3-Way Socket Wrench ST-3

The three most common bolt and nut sizes are combined with the classic Park Tool 3-way "Y" body. 8mm, 9mm, and 10mm forged chrome vanadium steel sockets.

Packaged carded: ST-3C

Y Wrench Belt Holster YBH-1

Your favorite tool always by your side, ready for action. The YBH-1 has a perfectly formed pocket so your trusty Y wrench is always handy without getting in the way. Clips right on your waistband, belt or pocket and works with any of our 3-ways except models with an aluminum center body.

Packaged carded: YBH-1C





Sprocket Remover / Chain Whip **SR-1**

This combination chain whip and freewheel / locking remover wrench is heat treated to prevent bending and flexing. It also features hardened pins to keep the chain in place and a comfortable handle. Hex opening fits ParkTool freewheel removers.



Sprocket Remover / Chain Whip **SR-2**

This shop quality chain whip gives you incredible leverage without worry of slippage. Heavy duty, heat treated head with a round vinyl coated handle. Hardened bolts hold securely and make chain replacement easy.

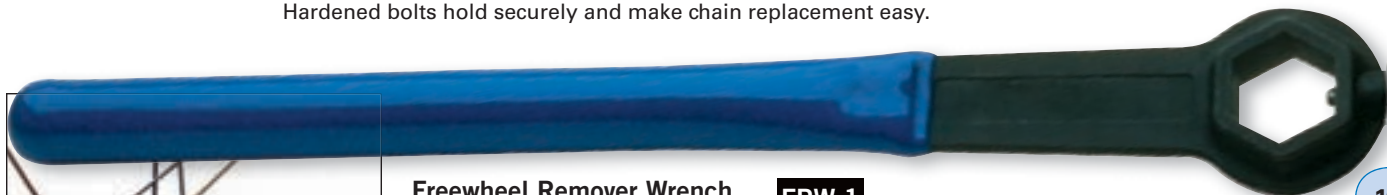

Freewheel Remover Wrench **FRW-1**

This tool securely holds freewheel and locking tools (FR-1 through FR-8) for removal and installation. Features an investment cast head and a long, round, vinyl dipped handle for superior leverage.



Chain Whip / 15mm Pedal Wrench **HCW-16**

A great combination for the home or traveling mechanic.



Freewheel Removers

FR-1 through FR-8

Heat treated alloy steel, one inch base fits wrench or bench vise. Thin wall construction allows use without removal of cones and locknuts.

Packaged carded: FR-1C through FR-8C, BBT-5C

FR-1

Fits Shimano, Sachs Aris, and Sun Race freewheels.



FR-2

Fits SunTour two-notch freewheels. Not recommended for SunTour four to six notch freewheels.



FR-3

Fits all SunTour four-notch freewheels since 1986.



FR-4

Fits Atom, Regina, splined Zeus, and some Schwinn Approved freewheels.



FR-5

Fits Shimano, SRAM, SunRace, SunTour, Chris King and other cassette lockrings. Also fits some Shimano disc brake lockrings.



FR-6

Removes four-notch BMX / single-speed freewheels from hubs with 1.37 x 24TPI threads.



FR-5G

Fits Shimano, SRAM, SunRace, SunTour, Chris King and other cassette lockrings. Also fits some Shimano disc brake lockrings. Guide pin stabilizes tool.



FR-7

Fits Falcon freewheels.



FR-8

Removes four-notch freewheels from "flip-flop" BMX hubs with 30 x 1mm threads.



BBT-5

Fits Campagnolo cassette lockrings and Campagnolo Record, Chorus, and Athena bottom brackets.



Shop Cone Wrenches SCW-13 through SCW-20 & SCW-22

The standard of the industry, Park Tool Shop Cone Wrenches are unmatched in quality and performance. The special "Y" head design puts more material where it's needed for strength and durability. Precision sizing and a military grade industrial phosphate finish ensure an accurate fit and consistent quality. Thin enough to use on the narrowest of adjusting cones, the SCW Shop Cone Wrenches have a long, vinyl dipped handle for leverage and comfortable use. Sizes 13mm to 20mm and 22mm.



Individual sizes available separately

13mm	SCW-13	14mm	SCW-14	15mm	SCW-15	16mm	SCW-16
17mm	SCW-17	18mm	SCW-18	19mm	SCW-19	20mm	SCW-20
22mm	SCW-22						

**Shop Cone Wrench Set SCW-SET**

The SCW-SET includes SCW-13 to SCW-19

28mm Cone Wrench (Shimano 20mm Through Axle Hub)

SCW-28

**Double-Ended Cone Wrenches DCW-1 through DCW-4**

These cone wrenches are designed for the home mechanic or occasional user. They're made of thin steel and are nickel plated and heat treated for long use. Available in four popular sizes from 13mm to 18mm. Their small size makes them ideal to carry along for quick repairs.

Packaged carded: DCW-1C through DCW-4C

13mm & 14mm	DCW-1	15mm & 16mm	DCW-2
17mm & 18mm	DCW-3	13mm & 15mm	DCW-4

**Axle Vise AV-1**

This tool holds the axle so it will not turn while work is done on the hub. It has two different diameter receptacles so it will work on front and rear axles. It is simple to use - just insert the axle into the proper diameter opening and tighten the bench vise. The jaws will open automatically when the vise is opened.

**Heavy Duty Axle & Pedal Vise AV-4**

Designed to securely hold 5/16" to 9/16" axles for easy wheel hub and pedal adjustments, the AV-4 is a must for every mechanic's workbench. Just insert axle into one of the three precision-machined openings and tighten in a bench vise. The AV-4's bridge spring keeps the jaws aligned and allows the tool to automatically open when the bench vise is opened. Aluminum jaws won't damage axle threads.





TW-1



TW-2

Torque Wrenches

TW-1 • TW-2

To prevent over tightening and under tightening of bolts and nuts, specific torque specifications are provided by bicycle component manufacturers. Park Tool Beam-Type Torque Wrenches are easy to use, simple to re-calibrate, and accurately measure the amount of torque being applied to a bolt or nut.

- TW-1: 1/4" drive with 3/8" adaptor
0 - 7 Newton Meter range (0 - 60 Inch Pounds)
- TW-2: 3/8" drive
0 - 70 Newton Meter range
(0 - 600 Inch Pounds)



TW-5



TW-6

Ratcheting "Click-Type" Torque Wrenches

TW-5 • TW-6

High quality, ratcheting torque wrenches to quickly and accurately measure and apply the proper amount of torque to components and accessories. The TW-5 and TW-6 feature a dial-adjust "click" system to preset the desired torque setting.

TW-5 Small Clicker

- Ratcheting 1/4" drive fitting with 3/8" adaptor
- 3-15 Newton Meter (26-132 inch pounds) range
- 19.5cm (7-1/2") length
- Protective case included

TW-6 Big Clicker

- Ratcheting 3/8" drive fitting
- 10-60 Newton Meter (88-530 inch pounds) range
- 38cm (15") length
- Protective case included

Socket & Bit Set

SBS-1

The SBS-1 is a complete, shop quality set of the most common 3/8" drive chrome vanadium sockets, hex bits and Torx® style bits. The set includes a convenient holder and the following tools:

- Sockets: 8, 9, 10, 11, 12, 13, 14, 15mm and 1" (fits various Park Tool freewheel, locking and bottom bracket tools)
- Hex bits: 3, 4, 5, 6, 8 and 10mm
- Torx® style bits: T25, T30 and T40





Bottom Bracket / Cassette Tool for Campagnolo

BBT-5

The BBT-5 fits 12-tooth internally splined Campagnolo bottom bracket cartridges and cassette lockrings.

Packaged carded: BBT-5C



Bottom Bracket Tool

BBT-18

The BBT-18 is a heavy duty, investment cast tool for installing and removing all Shimano, SRAM, and ISIS Drive eight-notch bottom bracket cups. 36mm wrench flats. Note: The BBT-18 replaces the previous model BBT-8.

Packaged carded: BBT-18C



Compact Bottom Bracket Tool

BBT-32

Economical and compact, this version of the BBT-22 tool is perfect for the home mechanic. The BBT-32 installs and removes Shimano and ISIS Drive 20-tooth splined bottom bracket cups and features 32mm wrench flats.

Packaged carded: BBT-32C

Bottom Bracket Tool

BBT-19

The BBT-19 is a heavy duty, shop quality tool for installing and removing Shimano, SRAM, Truvativ Giga X-Pipe and Howitzer, Race Face, FSA, and Campagnolo 16-notch external bearing bottom bracket cups. Made from investment cast steel, the BBT-19 can be turned with a 3/8" drive torque wrench, 3/8" ratchet driver, 1" wrench, or FRW-1 Freewheel Remover Wrench.

Packaged carded: BBT-19C



Bottom Bracket Tool

BBT-22

The BBT-22 is a shop quality tool for installing and removing Shimano and ISIS Drive splined 20-tooth bottom bracket cups. Made from investment cast steel, the BBT-22 utilizes a flat tooth profile to ensure maximum engagement with the bottom bracket cup. Can be turned with a 3/8" drive torque wrench, 3/8" ratchet driver, 32mm wrench, 1" wrench, or FRW-1 Freewheel Remover Wrench.

Note: The BBT-22 replaces the previous model BBT-2.

Packaged carded: BBT-22C



SPA-1

SPA-2

SPA-6

HCW-4

HCW-5

HCW-11

Pin Spanners

SPA-1 • SPA-2

ParkTool Pin Spanners have been designed to give maximum usefulness and versatility at the lowest possible cost. Tough, high carbon steel is used on each tool to ensure long life. Handle is vinyl coated to give a good grip. Each Pin Spanner is color coated for easy recognition.

Green SPA-1

Red SPA-2

Fits adjusting cup on most 3-piece cranks.

Fits one-key release dust caps and adjusting cone on most freewheels

Packaged carded: SPA-1C, SPA-2C

Adjustable Spanner

SPA-6

This spanner uses hardened, replaceable pins. Designed for heavy-duty use, the distance between pins is adjustable, allowing use on virtually any hanger cup.

Packaged carded: SPA-6C

Replacement Pins: 1501

Crank & Bottom Bracket Wrenches

HCW-4 • HCW-5 • HCW-11

Our popular and versatile Crank Wrenches feature our proven "Y" head design.

HCW-4

36mm box-end and bottom bracket pin spanner.

HCW-5

Double sided bottom bracket locking hook spanner.

HCW-11

Fits "slotted" bottom bracket adjusting cups and cups with "raised" 16mm wrench flats.

1501

Replacement pins for HCW-4.



Bottom Bracket Tool BBT-4

The BBT-4 is made for the installation and removal of 6-notch cartridge cups used on Campagnolo Veloce, Mirage, Centaur, Daytona and Avanti sealed cartridge bottom brackets. The handle is vinyl coated for comfort.

**Lockring Wrench BBT-7**

The BBT-7 Lockring Wrench is used for installing and removing the lockring used on Dura Ace 7700 and XTR 950 Bottom Brackets. It is laser cut and engages five of the lockring's six notches for a precise, secure fit. The handle is vinyl dipped for comfort. While made specifically to fit Dura Ace and XTR Lockrings, it also fits several other lockrings as well.

**Bottom Bracket Tool BBT-9**

The BBT-9 is used to remove and install 16-notch external bearing bottom bracket cups. One end of the BBT-9 securely engages the 16 notches of the bottom bracket cups, while the other end engages the 8 internal splines of the crank arm adjustment cap. Also fits Truvativ Giga X-Pipes and Howitzer, Race Face X-type, SRAM and FSA Mega EXO bottom bracket cups.

**Bottom Bracket Bearing Tool Set BBT-39**

Designed and built to install and remove BB30 bearings as well as install the bearings for the BB90 system. The BBT-39 set features two different bushing sets used in conjunction with the Park Tool HHP-1, 2 or 3 Cup Press to quickly and precisely press the bearings into the bottom bracket shell. The included BB30 bearing remover works from inside the shell to easily push out bearings.

NEW



Crank Puller **CCP-22**

A favorite of shop mechanics for over 30 years, the CCP-22 removes cranks using a square taper, Power Drive, or Power Spline bottom bracket interface. A long, comfortable, built-in handle and fine thread provide the leverage needed to remove even the tightest cranks. Designed with a rotating tip to ensure smooth operation and long life.

Packaged carded: CCP-22C



Crank Puller **CCP-44**

The CCP-44 is specifically designed to remove cranks using an Octalink or ISIS Drive bottom bracket interface. Uses a comfortable handle, fine thread, and a special rotating tip for superior leverage, smooth operation, and years of trouble-free service.

Packaged carded: CCP-44C

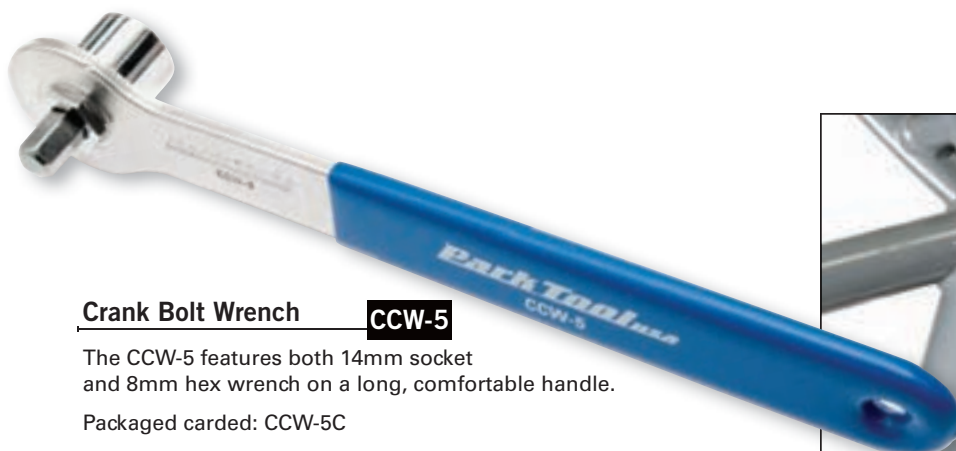

Crank Bolt Wrench **CCW-5**

The CCW-5 features both 14mm socket and 8mm hex wrench on a long, comfortable handle.

Packaged carded: CCW-5C



Single Speed Spanner **SS-15**

Designed and built especially for single speed bikes, the SS-15 is a forged, multi purpose ride saver. Just the right size and length (17cm/7") to take along or to wrench in the garage, the "SS" is destined to be a single speeders' favorite.

- 15mm socket - axle nuts
- 15mm open end - pedals
- Smooth, curved spoon tire lever
- Bottle opener

Packaged carded: SS-15C



Compact Crank Puller **CWP-7**

Includes two rotating tips (11.3mm and 16.3mm) and built in wrench flats allowing the tool to remove cranks using a square taper, Octalink, ISIS Drive, Power Drive or Power Spline bottom bracket interface.

Packaged carded: CWP-7C



Chainring Nut Wrench **CNW-2**

The CNW-2 makes chainring bolt set installation and removal easy. It securely holds the slotted nut to prevent spinning when tightening or loosening the bolt. Double-ended to fit most slotted-type nuts.

Packaged carded: CNW-2C





Pedal Wrench PW-3

Made from Cro-Moly steel for a shop quality pedal wrench made to last. 15mm and 9/16" precision openings and a long, round, vinyl dipped handle that won't dig into your hand like flat pedal wrenches.



Professional Pedal Wrench PW-4

The PW-4 Professional Pedal Wrench is designed for heavy shop use. Two 15mm wrench openings are oriented at 30 degree and 45 degree angles so the user can always achieve the best mechanical advantage, regardless of the pedal position. An oversized, asymmetrical head is made from Cro-Moly steel for superior strength and durability. While strong, the PW-4 is thin enough to access all wrench flats. An extra long 14" handle provides the leverage to remove even the tightest pedals. The handle is round and vinyl dipped so it won't dig into the hand like flat wrenches.



Home Mechanic Pedal Wrench PW-5

Designed for the do-it-yourself mechanic or rider, the PW-5 is perfect to take along or for the home workshop. Although economically priced, this 15mm pedal wrench, like all Park Tool products is built to last. Made from heat-treated spring steel and vinyl dipped for comfort, the PW-5 is 11-1/2" (29 cm) long.



pedal

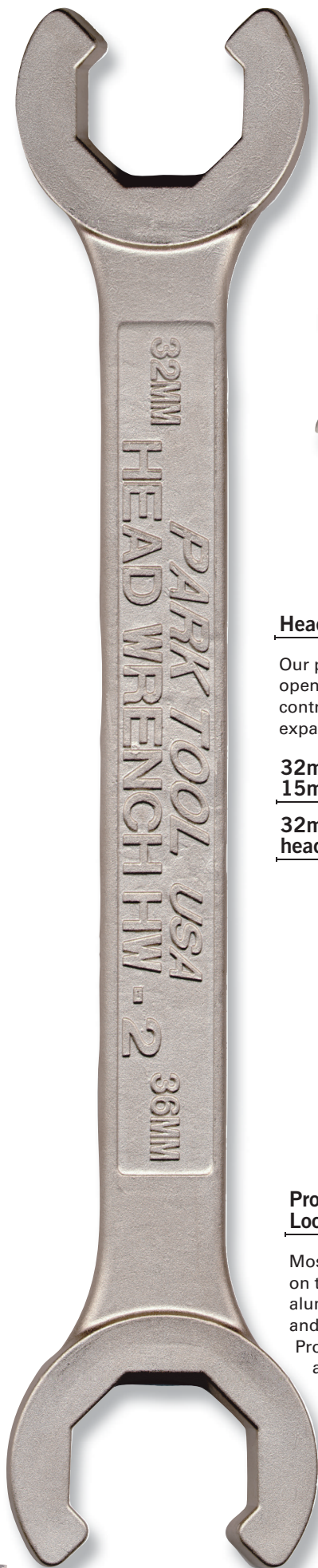

Headset Wrenches **HCW-6, 7, 9, 15**

Our popular and versatile Head Wrenches feature our proven "Y" head design and all headset wrench openings are lazer cut to ensure a tight, accurate fit. Precise sizing is achieved by high voltage computer controlled lazer technology after heat-treat. Waiting until the wrench is heat treated eliminates shrinkage and expansion of the steel after the wrench is sized. It takes longer, and costs more, but it's worth the extra effort.

32mm head wrench & 15mm pedal wrench **HCW-6**

30mm & 32mm head wrench **HCW-7**

36mm & 40mm head wrench **HCW-9**

32mm & 36mm head wrench **HCW-15**

Professional Headset Locknut Wrench **HW-2**

Most headset wrenches are too thin to use on the top locknut of headsets, particularly aluminum locknuts which can be marred and rounded off very easily. The HW-2 Professional Headset Locknut Wrench is the answer. It has a thick, semi-box opening and a substantial, extra long handle for a firm and precise grip on most 8 point 32mm and 36mm locknuts. Made of investment cast steel.



Rotor Truing Fork **DT-2**

Specially designed, and precisely manufactured to gently adjust bent or damaged brake rotors. Each DT-2 features two different slot depths laser cut from high quality steel. Center handle is vinyl dipped for comfort.

Packaged carded:
DT-2C



Disc Mount Facing Tool

DT-1

In order to ensure disc brakes function smoothly and accurately, the frame's mounting tabs must be parallel with the brake pads and rotor. The DT-1 is designed to perfectly machine the face of each tab, removing paint and material to create a flat surface. Works on front forks as well as 12 and 20mm through axles.



Rotor Truing Gauge

DT-3

Accurately gauge the straightness of disc brake rotors while the wheel is mounted in a TS-2 Professional Wheel Truing Stand. The DT-3 features an infinitely adjustable, finely threaded indicator gauge. Works with any diameter brake rotor.

Dial Indicator Set for DT-3

DT-3i

Dial Indicator Set bolts directly to the DT-3 allowing for greater accuracy and a way to measure results.

NEW

Hydraulic Brake Piston Press

PP-1

The unique shape and size of the PP-1 is perfect for compressing the hydraulic piston by pushing the brake pads apart to speed service and pad replacement. Slide the polished, wedge shaped tool between pads to expand the gap and pre-set the pistons into the caliper.



cuts housing

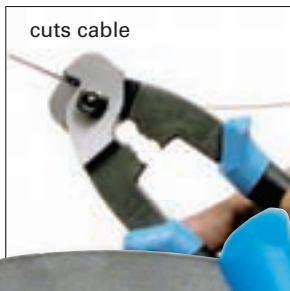

cuts cable



cable end crimper



housing end cap crimper



Professional Cable & Housing Cutter **CN-10**

The CN-10 Cable and Housing Cutter is a shop quality cutter designed specifically for use on all bicycle cables and housing, including hard-to-cut index housing. The CN-10 has cold forged, heat treated steel handles for strength and precision ground cutting jaws for a clean cut on every cable. Dual density molded grips are specially contoured for superior comfort and control. The CN-10 has a built in crimper for cable end caps and a forming hole for reforming housing ends and housing ferrules. A wire latch holds the handles together when not in use.

Packaged: CN-10C



Cable Stretcher **BT-2**

Commonly referred to as a "4th Hand", the Park Tool Cable Stretcher pulls cables tight. It features one-hand operation with a thumb lock to hold the cable tight while your hand is removed to tighten pull-up bolts and nuts. Made from heat treated steel, chrome plated, and featuring cushion grips for comfort. A must for any shop, home or professional.



Offset Brake Wrench **OBW-3**

We call this our offset wrench because of its unique design, which allows it to be used in tight places, such as centering caliper brakes. OBW-3 has a 14mm opening, and the other end fits into the tension springs to rotate the brake on its bolt.

Packaged carded: OBW-3C



Metric Wrenches **CBW-1 • CBW-4**

These small, nickel plated wrenches can be used on brakes, derailleurs, etc.

- CBW-1: 8mm open - 10mm open
- CBW-4: 9mm open - 11mm open

Packaged carded: CBW-1C & CBW-4C



Bike Cleaning Brush Set

BCB-4

A clean bike looks great, performs better, lasts longer, and is easier to maintain. Now with the BCB-4 Bike Cleaning Brush Set, having a clean bike is easier than ever. The BCB-4 contains four brushes, each specially designed for a specific cleaning purpose: a double-ended gear cleaning brush, a tire and frame tube cleaning brush, a frame cleaning sponge brush, and a tapered detail brush. "Sure Grip" dual density handles insure a positive grip even with wet hands.

Packaged carded: BCB-4



GearClean Brush

GSC-1

ParkTool's patented GearClean Brush has a unique design. A large comfortable handle with a curved, toothed-end reaches dirt deep between the gears, and tough nylon bristles clean the derailleur and chain. Saves wear and tear on your chain and freewheel. Works great on brakes or other places where dirt collects. 10 speed compatible. Handy size to take along for quick cleaning anywhere. Made of sturdy nylon.

Packaged carded: GSC-1C

Frame / Fork Tube Brush

FTB-1

All purpose cleaning and scrubbing brush designed to reach where no brush has gone before. The FTB-1 is 35" (89cm) long and features a vinyl dipped shaft and dual density handle for an extra strong grip. Perfect for suspension work, frame tube cleaning, and anything else that needs an extra long brush.

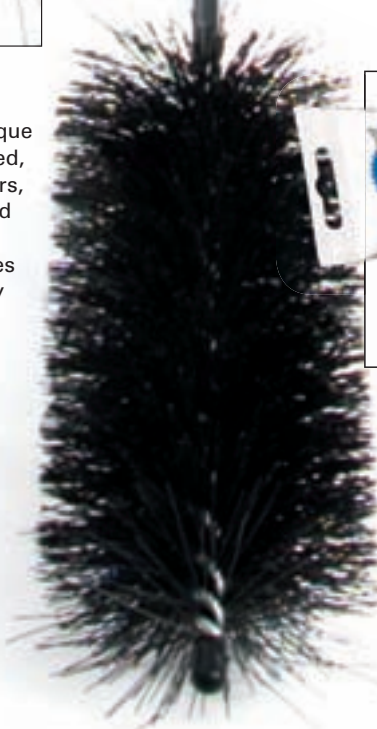

PolyLube 1000 Lubricant

PPL-1 • PPL-2

ParkTool's poly-urea lubricant was developed specifically for bicycle maintenance and repair. PolyLube 1000 has an extremely high shear strength to protect vital parts under extreme conditions. PolyLube 1000 also repels moisture and is compatible with conventional greases.

Available in a handy 4 oz. tube (PPL-1) and a 16 oz. tub (PPL-2).



Synthetic Blend Chain Lube with PTFE

CL-1

A chain lube from ParkTool, the leader in bicycle maintenance products. Using PTFE and a proprietary blend of oils, ParkTool Chain Lube works great in wet or dry conditions. It penetrates, reduces friction, prolongs component life, displaces moisture, and protects parts from rust and corrosion. Also works great on cables, spoke nipples, and derailleur and brake pivots.

4 oz. (118 ml) bottle



Anti-Seize Compound

ASC-1

ParkTool Anti-Seize Compound reduces friction in threaded and press fit connections for easy assembly and disassembly. Ideal for bottom bracket and pedal threads, pressed headset cups, seat posts, quill stems, etc. ASC-1 also seals and protects parts from corrosion and rust under the most extreme conditions. For use on steel, aluminum, and titanium.

4 oz. (113 g) tube



Cyclone Chain Scrubber **CM-5**

The CM-5 Cyclone Chain Scrubber uses an extra large solvent reservoir and a series of rotating brushes to get chains really clean. A magnet at the bottom of the Cyclone's solvent reservoir draws particles scrubbed from the chain, effectively keeping them from being redistributed on the chain during cleaning. Durable sponge material draws solvent from the chain as it exits the Cyclone, reducing drips and mess. To make it easy to control and use, we've even added a handle. Works with all multi-speed bikes and some single-speed models.

Packaged carded: CM-5

Replacement Brush Set for CM-5 **RBS-5**

Includes a complete set of three rotating brushes plus two wicking sponges.

Packaged carded: RBS-5C



Chain Gang Chain Cleaning System **CG-2**

A dirty drivetrain causes poor shifting and unnecessary wear to expensive parts. The Chain Gang contains everything needed to quickly and easily clean the chain, freewheel cogs, and chainrings. The Chain Gang includes a CM-5 Cyclone Chain Scrubber, a GSC-1 GearClean Brush, and an 8 oz. bottle of CB-2 Citrus Chain Brite. The CG-2 works on all derailleur bikes and many 3-speed and coaster brake bikes.

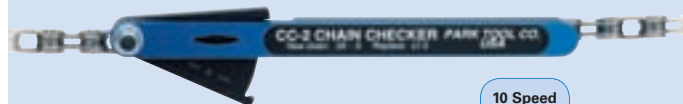

Chain Checker **CC-2**

10 Speed
Compatible

To alleviate poor shifting and uneven drive train wear, most manufacturers recommend chain replacement at or before 1% stretch. Now you can quickly and accurately determine the wear and stretch of any chain with the Park Tool Chain Checker. Simply insert the Chain Checker's pins into two links, press the swing arm gauge tight, and then check the gauge window for an accurate reading.

Packaged carded: CC-2C



10 Speed
Compatible

Chain Wear Indicator **CC-3**

A worn chain shifts poorly and wears sprockets at an accelerated rate. The CC-3 is a "go, no go" gauge designed to accurately indicate when a chain reaches .75% and 1% wear, the points at which most chain manufacturers suggest replacement. Made from precision, laser cut steel.

Packaged carded: CC-3C

Citrus ChainBrite **CB-2**

Biodegradable Citrus ChainBrite is specially formulated for use in the Cyclone Chain Scrubber. It quickly removes the toughest grease and grime buildup, yet won't harm alloy, plastic or rubber parts. Also works great as a general purpose parts cleaning fluid. Flip-top lid makes pouring easy.

16 oz. (472ml) bottle.



Nitrile Mechanics Gloves **MG-1**

MG-1 Nitrile Gloves keep hands free of grime and protected from potentially harmful chemicals and solvents. MG-1 Nitrile Gloves are thin enough to maintain finger dexterity, yet tough enough to resist snags. They provide superior fit, are easy to slip on and off, and can even be re-used. Sizes M, L, and XL.

Box of 100

10 Speed
Compatible**Mini Chain Brute Chain Tool****CT-5**

This small chain tool goes anywhere and actually performs like a shop quality tool. The fine thread, special "V"-shaped handle, and super strong replaceable pin make chain removal and installation a breeze. The CT-5 works on any derailleur chain and has a "shelf" for loosening tight links. At only 77 grams, it's the perfect take-along chain tool.

Packaged carded: CT-5C

**Screw Type Chain Tool****CT-7**

The CT-7 ChainTool is specifically designed to work on the wide and tall 3/16" BMX/freestyle chains now becoming popular. The CT-7 also works on 1/8" BMX/freestyle chains. Made from investment cast steel for strength and durability, the CT-7 has a replaceable driving pin (part CTP), a fine thread, and a comfortable handle. Please note: The CT-7 will not work on 3/32" derailleur or 3/32" BMX chains.

Replacement Chain Tool Pin**CTP**

These pins (not shown), fit ParkTool's CT-1, CT-2, CT-3, CT-5 and CT-7 ChainTools. Made from hardened alloy tool steel.

Packaged carded in pairs: CTP-C

10 Speed
Compatible**Master Link Plier****MLP-1**

Many derailleur chains use a "master link" that allows the chain to be installed and removed by hand. While this type of masterlink doesn't require a traditional chain tool, over time, dirt and corrosion can make it difficult to separate by hand. MLP-1 Master Link Pliers make removal and replacement of these masterlinks quick and effortless. Simply insert the specially sized jaws into the masterlink and squeeze the handles.

Packaged carded: MLP-1C

10 Speed
Compatible**Master Chain Tool****CT-4**

Specially designed to work with the tight tolerances and narrow profile of 10 speed chains and most high quality derailleur chains. The CT-4 is a powerful, precise tool designed to quickly and accurately remove and install chain pins. Without a doubt the most accurate chain tool we've ever built!

- Integrated Link Pocket to ensure precise alignment during use
- Replaceable, rotating pin
- Perfectly contoured cushioned handles
- Precisely machined investment cast body and components

Note: The CT-4 is NOT compatible with Wipperman chains.

Replacement Chain Tool Pin Kit for CT-4**CTP-4K**

Includes four replacement pins and one replacement bearing.

10 Speed
Compatible**Screw Type Chain Tool****CT-3**

Because of the tremendous force needed to remove chain pins, our Screw Type Chain Tool is made from investment cast steel. Along with superior strength and durability, the CT-3 features a handy "loosening shelf" to remedy stiff links after reassembly. The fine thread and comfortable size enable easy removal of even the toughest chain pins. Like all ParkTool ChainTools, it's easy to use and built to last.

Now packaged for retail sales

10 Speed
Compatible**Plier Type Chain Tool****CT-2**

The CT-2 is designed for fast, easy removal or repair of chains. The tremendous leverage generated removes even the toughest rivets. To use, simply put the chain roller in the built-in recess and squeeze the handles. The travel adjusts to return the rivet back the proper distance.

www.parktool.com

Bottom Bracket Tapping & Facing Set

BTS-1

The BTS-1 is a precision tool system which provides a piloted means of tapping the threads in the bottom bracket shell of a frame. After tapping, the taps act as guides to keep the included facing cutter perfectly square with the axis of the bottom bracket for cleanup of the faces of the bottom bracket shell. The BTS-1 includes English taps, 1.370" x 24TPI right hand thread for the adjustable cup, and 1.370" x 24TPI left hand thread for the fixed cup. Italian thread taps, 36mm x 24TPI right hand thread (Part #693), for the adjustable and fixed cups are available as accessories.

Replacement facer (Part #690) available.



Bottom Bracket Facing Set

BFS-1

The Bottom Bracket Facing Set is designed to be a complete self-contained facing set, combining top quality precision parts with ease of use. Simply install the threaded inserts using the facer handle, then insert the facing tool through the guides and install the tension spring and speed nut. After applying a liberal amount of cutting oil, the BFS-1 easily cuts the shell material, giving you a clean, faced surface. Now you're ready to install the bottom bracket.

Replacement facer (Part #690) available.



Pedal Taps

TAP-3 • TAP-6

Clean out or restore damaged threads in crank arms with these pedal taps. These taps can be used with either steel or alloy crank arms and are available in two popular sizes: 1/2" and 9/16" in both right and left-hand threads. Made of high carbon steel, precision ground, and hardened to stay sharp, they cut easily and fit all conventional tap handles.

TAP-3C Set of 2, 1/2" x 20 Left and Right

TAP-6C Set of 2, 9/16" x 20 Left and Right

Packaged carded: TAP-3C, TAP-6C

Frame Taps

TAP-7 to TAP-10

Frame Taps will become a lifesaver at some time for virtually every mechanic. As with all Park Tool Taps, these are made of high carbon steel and are precision ground. Park Tool Frame Taps cut easily and fit conventional tap handles.

TAP-7 3mm x .5, rear wheel drop-out alignment screws

TAP-8 5mm x .8, water bottle, toe clip, fender and rack bosses

TAP-9 6mm x 1, cantilever brakes and large fender bosses

TAP-10 10mm x 1, derailleur hanger

Head Tube Reaming & Facing Set **HTR-1**

Proper frame preparation is very important. The HTR-1 combines reaming and facing of the head tube to create a perfect fit for most sizes of head cups. The HTR-1 comes complete with a 30.0mm reamer, and four different size pilots, (29.8mm, 30.0mm, 33.8mm, and 36.8mm). There are cases when a reamer is required to clean out or increase the diameter of the head tube. Most times however, facing of the head tube for good cup fit is the objective. In this case, reaming is not necessary and the pilots can be used in place of the reamers to keep the tool straight and create a faced head tube. The unique part of the HTR-1 is the quick-release, quick-adjust feature. The bottom portion can slide off and on easily without the long threading process. This portion of the tool can still be fine tuned while in use. The tapered centering cone unit rides on a bearing for extra smooth operation. All cutting surfaces are top quality and extra sharp.

Head Tube Reaming & Facing Set **HTR-1B**

HTR-1B Includes 33.8mm reamer in place of 30.0 reamer.

Additional Reamers & Facers Available For Use With HTR-1:

751 30.0 mm Reamer. Reams head tubes using 1" headsets.

754 33.8 mm Reamer. Reams head tubes using 1-1/8" headsets.

769 Head Tube Reamer Extension. Extends reaming depth of 751 and 754 Reamers up to 27mm for head tubes using deep insertion headset cups.

690 Facing Cutter. Faces head tubes using 1", 1-1/8", and 1-1/4" headsets.

690-XL Facing Cutter. Faces head tubes using "low profile" (integrated with cups) headsets, such as Cane Creek ZeroStack and others. Used with 768 Pilot and 750 Centering Cone Adaptor.

756S Reaming and Facing Cutters. Reams and faces head tubes using "integrated" headsets with a 41mm bearing and 45 degree angular contact, such as Cane Creek IS and others. Includes upper and lower cutters. Used with 750 Centering Cone Adaptor.

758 Reaming and Facing Cutter. Reams and faces head tubes using "OnePointFive" headsets. Used with 750 Centering Cone Adaptor.

761S Reaming and Facing Cutters. Reams and faces head tubes using "integrated" headsets with a 42mm bearing and 45 degree angular contact, such as Campagnolo and others. Includes upper and lower cutters. Used with 750 Centering Cone Adaptor.

768 43.8 mm Pilot. Required when facing head tubes using "low profile" (integrated with cups) headsets, such as Cane Creek Zero Stack and others. Used with 690XL Facing Cutter and 750 Centering Cone Adaptor.

750 Centering Cone Adaptor. Adapts centering cone on HTR-1 for use on "low profile", "integrated", and "OnePointFive" headsets.



Cutting Fluid **CF-2**

The use of cutting oil or cutting fluid is extremely important when performing any cutting, tapping, facing, or reaming operation. Park Tool Cutting Fluid is a high quality, environmentally safe cutting fluid that extends tool life and makes any frame prep job easier and safer. Park Tool Cutting Fluid can effectively be used on all metals.

8 oz. (237 mL) bottle



Threaded Saw Guides

SG-1 • SG-2

Cut any fork quickly and easily with these handy fork stack cutting guides. Heat treated for long life, each guide cleans the freshly cut threads upon removal so headset parts install easily. Cut as little as 1mm from any fork.

SG-1 1" cutting guide

SG-2 1-1/8" cutting guide

Head Cup Remover

RT-1 • RT-2

The ParkTool Head Cup Remover makes headset cup removal easy. The tool is pulled through the frame until the flared ends snap in behind the cup. A blow on the tool head removes the cup. Strong, heat treated alloy steel with nickel finish.

RT-1 Fits 1", 1-1/8", 1-1/4" as well as some low profile and internal head cups.

RT-2 Fits 1-1/4" and 1-1/2" head cups as well as some low profile and internal head cups.



Threadless Saw Guide

SG-6

The SG-6 Threadless Saw Guide ensures a straight, clean cut on 1", 1-1/8" and 1-1/4" threadless forks. Simply clamp the SG-6 onto the fork and cut, letting the SG-6 guide the hacksaw blade. The SG-6's non-scratching composite body incorporates steel threads and a steel reinforcing plate to withstand the rigors of heavy shop use.



Oversized Adjustable Saw Guide

SG-7

Accurately guides a hack saw to cut steerers, integrated seat posts and even airfoil shaped seat posts up to 3.5" (89mm) or round tubes from 1" (32mm) to 1-3/4" in diameter (45mm). The SG-7 features a hardened steel body and molded contact pads to protect tubes and frames.



RT-1

RT-2

Crown Race Cutting Tool

CRC-1

To insure proper headset performance and longevity, special attention must be given to accurately machine the fork's crown race seat. The CRC-1 is a professional quality machining tool for milling both the outer edge and lower surfaces of the crown race seat. A unique adjusting system allows a tight fit of the tool on any fork, threaded or unthreaded (even forks with externally butted steerer tubes), ensuring a smooth, accurate cut and proper alignment of the fork in the frame. The CRC-1 Crown Race Cutting Set includes high speed steel cutters and adjustable collets to machine 26.5mm and 27.1mm crown race seats on 1" forks and 30.1mm crown race seats on 1-1/8" forks.



Bearing Cup Press

HHP-2

The HHP-2 accurately aligns and presses 1", 1-1/8", 1-1/4", and 1.5" headset cups. In addition, it presses cartridge bearings and cups into one-piece bottom bracket shells and holds fixed cup wrenches firmly in place when removing or installing adjustable-type bottom brackets. Features a quick-release design for fast tool installation and removal, extra long (30cm) handles for superior leverage, and stepped bushings for precise cup alignment.



Step Bushing Cup Adaptors

530-2

Included with HHP-2, also available separately in pairs.

Home Mechanic Head Cup Press

HHP-3

Simple and economical, the HHP-3 is designed to install all sizes of head cups and one-piece bottom bracket cups.



Crown Race Setting System for 1.5" Steering Column

CRS-15

Includes setting tube and one 1.5" setting insert.



Replacement inserts

Crown Race Setting System

CRS-1

We've taken a fresh new approach to crown race installation. Traditionally, a mechanic would slam a tube down onto the bearing surface to "set" the race in place. The CRS-1 offers a different approach that offers faster, safer, and more precise installation. The bearing surface is spared a direct hit by using different inserts to ensure proper fit on the race. Choose the correct insert then slide the tube over the fork tube and into the top end of the insert. Using a hammer, tap firmly on the end cap of the tube and seat the race into its proper place safely and accurately. The CRS-1 set includes one universal setting tube, three 1" inserts, and three 1-1/8" inserts.

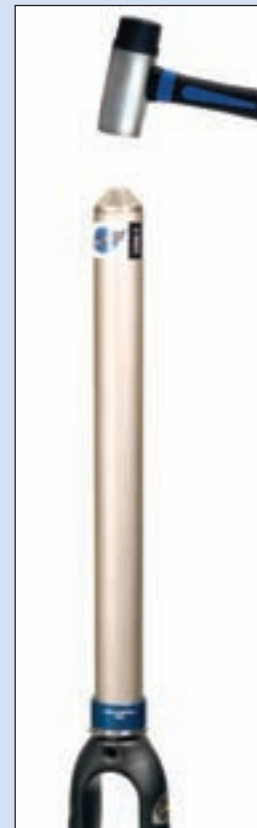

Universal Crown Race Puller

CRP-1

The CRP-1 is a precision tool for quickly and easily removing the headset crown race from the crown race seat of the fork. Universal design works with 1", 1-1/8", 1-1/4" and 1.5" crown race/fork (suspension or rigid) combinations. To use, simply turn the two small T-handles to press the thin-edged wedges under the crown race. Then turn the large T-handle to completely pull the crown race from the fork. No more hammer and punch! All steel construction for long life.

Replaceable wedges (part #1170-2, two required).



Fork Threading Set

FTS-1

The FTS-1 Fork Threading Set is designed for cutting new threads and for chasing existing threads on fork columns that are not chromed. The FTS-1's expandable cutting dies are made from the highest quality high speed steel for precision cutting and long life. The unique thread guide system used with the FTS-1 is specially designed to allow the metal chips and shavings that result during use to fall completely through the guide, preventing damage to the fork threads and the tool. The FTS-1 includes die handles, 1" x 24 tpi cutting die (Part #606), and 1" cutting guide (Part #610). 1-1/8" x 26 die (Part #607), 1-1/4" x 26 die (Part #608), 1-1/8" guide (Part #611), and 1-1/4" guide (Part #612) are available as accessories. Die handles fit all three sizes of dies and guides.



updated
Fits a wider
variety of bikes



Derailleur Hanger Alignment Gauge

DAG-2

The Derailleur Hanger Alignment Gauge can help solve a multitude of derailleur shifting problems, most notably with index shifting systems. Updated in 2009, the DAG-2 utilizes a longer measuring pointer, longer threaded stud and a longer, narrower alignment boss to fit a wider variety of bikes. This tool is extremely steady in operation and is simple to use. The tool threads directly into the derailleur hanger. The gauge bar holds a gauge which marks the distance to the wheel. The gauge then is rotated with the wheel to the 3, 6, 9, and 12 o'clock positions, noting any differences in measurements. The alignment of the derailleur hanger is accomplished by applying pressure to the tool's arm. The results can be checked instantly. The DAG-2 is made of heavy-gauge steel and is chrome plated for long shop life.



Frame Alignment Gauge

FAG-2

Many bicycles will not shift or track properly because the front and rear wheels are not in line with the frame. If these conditions still exist after wheel and derailleur adjustments, the seat stays, chain stays, and rear drop-outs of the frame may be misaligned. For years the accepted method to check the alignment of the rear drop-out was to run a string on either side. This method does work to some extent. However, it is not accurate because the measurement is not taken at the drop-out. With the Park Tool Frame Alignment Gauge the alignment can be checked quickly and accurately at the drop-out. Retractable pointer to fit all sizes and types of bicycles.



Threadless Nut Setter

TNS-1 • TNS-15

The Threadless Nut Setter is used to install the star-fangled nut found on threadless headset systems. Thread the nut onto the TNS, insert into the fork stack, and tap it in with a hammer. Sets the star-fangled nut to 15mm and keeps it straight. Long handle helps prevent pinched fingers.

TNS-1 1" and 1-1/8" Headset systems

TNS-15 1-1/4 and 1.5" Headset systems



Uses Part #822 Replacement Set Screws.



star nuts
not included



Deluxe Threadless Nut Setter

TNS-4

The TNS-4 makes it quick and easy to install star-fangled nuts used with 1" and 1-1/8" threadless headset systems. Using a durable steel driver and built-in guide, the TNS-4 perfectly aligns the star-fangled nut and sets it to the proper depth every time. The unique design virtually eliminates pinched fingers.

Uses Part #822 Replacement Set Screws.



Frame & Fork End Alignment Gauge Set

FFG-2

Improperly aligned frame and fork dropouts can cause bent axles and quick release skewers, as well as tracking and shifting problems. The updated FFG-2 quickly determines whether dropouts are aligned and parallel. If an error is detected, long handles and comfortable molded grips afford plenty of leverage for straightening. Works on frames and forks with dropout spacing up to 160mm.



FRAME & FORK STRAIGHTENING TOOLS

This section is devoted to our frame and fork straightening tools. Many bicycles cannot be properly repaired or adjusted because their frames and forks are no longer true. With the high cost of new bicycles and replacement frames and forks, straightening can be a viable, cost-effective alternative. Many damaged bicycles can be safely straightened and repaired when the proper tools are used by skilled mechanics. When these tools are used to straighten and assure the alignment of a frame or fork, the repaired bicycle will be safer to ride.

CAUTION

During any repair, safety should always come first. Customers should be advised prior to straightening that not all bicycles can be repaired. After alignment, all frames and forks should be carefully inspected for cracks or kinked tubes. A customer should be advised when certain conditions render a bicycle unsafe to ride.

Frame and Fork Straightener

FFS-2

The Park Tool Frame and Fork Straightener is a versatile and productive tool. The open hook design enables it to straighten not only frames and forks, but also cranks and handlebars. Vinyl coating on the hook and on the fulcrum pad protects painted surfaces. The hook has over 8" of adjustment. Reinforced to prevent flexing. The adjustable hook now accommodates a fork or tube up to 1-3/4" (44mm) in diameter – 35% larger than that of the FFS-1 – and features over 8" (20.3 cm) of sliding travel adjustment.



Includes tool
selection guide



2 - PFP-3 included

Park Tool Display System **PDR-4**

"The Right Tool for the Job." Over 4,000 bike shop owners worldwide rely on ParkTool Displays to help sell tools. And now, the newly updated PDR-4 ParkTool Display Center makes it easier than ever. A great mix of tools for maintaining most bikes, attractive packaging and graphics, a copy of our Home Mechanic Tool Selection Guide, and a versatile display that can be easily rolled from one location in the shop to another. It all adds up to create an impressive, well-defined tool and information center that sends your customers the message they've come to the right place for all their bicycle tool needs. If you're serious about selling bicycle tools, the PDR-4 Park Tool Display System is the right tool for the job.



Double Wall Display **PDR-6**



The PDR-6 showcases a selection of 31 popular tools on two display panels. Easily mounts side-by-side or vertically to any wall.



Mini Wall Display **PDR-5**

If you don't have the space for a full display system, check out the PDR-5 Mini Wall Display. It's a great way to get your feet wet and to discover how profitable selling tools can be.



Barbeque Tool Set **BBQ-3**

A post-ride essential and a fun way to work with your favorite tools. Stainless steel pedal wrench and cone wrench grilling tools that bring ParkTool Blue to the barbeque.

Available only as a set.



Ball Cap **HAT-2**

Our cap features an embroidered Park Tool logo.



PNT-1

Pint Glass



MUG-1

Coffee Mug



Bottle Opener **BO-2**

The ergonomically designed BO-2 is engineered and built to provide tremendous leverage, making quick work of any bottle cap. World famous ParkTool blue vinyl coated handle and stainless steel construction provide years of comfortable use. Dishwasher safe.

Packaged carded: BO-2C



Pizza Tool **PZT-2**

What's better than pizza after a good day of wrenching or riding? An update of one of our all-time greats, the PZT-2 Pizza Tool is bigger (for better hand position), better (super sharp, large diameter stainless steel cutting wheel cuts through even the toughest terrain), and stronger! Amaze your friends, show off to your in-laws. It's a bicycle...it's a pizza cutter!



Shop Stool **STL-1**

The STL-1 Park Tool Shop Stool has chrome-plated steel legs and a comfortable padded seat with a three-color Park Tool Logo. The seat swivels 360 degrees and is positioned at a height of 32" (81cm)—the perfect height for wheel truing or other work at a bench or counter. Great in the shop or on the sales floor.



Rolling Adjustable Height Shop Stool **STL-2**

The STL-2 is ideal for quickly maneuvering around the bike while making adjustments. It has an adjustable gas shock with 5" (13cm) of travel, smooth-rolling wheels, and a swiveling seat with a three-color Park Tool Logo. Adjusts in height from 17" to 22" (44cm to 57cm).



Shop Stool With Back **STL-3**

All the features of the STL-1 with a padded back.



Hoodie Sweatshirt **SWH-1**

This 11 oz. pullover hoodie is a heavyweight when it comes to keeping you warm. The textured logo and embroidered hood are a testament to your good taste when it comes to style (and bicycle tools). Sizes S, M, L, XL, XXL.



Heavy Duty Shop Apron **SA-3**

Once you try on this apron, there's no going back to standard aprons. The SA-3 is made from heavy 10 oz. cotton canvas and has two rows of bar tack reinforced pockets for stashing pens, parts, tools, etc. The special crossback design removes pressure from the neck for all day comfort. A nylon quick release makes the apron easy to adjust and take off. A full 35" in length, the bottom 7" of the apron can be snapped up for a custom height fit. An embroidered Park Tool logo makes the apron as good looking (even when it's dirty) as it is functional.



T-Shirt **TSO-1**

Our cotton T-shirts are pre-shrunk and feature an extra large logo. Sizes M, L, XL, and XXL.



Mechanic's Shirt **MS-1**

The MS-1 Mechanic's Shirt is an oversized version of the traditional mechanic's shirt. It has two pockets and is made from a wrinkle-free 65% poly/35% cotton blend for long wear and good looks. Black with embroidered logo. Sizes M, L, XL, and XXL.



Shop Apron **SA-1**

Protect your clothes and gain the advantage of large pouch pockets whenever you work in the shop. Our full-length, shop quality aprons are made of a heavy 7-ounce cotton twill for comfort and durability. Navy blue with white embroidered Park Tool logo.