

COMPLETE TECH BOOK
2006+

how easy
would you
like
biking
to be?

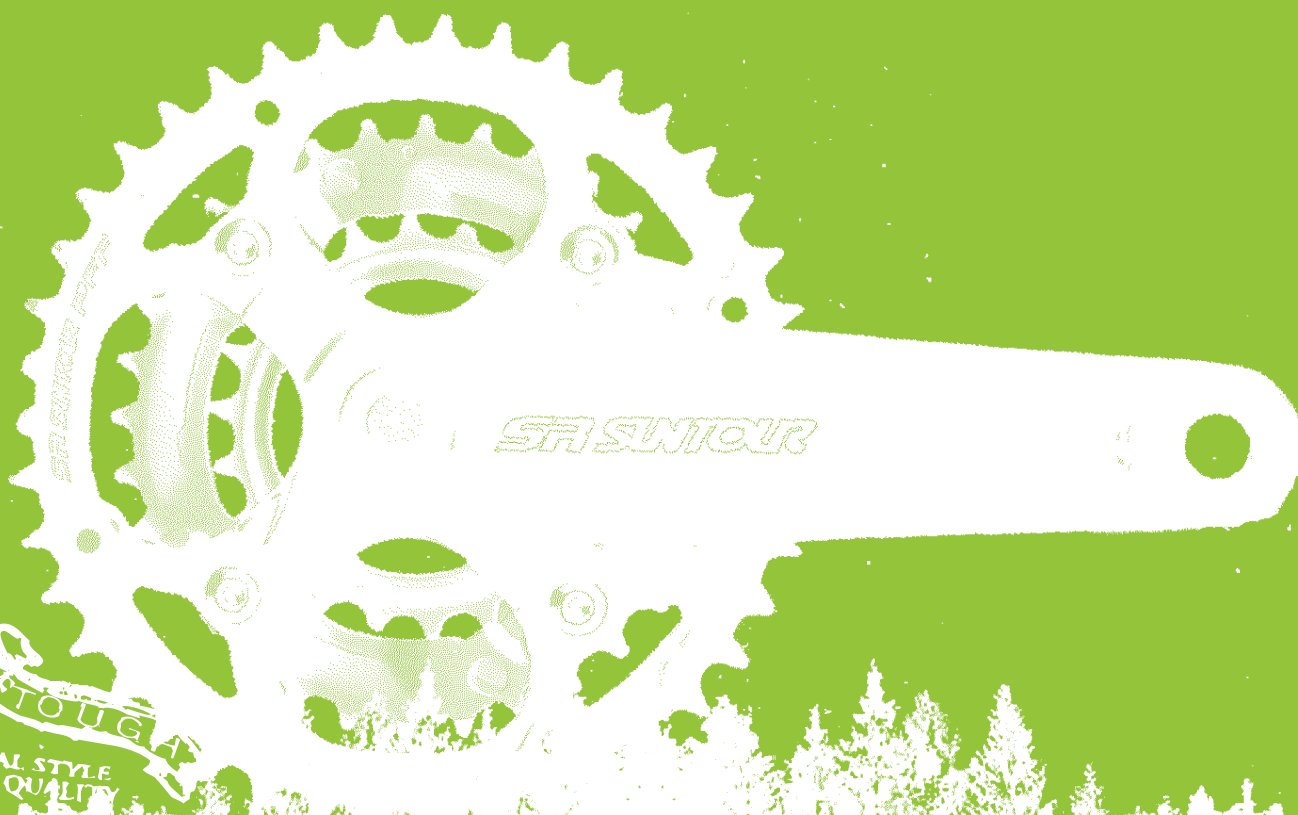

SR SUNTOUR

www.srsuntour-cycling.com

CONTENT OVERVIEW & PRODUCT MATRIX

CONTENT OVERVIEW / PRODUCT MATRIX	PAGE	2
HIGHLIGHTS / INNOVATIONS□	PAGE	4
INTRO□	PAGE	6
FORKS□	PAGE	8
CHAINWHEELS□	PAGE	16
FRONT DERAILLEURS□	PAGE	22
REAR DERAILLEURS□	PAGE	24
DRIVETRAINS / SUSPENSION CONTROL.....	PAGE	26
CASSETTES□	PAGE	28
SEATPOSTS / PEDALS / TOOLS□	PAGE	30
HUB DYNAMO□	PAGE	32
FORK OVERVIEW CHART.....□	PAGE	34
CONTACT DISTRIBUTORS□	PAGE	35

PRODUCT DESCRIPTIONS

RUX	• AGGRESSIVE DIRT JUMP/FREERIDE
AXON	• ALL MOUNTAIN, CROSS COUNTRY
DUROLUX	• TOUGH, AND HIGH PERFORMANCE
DURO	• DURABLE, TOUGH
CONDOR	• LIGHT, LONG FLIGHTS
XC PRO	• ADVANCED ALL MOUNTAIN / CROSS COUNTRY
XCR	• ALL MOUNTAIN
XCM	• STREET PERFORMANCE
XCT	• STREET PERFORMANCE
M	• BEGINNER SERIES, WIDE OPTIONS
NRX	• ALL ROAD, QUALITY PERFORMANCE,
NCX	• LIGHT WEIGHT FEATURES, SPORT LEISURE RIDING
NEX	• BEGINNER, PRICE/VALUE ADVANTAGE
CR	• TRADITIONAL STYLING, STURDY, ROAD
SUPERBE	• ROAD, CRAFTSMANSHIP, HIGH QUALITY
SC	• CRUISING, OLD CLASSIC

RIDE CATEGORY DESCRIPTIONS

CROSS COUNTRY	• LIGHT WEIGHT, TRAILS
ALL MOUNTAIN	• LONG DISTANCE, LONG HOURS MOUNTAIN RIDING
	• DURABLE, ROUGH TRAILS, SOME JUMPS
FREERIDE	• TOUGHER TERRAIN, JUMPING, TECHNICAL RIDING
STREET	• STREET FUN RIDING
CROSS	• EASY TRAILS, ROAD INFLUENCED DESIGNS, VERSATILE
TREKKING	• LIGHT TRAILS, GRAVEL ROADS, COUNTRY RIDING
COMMUTING	• CONVENIENCE, VERSATILITY, STABILITY
ROAD	• PAVEMENT, QUALITY

HIGHLIGHTS & INNOVATIONS



MODEL: RUX-S / RUX-T

Rebound and Compression Damping have a new valve system to provide Damping for big impacts and to avoid over Damping on the small bumps.

Coil spring with AIR preload adjuster system provides for a wider range of individual preload settings.



MODEL: CR930, CR940, CR980 AND CR990 SERIES

Integrated Lamp holder mountable brace design and Integrated Hub dynamo cable guide design are available for cleaner out-look.





MODEL: CW-DURO AND CW-XCM SERIES

The Hexon BB axle provides a larger surface area for improved locking. The Hexon BB also has M10mm oversized bolts for lighter weight.



MODEL: CS-AXON-SS

Alloy Spider Arm, Replaceable Cogs, Alloy 24, 28, 32T, Steel 11, 12, 14, 16, 18, 21T, Satin Finish, Max. Chain Width 6.6mm Super PowerFlo, Light Weight Teeth Design, 9-speed



MODEL: SL-DURO SERIES

Janus Single Lever Dual Action with auto return mechanism
Single lever provides Dual action — two functions in one
Thumb actuated shifter keeps fingers free for braking
Ease of use with Auto return mechanism.



MODEL: RD-DUROLUX SERIES

9-speed, Full Alloy body Forged Alloy short cage
10T front teeth difference 11-34T rear sprocket,
33T total 33T total capacity, 1:1 stroke



MODEL: SP-NCX-D4

- 48mm Travel
- Parallelogram suspension design
- Coil Spring (2 Pcs) Suspension system
- One bolt clamp design
- Diameter 27.2 or 26.6mm x 350mm
- L Saddle base width, 43.5mm, Alloy Arm
- Alloy Upper
- Anti-slip pin design
- Finish; Silver / Powder black
- Optional Safety cover available

INTRO



HOW EASY DO YOU WANT BIKING TO BE?

SR SUNTOUR'S MISSION, IN ONE SENTENCE, IS TO MAKE BIKING SIMPLE, COMFORTABLE, SAFE, ERGONOMIC AND PHYSICALLY CORRECT. BUT IN ONE WORD, IT'S TO MAKE BIKING EASIER!

THIS HAS BEEN THE EXPECTATION OF A MYRIAD OF A PEOPLE FROM A PLETHORA OF BIKING WORLDS. FROM THE HARD-CORE DIRT JUMPER TO THE DAILY COMMUTER, FROM THE ALP-CROSSING ENDURO TREKKER TO THE STUDENT WHO NEEDS TO SQUEEZE HIS VEHICLE INTO HIS TINY FLAT, ALL OF THEM REQUIRE AN EASIER RIDE.

THIS MISSION IS THE HANDRAIL ON TO WHICH SR SUNTOUR HAS HELD DURING ITS 70-YEAR HISTORY. FROM THE ORIGINS OF A SMALL COMPANY WE'VE NOW EVOLVED TO ONE OF A VERY RESPECTABLE SIZE. OUR ENGINEERING GROUP CAN LOOK BACK ON 50 YEARS INVOLVED IN THE CYCLING INDUSTRY.

WE'VE SEEN THE DRIVE TRAIN DEVELOP FROM SINGLE SPEED TO 27 SPEEDS, THE STIFF FRONT FORK TO AN INNOVATIVE TRAVEL ADJUSTMENT SUSPENSION FORK AND THE BRAKING SYSTEM EVOLVE FROM AN ORDINARY TYRE BRAKE TO PERFORMANCE DISC BRAKES.

WE AT SR SUNTOUR MADE THE FIRST MOUNTAIN BIKE COMPONENTS IN THE EARLY '80S. WE'VE OBSERVED THE PROCESS OF THE BICYCLE FRAME AND THE SUSPENSION BECOMING A SINGLE UNIT AND REACTED BY INTRODUCING THE CONCEPT OF FUNCTIONAL INTEGRATION WITH OUR I.C.E PRODUCT LINE.

THROUGHOUT ALL THESE CHANGES THOUGH, ONE THING AT SR SUNTOUR HAS ALWAYS REMAINED THE SAME: THE CONSTANT SEARCH FOR SOLUTIONS TO IMPROVE BIKING. TO MAKE IT EASIER, TO MAKE IT BETTER.

THROUGH THE YEARS OUR PASSION FOR MAKING BIKING EASIER HAS BEEN OUR FAITHFUL COMPANION, A PARTNER IN WHICH WE COULD TRUST, A CONSTANT INSPIRATION, AN ENDLESS ENERGY SOURCE, A COMMON THEME IN OUR WORLD WIDE, MULTINATIONAL COMPANY.

IT IS THIS PASSION TO OUR COMPANY PRINCIPLES OF PROVIDING QUALITY, PRICE AND FULFILMENT THAT HELPS US TO SATISFY THE EXPECTATIONS OF OUR CUSTOMERS, OUR RETAILERS AND THE BICYCLE ENTHUSIASTS WHO USE OUR PRODUCTS.

THE PASSION TO IMPROVING RIDE QUALITY IS OUR INSPIRATION TO OFFER AFFORDABLE AND INNOVATIVE PRODUCTS FOR OUR CUSTOMER'S ENJOYMENT AND CONSTANTLY TRIGGERS NEW INNOVATION IMPULSES IN OUR MINDS THAT WILL KEEP ON CHANGING THE BIKING WORLD FOR THE COMING DECADES.

LET US MAKE YOUR LIFE EASIER...

YOUR SR-SUNTOUR TEAM

TREKKING FORKS

NRX SERIES



MODEL: NRX 9100 RL

- I.C.E. = Integrated Control Equipment
- Remote Speed Lock Air Spring, Hydraulic Damping
- Magnesium Lower: 116mm width
- Leading axle design
- AL 7050, 28mm stanchions AL Alloy steerer
- 63mm travel (700C) 75mm travel (26")



MODEL: NRX 8100 LO

- Speed Lock Out, Air Spring, Hydraulic Dampi
- Magnesium Lower: 116mm width
- Leading axle design
- AL 6061, 28mm stanchions, AL Alloy steerer
- 63mm travel (700C) 75mm travel (26")



MODEL: NRX 6500-LO

- Speed Lock Out
- Magnesium Lower: 116mm width
- Leading axle design
- Coil Spring, Hydraulic Damping
- Preload adjuster
- STKM CP Finish Stanchion
- 63mm travel (700C) 75mm travel (26")



MODEL: NRX 8200 RL

- I.C.E. = Integrated Control Equipment
- Remote Speed Lock, Air Spring, Hydraulic Damping
- Magnesium Lower: 116mm width
- Leading axle design
- AL 6061, 28mm stanchions STKM steel steerer
- 63mm travel (700C) 75mm travel (26")



MODEL: NRX 7600-RL

- I.C.E. = Integrated Control Equipment
- Remote Speed Lock, Coil Spring, Hydraulic Damping
- Magnesium Lower: 116mm width
- Leading axle design
- Preload Adjuster
- STKM CP Finish Stanchion
- 63mm travel (700C) 75mm travel (26")



MODEL: NRX 6000

- Magnesium Lower: 116mm width
- Leading axle design
- Coil Spring, Preload adjuster
- STKM CP Finish Stanchion
- 63mm travel (700C) 75mm travel (26")

NCX-FT SERIES



MODEL: NCX-FT-S AL

- I.C.E. = Integrated Control Equipment
- Remote Speed Lock, Air Spring, Hydraulic Damping
- Magnesium Lower: 108mm width
- Leading axle design
- AL 7050, 28mm stanchions, AL Alloy steerer, 63mm travel (700C)
- FIRMTECH brake, Disc brake compatible



MODEL: NCX-FT-E AL

- I.C.E. = Integrated Control Equipment
- Remote Speed Lock, Air Spring, Hydraulic Damping
- Magnesium Lower: 108mm width
- Leading axle design
- AL 6061, 28mm stanchions, STKM Steerer, 63mm travel (700C)
- FIRMTECH brake, Disc brake compatible



MODEL: NCX-FT-E LO

- Speed Lock Out, Air Spring, Hydraulic Damping
- Magnesium Lower: 108mm width
- Leading axle design
- AL 6061, 28mm stanchions, STKM Steerer
- 63mm travel (700C)
- FIRMTECH brake, Disc brake compatible



MODEL: NCX-FT-D AL

- I.C.E. = Integrated Control Equipment
- Remote Speed Lock, Coil Spring, Hydraulic Damping
- Magnesium Lower: 108mm width
- Leading axle design
- Preload Adjuster, STKM Stanchions, STKM Steerer
- 63mm travel (700C)
- FIRMTECH brake, Disc brake compatible



MODEL: NCX-FT-D LO

- Speed Lock Out,
- Magnesium Lower: 108mm width
- Leading axle design
- Coil Spring, Hydraulic Damping, Preload adjuster
- STKM CP Finish Stanchion, STKM Steerer
- 63mm travel (700C)
- FIRMTECH brake, Disc brake compatible



MODEL: NCX-FT-D

- Coil Spring, Magnesium Lower: 108mm width
- Leading axle design
- Preload Adjuster, STKM Stanchions, STKM Steerer
- 63mm travel (700C)
- FIRMTECH brake, Disc brake compatible



NCX SERIES



MODEL: NCX-E RL

- I.C.E. = Integrated Control Equipment
- Remote Speed Lock, Air Spring, Hydraulic Damping
- Magnesium Lower: 108mm width
- Leading axle design
- AL 6061, 28mm stanchions, STKM Steerer
- 63mm travel (700C)



MODEL: NCX-D RL

- I.C.E. = Integrated Control Equipment
- Remote Speed Lock, Coil Spring, Hydraulic Damping
- Magnesium Lower: 108mm width
- Leading axle design
- Preload Adjuster, STKM Stanchions, STKM Steerer
- 63mm travel (700C)



MODEL: NCX-D

- Magnesium Lower: 108mm width
- Leading axle design
- Coil Spring, Preload Adjuster
- STKM Stanchion, STKM Steerer
- 63mm Travel



MODEL: NCX-E LO

- Speed Lock Out, Air Spring, Hydraulic Damping
- Magnesium Lower: 108mm width
- Leading axle design
- AL 6061, 28mm stanchions, STKM Steerer
- 63mm travel (700C)



MODEL: NCX-D LO

- Speed Lock, Coil Spring, Hydraulic Damping
- Magnesium Lower: 108mm width
- Leading axle design
- Preload Adjuster, STKM Stanchions, STKM Steerer
- 63mm travel (700C)

NEX SERIES



MODEL: NEX 4500LO

- Mechanical Lock Out
- Aluminum Lower
- Leading axle design: 116mm width
- Coil Spring, Preload Adjuster
- STKM Stanchion w/Mini Boots, STKM Steerer
- 63mm travel (700C) and (26") available

**MODEL:** NEX 4000

- Aluminum Lower, Leading axle design: 116 width
- Coil Spring, Preload Adjuster
- STKM Stanchion w/Mini Boots, STKM Steerer
- 63mm travel (700C) and (26") available

CR SERIES**MODEL:** CR 990-LO-700

- Air Spring, Hydraulic Damping, Speed Lock Out
- Magnesium Lower
- Alloy Stanchion, Alloy Steerer
- Integrated HB dynamo cable guide (option)
- Integrated Lamp Mount System compatible
- 63mm travel

**MODEL:** CR 980-LW-700

- MCU Elastomer
- Magnesium Lower
- CRMO stanchion, Preload Adjuster, Alloy Steerer
- Integrated HB dynamo cable guide (option)
- Integrated Lamp Mount System compatible
- 63mm travel

**MODEL:** CR 940-LO

- Coil Spring, Hydraulic Damping
- Speed Lock Out
- Magnesium Lower
- STKM steerer, STKM Stanchions, Preload Adjuster
- Integrated HB dynamo cable guide (option)
- Integrated Lamp Mount System compatible
- 63mm travel

**MODEL:** CR 930-700

- Coil Spring
- Magnesium Lower
- STKM steerer, STKM Stanchions, Preload Adjuster
- Integrated HB dynamo cable guide (option)
- Integrated Lamp Mount System compatible
- 63mm travel

**MODEL:** CR 860-LO

- Coil Spring
- Mechanical Lock Out
- Alloy Lower
- Preload Adjuster, STKM Stanchions, STKM steerer
- HB dynamo cable guide (option)
- 50mm travel (700C)

**MODEL:** CR 851

- Coil Spring, Alloy Lower
- Preload Adjuster, STKM Stanchion
- Roller Brake
- HB dynamo cable guide (option)
- 40mm travel (700C) available

**MODEL:** CR 850

- Coil Spring, Alloy Lower
- Preload Adjuster, STKM Stanchions, STKM steerer
- HB dynamo cable guide (option)
- 50mm travel (700C) available

**MODEL:** CR 820W

- Coil Spring
- Alloy Lower
- STKM Stanchion
- 40mm travel (700C) available

ALL MOUNTAIN, CROSS COUNTRY & FREERIDE FORKS



AXON SERIES



MODEL: AXON-S AL

- I.C.E. = Integrated Control Equipment
- Magnesium Lower
- AL 7050, 30mm Stanchions, Remote Speed Lock cartridge
- 80 or 100mm travel, Alloy shot anodized lightweight crown
- AL steerer tube
- Air spring w/Hydraulic Damping



MODEL: AXON-E AL

- I.C.E. = Integrated Control Equipment
- Magnesium Lower
- AL 6061, 30mm Stanchions
- Remote Speed Lock cartridge
- 80 or 100mm travel
- Alloy shot anodized lightweight crown
- Cromoly steerer tube
- Air spring w/Hydraulic Damping



MODEL: AXON-D AL

- I.C.E. = Integrated Control Equipment
- Magnesium Lower
- STKM, Chrome plated 30mm stanchions
- Remote Speed Lock cartridge
- 80 or 100mm travel
- Air spring w/Hydraulic Damping



MODEL: RUX-S

- Hydraulic Damping (open oil bath)
- Rebound Adjuster, Compression Adjuster
- A7050 Cold Forged Crown
- Magnesium Lower
- 32mm A7050 Stanchion, Reinforced CRMO steerer
- Air Preload adjuster
- Disc brake international mount
- Coil Spring, 130mm travel



MODEL: RUX-E

- Hydraulic Damping (open oil bath)
- Rebound Adjuster
- A7050 Cold Forged Crown
- Magnesium Lower
- 32mm A7050 Stanchion, Reinforced CRMO steerer
- Air Preload adjuster, Disc brake international mount
- Coil Spring, 130mm travel



MODEL: RUX-TRIPLE

- Hydraulic Damping (open oil bath)
- Rebound Adjuster, Compression Adjuster
- A6061 Double Crown
- Magnesium Lower
- 32mm A7050 Stanchion, Reinforced CRMO steerer
- Air Preload adjuster, Disc brake international mount
- Coil Spring, 150mm travel

duro



MODEL: DURO-E

- Coil Spring, 100 or 130mm travel
- Hydraulic Damping
- Rebound Adjuster
- A7050 Cold Forged Crown 130mm pitch
- Magnesium Lower
- 32mm CR-MO Stanchion
- Reinforced CRMO steerer
- Preload adjuster, Disc brake international mount



MODEL: DURO-D

- Coil Spring, 100 or 130mm travel
- Hydraulic Damping
- AC4C Accurad Forged Crown 130mm pitch
- Magnesium Lower
- 32mm CR-MO Stanchion
- Reinforced CRMO steerer
- Preload adjuster
- Disc brake international mount



MODEL: DURO-TRIPLE

- Coil Spring, 130mm travel
- A6061 Double Crown
- Magnesium Lower
- 32mm STKM Stanchion CRMO steerer
- Preload adjuster
- Disc brake international mount



CONDOR SERIES



MODEL: CONDOR-TR

- I.C.E. = Integrated Control Equipment
- Air Spring, Remote Travel Adjuster
- 60-150mm travel adjustable
- Magnesium Lower
- A6061 double crown
- 35mm A6061 Alloy stanchion, A7075 Alloy steerer
- Air preload adjust

XCR SERIES



MODEL: XCR-TR

- I.C.E. = Integrated Control Equipment
- Coil Spring, Hydraulic Damping
- Remote Control Travel Adjuster 60-120mm
- Magnesium Lower
- AC4C Accurad Forged crown
- 32mm STKM stanchion, STKM steel steerer
- Preload adjuster
- Disc, V-brake, International disc mount



MODEL: XCR-RL

- I.C.E. = Integrated Control Equipment
- Coil Spring, Hydraulic Damping
- Remote Speed Lock cartridge
- 100 or 120mm travel, Magnesium Lower
- AC4C Accurad Forged
- 32mm STKM stanchion, STKM steel steerer
- Preload adjuster
- Disc, V-brake, International disc mount



MODEL: XCR-LO

- Coil Spring, Hydraulic Damping
- Speed Lock cartridge
- 100 or 120mm travel
- Magnesium Lower
- AC4C Accurad Forged crown
- 32mm STKM stanchion, STKM steel steerer
- Preload adjuster
- Disc, V-brake, International disc mount



MODEL: XCR

- Coil Spring, 100 or 120mm travel
- Magnesium Lower
- AC4C Accurad Forged crown
- 32mm STKM stanchion, STKM steel steerer
- Preload adjuster
- Disc, V-brake, International disc mount

XCM SERIES



MODEL: XCM-H-LO

- Coil Spring, Hydraulic Damping
- Speed Lock Out Cartridge
- 80 or 100mm travel
- Alloy Lower
- AC4C Accurad Forged crown
- STKM stanchion, STKM steel steerer
- Preload adjuster
- Disc, V-brake, International disc mount

XCT SERIES



MODEL: XCT-LO

- Coil Spring, Mechanical Lockout
- 75mm travel, Alloy Lower
- AC4C Accurad Forged crown
- 25.4mm STKM stanchion, STKM steel steerer
- Preload adjuster
- Disc, V-brake, International disc mount



MODEL: M3010

- Coil Spring
- Alloy Crown and brace
- Pre-load adjuster
- STKM Steerer w/mini boots
- Internal Coil Spring, STKM Stanchions
- 700C & 26" available



MODEL: XCM-LO

- Coil Spring, Mechanical Lock Out
- 80 or 100mm travel
- Alloy Lower
- AC4C Accurad Forged crown
- STKM stanchion, STKM steel steerer
- Preload adjuster
- Disc, V-brake, International disc mount



MODEL: XCT

- Coil Spring
- 75mm travel, Alloy Lower
- AC4C Accurad Forged crown
- 25.4mm STKM stanchion, STKM steel steerer
- Preload adjuster
- Disc, V-brake
- International disc mount



MODEL: M 2000

- Steel Lower
- Alloy Crown 116mm pitch
- STKM Stanchions w/Dustboots
- External Coil Spring
- Discmount (option)
- 26", 24", 20" available

XCU SERIES



MODEL: XCM

- Coil Spring, 80 or 100mm travel
- Alloy Lower
- AC4C Accurad Forged crown
- STKM stanchion, STKM steel steerer
- Preload adjuster
- Disc, V-brake, International disc mount



MODEL: XCU

- Coil Spring
- AC4C Accurad Forged crown
- 35mm STKM stanchion, STKM steel steerer
- Disc, V-brake, International disc mount
- 26", 24", 20" available



MODEL: M 2000N

- Steel Lower
- Alloy Crown 108mm pitch
- STKM Stanchions w/Dustboots
- External Coil Spring
- 700C, 26", 24", 20" available

CHAINWHEELS

X-OFF SERIES



MODEL: CW-XOFF-0

- A7050 Forged Alloy
- Center Lock System
- 32/22T Interchangeable Chainrings
- 9-speed compatible
- Anodized Black Finish Arm
- Polycarbonate Bash Guard
- ISIS type BB compatible



MODEL: CW-DUROLUX T854-BRZ

- A7050 Forged Alloy
- 44/32/22T Interchangeable Chainrings
- 9-speed compatible
- ISIS type BB compatible

DUROLUX SERIES



MODEL: CW-DUROLUX -0-BRZ

- A7050 Forged Alloy
- 32/22T Interchangeable Chainrings
- 9-speed compatible
- Polycarbonate Bash Guard
- ISIS type BB compatible

BOTTOM BRACKETS



MODEL: BB-DUROLUX-113 ISIS,

- Hollow Chromo ISIS
- 2 bearing
- M10 axle, 110mm axle length

DURO SERIES



MODEL: CW-DURO-D-PB

- AC4C Accurad Forged Alloy
- 32/22T Interchangeable Chainrings
- 9-speed compatible
- With Aluminum Bash Guard
- Polycarbonate Bash Guard option
- Hexagon type or Square type BB (110)



MODEL: CW-DURO-T32B-PB

- AC4C Accurad Forged Alloy
- 48/38/28T Interchangeable Chainrings
- 9-speed compatible
- Outer Ring Alloy Anodized
- Hexagon type or Square type BB (110)

XCR SERIES



MODEL: CW-XCR T654-PB

- 4-Arm Crank, A6061 Forged Alloy
- 44/32/22T Interchangeable Chainrings
- 9-speed compatible
- Outer Ring Black Alloy Anodized CNC
- ISIS type BB compatible



MODEL: CW-DURO-T324-PB

- AC4C Accurad Forged Alloy
- 44/32/22T Interchangeable Chainrings
- 9-speed compatible
- Outer Ring Black Alloy Anodized CNC
- Hexagon type or Square type BB (110)



MODEL: CW-DURO-T318-PB

- AC4C Accurad Forged Alloy
- 48/38/28T Interchangeable Chainrings
- 9-speed compatible
- Hexagon type or Square type BB (110)



MODEL: CW-XCR T558-PB

- 4-Arm Crank, A6061 Forged Alloy
- 48/38/28T Interchangeable Chainrings
- 9-speed compatible
- Outer Ring Black Alloy Anodized CNC
- ISIS type BB compatible



MODEL: CW-DURO-T314-PB

- AC4C Accurad Forged Alloy
- 44/32/22T Interchangeable Chainrings
- 9-speed compatible
- Hexagon type or Square type BB (110)

BOTTOM BRACKETS



MODEL: BB XCM-110 HEXON

- Hollow Cromo Hexagon design,
- 2 bearing,
- M10 axle, 110mm axle length



MODEL: CW-XCR T554-PB

- 4-Arm Crank, A6061 Forged Alloy
- 44/32/22T Interchangeable Chainrings
- 9-speed compatible
- Outer Ring Black Alloy Anodized CNC
- ISIS type BB compatible

**MODEL:** CW-XCR T458-PB

- 4-Arm Crank, A6061 Forged Alloy
- 48/38/28T Interchangeable Chainrings
- 9-speed compatible
- ISIS type BB compatible

**MODEL:** CW-XCR T454-PB

- 4-Arm Crank, A6061 Forged Alloy
- 44/32/22T Interchangeable Chainrings
- 9-speed compatible
- ISIS type BB compatible

BOTTOM BRACKETS

**MODEL:** BB XCR-113 ISIS

- Hollow Cromo ISIS spline
- 2 bearing
- M15 axle, 113mm axle length

XCM SERIES



new

MODEL: CW-XCM-T318-PB

- AC4C Accurad Forged Alloy
- 48/38/28T Semi-Interchangeable Chainrings
- 8/9-speed compatible
- Hexagon type or square type BB (110)



new

MODEL: CW-XCM T312-PB

- AC4C Accurad Forged Alloy
- 42/32/22T Semi-Interchangeable Chainrings
- 8/9-speed compatible
- Hexagon type or square type BB (110)



new

MODEL: CW-XCM T308-PB

- AC4C Accurad Forged Alloy
- 48/38/28T Riveted Chainrings
- 8/9-speed compatible
- Hexagon type or square type BB (110)



MODEL: CW-XCM T30Z-PB

- AC4C Accurad Forged Alloy
- 42/32/22T Riveted Chainrings
- 8/9-speed compatible
- Hexagon type or square type BB (110)



MODEL: CW-XCC 150-PB

- AC4C Accurad Forged Alloy
- 42/34/24T Riveted Chainrings
- 8/7-speed compatible
- Powder Black Finished Arm



MODEL: CW-NCX 510-HBG

- AC4C Accurad Forged Alloy
- 42/32/22T Interchangeable Chainrings
- 9/8-speed compatible
- Hi Barrel Crank Arm with Chainguard

XCT SERIES



MODEL: CW-XCT T20B-PB

- AC4C Accurad Forged Alloy
- 48/38/28T Riveted Chainrings
- 8-speed compatible
- Power Black Finish Arm



MODEL: CW-XCC 100-PB

- AC4C Accurad Forged Alloy
- 48/38/28T Riveted Chainrings
- 8/7-speed compatible
- Powder Black Finished Arm



MODEL: CW-NCX 420-HBG

- AC4C Accurad Forged Alloy
- 48/38/28T Interchangeable Chainrings
- Alloy outer ring
- 9-speed compatible
- Hi Barrel Crank Arm with Chainguard

NCX SERIES



MODEL: CW-XCC 20Z-PB

- AC4C Accurad Forged Alloy
- 42/32/22T Riveted Chainrings
- 8-speed compatible
- Powder Black Finished Arm



MODEL: CW-NCX 610-HBG

- AC4C Accurad Forged Alloy
- 44/32/22T Interchangeable Chainrings
- 9/8-speed compatible
- Hi Barrel Crank Arm
- With Chainguard



MODEL: CW-NCX 410-HBG

- AC4C Accurad Forged Alloy
- 48/38/28T Interchangeable Chainrings
- 9/8-speed compatible
- Hi Barrel Crank Arm with Chainguard

NEX SERIES

**MODEL:** CW-NEX 200-GNG

- AC4C Accurad Forged Alloy
- 48/38/28T Riveted Chainrings
- 8-speed compatible
- With Chainguard

**MODEL:** CW-NEX 110-ABG

- AC4C Accurad Forged Alloy
- 48/38/28T Riveted Chainrings
- 9/8-speed compatible
- Barrel Finished Arm
- With Chainguard

SUPERBE SERIES

**MODEL:** CW-SP 60D-AZ

- 5-Arm Crank, Forged Alloy
- 53/39T Interchangeable Chainrings
- 8 9-speed compatible
- Alloy Anodized Rings

**MODEL:** CW-SP 60T-AZ

- 5-Arm Crank, Forged Alloy
- 52/42/30T Interchangeable Chainrings
- 9-speed compatible
- Alloy Anodized Rings

**MODEL:** CW-SPcomp-D-HP

- 5-Arm Crank, AC4C Accurad
- Alloy, 53/39T Interchangeable Chainrings
- 9-speed compatible
- Outer Ring Alloy Anodized



MODEL: CW-SPcomp-T-HP

- 5-Arm Crank, AC4C Accurad Alloy
- 52/42/30T Interchangeable Chainrings
- 9-speed compatible
- Outer Ring Anodized AL Alloy



MODEL: CW-SC 44B-ABDG

- 4-Arm Crank, AC4C Accurad Alloy
- 48T Riveted Chainring
- Single 8 speed compatible
- Barrel Finished Arm with Double Chainguards



MODEL: CW-SC238-95-HF

- Single Arm Crank
- AC4C Accurad Alloy
- 38T Revetted Chainring
- Single Speed, 95mm disc integrated design
- Hi finish Arm



MODEL: CW-SP-T-PB

- 5-Arm Crank, AC4C Accurad Alloy
- 52/42/30T Interchangeable Chainrings
- 9-speed compatible
- Powder Black Crank Arm



MODEL: CW-SC 44Z-ABG

- 4-Arm Crank, AC4C Accurad Alloy
- 42T Interchangeable Chainring
- Single 8-speed compatible
- Barrel Finished Arm with Chainguards



MODEL: CW-SC233-95-HF

- Single Arm Crank
- AC4C Accurad Alloy
- 33T Revetted Chainring
- Single Speed, 95mm disc integrated design
- Hi finish Arm

SINGLE SPEED SERIES



MODEL: CW-SCSP4Z-PBG

- 5-Arm Crank, AC4C Accurad Alloy
- 42T Interchangeable Chainring
- Single 9-speed compatible
- Powder Black Finished Arm with Alloy Chainguard



MODEL: CW-SC 344-PBCG

- 4-Arm Crank, AC4C Accurad Alloy
- 44T Interchangeable Chainring
- Single 8-speed compatible
- Powder Black Finished Arm with CNC cut Alloy Chainguard



MODEL: CW-SC233-110-HF

- Single Arm Crank
- AC4C Accurad Alloy, 33T
- Riveted Chainring
- Single speed compatible
- 95mm Disc Integrated Design
- Hi finish Crank Arm

Chart to explain Chainwheel Finishes:

AB: Barrel Finish, AZ: Anodized, BAZ: Black Anodized, HF: Hi-Finish Polish, PB: Powder Black, GNG: Powder Grey, Full Guard, G: Guard

FRONT DERAILLEURS

XCR SERIES



MODEL: FD-XCR 704

- Double action plate mechanism
- Dual Clamp Diameter (31.8 & 34.9),
- Double pull cable route
- 44-32-22T suggested CW combo
- Middle clamp position
- For 66-69 degrees seat tube angle
- For 9-speed



MODEL: FD-XCR 508

- Double action plate mechanism
- Dual Clamp Diameter (31.8 & 34.9),
- Double pull cable route
- 48-38-28T suggested CW combo
- Middle clamp position
- For 66-69 degrees seat tube angle
- For 9-speed



MODEL: FD-XCR 504

- Double action plate mechanism
- Dual Clamp Diameter (31.8 & 34.9)
- Double pull cable route
- 44-32-22T suggested CW combo
- Middle clamp position
- For 66-69 degrees seat tube angle
- For 9-speed



MODEL: FD-XCR 502

- Double action plate mechanism
- Dual Clamp Diameter (31.8 & 34.9)
- Double pull cable route
- 42-32-22T suggested CW combo
- Middle clamp position
- For 66-69 degrees seat tube angle
- For 9-speed

XCC SERIES



MODEL: FD-XCC 322

- Dual Clamp Diameter (31.8 & 34.9)
- Double pull cable route
- 42-32-22T suggested CW combo
- Middle clamp position
- For 66-69 degrees seat tube angle
- For 8-speed

XCR SERIES - Double Action Plate Mechanism, Dual Clamp Diameter, Dual Cable Pull, Smooth Action / **XCC SERIES** - Dual Clamp Diameter, Dual Cable Pull, High Versatility
CR SERIES - Dual Cable Pull, Dual Clamp Diameter, High Versatility / **XR & TP SERIES** - Classic Entry Level, Top or Down Pull Models

CR SERIES

XR SERIES



MODEL: FD-XCC 202

- Dual Clamp Diameter (31.8 & 34.9)
- Double pull cable route
- 42-32-22T suggested CW combo
- Middle clamp position
- For 66-69 degrees seat tube angle
- For 8-speed



MODEL: FD-CR 328

- Dual Clamp Diameter (31.8 & 34.9)
- Double pull cable route
- 48-38-28T suggested CW combo
- Middle clamp position
- For 66-69 degrees seat tube angle
- For 8-speed



MODEL: FD-XR17

- Upper clamp position
- 42-34-24T suggested CW combo
- 28.6 clamp diameter / 31.8 / 34.9 available
- For 66-69 degrees seat tube angle
- Down pull cable route, For 8/7-speed
- Top pull cable route available (FD-TP17)



MODEL: FD-XCC 102

- Dual Clamp Diameter (31.8 & 34.9)
- Double pull cable route
- 42-34-24T suggested CW combo
- Middle clamp position
- For 66-69 degrees seat tube angle
- For 8-speed



MODEL: FD-CR 208

- Dual Clamp Diameter (31.8 & 34.9)
- Double pull cable route
- 48-38-28T suggested CW combo
- Middle clamp position
- For 66-69 degrees seat tube angle
- For 8-speed



MODEL: FD-XR05

- Upper clamp position
- 48-38-28T suggested CW combo
- 28.6 clamp diameter / 31.8 / 34.9 available
- For 66-69 degrees seat tube angle
- Down pull cable route
- For 8/7-speed Shimano compatible
- Top pull cable route available (FD-TP17)

REAR DERAILLEURS



MODEL: RD-DUROLUX-GTB

- 9-speed, Full Alloy body
- Forged Alloy short cage
- 10T front teeth difference
- 11-34T rear sprocket, 33T total
- 33T total capacity
- 1:1 stroke



MODEL: RD-DUROLUX-SGX

- 9-speed, Full Alloy body
- Alloy long cage
- 24T front teeth difference
- 11-34T rear sprocket
- 47T total capacity
- 1:1 stroke



MODEL: RD-DURO 720-GTB

- 9-speed, Alloy body
- Short cage
- 10T front teeth difference
- 11-34T rear sprocket
- 33T total capacity
- 1:1 stroke



MODEL: RD-DURO 720-SGX

- 9-speed, Alloy body
- Long cage
- 24T front teeth difference
- 11-34T rear sprocket
- 47T total capacity
- 1:1 stroke



MODEL: RD-XCM660-GTB

- 8/9 speed
- Short cage
- 10T front teeth difference
- 11-34T rear sprocket
- 33T total capacity
- 1:1 stroke



MODEL: RD-XCM660-SGX

- 8/9-speed, Long cage
- 20T front teeth difference
- 11-30T rear sprocket
- 39T total capacity
- 1:1 stroke



MODEL: RD-XR 180-GXB

- Without hangar bracket
- 7-speed
- 20T front teeth difference
- Light action
- 12-30T rear sprocket
- 38T total capacity
- Shimano compatible



MODEL: RD-XR 180-GTB (Z)

- With hangar bracket
- 7-speed
- 10T front teeth difference
- Light action
- 12-30T rear sprocket
- 28T total capacity
- Shimano compatible

REAR DERAILLEUR CAGE LENGTH



MODEL: GTB - SHORT CAGE

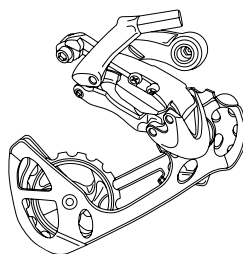

MODEL: SCX - LONG CAGE

DRIVETRAIN - & SUSPENSION CONTROL SHIFTERS

DRIVETRAIN SHIFTERS (ONE HAND SHIFTERS)



MODEL: DSM-XCR 61-DR 3X9

- I.C.E. = Integrated Control Equipment
- Movable grip: Compact for rear (1:1 stroke)
- Under bar shifter: Single lever auto-return type for front



MODEL: DSM-XCR 51-DR 3X8

- I.C.E. = Integrated Control Equipment
- Movable grip: Compact for rear (1:1 stroke)
- Under bar shifter: Single lever auto-return type for front



MODEL: DSC-NCX 60-DR 3X9

- I.C.E. = Integrated Control Equipment
- Movable grip: Long rear (1:1 stroke)
- Under bar shifter: Single trigger auto-return type for front

SUSPENSION CONTROL SHIFTERS

**MODEL:** DSC-NCX 50-DR 3XB

- I.C.E. = Integrated Control Equipment
- Movable grip: Long rear (1:1 stroke)
- Under bar shifter: Single lever auto-return type for front

**MODEL:** DSM-XCR 61-SC

- Short Grip Shift Style Remote Lockout
- Integrated Remote Lever for Travel Adjust
- Alloy Clamp
- Cable Adjuster

**MODEL:** SL-DUR027E-R9/L3

- One Lever Dual Action Trigger
- Auto return System
- Rear: 9-speed (1:1 stroke)
- Front: 3-speed

**MODEL:** TSM-XCR 61-RL

- Grip Shift Style (Compact)
- Remote Lockout Lever
- Alloy Clamp
- Cable Adjuster

**MODEL:** SL-DUR018E-R9/L2

- One Lever Dual Action Trigger
- Auto return System
- Rear: 8-speed (1:1 stroke)
- Front: 3-speed

**MODEL:** TSC-NCX 60-RL

- Grip Shift Style (long)
- Remote Lockout Lever
- Alloy Clamp
- Cable Adjuster

**MODEL:** SLSSC-LTR

- Remote Travel Adjust Lever
- Underbar Position
- Alloy Clamp
- Cable Adjuster

**MODEL:** SLSSC-RLD

- Remote Lock Out Lever
- Underbar Position
- Alloy Clamp
- Cable Adjuster

CASSETTES

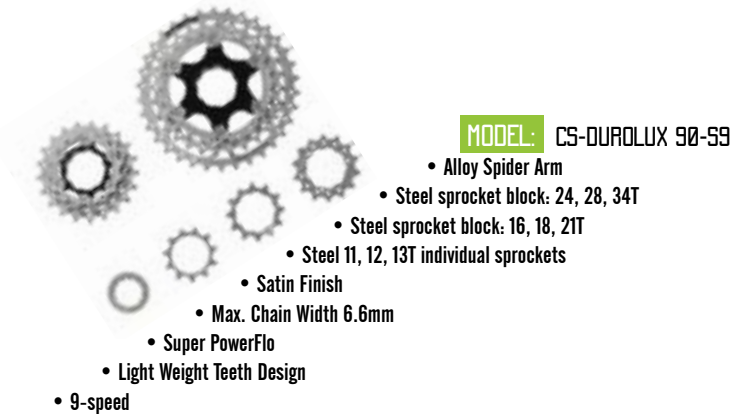
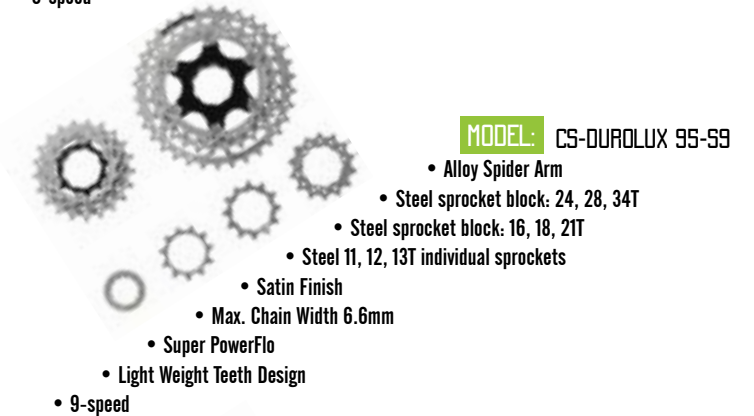
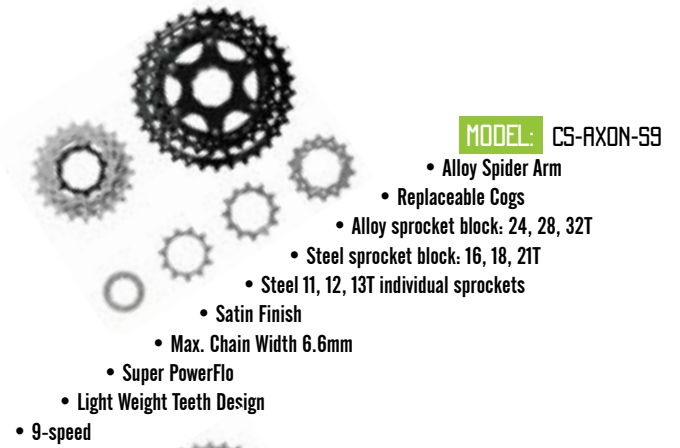



MODEL: CS-SPF 75-S9

- 11-34T
- Satin Finish
- Max. Chain Width 6.6mm
- Super Weigth Teeth Design
- 9-speed



MODEL: CS-PF 44-C8

- 11-32T
- Chrome-Plated finish
- Max. Chain Width 7.1mm
- 8-speed



MODEL: CS-PF 32-C7

- 11-30T
- Chrome-Plated finish
- Max. Chain Width 7.3mm
- 7-speed



MODEL: CS-SPF 70-S9

- 11-32T
- Satin Finish
- Max. Chain Width 6.6mm
- Super Weigth Teeth Design
- 9-speed



MODEL: CS-PF 41-C8

- 11-30T
- Chrome-Plated finish
- Max. Chain Width 7.1mm
- 8-speed



MODEL: CS-PF 30-C7

- 12-28T
- Chrome-Plated finish
- Max. Chain Width 7.3mm
- 7-speed



MODEL: CS-PF 48-C8

- 11-34T
- Chrome-Plated finish
- Max. Chain Width 7.1mm
- 8-speed



MODEL: CS-PF 30Z-C7

- 12-30T
- Chrome-Plated finish
- Max. Chain Width 7.3mm
- 7-speed

SEATPOSTS, PEDAL, & TOOLS



SEATPOSTS

new

MODEL: SP-NCX-04

- 48mm Travel
- Parallelogram suspension design
- Coil Spring (2 Pcs) Suspension system
- One bolt clamp design
- Diameter 27.2 or 26.6mm x 350mm L
- Saddle base width, 43.5mm
- Alloy Arm
- Alloy Upper
- Anti-slip pin design
- Finish; Silver / Powder black
- Optional Safety cover available



new

MODEL: SP-NEX-02

- 48mm Travel
- Parallelogram suspension design
- Coil Spring (2 Pcs) Suspension system
- One bolt clamp design
- Diameter 27.2mm x 350mm L
- Saddle base width, 43.5mm
- Steel Arm with plastic cover
- Alloy Upper, Anti-slip pin design
- Finish; Silver / Powder black,
- Optional Safety cover available



PEDALS



MODEL: PL-NX80

- One kick folding system
- Alloy body
- Rubber plate
- Loose ball bearing
- Reflector integrated design
- Non-slip plate



MODEL: PL-NX60

- One kick folding system
- Resin body
- Loose ball bearing
- Reflector integrated design
- Rubber plate
- Non-slip plate

TOOLS



MODEL: FORK MAINTENANCE TOOL KIT

- 1) Quick wrench
- 2) Set of: 5mm long wrench
- 3) Set of: 27mm AL top cap box wrench
- 4) Set of: 21mm AL top cap box wrench
- 5) Preload adjuster removal tool for MTB FAA-122
- 6) Preload adjuster removal tool for Trekking FAA-086
- 7) SR Suntour Grease kit

HUB DYNAMO



MODEL: DH-CT600-SERIES

Our new DH-CT600-Series is a compact light and efficient dynamo hub. It is developed to match the latest german regulations StVZO §22a. Some of the requirements are increased efficiency, voltage limitation and a characteristic of the voltage/speed- which reduces flashing when riding at a very low speed.

The DH-CT600-Series dynamo hub is of course optimized in weight and rolling resistance and is including a state of the art connector which makes the wheel disassembly and assembly as easy as possible.



MODEL: DH-CT600-SERIES VARIATIONS

- Alloy body
- New german standard approved including K-mark and wave symbol
- 6V-3W or 6V-2.4W models
- 32H or 36H
- Silver or Black
- Nut type or quick release type
- Weight is approximately xxx grams

OUTPUT VOLTAGE COMPARISON

Conventional dynamo hub without voltage limitation (old StVZO-Standard)

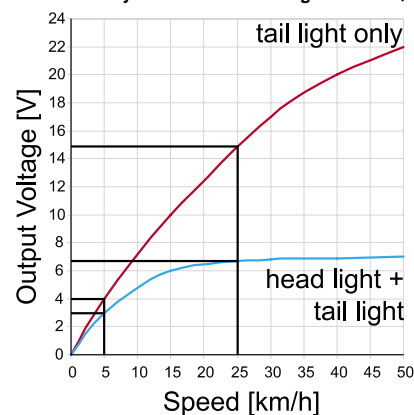

DH-CT600-Series dynamo hub with voltage limitation (new StVZO-Standard)

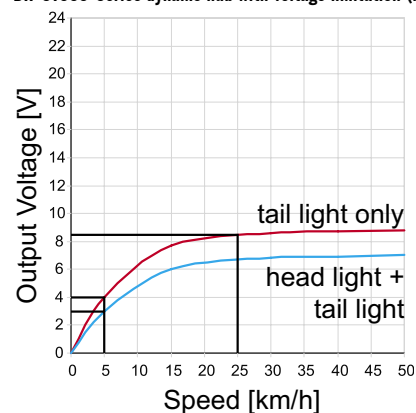

The voltage limitation prevents bulb breakdown caused by over voltage. This usually happens on conventional dynamos without voltage limitation.

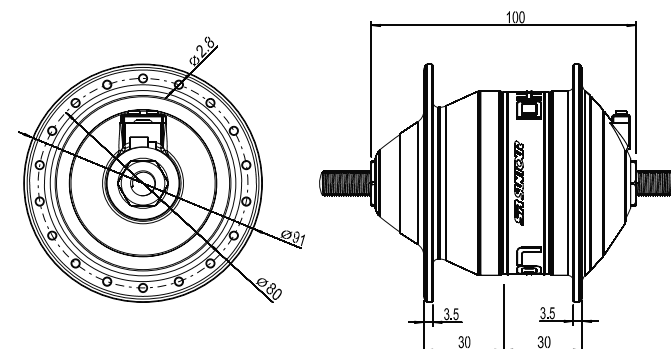

DIMENSION SR SUNTOUR DH-CT600-SERIES



Model variations and Itmes-Numbers SR Suntour DH-CT600-Series

Model Name	Description
DH-CT624-NT36	Nut type Output: 6V/2.4W (EU except for Germany) Silver or Black finish number of spoke holes 36
DH-CT630-NT36	Nut type Output: 6V/3.0W (EU) Silver or Black finish number of spoke holes 36
DH-CT624-NT32	Nut type Output: 6V/2.4W (EU except for Germany) Silver or Black finish number of spoke holes 32
DH-CT630-NT32	Nut type Output: 6V/3.0W (EU) Silver or Black finish number of spoke holes 32
DH-CT624-QR36	Quick release type Output: 6V/2.4W (EU except for Germany) Silver or Black finish number of spoke holes 36
DH-CT630-QR36	Quick release type Output: 6V/3.0W (EU) Silver or Black finish number of spoke holes 36
DH-CT624-QR32	Quick release type Output: 6V/2.4W (EU except for Germany) Silver or Black finish number of spoke holes 32
DH-CT630-QR32	Quick release type Output: 6V/3.0W (EU) Silver or Black finish number of spoke holes 32

FORK OVERVIEW

PERFORMANCE	X-COUNTRY	ALLMOUNTAIN	FREERIDE	STREET	CROSS	TEKKING
 TRIPLE SCOOP W. CREAM	AXON-S-RL AXON-E-RL	CONDOR-TA XC-PRO-S-TR XC-PRO-S-TAD XC-PRO-E-TR XC-PRO-E-TAD	RUX-T RUX-S RUX-E		NCX-FT-S-RL NRX9100-RL NCX-S-RL NCX-FT-E-RL/LO NRX8200-RL NCX-E-RL NRX8100-LO	CR990-LO CR980LW
 TRIPLE SCOOP	AXON-D-RL AXON-D-LO	XCR-TA	DURO-E DURO-D		NCX-FT-D-RL/LO NRX7600-RL NRX6500-LO NCX-D-LO	CR940-LO
 DOUBLE SCOOP		XCR-RL XCR-LO XCR XCM-H-LO			NCX-FT-D NRX6000 NCX-D SP-NCX	CR930
 SINGLE SCOOP		XCM	XCU	XCT-LO XCT M2000	NEX4500-LO NEX4000 SP-NEX M3010 M2000N	CR860-LO CR850 CR820W

DISTRIBUTOR ADDRESSES

SR SUNTOUR CORPORATE

TAIWAN
SR SUNTOUR INC.
#7 HSING YEH RD
FU HSING INDUSTRIAL ZONE
CHANG HUA
TEL. 886-4-7695115
FAX 886-4-7694028
E-MAIL: ORDERS@SRSUNTOUR.COM.TW
WEBSITE: WWW.SRSUNTOUR-CYCLING.COM

CHINA
SR SUNTOUR (SHEN ZHEN) INC.
SUIBEI INDUSTRIAL ZONE SUIBEI ROAD
GONGMING TOWN, BADAN DISTRICT
SHEN ZHEN
TEL. 86-755-27105533
FAX 86-755-27105633

SR SUNTOUR MACHINERY (KUNSHAN) CO.
LTD
NO6, GAODING ROAD
KUNJIA INDUSTRIAL ZONE
KUNSHAN CITY, JIANGSU PROVINCE
TEL. 86-512-7811972
FAX 86-512-7811972

EUROPE

SR SUNTOUR EUROPE GMBH
AM MARSCHELLFELD 6A
83626 VALLEY
GERMANY
TEL. 49-8024-3038152
FAX 49-8024-4730984
E-MAIL: SERVICE@SRSUNTOUREUROPE.COM

USA
SR SUNTOUR USA
P.O. BOX 61988
VANCOUVER, WA 98666, USA
TEL. 1-360-737-6450
FAX. 1-360-737-6452
E-MAIL: SERVICE@USULCORP.COM

AUSTRIA
KTM FAHRRAD GMBH
HARLOCHNER STR. 13
5230 MATTIGHOFEN
TEL. 43-7742-409134
FAX 43-7742-409126
E-MAIL: OFFICE@KTM-BIKES.AT
WEBSITE: WWW.KTM-BIKES.AT

BRAZIL
INTAC
RUE ALBA, 1737 – V.SANTA, CATARINA
04346-000, SAO PAULO
TEL. 55-11-5565-2100

COLOMBIA
HA BICICLETAS
CALLE 14 NO. 52A-187
APARTADO AEREO 368
MEDELLIN - COLOMBIA
TEL: +57-4-2855040
FAX NO.: +57-4-2553343
E-MAIL: HABICI@ELSITIO.NET.CO

CZECH REPUBLIC
BP LUMEN
PUSKINOVA 546
54232 UPICE
TEL. 42-499-881327
FAX 42-499-881327
E-MAIL: INFO@BPLUMEN.CZ
WEBSITE: WWW.BPLUMEN.CZ

FRANCE
EUROSTAR
Z.I. DE LA SEIGLERIE
44270 MACHECOUL
TEL. 33-2-40782400
FAX 33-2-40022874

GERMANY
E. WIENER BIKE PARTS GMBH
MAX-PLANCK-STR. 8
97526 SENNFELD
POSTFACH 1561
97405 SCHWEINFURT
TEL. 49-9721-650188
FAX 49-9721-650173

ZWEIRAD-EINKAUFSGE-NOSSENSCHAFT EG
LONGERICH STR. 2
50739 KÖLN
TEL. 49-221-1795920
FAX 49-221-1795931

HUNGARY
AVEX LTD
3 CSENERICS RD
SZAZHALOMBATTA
MAIL: H-2442 SZAZHALOMBATTA, PO BOX 15
TEL. 36-23-358677
FAX 36-23-354520
E-MAIL: AVEXKFT@AXELERO.HU
WEBSITE: WWW.HAUSER.HU

ITALY
SAIM S.P.A.
VIA LEON BATTISTA ALBERTI 10
20149 MILANO
TEL. 39-02-3491616
FAX 39-02-3491613
E-MAIL: SAIM.CICLO@SAIM-GROUP.COM

JAPAN
RITEWAY PRODUCTS JAPAN
102 Ikebukuro City-Highs
3-18-34 Minami Ikebukuro
Toshima-Ku, Tokyo
TEL. 81-3-590506002
FAX 81-3-59568028
E-MAIL: RPJINFO@GT-JAPAN.COM.JP
WEBSITE: WWW.RITEWAY-JP.COM

MEXICO
BICICLO S.A. DE C.V.
EJE 126 NO. 265 ZONA INDUSTRIAL
DEL PORTOSI Z.C. 78395
SAN LUIS PORTOSI S.L.P. MEXICO
TEL. 52-444-824-0139
FAX. 52-444-824-0279
E-MAIL: BICICLETAS@TURBO.COM.MX
WEBSITE: WWW.TURBO.COM.MX

POLAND
R&P PAWLAK SP. Z.O.O.
UL. STAROLECKA 18
61-361 POZNAN
TEL. 48-61-8787335
FAX. 48-61-6531066
E-MAIL: OFFICE@RP-PAWLAK.HOME.PL

SLOVAKIA
KCK CYCLOSPORT-MODE S.R.O.
MEROVA 854/37
97247 OSLANY
TEL. 421-46-5492200
FAX. 421-46-5492350
E-MAIL: KCK@KCK-OSLANY.SK
WEBSITE: WWW.KCK-OSLANY.SK

SPAIN
BH, S.A. BICICLETAS DE ALAVA S.A.
ARCACHA 1
01006 VITORIA
TEL. 34-945-135202 / 135708
FAX. 34-945-139321 / 234810

SWITZERLAND
SUSPENSION CENTER
GURNIGELSTRASSE 11, 3132 RIGGISBERG
SWITZERLAND
TEL. 41-31-809 3020
FAX. 41-31-809 3022
EMAIL: SUSPENSION.CENTER@BLUEWIN.CH
WWW.SUSPENSIONCENTER.CH

BENELUX
JUNCKER BIKE PARTS
FOKKERSTRAAT 25
3905 KV VEENENDAAL
TEL. 31-318-553030
FAX. 31-318-51308307
E-MAIL: INFO@JUNCKER.NL
WEBSITE: WWW.JUCKER.NL

UK
GREYVILLE ENTERPRISES
20 EUROPAY
BRITANIA ENTERPRISE PARK
LICHFIELD, STAFFS. WS14 9TZ
TEL. 44-1543-251328
FAX. 44-1543-256260
E-MAIL: SALES@GREYVILLE.COM

MOORE LARGE & CO. LTD
DERBY DE24 9GL
SINFIN LANE
SINFIN LANE INDUSTRIAL ESTATE
TEL. 44-133-2274238
FAX. 44-133-2274201
EMAIL: SALES@MOORELARGE.CO.UK

USA
BICYCLE TECHNOLOGIES INTERNATIONAL LTD
1216 MERCANTILE RD
SANTA FE, NM 87507
TEL. 1-505-4731010
FAX. 1-505-4730011
E-MAIL: INFO@BTI-USA.COM
WEBSITE: WWW.BTI-USA.COM

SEATTLE BIKE SUPPLY
7620 S. 192ND
KENT, WA 98032
WEBSITE: WWW.SEATTLEBIKESSUPPLY.COM

HEADQUARTERS

TAIWAN

SR SUNTOUR INC.
#7 HSING YEH RD
FU HSING INDUSTRIAL ZONE
CHANG HUA
TEL. 886-4-7695115
FAX 886-4-7694028
ORDERS@SRSUNTOUR.COM.TW
WWW.SRSUNTOUR-CYCLING.COM

CHINA (SHEN ZHEN)

SR SUNTOUR (SHEN ZHEN) INC.
SUIBEI INDUSTRIAL ZONE SUIBEI
ROAD
GONGMING TOWN, BAOAN DISTRICT
SHEN ZHEN
TEL. 86-755-27105533
FAX 86-755-27105633

CHINA (KUNSHAN)

SR SUNTOUR MACHINERY (KUNSHAN)
CO. LTD
NO.6, GAODING ROAD
KUNJIA INDUSTRIAL ZONE
KUNSHAN CITY, JIANGSU PROVINCE
TEL. 86-512-7811972
FAX 86-512-7811972

EUROPE

SR SUNTOUR EUROPE GMBH
AM MARSCHALLFELD 6A
83626 VALLEY
GERMANY
TEL. 49-8024-3038152
FAX 49-8024-4730984
SERVICE@SRSUNTOUREUROPE.COM

USA

SR SUNTOUR USA
P.O. BOX 61988
VANCOUVER, WA 98666, USA
TEL: 1-360-737-6450
FAX: 1-360-737-6452
SERVICE@USULCORP.COM

SR SUNTOUR

www.srsuntour-cycling.com