



Sunringle

TRUE.



TJ LAVIN
PHOTO: STEVE BUDDENDECK

Sunringle 2004

MTB : 4-15

ROAD : 16-19

BMX : 20-27

OEM : 28

SOFTGOODS : 29





CHRIS KOVARIK
PHOTO: DYLAN DEAN DESIGNS



MTB 2004

WHEELSETS

REDUCED ROTATIONAL WEIGHT

Location weights of the three integrated parts of a wheel (i.e. the rim, spokes and hubs) are actually more important than the total wheel weight

STRONG

Our rims are designed and manufactured by us and trusted by the world's greatest athletes. We know what we're doing, we've been doing it for over 50 years.

SERVICEABLE

We've taken the mystery out of your wheelset. No faddish designs that cost more because of their looks. No special tools needed. We're not reinventing the wheel, we're building it better.

QUALITY & VALUE

No one else offers as light, strong and durable wheelsets. Hand built in the good ol' U.S.A. by experienced wheelbuilders for sometimes hundreds less than those other wheels.

RIMS

DISC-BRAKE SPECIFIC DESIGNS

By eliminating the need for full sidewalls, we have built a stronger rim that will hold up to the spoke-pulling stresses encountered with disc-brake use, while still making a lightweight rim.

TRIP HOLLOW DESIGNS

A rim with three channels in the cross-section provides increased stability under hard impacts and fatiguing forces that happen regularly on downhill.

DOUBLE-WALL DESIGNS

Provides the right mixture between strength, rigidity and lightweight for all types of cross-country riding.

COMPONENTS

HIGH QUALITY ALLOYS

Only the best designs for our products. Designed from the start to finish to determine what type of alloy should be used on a particular component, wheelset or rim and why. Like, we said... only the best!

COMPETITION PROVEN DESIGNS

It's got to work on the battlefield first. On race courses and in skateparks around the world, our products display their winning form to help top athletes concentrate on their riding and trust in our products to take them to the top.

INDUSTRY LEADING CONCEPTS

From rider to our multi-compatible disc-brake hubs to our exclusive D-shaped axle we've lead the way in making components better and better. Anyone can make components, but only the best can make components better.

RIM TECHNOLOGY



PRB: PINCH RESISTENT BEAD-CLINCH is our exclusive rounded, hollow tire bead clinch. Keeps tubes from flatting on hard impacts by increasing the rounded rim material that will contact the tube.



TCB: TOTAL CONTROL BRAKING combines a welded rim seam with a precision machined brake surface. No visible seam on the rim gives you the ultimate in braking control.



L7: Allows us to provide a precision machined braking surface on a lighter sleeved / pinned rim for even better braking control.



ABT: ADVANCED BRAKE TRACK is a specially finished brake surface. It provides a smooth raw aluminum brake track, for more controlled braking. ABT is standard on all Red, Black, Gun Metal and Titanium anodized finished, as well as the polished finish.

MTB WHEELSETS



R.P.M. LITE

USE:
CROSS COUNTRY RIDING AND RACING
FRONT HUB:
24 HOLE SUN OF BUBBA (BLACK)
REAR HUB:
28 HOLE 439 LITE (BLACK)
RIM:
0 DEGREE LITE (BLACK) (L7)
SPOKES:
14/15 GAUGE DOUBLE BUTTED (BLACK)
NIPPLES:
ALLOY
LACING:
RADIAL (F), 2 CROSS (R)
WEIGHT:
680g (F), 970g (R)



R.P.M.

USE:
CROSS COUNTRY RIDING AND RACING
FRONT HUB:
28 HOLE SUN OF BUBBA (BLACK)
REAR HUB:
32 HOLE 439 OR 439 LITE (BLACK)
RIM:
0 DEGREE XC (BLACK) (TCB)
SPOKES:
14/15 GAUGE DOUBLE BUTTED (BLACK)
NIPPLES:
ALLOY
LACING:
RADIAL (F), 2 CROSS (R)
WEIGHT:
700g (F), 1,000g (R)



BLACK FLAG

USE:
CROSS COUNTRY RACING
FRONT HUB:
24 HOLE SUN RINGLE FLEA, SEALED
CARTRIDGE BEARINGS (BLACK)
REAR HUB:
28 HOLE SUN RINGLE FLEA, SEALED
CARTRIDGE BEARINGS (BLACK)
RIM:
UFO (BLACK) (TCB)
SPOKES:
SAPIM LASER DOUBEL BUTTED 14/15
GAUGE (BLACK)
NIPPLES:
SAPIM POLYAX SELF LOCKING ALLOY
LACING:
RADIAL (F), 2 CROSS (R)
WEIGHT:
570g (F), 720g (R)



S.U.V.

USE:
4 CROSS, FREERIDING
FRONT HUB:
32 OR 36 HOLESUPER DUPER BUBBA OR
SOB (BLACK)
REAR HUB:
32 OR 36 HOLE 439 (BLACK)
RIM:
24" OR 26" RHYNO LITE XL
(BLACK) (TCB)
SPOKES:
14 GAUGE DOUBLE BUTTED (BLACK)
NIPPLES:
BRASS
LACING:
3 CROSS (F/R)
WEIGHT:
950g (F), 1,200g (R)



DISK JOCKEY

USE:
DISC SPECIFIC CROSS COUNTRY RIDING, RACING
FRONT HUB:
32H SUN RINGLE XC DISC, SEALED CARTIDGE
BEARINGS (BLACK)
REAR HUB:
32H SUN RINGLE XC DISC, SEALED CARTIDGE
BEARINGS (BLACK)
RIM:
DS2-XC (BLACK)
SPOKES:
14/15 GAUGE DOUBLE BUTTED (BLACK)
NIPPLES:
BRASS
LACING:
3 CROSS (F/R)
WEIGHT:
944g (F), 1,175g (R)



DISC-O-TEK

USE:
DISC SPECIFIC CROSS COUNTRY RIDING, RACING
FRONT HUB:
32 HOLE ABBAA S.O.S. XC (BLACK)
REAR HUB:
32 HOLE ABBAA S.O.S. STANDARD REAR
(BLACK)
RIM:
DS1-XC (BLACK)
SPOKES:
14/15 GAUGE DOUBLE BUTTED (BLACK)
NIPPLES:
BRASS
LACING:
2 CROSS (F/R)
WEIGHT:
785g (F), 1,015g (R)



S.U.V. DISC

USE:
4 CROSS, FREERIDING, DOWNHILL

FRONT HUB:
32 OR 36 HOLE ABBAH S.O.S. XC OR DH (BLACK)

REAR HUB:
32 OR 36 HOLE ABBAH S.O.S. STANDARD
REAR OR 12mm THRU AXLE (BLACK)

RIM:
24" OR 26" RHYNO LITE XL (BLACK) (TCB)

SPOKES:
14 GAUGE (BLACK)

NIPPLES:
BRASS

LACING:
3 CROSS (F/R)

WEIGHT:
1,075g (F), 1,230g (R)



SINGLETRACK

USE:
DISC SPECIFIC DOWNHILL, 4 CROSS, FREERIDING

FRONT HUB:
32 OR 36 HOLE ABBAH XC OR DH (BLACK)

REAR HUB:
32 OR 36 HOLE ABBAH S.O.S. STANDARD
REAR OR 12mm THRU AXLE (BLACK)

RIM:
24 OR 26" SINGLETRACK (BLACK) (PRB)

SPOKES:
14 GAUGE (BLACK)

NIPPLES:
BRASS

LACING:
3 CROSS (F/R)

WEIGHT:
1,100g (F), 1,220g (R)



EIGHT TRACK

USE:
DOWNHILL, 4 CROSS, FREERIDING

FRONT HUB:
32 OR 36 HOLE ABBAH S.O.S. XC OR DH (BLACK)

REAR HUB:
32 OR 36 HOLE ABBAH S.O.S. STANDARD
REAR OR 12MM THRU AXLE (BLACK)

RIM:
26" OR 24" MTX (BLACK) (TCB)

SPOKES:
14 GAUGE (BLACK)

NIPPLES:
BRASS

LACING:
3 CROSS (F/R)

WEIGHT:
1,088g (F), 1,270g (R)



INTENSE MAG 30

USE:
SERIOUS DOWNHILL, 4 CROSS, FREERIDING

FRONT HUB:
CUSTOM 32 OR 36 HOLE ABBAH S.O.S. DH (BLACK)

REAR HUB:
32 OR 36 HOLE ABBAH S.O.S. STANDARD
REAR OR 12MM THRU AXLE (BLACK)

RIM:
26" OR 24" INTENSE MAG 30 (GRAPHITE GREY) (PRB)

SPOKES:
14 GAUGE (BLACK)

NIPPLES:
BRASS

LACING:
3 CROSS (F/R)

WEIGHT:
1,225g (F), 1,375 (R)



MODO

USE:
DISC SPECIFIC HARDCORE DOWNHILL

FRONT HUB:
32 OR 36 HOLE ABBAH S.O.S. DH

REAR HUB:
32 OR 36 HOLE ABBAH S.O.S. STANDARD
REAR OR 12MM THRU AXLE

RIM:
26" OR 24" DOUBLEWIDE (BLACK) (PRB)

SPOKES:
14 GAUGE BLACK

NIPPLES:
BRASS

LACING:
3 CROSS (F/R)

WEIGHT:
1,450g (F), 1,600g (R)



MARKUS ZANDER
PHOTO: KAI DUDENHOFER

CR18 »

USE:
CROSS COUNTRY RIDING, TRAINING, TOURING

SIZES:
559mm

E.R.D.:
548

WEIGHT:
440g

HOLE COUNTS:
32, 36

COLORS:
BLACK



FEATURES: **ABT** **L7**

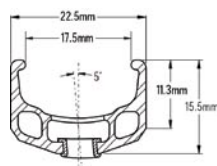

MACH IV »

USE:
CROSS COUNTRY RIDING AND RACING

SIZES:
559mm

E.R.D.:
544

WEIGHT:
405g

HOLE COUNTS:
28, 32

COLORS:
BLACK



FEATURES: **L7**

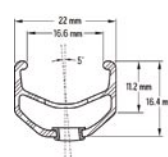

0 DEGREE XC »

USE:
CROSS COUNTRY RIDING AND RACING

SIZES:
559mm

E.R.D.:
544

WEIGHT:
422g

HOLE COUNTS:
28, 32

COLORS:
SILVER, BLACK



FEATURES: **TCB**

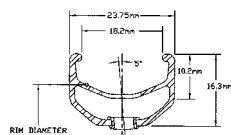

UFO »

USE:
CROSS COUNTRY RACING

SIZES:
559mm

E.R.D.:
538

WEIGHT:
370g - 395g

HOLE COUNTS:
24, 28, 32

COLORS:
BLACK



FEATURES: **TCB**

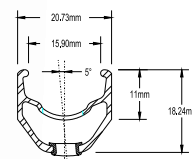

DS2-XC SLEEVED »

USE:
CROSS COUNTRY RIDING, RACING FOR BIKES WITH DISC BRAKES

SIZES:
559mm

E.R.D.:
545

WEIGHT:
400g

HOLE COUNTS:
32, 36

COLORS:
BLACK

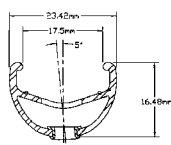

DS1-XC WELDED »

USE:
CROSS COUNTRY RIDING, RACING FOR BIKES WITH DISC BRAKES

SIZES:
559mm

E.R.D.:
545

WEIGHT:
400g

HOLE COUNTS:
32, 36

COLORS:
BLACK

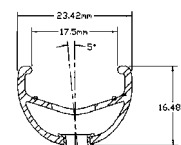



RHYNO LITE »

USE:
XC RIDING AND RACING, DUAL SLALOM

SIZES:

559mm

E.R.D.:

548

WEIGHT:

550g

HOLE COUNTS:

32, 36, 40, 48

COLORS:

BLACK



FEATURES:

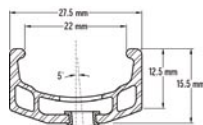

RHYNO LITE XL »

USE:
DOWNHILL, 4 CROSS RIDING AND RACING

SIZES:

507mm, 559mm

E.R.D.:

493, 548

WEIGHT:

512g, 565g

HOLE COUNTS:

32, 36

COLORS:

BLACK



FEATURES:

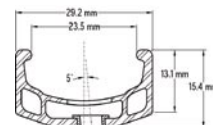

MAMMOTH »

USE:
DOWNHILL AND 4 CROSS RIDING AND RACING

SIZES:

507mm, 559mm

E.R.D.:

492, 548

WEIGHT:

625g, 705g

HOLE COUNTS:

32, 36

COLORS:
BLACK, SILVER - WITH OR
WITHOUT CENTER STRIP

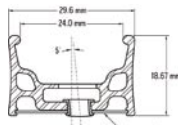

SINGLE TRACK »

USE:
DOWNHILL, 4 CROSS RIDING AND RACING

SIZES:

507mm, 559mm

E.R.D.:

491, 543

WEIGHT:

540g, 590g

HOLE COUNTS:

32, 36

COLORS:
BLACK



FEATURES:

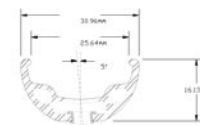

S-TYPE »

USE:
4-CROSS AND FREERIDING

SIZES:

507mm, 559mm

E.R.D.:

480, 530

WEIGHT:

605g, 640g

HOLE COUNTS:

32, 36

COLORS:
BLACK, POLISHED



FEATURES:

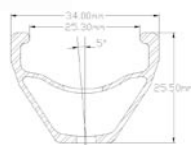

MTX »

USE:
4-CROSS AND FREERIDING

SIZES:

507mm, 559mm

E.R.D.:

480, 530

WEIGHT:

605g, 640g

HOLE COUNTS:

32, 36

COLORS:
BLACK, POLISHED



FEATURES:



MTB RIMS

SINGLEWIDE »

USE:
DOWNHILL AND 4 CROSS RIDING AND RACING

SIZES:
559mm

E.R.D.:
543

WEIGHT:
665g

HOLE COUNTS:
32, 36

COLORS:
BLACK, HARD ANO BLUE

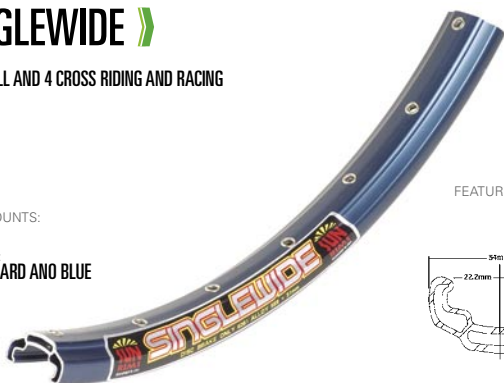

FEATURES: **PRB**

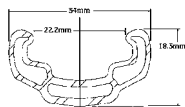

DOUBLE TRACK »

USE:
4-CROSS AND FREERIDING

SIZES:
507mm, 559mm

E.R.D.:
475, 525

WEIGHT:
760g, 850g

HOLE COUNTS:
32, 36

COLORS:
BLACK



FEATURES: **PRB**

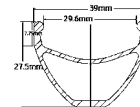

INTENSE MAG 30 DH »

USE:
DOWNHILL RIDING AND RACING FOR BIKES WITH DISC BRAKES

SIZES:
507mm, 559mm

E.R.D.:
475, 525

WEIGHT:
760g, 850g

HOLE COUNTS:
32, 36

COLORS:
GRAPHITE GREY



FEATURES: **PRB**

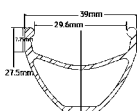

DOUBLEWIDE »

USE:
DOWNHILL RIDING AND RACING FOR BIKES WITH DISC BRAKES

SIZES:
507mm, 559mm

E.R.D.:
486, 541

WEIGHT:
795g, 885g

HOLE COUNTS:
32, 36

COLORS:
BLACK POWDER COAT



FEATURES: **PRB**

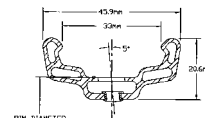

CHRISTIAN BOHRER
PHOTO: KAI DUDENHOEFER



SUN TUBELESS SYSTEM (STS): Sun delivers the latest advancement in tubeless rim technology.

STS is user friendly, checkbook friendly, and builds like any conventional wheelset (special hubs are not required). It is compatible with most tubeless tires on the market.

STS MOUNTING GUIDELINES

- » insert the valve stem through the hole in the end of the rubber strip from the channel side (sketch 1).
- » push the stem down until the crown of the stem is touching the bottom of the strip channel. the sides of the channel will be slightly flattened outward.
- » insert the valve stem in the rim. push it down firmly until the strip is seated against the bottom of the rim channel.
- » put the nut on the stem and tighten it snugly to trap the strap securely, achieving an airtight seal, do not overtighten (sketch 2).
- » starting at the stem, work around the rim with your fingers, pressing the strip into the rim channel. put a suitable adhesive such as superglue, weather-strip adhesive, or tubular tire cement on the last one inch of the strip. press the end of the strip into place, butting it up against the other end. hold in place allowing glue to set.
- » mount the tire in the conventional way, making sure to locate the tire bead in the channel to facilitate mounting (sketch 3).
- » once the tire is mounted visually check around the rim to determine if the beads are centered into the sealing strip channel. determine if the channel is properly seated (sketch 4).
- » inflate the tire using either a high volume hand pump or an air compressor. if needed, soap solution around the beads will help the tire seating. the tire beads will pop as they seat onto the rim.
- » to remove the tire, break the side of the tire loose by pushing it towards the center of the rim. seat it in the rim channel, prying it off in the conventional manner. unseat the remaining side and remove it by using the same method.
- » it is recommended that a new sealing strip be used if the original strip is removed for any reason.

sketch 1

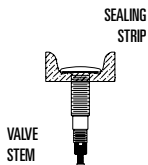

sketch 2

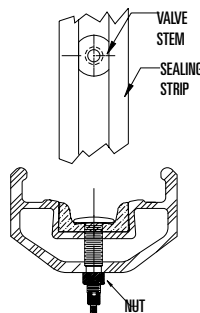

sketch 3

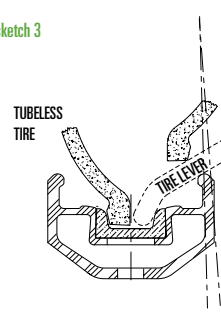

sketch 4

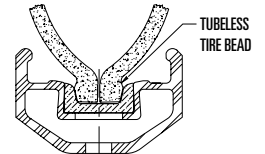

*sketches not to scale

BOBBIT TUBELESS »

USE:
CROSS COUNTRY RIDING AND RACING
SIZES:
559mm
E.R.D.:
543
WEIGHT:
610g
HOLE COUNTS:
32, 36
COLORS:
BLACK

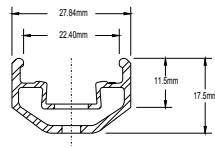

SINGLE TRACK STS

USE:
DISC SPECIFIC DOWNHILL, 4 CROSS
RIDING AND RACING
SIZES:
559mm
E.R.D.:
543
WEIGHT:
700g
HOLE COUNTS:
32, 36
COLORS:
BLACK POWDER-
COAT

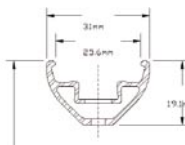

INTENSE MAG 30 STS

USE:
DOWNHILL RIDING AND RACING FOR BIKES
WITH DISC BRAKES
SIZES:
507mm, 559mm
E.R.D.:
475, 525
WEIGHT:
790g, 880g
HOLE COUNTS:
32, 36
COLORS:
BLACK POWDER-
COAT

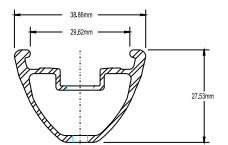

MTB HUBS

ECO 135mm REAR

TECH SPEC:

6061 T6 ALLOY HUB BODY
15MM ALLOY AXLE
FOUR SEALED CARTRIDGE BEARINGS
32 HOLE
BLACK
354g
LASER ENGRAVED GRAPHICS
50mm RIGHT SIDE FLANGE DIAMETER
50mm LEFT SIDE FLANGE DIAMETER
21mm RIGHT SIDE CENTER-TO-FLANGE DIAMETER
45mm LEFT SIDE CENTER-TO-FLANGE DIAMETER



ECO FRONT

TECH SPEC:

6061 T6 ALLOY HUB BODY
15MM ALLOY AXLE
TWO SEALED CARTRIDGE BEARINGS
28 OR 32 HOLE
BLACK
159g
LASER ENGRAVED GRAPHICS
35mm RIGHT SIDE FLANGE DIAMETER
35mm LEFT SIDE FLANGE DIAMETER
39mm CENTER-TO-FLANGE DIAMETER



DISC JOCKEY 135mm REAR

TECH SPEC:

6061 T6 ALLOY HUB BODY
15MM CHROMOLY AXLE
FOUR SEALED CARTRIDGE BEARINGS
32 HOLE
BLACK
449g
LASER ENGRAVED GRAPHICS
50.5mm RIGHT SIDE FLANGE DIAMETER
61mm LEFT SIDE FLANGE DIAMETER
21mm RIGHT SIDE CENTER-TO-FLANGE DIAMETER
32mm LEFT SIDE CENTER-TO-FLANGE DIAMETER



DISC JOCKEY FRONT

TECH SPEC:

6061 T6 ALLOY HUB BODY
11mm ALLOY AXLE
TWO SEALED CARTRIDGE BEARINGS
32 HOLE
BLACK
218g
LASER ENGRAVED GRAPHICS
50.5mm RIGHT SIDE FLANGE DIAMETER
61mm LEFT SIDE FLANGE DIAMETER
21mm RIGHT SIDE CENTER-TO-FLANGE DIAMETER
35mm LEFT SIDE CENTER-TO-FLANGE DIAMETER



SUN OF BUBBA (SOB)

TECH SPEC:

6061 T6 ALLOY HUB BODY
7075 T6 ALLOY AXLE
11MM AXLE
TWO SEALED CARTRIDGE BEARINGS
24, 28, 32 HOLE
BLACK, RED, SILVER
123g
LASER ENGRAVED GRAPHICS
38mm FLANGE DIAMETER
32mm CENTER-TO-FLANGE DIAMETER



SUPER DUPER BUBBA

TECH SPEC:

6061 T6 ALLOY HUB BODY
7075 T6 ALLOY AXLE
17.5MM D-SHAPED AXLE
TWO SEALED CARTRIDGE BEARINGS
32, 36 HOLE
BLACK, RED, SILVER
202g
LASER ENGRAVED GRAPHICS
46mm FLANGE DIAMETER
34mm CENTER-TO-FLANGE DIAMETER



COUNTRY FLEA FRONT

TECH SPEC:

CNC 7075 T6 SHELL AND AXLE
BLACK
24, 28, 32 HOLE
75g
36mm FLANGE DIAMETER
35mm CENTER-TO-FLANGE
FREE FLOATING FLANGES



COUNTRY FLEA 135mm REAR

TECH SPEC:

135mm SPACING
CNC 7075 T6 SHELL AND AXLE
3 PAWL SYSTEM
6/4 TITANIUM RATCHET RING
QUAD BEARING SYSTEM
24, 28, 32 HOLE
190g
9/10 SPD CLAMP
54mm DRIVE SIDE FLANGE DIAMETER
40mm NON-DRIVE SIDE FLANGE DIAMETER
20mm DRIVE SIDE CENTER-TO-FLANGE
35mm NON DRIVE SIDE CENTER-TO-FLANGE
7075 T6 ALLOY COG CARRIER

*SPECIAL TOOLS REQUIRED FOR DISASSEMBLY



439 / 439 LITE 135mm REAR »

TECH SPEC:
6061 T6 ALLOY HUB BODY
7075 T6 ALLOY AXLE
15MM AXLE
FOUR SEALED CARTRIDGE BEARINGS
28, 32, 36 HOLE
BLACK, RED, SILVER
417g / 337g (439 LITE)
LASER ENGRAVED GRAPHICS
52mm FLANGE DIAMETER
34mm CENTER-TO-LEFT FLANGE DIAMETER
21mm CENTER-TO-RIGHT FLANGE DIAMETER



(ALUMINUM COG CARRIER)

ABBAH S.O.S. XC FRONT »

TECH SPEC:
6061 T6 ALLOY HUB BODY
7075 T6 ALLOY AXLE
17.5mm D-SHAPED AXLE
TWO SEALED CARTRIDGE BEARINGS
32, 36 HOLE
BLACK
214g
LASER ENGRAVED GRAPHICS
45.5mm RIGHT SIDE FLANGE DIAMETER
59.5mm LEFT SIDE FLANGE DIAMETER
35mm RIGHT SIDE CENTER-TO-FLANGE DIAMETER
21mm LEFT SIDE CENTER-TO-FLANGE DIAMETER



ABBAH S.O.S. DH FRONT »

TECH SPEC:
6061 T6 ALLOY HUB BODY
110MM HUB SPACING
TWO SEALED CARTRIDGE BEARINGS
32, 36 HOLE
BLACK
216g
LASER ENGRAVED GRAPHICS
54.5mm RIGHT SIDE FLANGE DIAMETER
59.5mm LEFT SIDE FLANGE DIAMETER
35.5mm CENTER-TO-LEFT FLANGE DIAMETER
24.5mm CENTER-TO-RIGHT FLANGE DIAMETER



ABBAH S.O.S. REAR STANDARD AXLE »

TECH SPEC:
6061 T6 ALLOY HUB BODY
7075 T6 ALLOY AXLE
15MM AXLE
FOUR SEALED CARTRIDGE BEARINGS
32, 36 HOLE
BLACK
421g
LASER ENGRAVED GRAPHICS
59.5mm DRIVE SIDE FLANGE DIAMETER
53.5mm NON-DRIVE SIDE FLANGE DIAMETER
21mm DRIVE SIDE CENTER-TO-FLANGE DIAMETER
34.5mm NON-DRIVE SIDE CENTER-TO-FLANGE DIAMETER



ABBAH / LAWWILL HUBS 10mm SUB-AXLE AVAILABLE »



12mm REAR AXLE WITH 135mm SPACING

TECH SPEC:
6061 T6 ALLOY HUB BODY
12MM 7075 ALUMINUM THROUGH-AXLE
4 SEALED CARTRIDGE BEARINGS
32, 36 HOLE
BLACK
425g
LASER ENGRAVED GRAPHICS
54.5mm DRIVE SIDE FLANGE DIAMETER
54.5mm NON-DRIVE SIDE FLANGE DIAMETER
20.5mm DRIVE SIDE CENTER-TO-FLANGE DIAMETER
35.5mm NON-DRIVE SIDE CENTER-TO-FLANGE DIAMETER
COMES WITH DROP OUT SPACER



12mm REAR AXLE WITH 150mm SPACING

TECH SPEC:
6061 T6 ALLOY HUB BODY
12MM 7075 ALUMINUM THROUGH-AXLE
4 SEALED CARTRIDGE BEARINGS
32, 36 HOLE
BLACK
475g
LASER ENGRAVED GRAPHICS
57.9mm DRIVE SIDE FLANGE DIAMETER
57.9mm NON-DRIVE SIDE FLANGE DIAMETER
29mm DRIVE SIDE CENTER-TO-FLANGE DIAMETER
34mm NON-DRIVE SIDE CENTER-TO-FLANGE DIAMETER
COMES WITH DROP OUT SPACER



12mm REAR AXLE WITH 165mm SPACING

TECH SPEC:
6061 T6 ALLOY HUB BODY
12MM 7075 ALUMINUM THROUGH-AXLE
4 SEALED CARTRIDGE BEARINGS
32, 36 HOLE
BLACK
505g
LASER ENGRAVED GRAPHICS
57.9mm DRIVE SIDE FLANGE DIAMETER
57.9mm NON-DRIVE SIDE FLANGE DIAMETER
34mm DRIVE SIDE CENTER-TO-FLANGE DIAMETER
37mm NON-DRIVE SIDE CENTER-TO-FLANGE DIAMETER
COMES WITH DROP OUT SPACER

MTB COMPONENTS

EVOLUTION STEMS »

TECH SPEC:

6061-T6 aluminum
1 1/8" threadless
laser engraved graphics
charcoal grey

Evolution
SERIES



REACH	RISE
60mm	10°
90mm	10°
105mm	10°
105mm	0°
110mm	10°
110mm	0°
120mm	10°
120mm	0°
127.5mm	10°
127.5mm	0°

EVOLUTION SEATPOST »

TECH SPEC:

7075-T6 Taperwall tubing
7075-T6 adjustment clamp parts
350mm length
26.8, 27.0, 27.2, 31.6mm diameters
two tone laser engraved evolution series graphics
245-270g

Evolution
SERIES



EVOLUTION XC RISER BAR »

TECH SPEC:

7075-T6 butted alloy
190 grams
6 degree sweep
1 inch rise
24.5 inch width
two-tone evolution series graphics



Evolution
SERIES

EVOLUTION DH RISER BAR »

TECH SPEC:

7075-T6 butted alloy
300 grams
10 degree sweep
2 inch rise
27 inch width
two-tone evolution series graphics



Evolution
SERIES

FRAME ADAPTER »

TECH SPEC:

AVAILABLE WITH ABBAH S.O.S. LAWWILL 12MM REAR HUBS FOR USE ON NON-LAWWILL DESIGN REAR-END BIKES.



SWOOPY BOLT KIT »

TECH SPEC:

AVAILABLE FOR USE WITH THE SUPER DUPER BUBBA OR THE ABBAH S.O.S. XC FRONT AND STANDARD REAR DISC HUB FOR A STIFFER FEEL. WORKS WITH OUR D-SHAPED AXLE HUBS TO REDUCE ROTATIONAL FLEX OF FORK LEGS AROUND YOUR HUB AXLE.



20mm ADAPTER CAPS »

TECH SPEC:

MACHINED FROM AIRCRAFT 7075 T6 ALUMINUM
CONVERTS 20mm THRU AXLE FRONT HUBS TO 110mm QR





CNC OCTANE MAG PEDALS »

TECH SPEC:
 LIGHTWEIGHT MAGNESIUM BODY
 9/16" CHROMOLY SPINDLE
 REPLACEABLE CLEATS
 SEALED CARTRIDGE BEARINGS
 BROACHED SPINDLES
 243g (EACH)
 BLACK



ZU ZU'S PEDALS »

TECH SPEC:
 ALLOY CAGE
 9/16" CHROMOLY AXLE
 REPLACEABLE CLEATS
 SEALED BEARING
 BLACK



RINGLE SKEWERS »

TECH SPEC:
 AVAILABLE IN TITANIUM OR CHROMOLY
 LASER ENGRAVED LOGO
 BLACK ONLY



FLEA SKEWERS »

TECH SPEC:
 MADE FROM 6 AL/4V TITANIUM
 55g (PAIR)



STIFFY 12mm REAR AXLE »

TECH SPEC:
 6061 T6 ALUMINUM
 6.9 INCHES IN LENGTH (135mm SPACING), (150mm AND 165mm AVAILABLE)
 AVAILABLE IN POLISHED OR AXLE ROSE (RED)



TITANIUM OCTANE PEDAL SPINDLE »

TECH SPEC:
 6 AL/4V TITANIUM SPINDLES
 BROACHED AXLE
 SAVES 40g



ROAD 2004

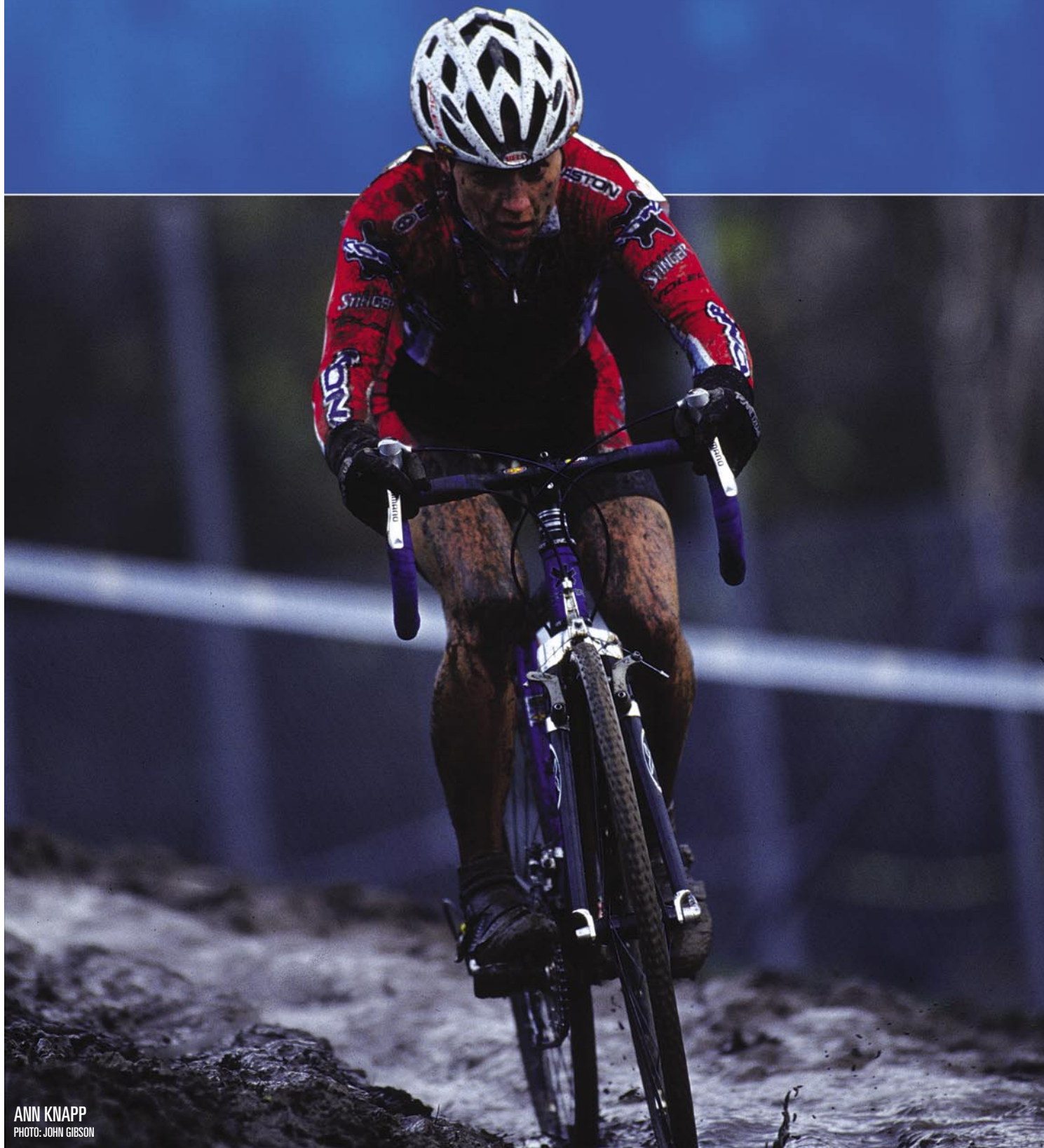

ANN KNAPP
PHOTO: JOHN GIBSON

ROAD WHEELSETS



PRO SPRINT

USE:
ROAD RIDING AND RACING
FRONT HUB:
28 HOLE SUN OF BUBBA
REAR HUB:
32 HOLE 439 LITE
RIM:
ASSAULT (TCB)
SPOKES:
14/15 GAUGE DOUBLE BUTTED BLACK
NIPPLES:
ALLOY
LACING:
RADIAL (F), 2 CROSS (R)
WEIGHT:
690g (F), 940g (R)



PRO RACE

USE:
ROAD RIDING AND RACING
FRONT HUB:
28 HOLE SUN OF BUBBA
REAR HUB:
32 HOLE 439 LITE
RIM:
VENUS (TCB)
SPOKES:
14/15 GAUGE DOUBLE BUTTED BLACK
NIPPLES:
ALLOY
LACING:
RADIAL (F), 2 CROSS (R)
WEIGHT:
710g (F), 970g (R)



PRO ELITE

USE:
ROAD RIDING AND RACING
FRONT HUB:
28 HOLE SUN OF BUBBA
REAR HUB:
32 HOLE 439 LITE
RIM:
ME14A (TCB)
SPOKES:
14/15 GAUGE DOUBLE BUTTED BLACK
NIPPLES:
ALLOY
LACING:
RADIAL (F), 2 CROSS (R)
WEIGHT:
700g (F), 955g (R)



CYCLO-CROSS

USE:
ROAD RIDING AND RACING
FRONT HUB:
28 HOLE SUN OF BUBBA
REAR HUB:
32 HOLE 439 LITE (130mm OR 135mm SPACING)
RIM:
ME14A (TCB)
SPOKES:
14/15 GAUGE DOUBLE BUTTED BLACK
NIPPLES:
ALLOY
LACING:
2 CROSS (F/R)
WEIGHT:
700g (F), 955g (R)



ANN KNAPP
PHOTO: JOHN GIBSON

ROAD RIMS

ASSAULT »

USE:
ROAD RIDING AND RACING

SIZES:
571mm, 622mm

E.R.D.:
522, 603

WEIGHT:
410g

HOLE COUNTS:
28, 32

COLORS:
BLACK



FEATURES:

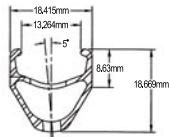

ME14A » *NEWLY REDESIGNED SPOKE FACE

USE:
ROAD RIDING, RACING, TRAINING, ENDURANCE, TRIATHLONS, CYCLO-CROSS

SIZES:
622mm

E.R.D.:
548

WEIGHT:
420g

HOLE COUNTS:
32, 36

COLORS:
BLACK

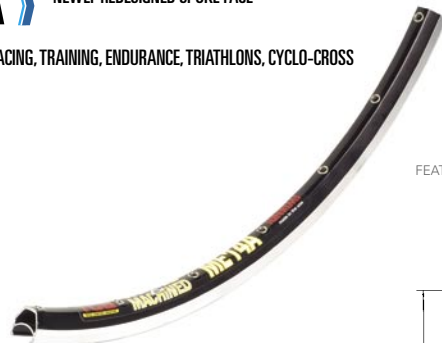

FEATURES:

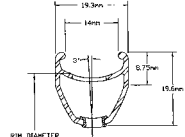

VENUS » *NEWLY REDESIGNED SPOKE FACE

USE:
ROAD RIDING, RACING, TRAINING, TRIATHLONS

SIZES:
622mm

E.R.D.:
589

WEIGHT:
440g

HOLE COUNTS:
24, 28, 32

COLORS:
BLACK



FEATURES:

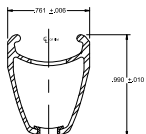

SWIFT » *ALUMINUM EYELET INSERT

USE:
ROAD RIDING, RACING, TRAINING, TRIATHLONS

SIZES:
622mm

E.R.D.:
585

WEIGHT:
500g

HOLE COUNTS:
28, 32

COLORS:
BLACK



FEATURES:

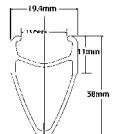

RHYNO LITE »

USE:
CYCLO-CROSS, ROAD RIDING, TRAINING, TOURING, ULTRA ENDURANCE

SIZES:
622mm, 29"

E.R.D.:
612

WEIGHT:
590g

HOLE COUNTS:
32, 36

COLORS:
BLACK



FEATURES:

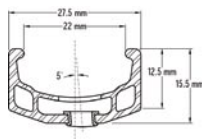

0 DEGREE XTC »

USE:
CYCLO-CROSS, ROAD RIDING, TRAINING, TOURING, ULTRA ENDURANCE

SIZES:
622mm, 29"

E.R.D.:
605

WEIGHT:
470g

HOLE COUNTS:
28, 32, 36

COLORS:
BLACK

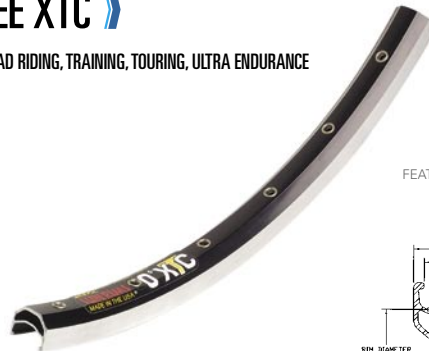

FEATURES:

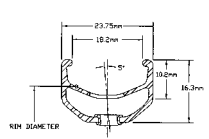

M19AI »

USE:
ROAD RIDING, RACING

SIZES:
632mm (TUBULAR)

E.R.D.:
602

WEIGHT:
370g

HOLE COUNTS:
28, 32, 36

COLORS:
HARD ANO BLACK



VISTA CRUISER » *DOUBLE EYELET CUP

USE:
CYCLO-CROSS AND CLASSIC ROAD RIDING

SIZES:
632mm (TUBULAR)

E.R.D.:
612

WEIGHT:
345g

HOLE COUNTS:
24, 28, 32

COLORS:
BLACK



FEATURES:



ROAD HUBS & COMPONENTS

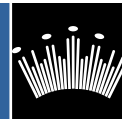

CITY FLEA FRONT »

TECH SPEC:
CNC 7075 T6 SHELL AND AXLE
BLACK
20, 24, 28 HOLE
75g
36mm FLANGE DIAMETER
35mm CENTER-TO-FLANGE
FREE FLOATING FLANGES



« CITY FLEA 130mm REAR

TECH SPEC:
CNC 7075 T6 SHELL AND AXLE
3 PAWLS SYSTEM
6/4 TITANIUM RATCHET RING
QUAD BEARING SYSTEM
24, 28, 32 HOLE
190g
9/10 SPD CLAMP
54mm DRIVE SIDE FLANGE DIAMETER
40mm NON-DRIVE SIDE FLANGE DIAMETER
19mm DRIVE SIDE CENTER-TO-FLANGE
36mm NON DRIVE CENTER-TO-FLANGE
7075-T6 ALLOY COG CARRIER: CAMPAGNOLO OR SHIMANO

*SPECIAL TOOLS REQUIRED FOR DISASSEMBLY

ECO 130mm REAR »

TECH SPEC:
6061 T6 ALLOY HUB BODY
15MM ALLOY AXLE
FOUR SEALED CARTRIDGE BEARINGS
32 HOLE
BLACK
330g
LASER ENGRAVED GRAPHICS
50mm RIGHT SIDE FLANGE DIAMETER
50mm LEFT SIDE FLANGE DIAMETER
22mm RIGHT SIDE CENTER-TO-FLANGE DIAMETER
41mm LEFT SIDE CENTER-TO-FLANGE DIAMETER



ECO »

TECH SPEC:
6061 T6 ALLOY HUB BODY
11MM ALLOY AXLE
TWO SEALED CARTRIDGE BEARINGS
28 OR 32 HOLE
BLACK
159g
LASER ENGRAVED GRAPHICS
35mm RIGHT SIDE FLANGE DIAMETER
35mm LEFT SIDE FLANGE DIAMETER
39mm CENTER-TO-FLANGE DIAMETER



439 / 439 LITE 130mm REAR »

TECH SPEC:
6061 T6 ALLOY HUB BODY
7075 T6 ALLOY AXLE
15MM AXLE
FOUR SEALED CARTRIDGE BEARINGS
28, 32, 36 HOLE
BLACK, RED, SILVER
417g / 337g (439 LITE)
LASER ENGRAVED GRAPHICS
52mm FLANGE DIAMETER
34mm CENTER-TO-LEFT FLANGE DIAMETER
21mm CENTER-TO-RIGHT FLANGE DIAMETER



SUN OF BUBBA (SOB) »

TECH SPEC:
6061 T6 ALLOY HUB BODY
7075 T6 ALLOY AXLE
11MM AXLE
TWO SEALED CARTRIDGE BEARINGS
24, 28, 32 HOLE
BLACK, RED, SILVER
123g
LASER ENGRAVED GRAPHICS
38mm FLANGE DIAMETER
32mm CENTER-TO-FLANGE DIAMETER



RINGLE SKEWERS »

TECH SPEC:
AVAILABLE IN TITANIUM OR CHROMOLY
LASER ENGRAVED LOGO
BLACK ONLY



FLEA SKEWERS »

TECH SPEC:
7075 T6 ALUMINUM FRONT
6/4 TITANIUM REAR
60g (PAIR)



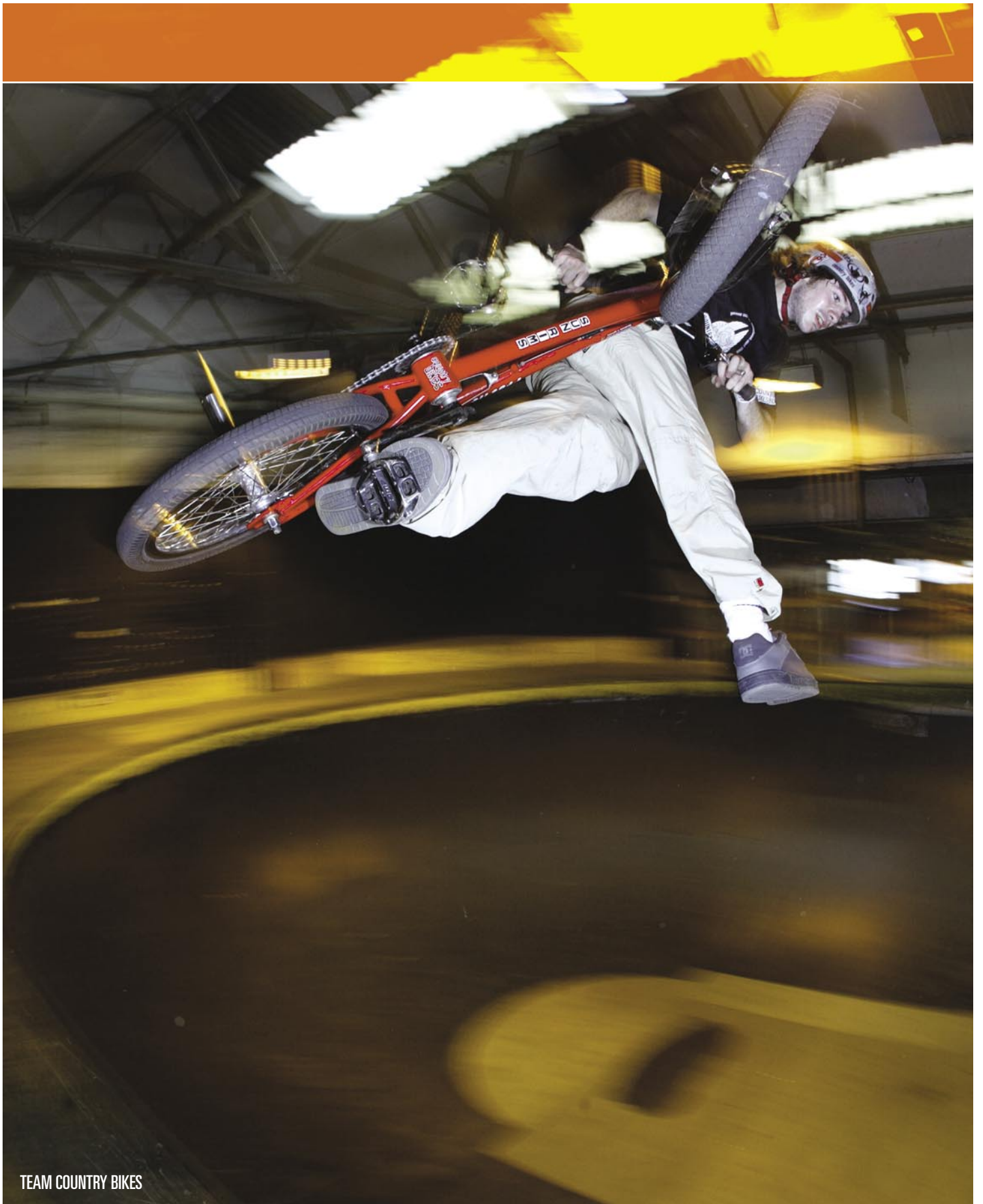

TEAM COUNTRY BIKES



BMX 2004

WHEELSETS

REDUCED ROTATIONAL WEIGHT

Location weights of the three integrated parts of a wheel (i.e. the rim, spokes and hubs) are actually more important than the total wheel weight

STRONG

Our rims are designed and manufactured by us and trusted by the world's greatest athletes. We know what we're doing, we've been doing it for over 50 years.

SERVICEABLE

We've taken the mystery out of your wheelset. No faddish designs that cost more because of their looks. No special tools needed. We're not reinventing the wheel, we're building it better.

QUALITY & VALUE

No one else offers as light, strong and durable wheelsets. Hand built in the good ol' U.S.A. by experienced wheelbuilders for sometimes hundreds less than those other wheels.

RIMS

TRIPLE HOLLOW DESIGNS

A rim with three channels in the cross-section provides increased stability under hard impacts and fatiguing forces that happen regularly in BMX.

DOUBLE WALL DESIGNS

Provides the right mixture between strength, rigidity, and lightweight for all types of riding.

NICKEL PLATED BRASS EYELETS

More flexible than stainless steel, thus less prone to cracking. Plus plated brass is a self-lubricating metal, keeping your eyelets and nipples from seizing up, which builds a stronger wheel that will last longer as well.

COMPONENTS

HIGH QUALITY ALLOYS

Only the best designs for our products. Designed from the start to finish to determine what type of alloy should be used on a particular component, wheelset or rim and why. Like, we said... only the best!

COMPETITION PROVEN DESIGNS

It's got to work on the battlefield first. On race courses and in skateparks around the world, our products display their winning form to help top athletes concentrate on their riding and trust in our products to take them to the top.

INDUSTRY LEADING CONCEPTS

From rider to our multi-compatible disc-brake hubs to our exclusive D-shaped axle, we've lead the way in making components better and better. Anyone can make components, but only the best can make components better.

RIM TECHNOLOGY



TCB: TOTAL CONTROL BRAKING combines a welded rim seam with a precision machined brake surface. No visible seam on the rim gives you the ultimate in braking control.



L7: Allows us to provide a precision machined braking surface on a lighter sleeved / pinned rim for even better braking control.



ABT: ADVANCED BRAKE TRACK is a specially finished brake surface. It provides a smooth raw aluminum brake track, for more controlled braking. ABT is standard on all Red, Black, Gun Metal and Titanium anodized finished, as well as the polished finish.



DWS: DUAL-WIDTH SIDEWALL. Serious testing shows that different areas of the rim need to have increased amounts of material. We reinforce sidewalls and spoke faces for specific uses of the rim.

BMX WHEELSETS



*DUBZ DELUX COMING SOON WITH CASSETTE HUBS

DUBZ

USE:
DIRT JUMPING, RAMP, STREET

FRONT HUB:
36 OR 48H, 3 BEARING,
11.5mm SLOTS, HOLLOW AXLES

REAR HUB:
36 OR 48H FLIP-FLOP JABBA, 3
BEARING, 11.5mm SLOTS, HOLLOW AXLES

RIM:
TRIPLE WALL BLACK LABEL (DWS)

SPOKES:
14 STRAIGHT GAUGE BLACK

NIPPLES:
BRASS

LACING:
36H: 3 CROSS (F/R), 48H: 4 CROSS (F/R)

WEIGHT:
780g (F), 1,040g (R)



BARELY LEGAL

USE:
DIRT JUMPING, RAMP, STREET

FRONT HUB:
36 OR 48H, 3 BEARING,
11.5mm SLOTS, HOLLOW AXLES

REAR HUB:
36 OR 48H FLIP-FLOP JABBA, 3
BEARING, 11.5mm SLOTS, HOLLOW AXLES

RIM:
BIG CITY (TCB) (DWS)

SPOKES:
14 STRAIGHT GAUGE BLACK

NIPPLES:
BRASS

LACING:
36H: 3 CROSS (F/R), 48H: 4 CROSS (F/R)

WEIGHT:
710g (F), 970g (R)



SUPERSTOCK 2.0

USE:
MID-LEVEL BMX RIDING, RACING - MODERATE
DIRT JUMPING AND FREESTYLE

FRONT HUB:
36H SUN SUPERSTOCK

REAR HUB:
36H SUN SUPERSTOCK (FREEWHEEL)

RIM: (CHOICE OF)
BFR (1.75"), RHYNO LITE (1.75"),
CR18 (1-3/8"), ICI-1 (1-1/8")

SPOKES:
14 STRAIGHT GAUGE BLACK

NIPPLES:
BRASS

LACING:
3 CROSS (F/R)

WEIGHT:
1,015g/1,030g (BFR), 920g/935g (RHYNO
LITE), 880g/895g (CR18), 845g/860g (ICI-1)



SUPERSTOCK 2.4

USE:
24" MID-LEVEL FREEWHEEL USE BMX RIDING
AND RACING

FRONT HUB:
36H SUN SUPERSTOCK

REAR HUB:
36H SUN SUPERSTOCK (FREEWHEEL)

RIM: (CHOICE OF)
BFR (1.75"), RHYNO LITE (1.75"),
CR18 (1-3/8"), ICI-1 (1-1/8")

SPOKES:
14 STRAIGHT GAUGE BLACK

NIPPLES:
BRASS

LACING:
3 CROSS (F/R)

WEIGHT:
1,115g/1,145g (BFR), 1,010g/1,040g (RHYNO
LITE), 960g/990g (CR18), 925g/955g (ICI-1)



BM DOUBLE U

USE:
PRO BMX RACING

FRONT HUB:
36 HOLE ATILLA THE HUB

REAR HUB:
36 HOLE ATILLA THE HUB REAR CASSETTE

RIM:
BFR OR RHYNO LITE (TCB)

SPOKES:
14 STRAIGHT GAUGE BLACK

NIPPLES:
BRASS

LACING:
36H: 3 CROSS (F/R)

WEIGHT:
1,130g (F), 1,348g (R)

ATILLA HUBS W/ COGS

SEE PAGE 26 FOR COMPLETE SPEC



***FOR USE WITH 13-18 TOOTH COGS

BMX RIMS



BLACK LABEL WELDED

USE:
FREESTYLE, STREET, TRAILS

SIZES:
406mm

E.R.D.:
388

WEIGHT:
670g

HOLE COUNTS:
36, 48

COLORS:
BLACK, CHROME



FEATURES: **DWS**

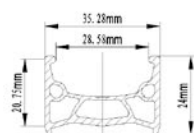

4-PLAY

USE:
FREESTYLE, STREET, TRAILS

SIZES:
406mm

E.R.D.:
382

WEIGHT:
575g

HOLE COUNTS:
36, 48

COLORS:
BLACK, CHROME



FEATURES: **TCB**

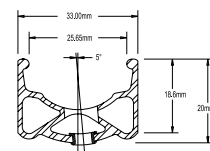

CHI-TOWN HUSTLER PINNED

USE:
FREESTYLE, STREET, TRAILS

SIZES:
406mm

E.R.D.:
388

WEIGHT:
670g

HOLE COUNTS:
36, 48

COLORS:
BLACK, CHROME

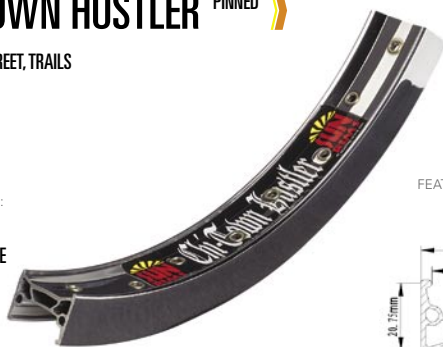

FEATURES: **DWS**

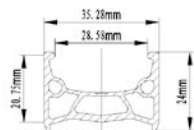

BIG CITY

USE:
FREESTYLE, STREET, TRAILS

SIZES:
406mm

E.R.D.:
389

WEIGHT:
600g

HOLE COUNTS:
36, 48

COLORS:
BLACK, CHROME,
SMOKE CHROME,
GOLD CHROME



FEATURES: **DWS TCB**

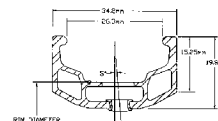

MATT POHLKAMP
TEAM SUN RINGLE - CALL CENTER JOCKEY



JAMIE BESTWICK
PHOTO: STEVE BUDDENDECK

BMX RIMS

KING PIN »

USE:
FREESTYLE, STREET, TRAILS
SIZES:
406mm
E.R.D.:
389
WEIGHT:
595g
HOLE COUNTS:
36, 48
COLORS:
BLACK, CHROME



FEATURES:

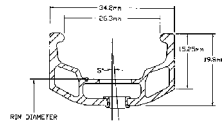

BFR (BIG FAT RIM) »

USE:
ALL PURPOSE
SIZES:
406mm, 507mm
E.R.D.:
394, 492
WEIGHT:
510g, 635g
HOLE COUNTS:
36, 48
COLORS:
BLACK, CHROME

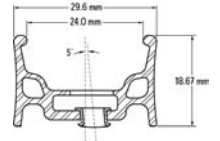

BLACK BOX »

USE:
BMX RIDING AND RACING
SIZES:
406mm
E.R.D.:
389
WEIGHT:
480g
HOLE COUNTS:
36, 48
COLORS:
BLACK, CHROME



RHYNO LITE XL 1.75 »

USE:
BMX RACING, TRAILS
SIZES:
406mm, 507mm
E.R.D.:
395, 493
WEIGHT:
415g, 510g
HOLE COUNTS:
36, 48
COLORS:
BLACK, CHROME



FEATURES:

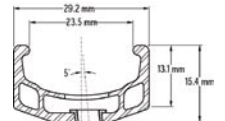

RHYNO LITE 1.5 »

USE:
BMX RACING, RIDING
SIZES:
406mm, 507mm, ALSO AVAILABLE IN 305mm
E.R.D.:
395, 493
WEIGHT:
405g, 495g
HOLE COUNTS:
36
COLORS:
BLACK



FEATURES:

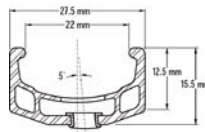

CR-18 »

USE:
BMX RACING, RIDING
SIZES:
406mm, 451mm, 507mm, 541mm
E.R.D.:
389, 438, 494, 532
WEIGHT:
350g, 375g, 390g, 425g
HOLE COUNTS:
28, 36
COLORS:
BLACK

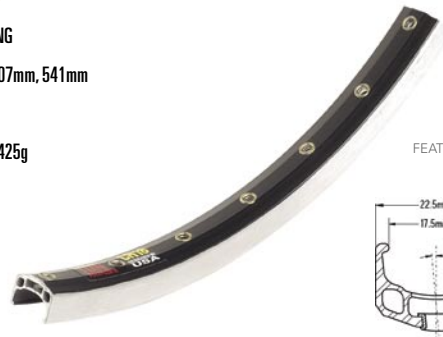

FEATURES:

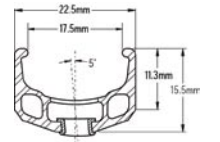

ICI-1 »

USE:
BMX RACING, RIDING
SIZES:
451mm, 520mm
E.R.D.:
438, 507
WEIGHT:
340g, 390g
HOLE COUNTS:
28, 36
COLORS:
BLACK

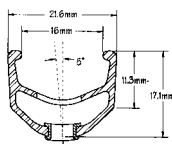

M14A AKA THE ANKLE BITER »

USE:
BMX RACING, RIDING
SIZES:
400mm
E.R.D.:
380
WEIGHT:
215g
HOLE COUNTS:
28
COLORS:
SILVER

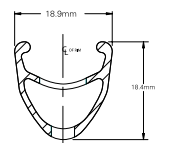

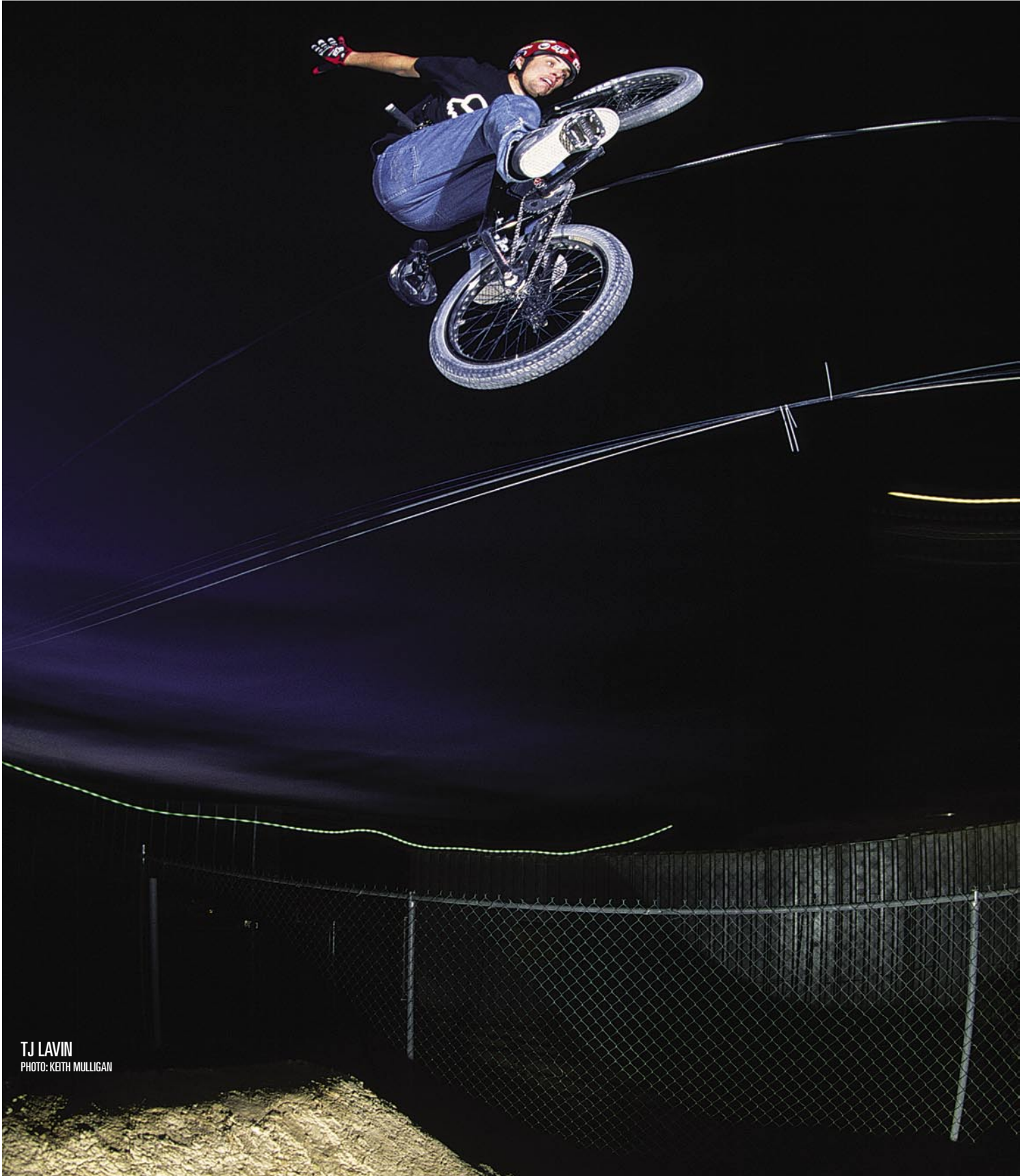

TJ LAVIN
PHOTO: KEITH MULLIGAN

SUPERSTOCK HUBSET »

TECH SPEC:

6061 T6 ALLOY HUB BODY
4130 HEAT TREATED CHROMOLY AXLES
36 HOLE DRILLINGS
SEALED BEARINGS
FLIP-FLOP DESIGN
BLACK



JABBA THE HUBSET »

TECH SPEC:

6061 T6 ALLOY HUB BODY
4130 HEAT TREATED CHROMOLY AXLES
36 AND 48 HOLE DRILLINGS
HOLLOW HARDENED 14mm SLOTTED OR SOLID AXLES
3 SEALED BEARINGS
FLIP-FLOP DESIGN
BLACK



ATILLA THE HUB »

TECH SPEC:

6061 T6 ALLOY HUB BODY
7075 T6 ALLOY AXLE
STEEL LUG AXLES
SEALED CARTRIDGE BEARINGS
36 HOLE
ANGLED FLANGES
280g (F) / 440g (R)
BLACK
LASER ENGRAVED GRAPHICS
13-18 TOOTH REAR 4140 PRE-HARDENED COGS
51mm FLANGE DIAMETER (F/R)
32.1mm CENTER-TO-FLANGE DIAMETER (F),
30.2mm DRIVE SIDE CENTER-TO-FLANGE DIAMETER (R)
37.1 NON-DRIVE SIDE CENTER-TO-FLANGE DIAMETER



*LOOK FOR NEW THRU AXLE DESIGN

BMX COMPONENTS



CNC OCTANE MAG PEDALS »

TECH SPEC:
LIGHTWEIGHT MAGNESIUM BODY
9/16" CHROMOLY SPINDLE
REPLACEABLE CLEATS
SEALED CARTRIDGE BEARINGS
BROACHED SPINDLES
243g (EACH)
BLACK



TITANIUM OCTANE PEDAL SPINDLE »

TECH SPEC:
6 AL/4V TITANIUM SPINDLES
BROACHED AXLE
SAVES 40g



ZU ZU'S PEDALS »

TECH SPEC:
ALLOY CAGE
9/16" CHROMOLY AXLE
REPLACEABLE CLEATS
SEALED BEARING
BLACK



DEEZ NUTZ AND LUGZ »

TECH SPEC:
DEEZ LUGZ ALLOW CONVERSION OF STANDARD 3/8" AXLES TO 14mm AXLES
DEEZ NUTZ ARE 14mm CNC MACHINED AXLE NUTS FOR ATILLA THE HUB



DAVID STROUD
PHOTO: CORY MUTH

OEM RIMS

DITCHWITCH »

USE:
BMX RACING TO FREERIDE

SIZES:
406mm, 559mm

WEIGHT:
410g, 560g

HOLE COUNTS:
32, 48

COLORS:
SILVER, BLACK



HILLROD »

USE:
XC RIDING

SIZES:
559mm

WEIGHT:
569g

HOLE COUNTS:
32, 36

COLORS:
SILVER, BLACK



AT18 »

USE:
ALL AROUND USAGE

SIZES:
305mm, 630mm

WEIGHT:
280g, 570g

HOLE COUNTS:
28, 48

COLORS:
SILVER, BLACK



MC18 »

USE:
ALL AROUND USAGE

SIZES:
305mm, 559mm

WEIGHT:
250g, 470g

HOLE COUNTS:
28, 48

COLORS:
SILVER, BLACK

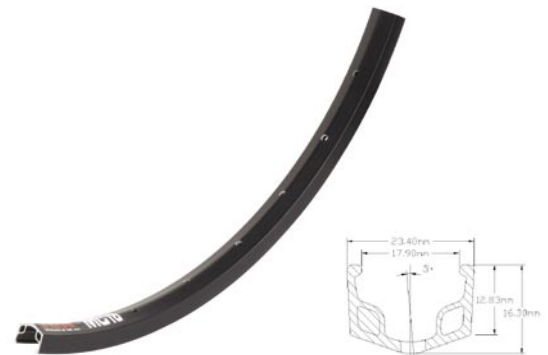

ZX25 »

USE:
BMX RACING TO XC RIDING

SIZES:
406mm, 559mm

WEIGHT:
280g, 570g

HOLE COUNTS:
32, 48

COLORS:
SILVER, BLACK



M13II »

USE:
BMX RACING TO TOURING

SIZES:
451mm, 630mm

WEIGHT:
330g, 470g

HOLE COUNTS:
28, 36

COLORS:
SILVER, BLACK



MZ14 »

USE:
ROAD RIDING AND RACING

SIZES:
622mm

WEIGHT:
588g

HOLE COUNTS:
28, 36

COLORS:
SILVER, BLACK



THESE RIMS ARE ORIGINAL EQUIPMENT ON
THE BEST BICYCLES SOLD WORLDWIDE AND
ARE NOT SOLD IN THE AFTERMARKET.

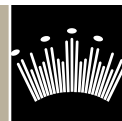

HANDLE YOUR BUSINESS CARD HOLDER »

ALLOY CARD CARRYING CASE FOR BUSINESS CARDS, CREDIT CARDS, CASH, OR CONDOMS
LASER ETCHED LOGO
AVAILABLE IN BLACK ONLY



STUFF-IT WHEEL BAG »

LARGE ENOUGH FOR 700c WHEELS
SCREENED SUN RINGLE LOGO
STURDY HANDLES
ZIPPER CLOSURE AND SMALL POCKET FOR SKEWERS, TOOLS, ETC.
EXTERIOR BUSINESS CARD HOLDER



SUN RINGLE TEAM JERSEY »

AIR KONTROL POLYESTER PADDED LONG SLEEVE AVAILABLE



T-SHIRTS »

L, XL SIZES ONLY
BLACK S/S
RINGER T (WHITE & RED)
3/4 (WHITE & BLACK)



FRONT

BACK

SUN RINGLE BANNER »

3' X 6'
4 GROMMET



SUN RIMS BANNER »

3' X 6'
4 GROMMET



ASSORTED STICKERS »

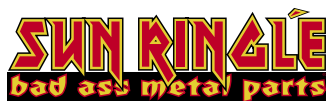



CHRIS DOYLE
PHOTO: STEVE BUDDENDECK

METRIC TO U.S. STANDARD CONVERSION CHART



Metric	U.S. Standard
305mm	16x1.5 - 2.125
400mm	18"
406mm	20x1.5 - 2.125
451mm	20x1 1/8 & 1 3/8
507mm	24x1.5 - 2.125
520mm	24x1 1/8
541mm	24x1 3/8
571mm	650c clincher
559mm	26x1.5 or larger
622mm	700c clincher
630mm	27x1 1/8, 1 1/4
632mm	700c tubular



WORLD HEADQUARTERS
2156 NORTH DETROIT STREET
WARSAW, IN 46580
TELE: 888-4-SUNRIM (FREE), (574) 267-3281 - FAX: (574) 267-2446