

TOKEN

High Rolling Bike Products



www.tokenproducts.com

2005 / 2006

Token Products have entered into the new design dynamic that only carbon fiber can bring to the cycling industry.

Having methodically increased our product line to include frames, cranks and bars, we now have a comprehensive range, offering distributors an exclusive opportunity to market cutting edge products.

Token commissions the finest manufacturers worldwide and can ensure top quality products at very reasonable pricing.

At Token, we understand the importance of visual communication and design. Therefore we offer a comprehensive solution in packaging and product branding.

Your Token, our commitment...

Aftermarket Packaging	03
Cycle Cross & MTB Frames	04
Road 700C Frames	05
Forks, Expanders & Spacers	06
Saddles, Seat Posts & Seat Clamps	07
Integrated Headsets & ACBearings	08
Internal & Threadless Headsets	09
Heavy Duty Threadless Headsets	10
New Patented Two-Tone Headsets & Safe Head	11
MTB & Road Cranksets, MTB Alloy Cassette	12
Road & Compact Cranksets	13
ISO/JIS Square BB	14
ISIS Drive BB	15
Cycle Cross & MTB Handlebar	16
Racing Handlebar	17
Bar Ends, Grips , Ti bolts & Carbon Patches	18
Stems for Road & XC MTB	19
Carbon Clincher wheelsets for Road & MTB	20
Carbon Tubular wheelsets & New Ti/SC/7075 CNC Cassettes	21
Shuriken® 7075 CNC Chainblades	22
Bottles, Bottle cages & Helmets	23

PYROTEC[®] S E R I E S

Token's Pyrotec[®] Carbon Fiber Series components represent the latest developments in carbon fiber technology. Tested to destruction, these components offer the weight to strength ratios that you demand and the performance that you can trust.

MONO-Q[™] S E R I E S

Token's Mono-Q[™] Series of components are design and manufactured using "monocoque" technology. Monocoque construction needs no framework to provide strength, because the strength is inherent in its shell-like structure, just as it is in an egg which, on the basis of strength to weight ratio, is one of the strongest structures known!

The one-piece design of Mono-Q[™] also allows Token engineers to sculpt the best possible shape and ergonomic form to optimize design and performance in all Token Mono-Q[™] products.

Token has a complete aftermarket packaging program for all of our components and accessories.

Our value-added packaging program is a reflection of the quality of our products. The bold colors and integrated "Point of Purchase" / Pop Up Display's grab attention and promote sales of retail and consumer level.



Cycle Cross & MTB Frames

TK9008CX 700C Cycle Cross Frame (Sloping)

- Carbon and Alloy 7005 Bondo Ergo welding
- Front: • SCUZZI CNC Lugs combined with carbon T/T, D/T & S/T
- Head Tube : Carbon Tube inserted into alloy head tube Ø45mm with 1-1/8" integrated headset mechanism to fit TOKEN OMEGA • IZC carbon headset
- Seat tube: Ø27.2x31.8mm
- Rear: New shape carbon cycle cross S/S & C/S with forged alloy dropouts
- Fork: Full carbon cycle cross type, GXC01
- Size: 50/52/54/56/58 cm C-T
- Weight: 1.33kgs/52cm
- Air Brush color finish



TK9619 HT 26" MTB Hardtail Scandium Frame

- Scandium & Alloy 7005 Bondo Ergo Welding
- Front: • Head Tube: Alloy 7005, Ø44x50x45" Internal headset mechanism to fit TOKEN KUDOS • Z Headset
- Down Tube & Top Tube: 4 clover profile Scandium Tubing
- Seat Tube: Ø31.6x34.9mm
- Rear: • S-bend SCUZZI 4 Clover profile alloy 7005 S/S & C/S
- CNC Disc Dropouts
- Size: 15"/ 17"/ 19"/ 21"/ 23" C-T
- Weight: 1.4 kgs/17"
- Air Brush Color Finish



TK9719ST 26" MTB Softail Frame

- Alloy 7005 Ergo welding
- Front: • SCUZZI 4 Clover profile tubing
- Head tube: Ø44x50x45" Internal headset mechanism to fit TOKEN KUDOS • Z Headset
- Seat Tube: Ø31.6x34.9mm
- Rear: • Elastomer Suspension S/S with Titanium plate
- Replaceable SCUZZI Carboyoke C/S
- CNC Disc dropouts
- Size: 15"/17"/19"/21"/23" cm C-T
- Weight: 1.75kgs/17"
- Air Brush color finish & anodized S/S



TK9101 TT

Alloy Road Time Trial Frame

- Super lightweight, Bondo Ergo Alloy 7005 welding
- Front: • SCUZZI Third Dimension Frame 1:3 T/T to D/T geometry
- Head tube: Ø45mm with 1-1/8" Integrated mechanism to fit TOKEN OMEGA • IZC Carbon Headset
- Seat Post: Ø27.2mm
- Rear: Aero Shap + Yoke Seat Tube
- Fork: Alloy-Carbon, TK925
- Size: 48/50/52/54/56/58/60 cm C-T
- Weight: 1.48 kgs/54cm Frame only
- Air Brush color finish



TK998SC 26" TWO CAMM MTB Suspension Scandium Frame

- Material: Scandium and alloy 7005 Bondo Ergo Welding
- Front: • Head Tube - Alloy 7005, Ø44x50x45" Internal headset mechanism to fit TOKEN KUDOS • Z Headset
- Down Tube: New SCUZZI Scandium triple butted 4 clover profile
- Seat Tube : Scandium double butted Ø 27.2 x 31.8mm
- Top Tube - Alloy 7005
- Rear: • Replaceable Scuzzi Carboyoke
- S-bend seat stay
- CNC Disc Dropouts
- Size: 16"/ 17"/ 18"/ 19"/ 20"/ 21" C-T
- Weight: 2.26kgs, 17" with X-FUSION shock
- Air Brush Color Finish
- TK998CDA Alloy 7005 Construction Frame, 2.34 kgs/17"

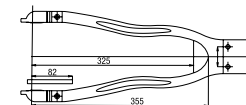

The patented Two CAMM design of dual dampened rear triangle delivers 68mm of travel. The SCUZZI CARBOYOKO Chainstay eliminates the need for traditional bearing axle assemblies. This reduces weight and increases the lateral stiffness without Compromising on travel or performance



TK9006SC Shuriken Scandium 700C Frame

- Super lightweight SCUZZI SC7000, 4clover profile triple butted tubing construction
- Head Tube: Alloy Ø45mm with 1-1/8" Integrated mechanism to fit TOKEN OMEGA • IZC Carbon headset
- Seat Tube: Ø27. 2x31.8mm
- C/S, S/S: SCUZZI SC7000 with alloy forged dropouts
- Size: 48/51/54/57/60 cm C-T
- Weight: 0.95kgs/ 51cm Frame only
- Fork: Integrated Full Carbon TK921
- Air Brush Color Finish



TK9729 Shuriken White 700 Frame

- Front: White Carbon & rear black carbon construction
- Fork: Alloy steerer carbon blades, TK925
- Head Tube: Ø45mm with 1/1/8" Integrated headset mechanism to fit TOKEN OMEGA • IZC Carbon headset
- Seat Tube: Ø27.2 x 31.8mm
- Size: 48/51/54/57 cm C-T
- Weight: 1.35kgs/ 54cm Frame only
- Air Brush color Finish



TK9729W Shuriken Full White Carbon 700C Frame

- Front & Rear White Carbon
- Fork: White Integrated Full Carbon Ø45x1-1/8, TK921W
- Head Tube: Ø45mm with 1-1/8" Integrated headset mechanism to fit TOKEN OMEGA • IZC Carbon headset
- Seat Tube: Ø27.2x31.8mm
- Size: 48/51/54/57 cm C-T
- Weight: 1.40kgs/54cm Frame only
- Air Brush Color Finish



TK9826 Shuriken Carbon 700C Frame

- Front: Alloy Lugs
- New Shape carbon S/T, T/T & D/T
- Head Tube: Ø45mm with 1-1/8" Integrated headset mechanism to fit TOKEN OMEGA • IZC Carbon headset
- Seat Tube: New design wing type Ø27.2x31.8mm
- Rear: New design Mono Box wing type S/S & New shape Mono Box C/S with CNC Dropout
- Fork: Full Carbon wing type Ø45 x 1-1/8"
- Size: 49/52/55/58 cm C-T
- Weight: 1.15kgs/ 52cm Frame only
- Air Brush Color Finish



TK9826FC Shuriken Full Carbon 700C Frame

- Front: new Carbon Lugs
- New Shape carbon S/T, T/T & D/T
- Head Tube: Ø45mm with 1-1/8" Integrated headset mechanism to fit TOKEN OMEGA • IZC Carbon headset
- Seat Tube: New design wing type Ø27.2x31.8mm
- Rear: New design Mono Box wing type S/S & New shape Mono Box C/S with CNC Dropout
- Fork: Full Carbon wing type Ø45 x 1-1/8"
- Size: 49/52/55/58 cm C-T
- Weight: 1.05kgs/ 52cm Frame only
- Air Brush Color Finish



TK997 Shuriken Dedacciai U2 700C Frame

- Super lightweight dedacciai U2 & black box construction
- Head Tube: Alloy Ø45mm with 1-1/8" Integrated headset mechanism to fit TOKEN OMEGA • IZC Carbon headset
- Seat Tube: Alloy Ø32.4x35mm
- C/S, S/S: Dedacciai U2 carbon black box with alloy forged dropouts
- Sloping: 1.4°
- Size: 48, 50, 52, 54, 56, 58 cm/C-T
- Weight: 1.21kg - 54cm Air brush
- Fork: Integrated Full carbon TK921
- Air brush color Finish



Forks, Expanders & Spacers

TK921 Mono-Q Integrated Full Carbon Fork

-Carbon Integrated steerer & curved blades, alloy ends, 700C for Road.
 -Ø45mm Crown for integrated headset
 -1-1/8" Carbon steerer ID Ø22.2mm
 -Crown race: Ø30mm
 -Weight: 360g
 • TK921W MONO-Q White Integrated Full Carbon Fork
 -Weight: 440g



TK921

TK921W



Carbon Spacer for 1-1/8" Steerer

Height	Black	Sliver	Weight
5mm	TKC3505	TKC3505W	2.5g
10mm	TKC3510	TKC3510W	5.0g
15mm	TKC3515	TKC3515W	7.5g
20mm	TKC3520	TKC3520W	10.0g
25mm	TKC3525	TKC3525W	12.0g

TK925 PYROTEC Alloy Carbon Fork

-Alloy Steerer, carbon curved blades, alloy crown & ends, 700C for Road
 -Ø45mm Crown for integrated headset
 -1/8" alloy steerer ID Ø24.6mm
 -Crown race: Ø30mm
 -Weight: 540g



TK925



Carbon Conical Spacer for 1-1/8" Steerer

Height	Black	Sliver	Weight
15mm	TKC2815	TKC2815W	9g
20mm	TKC2820	TKC2820W	10.5g
25mm	TKC2825	TKC2825W	12.0g
30mm	TKC2830	TKC2830W	13.5g

TK926 MONO-Q Integrated Full Carbon Fork for Cyclocross

-Carbon steerer, monocoque design crown & blades
 -Ø45mm crown for integrated headset
 -1-1/8" Carbon steerer ID Ø 24.7 mm
 -Crown race: Ø30mm
 -Tire clearance: Ø 52mm
 -Offset: 45mm
 -Weight: 500g



TK926

Multiple combinations of Expanders



Alloy Cap (A)



Alloy / Carbon (AC)



White Alloy / Carbon (CW)



Full Carbon (C)



Expander I



Expander II

Cap	A	AC	CW	C	Fork steerer ID	Weight
Ø22mm	TK2852A	TK2852AC	TK2852CW	TK2852C	Ø22~23mm	39g
Ø23mm	TK2853A	TK2853AC	TK2853CW	TK2853C	Ø23~24mm	41g
Ø24mm	TK2854A	TK2854AC	TK2854CW	TK2854C	Ø24~25mm	43g
Ø25mm	TK2855A	TK2855AC	TK2855CW	TK2855C	Ø25~26mm	45g

Cap	A	AC	CW	C	Fork steerer ID	Weight
Ø22mm	TK2862A	TK2862AC	TK2862CW	TK2862C	Ø22~23mm	43.5g
Ø23mm	TK2863A	TK2863AC	TK2863CW	TK2863C	Ø23~24mm	46g
Ø24mm	TK2864A	TK2864AC	TK2864CW	TK2864C	Ø24~25mm	48.5g
Ø25mm	TK2865A	TK2865AC	TK2865CW	TK2865C	Ø25~26mm	51g

TK318A 1-1/4" Alloy Expander, 52g

- Alloy Cap, Star Nut, Stainless steel bolt



TK385 1.5" Tension Adjuster, 40g

- Alloy Cap, Star Nut, Stainless steel bolt



TK289C 1-1/8" All-in-one Carbon / Stainless steel expander

- Carbon Cap
 - Changeable 2pcs stainless steel expanders to fit steers ID Ø22~26mm, 19g



TK280AC 1-1/8" Tension Adjuster, 28g

- Alloy/Carbon Cap, Star Nut, Stainless Steel bolt



TK951 PYROTEC Carbon Saddle

- Carbon Fiber Seat
- 6/4 Ti Rails
- Weight: 140g



TK951W White Carbon Saddle

- White Fiber Glass Matrix on Carbon Seat
- 6/4 Titanium rails
- Weight: 150g



TK956 KEVLAR Saddle

- Low profile race style Kevlar seat
- Titanium rails
- Embroidered logo
- Colors: Red & Black
- Weight: 170g



TK910 MONO-Q Carbon Seat Post

- Monocoque carbon construction post
- CNC machined alloy clamp
- 2 bolts set up and micro adjust mechanism
- Diameter: Ø27.2mm, Ø31.6mm
- Length: 250, 300, 350mm
- Weight: 180g (Ø27.2x300mm)

MONO-Q™



TK911G PYROTEC Carbon Seat Post

- 80% fiber glass +20% carbon post / bonded with alloy clamp
- 1 bolt sets up and adjusts mechanism
- Diameter: Ø27.2mm
- Length: 250,300,350mm
- Weight: 250g (Ø27.2x300mm)

PYROTEC®



TK911GW White Carbon Seat Post

- White fiber glass post / bonded with alloy clamp
- One bolt sets up and adjusts mechanism
- Diameter: Ø27.2mm
- Length: 250, 300, 350mm
- Weight: 250g (Ø27.2x300mm)

PYROTEC®



TK912 PYROTEC Carbon Seat Post

- Carbon fiber post/bonded with alloy clamp
- 1 bolt sets up and micro adjusts mechanism
- Diameter: Ø27.2mm
- Length: 250, 300, 350mm
- Weight: 220g (Ø27.2x300mm)

PYROTEC®



TK915 MONO-Q Carbon Seat Post

- Monocoque Carbon Construction post
- CNC Machined alloy Clamp
- One bolt sets up and adjusts mechanism
- Diameter: Ø27.2mm, Ø31.6mm, Ø32.4mm
- Length: 250, 300, 350mm
- Weight: 170g (Ø27.2x300mm)

MONO-Q™



TK916 PYROTEC Carbon Seat Post

- Blade type
- CNC machined alloy clamp
- 2 bolts set up and micro adjust mechanism
- Diameter: Ø27.2mm, Ø31.6mm
- Length: 250, 300, 350mm
- Weight: 185g (Ø27.2x250mm)

PYROTEC®



TK918 PYROTEC Carbon Seat Post

- Carbon fiber post / bonded with alloy 2014 CNC machined clamp
- 1 bolt sets up and adjusts mechanism
- Diameter: Ø 27.2mm, Ø31.6mm, Ø32.4mm
- Length: 250,300,350mm
- Weight: 235g (Ø31.6x300mm)
210g (Ø27.2x300mm)

PYROTEC®



TK- SC701 CNC 7075 Seat Clamp

- 7075 Alloy CNC Clamp Black Anodized
- Scandium locking threaded Nut, Crmo bolt
- Size: 31.8 mm
- Weight: 19g
- TK-SC701Ti with 6/4 Titanium bolt



TK-SC701 CNC 7075 Seat Clamp

- Black Anodized 7075 Alloy CNC Clamp
- Scandium locking threaded Nut, Crmo bolt
- Size: 34.9mm
- Weight: 25g
- TK-SC701 Ti with 6/4 Titanium bolt



Integrated Headsets & AC Bearings

OMEGA • IZ Ø45 Alloy

Water Seal 1-1/8" Integrated Headset

- Ø28.6X30X45mm
- Top Cover: Ø28.6x45 6061 T6 CNC machined
- Crown Race: Ø30mm 7075 T6 CNC machined
- High Rolling Sealed ACBearing TK410A: Ø30.2x41x7x45°x45°
- THxTID: 2.8x45°x41.2
- BHxTID: 7.2x45°x41.2
- Height: 10mm
- Weight: 54g (w/o Alloy Cap)

- TK410S stainless steel ACBearing for option



OMEGA • IZC Ø45 Carbon

Water seal 1-1/8" Integrated Headset

- Ø28.6x30x45mm
- Top Cover: Ø28.6x45 Carbon construction
- Crown race: Ø30mm 7075 T6 CNC machined
- High Rolling Sealed ACBearing TK410A: Ø30.2x41x7x45°x45°
- THxTID=2.8x45°x41.2
- BHxTID=7.2x45°x41.2
- Height: 10, 20, 30mm for options
- Weight: 55g (w/o Cap)
- Carbon Top Cover colors: Black, Blue, Red & White for options (Normally with black carbon Top Cover)



OMEGA • IIC Ø46 Carbon 1-1/8" Integrated Headset Water Seal 1-1/8" Integrated Headset

- Ø28.6x30x46mm
- Top Cover: Ø28.6x46 Carbon construction
- Crown Race: Ø30mm 7075 T6 CNC machined
- High Rolling Sealed ACBearing TK418A: Ø30.2x41.8x8x45°x45°
- THxTID: 3.2x45°x42.0
- BHxTID: 7.2x45°x42.0
- Height: 12mm
- Weight: 56g



OMEGA • IIA Ø46 Alloy Water Seal 1-1/8" Integrated Headset with Campagnolo Compatible Sealed ACBearing

- Ø28.6x30x46mm
- Top cover: Ø28.6x46 6061T6 CNC machined
- Crown Race: Ø30mm 7075T6 CNC machined
- High Rolling Campagnolo Compatible Sealed ACBearing TK418CA: Ø30.2x41.8x8x45°x45°
- THxTID: 3.2x45°x42.0
- BHxTID: 7.2x45°x42.0
- Height: 10mm
- Weight: 64g (w/o Alloy Cap)



TK418CA

- Campagnolo Compatible, High Rolling Sealed ACBearing
- Ø30.2x41.8x8x45°x45°



TK418A

- High Rolling Sealed ACBearing
- Ø30.2x41.8x8x45°x45°



TK410A

- High Rolling Sealed ACBearing
- Ø30.2x41x7x45°x45°



TK410S

- Stainless Steel High Rolling Sealed ACBearing
- Ø30.2x41x7x45°x45°

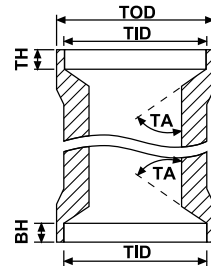

TOD = Head Tube Outer Diameter
TID = Head Tube Inner Diameter
TH = Top Head tube reamer height
BH = Bottom Head tube reamer height
TA = Reamer Angle

Chart of Various Integrated Headsets

Model#	Top Cover	Size	TOD	TID	OD of Sealed Bearing	TH	TA	BH	Stack Height	Model of Sealed Bearing	Reference
OMEGA • IA	Alloy	1-1/8"	45	41.2	41.0	3.2	45°	7.2	10	TK410A	IS-2 IS-3
OMEGA • IC	Carbon	1-1/8"	45	41.2	41.0	3.2	45°	7.2	10	TK410A	IS-2 IS-3
OMEGA • IZ	Alloy	1-1/8"	45	41.2	41.0	2.8	45°	7.2	10	TK410A	#16 #23
OMEGA • IZC	Carbon	1-1/8"	45	41.2	41.0	2.8	45°	7.2	10	TK410A	#16/CC #23/CC
OMEGA • IIA	Alloy	1-1/8"	46	42.0	41.8	3.2	45°	7.2	12	TK418A	Ritchey Compatible
OMEGA • IIC	Carbon	1-1/8"	46	42.0	41.8	3.2	45°	7.2	12	TK418A	Ritchey Compatible
OMEGA • IIAA	Alloy	1-1/8"	46	42.0	41.8	3.2	45°	7.2	10	TK418CA	Campagnolo Compatible
OMEGA • IIIC	Carbon	1-1/8"	46	42.0	41.8	3.2	45°	7.2	12	TK418CA	Campagnolo Compatible
OMEGA • IIIZ	Alloy	1-1/8"	46	42.0	41.8	2.8	45°	6.8	10	TK418CA	#8B
OMEGA • IIIZC	Carbon	1-1/8"	46	42.0	41.8	2.8	45°	6.8	12	TK418CA	#8C

KUDOS • Z (TK011A)

Alloy 1-1/8" Internal Headset for ATB

- Ø28.6x30x44x50mm
- Top Cover: Ø28.6x50 Alloy 6061 T6 CNC machined
- Cups: Ø44x50 Alloy 6061 T6 CNC machined
- Crown race: Ø30 Alloy 7075 T6 CNC machined
- High Rolling Sealed ACBearings
- TK410A: Ø30.2x41x7x45°x45°
- Height: 19mm, ZS-2 Compatible
- Weight: 87g (w/o Cap)



KUDOS • ZC (TK011C)

Carbon 1-1/8" Internal Headset for ATB

- Ø28.6x30x44x50mm
- Top Cover: Ø28.6x50 Carbon Construction
- Cups: Ø44x50 CNC Alloy 6061 T6
- Crown race: Ø30 Alloy 7075 T6
- High Rolling Sealed ACBearings
- TK410A: Ø30.2x41x7x45°x45°
- Height: 29mm, ZS-2 Compatible
- Weight: 80g (w/o Cap)
- Carbon Top Cover Colors: Black, Blue & Red for options (Normally with black Carbon Top Cover)



KUDOS • V (TK018CB)

Alloy 1-1/8" Internal Headset for ATB

- Ø28.6x30x44x50mm
- Top Cover: Ø28.6x50 Alloy 6061 T6 CNC machined
- Cups: Ø44x50 Alloy 6061 T6 CNC machined
- Crown race: Ø30 steel
- High Rolling Cartridge ACBearings
- TK417CB: Ø31x41.7x8x36°x45°
- Height: 13mm
- Weight: 89g (w/o Cap)



KUDOS • DX (TK020DX)

New Alloy 1 1/8" Double Lock Internal Headset With Water Seal for ATB

- Ø28.6x30x44x50mm
- Top Cover: Ø28.6x50 Alloy 6061 CNC with Double Lock & Water Seal, easy adjusting
- Cups: Ø44x50 Full Cartridge steel cups
- Crown race: Ø30 steel
- Height: 34mm
- Weight: 175g (w/o Cap)



EOXIS • W (TK110A)

Alloy 1-1/8" AC Bearing Threadless Headset

- Ø28.6x34x30mm for ATB & Road
- Full set alloy 6061 T6 CNC machined cups with steel crown race
- High Rolling ACBearings
- TK410A: Ø30.2x41x7x45°x45°
- Height: 30mm
- Weight: 96g (w/o Cap)



EOXIS • R (TK119A)

Super lightweight 7075T6 1-1/8" Sealed Bearing Threadless Headset

- Ø28.6x34x30mm for Road & XCMTB
- Full set alloy 7075 T6 CNC machined cups with stainless steel crown race
- High rolling sealed bearings
- TK6806-2RS: Ø30.2x42x7x45°
- Height: 26.5mm
- Weight: 95g (w/o Cap)



EOXIS • Z (TK667CN)

Alloy 1-1/8" AC Needle Bearing Threadless Headset

- Ø28.6x34x30mm for ATB & Road
- Full set alloy 6061 T6 CNC machined cups & crown race
- High rolling AC Needle Bearings
- TK417CN: Ø30.2x41.7x8x45°x45°
- Height: 28.8mm
- Weight: 75g (w/o Cap)
- EOXIS • ZB(TK627CN) 1" Threadless Headset



EOXIS • V (TK668CB)

Alloy 1-1/8" Cartridge Bearing Threadless Headset

- Ø 28.6x34x30mm for ATB
- Full set alloy 6061 T6 CNC machined cups with steel crown race
- High Rolling AC Cartridge Bearings
- TK417CB Ø31x41.7x8x36°x45°
- Height: 30.5mm
- Weight: 90g (w/o Cap)



Heavy Duty Threadless Headsets

CADAC • ZA (TK115A)

7075 1-1/8" Heavy Sealed Bearing Threadless Headset

- Ø28.6x34x30mm for **Down Hill, Free Ride**
- Full set CNC machined alloy 7075 T6 Humongous Cups
- Heavy high rolling 6807RS pressed in sealed bearings
- Height: 32.5mm
- Weight: 160g (w/o Cap)
- 6061T6 Alloy also available



CADAC • ZS (TK115AS)

Stainless Steel 1-1/8" Heavy Sealed Bearing Threadless Headset

- Ø28.6x34x30mm for **Down Hill, Free Ride**
- Full set CNC machined stainless steel Humongous Cups
- Heavy High Rolling 6807RS Pressed in sealed bearings
- X-Long 25mm or 15mm insertion cups for options
- Height: 32.5mm
- Weight: 260g (w/o Cap)



CADAC • ZM (TK115ACM)

Cromo 1-1/8" Heavy Sealed Bearing Threadless Headset

- Ø28.6x34x30mm for **Dirt Jump**
- Full set CNC machined Cromo Humongous Cups
- Heavy high rolling 6807RS pressed in sealed bearings
- Height: 32.5mm
- Weight: 280g (w/o Cap)



CADAC • X (TK118ACB)

Alloy 1-1/8" Heavy ACBearing Threadless Headset

- Ø28.6x34x30mm for **Down Hill, Free Ride**
- Full set CNC machined 6061 T6
- Crown Race: **stainless steel**
- Heavy high rolling sealed ACBearing
- TK438C: Ø33x43.8x7x30°x45°
- Height: 32.5mm
- Weight: 120g (w/o Cap)



CADAC • V (TK737SW)

Rotor type cromo 1-1/8" Heavy Threadless Headset

- Ø28.6x34x30mm for **BMX Freestyle**
- Compact Upper Cone & Cup: Ø45mm CNC machined Cromo
- Humongous Lower Cup & Crown race: CNC machined cromo with 1/4"x15 Balls
- High Polished CP or Black ED finish for options
- Height: 30mm
- Weight: 195g (w/o Cap)



CADAC • W (TK737ACB)

Rotor type Alloy 1-1/8" Heavy Sealed ACBearing Threadless Headset

- Ø28.6x34x30mm for **BMX Freestyle**
- Full set CNC machined 6061 T6 cups with **stainless steel crown race**
- Compact alloy upper cup & sealed ACBearing
- TK410A: Ø30.2x41x7x45°
- Humongous alloy lower cup & **stainless steel** crown race with heavy sealed ACBearing
- TK438C: Ø33x43.8x7x30°x45°
- Height: 30mm
- Weight: 108g (w/o Cap)



TEMPA • X (TK151)

Alloy 1.5" Heavy Sealed Bearing Headset

- Ø38.2x49.6x39.8mm for **Down Hill, Free Ride**
- Full set CNC machined alloy 6061 T6 cups & **stainless steel** crown race
- Heavy High Rolling 6808RS pressed in sealed bearings
- 20mm head tube insertion cups
- Height: 37mm
- Weight: 205g (w/o Cap)
- TEMPA • XR 1.5" Reduced 1-1/8"



TEMPA • Z (TK152)

X-Long Alloy 7075 1.5" Heavy Sealed Bearing Headset

- Ø38.2x49.6x39.8mm for **Down Hill, Free Ride**
- Full set CNC machined alloy 7075 T6 Cups & crown race
- Heavy high rolling 6808 RS pressed in sealed bearings
- 25mm X-Long head tube insertion cups
- Height: 32mm
- Weight: 182g (w/o cap)



New patented Two-Tone Headsets & Safehead

Notch • TT

Steel 1-1/8" Cartridge Threadless Headset

- Ø28.6X34X30 for ATB
- Set 4pcs, water seal type
- Two colors full Cartridge steel cups make following combinations
 - Chrome plating + Black
 - Satin finish + Black
 - Titanium finish + Black
- Weight: 150g



Notch • AT

Alloy/Steel 1-1/8" Cartridge Threadless Headset

- Ø28.6X34X30 for ATB
- Set 4pcs, water seal type
- Two colors of anodized alloy cover & black steel cups make following combinations
 - Red + Black
 - Light Blue + Black
 - Dark Brown + Black
- Weight: 135g



Notch • AA

Alloy 1-1/8" ACBearing Threadless Headset

- Ø28.6 x 34x30 for ATB
- Set 4 pcs, water seal type
- Two Colors of alloy anodized cups make following combinations
 - Red + Black
 - Grey + Black
 - Green + Black
 - Satin + Black
- Weight: 95g



The Token Safe Head is a smart new safety headset for Children's bikes. The Safe Head has a patented internal design that stops the handlebars and front wheel from over rotating. This 130° restricted turning radius prevents the rider from being unintentionally thrown over the front bars resulting in potential harm.

The addition of the Token Safe Head is an incomparable value in the specification of any children's bicycle program.

SAFEHEAD

Patent no.

China: #01229350.4

U.S.: #6,343,806

Germany: #201 11 166.7

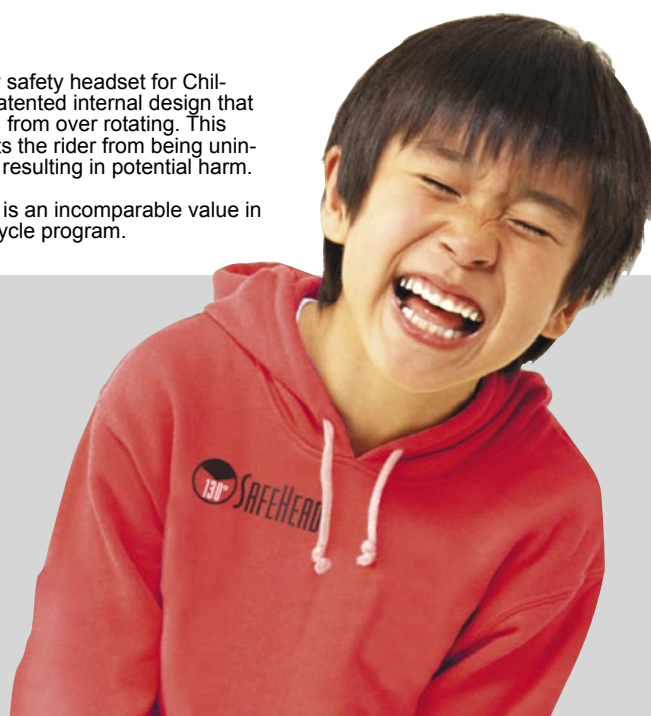

TK7139 • IIS

New Patented product Two Stoppers Safety Headset

- 1" x 24T x 30x27
- Patented 130° (65° x 2) safety device of lower cup & crown race for children's bikes to stop the handlebars and front wheel from over rotating. This 130° restricted turning radius prevents the rider from being unintentionally thrown over the front bars resulting in potential harm.
- Lower Cup with new design "Stop Dot" to prevent cups from moving
- Full cartridge cups
- Height: 40mm
- Weight: 160g



SAFEHEAD



TK7139 • IS New patented one stopper safety headset

- 1" x 24T x 30x27
- Patented 340° (170° x 2) safety device of lower cup & crown race for children's bikes to prevent the cables over rotating caused unintentionally in potential harm
- Lower cup with new design "Stop Dot" to prevent cups from moving
- Full cartridge cups
- Height: 40mm
- Weight: 160g



SAFEHEAD



MTB Cranksets, Alloy Cassettes & Road Crankset

TK901 Mono-Q carbon Triple Crankset for MTB

- Patented spider type carbon construction with 2014 alloy spine
- Length: 170, 172.5, 175mm
- Shuriken 7075 T6 deadlly precise CNC, 44/32/22 chainrings (p.22)
- BCD 94/58mm or 104/64mm
- Triple BB connection styles
 - 113mm ISIS Drive BB (p.15)
 - 113mm Octalink BB
 - 113.5mm JIS Square BB (p.14)
- Chainline: 48mm
- Weight: 610g (M15 Alloy bolts included)

MONO-Q
Shuriken
CHAINBLADES



TK202 Trego • M1 Alloy Triple Crankset for MTB

- Alloy forged crank, four arm spider
- Length: 170, 175mm
- Shuriken 7075 T6 deadlly precise CNC, 44/32/22 chainrings (p.22)
- BCD 104/64mm
- Triple BB connection styles
 - 113mm ISIS Drive BB (p.15)
 - 110.5mm JIS Square BB (p.14)
- Chainline: 48.5mm
- Weight: 740g (M15 Crmo bolts included)

Shuriken
CHAINBLADES



New Alloy MTB Cassettes

- Super lightweight for competition
- 2pcs chromo + 7pcs Alloy 7075 precise CNC construction
- Quick, super precise shifting
- 11-32T Shimano 9 speed compatible
- Weight: 143g



TK208 Mono-Q Alloy Double Crankset for Road

- Forged aluminum cranks high polished
- Length :170, 175mm
- Shuriken 7075 T6 CNC 9/10 speeds 53/39 chainrings (p.22)
- BCD 130mm
- JIS & ISIS Double BB Connection styles
 - 107.5mm JIS square BB (p.14)
 - 108mm ISIS drive BB (p.15)
- Chainline: 43.5mm
- Weight: 670g (M15 Alloy bolts included)

MONO-Q
Shuriken
CHAINBLADES



TK208AC Mono-Q Carbon Matrix Alloy Double Crankset for Road

- Carbon matrix on forged aluminum cranks for durability & longevity
- Length: 170, 175mm
- Shuriken 7075 T6 CNC 53/39 chainrings (p.22)
- BCD 130mm
- JIS & ISIS Double BB connection styles
 - 107.5mm JIS Square BB (p.14)
 - 108mm ISIS Drive BB (p.15)
- Chainline: 43.5mm
- Weight: 685g (M15 Alloy bolts included)

MONO-Q
Shuriken
CHAINBLADES



TK208ACW Mono-Q White Carbon Matrix Alloy Double Crankset for Road

- White fiber glass matrix on forged aluminum cranks for durability & longevity
- Length: 170, 175mm
- Shuriken 7075 T6 CNC 53/39 chainrings (p.22)
- BCD130mm
- JIS & ISIS Double BB connection styles
 - 107.5mm JIS square BB (p.14)
 - 108mm ISIS drive BB (p.15)
- Chainline: 43.5mm
- Weight: 685g (M15 Alloy bolts included)

MONO-Q
Shuriken
CHAINBLADES



TK902 Mono-Q Carbon Double Crankset

- Patented Monocoque carbon/alloy construction
- Length: 170, 172.5, 175mm
- Shuriken 7075 T6 CNC 9/10 Speeds 53/39 Chainrings (p.22), BCD130mm
- Double BB connection styles
 - 103mm JIS Square BB (p.14)
 - 108mm ISIS Drive BB (p.15)
 - 109.5mm Octalink BB
- Chainline: 43.5mm
- Weight: 600g (M15 Alloy Bolts included)
- TK903 spider type Carbon Double Crankset

MONO-Q
Shuriken
CHAINBLADES



TK902III Mono-Q Carbon Triple Crankset

- Patented Monocoque carbon/alloy construction
- Length: 170, 172.5, 175mm
- Shuriken 7075 T6 CNC, 10 Speeds 52/42/30 Chainrings(p.22)
- BCD 130/74mm
- Triple BB connection styles
 - 111mm ISO Square BB
 - 118mm ISIS Square BB
 - 118.5mm Octalink BB
- Chainline: 46mm
- Weight: 698g (M15 Alloy Bolts included)

MONO-Q
Shuriken
CHAINBLADES



TK906 Mono-Q Carbon Double Crankset

- Monocoque Carbon/alloy construction
- Length 170, 172.5, 175mm
- Shuriken 7075 T6 CNC 9/10 speeds 53/39 chainrings (p.22), BCD 130mm
- Double BB Connection styles
 - 108mm ISIS Drive BB (p.15)
- Chainline: 43.5mm
- Weight: 600g (M15 Alloy bolts included)

MONO-Q
Shuriken
CHAINBLADES



TK907 Mono-Q Carbon Double Crankset

- Patented Monocoque carbon/alloy construction
- Length: 170, 172.5, 175mm
- Shuriken 7075 T6 CNC 9/10 speeds 53/39 chainrings (p.22), BCD 135mm
- Double BB connection styles
 - 102mm ISO Square BB (p.14)
- Chainline: 43.5mm
- Weight: 558g (M15 Alloy bolts included)

MONO-Q
Shuriken
CHAINBLADES



TK904 Mono-Q Compact Carbon Double Crankset

- New patented Monocoque compact carbon/alloy construction
- Length: 170, 172.5, 175mm
- Shuriken 7075 T6 CNC 9/10 speeds 50/36, 50/34, 48/34 chainrings (p.22), BCD 110mm
- Double BB connection styles/Road
 - 102mm ISO Square BB (p.14)
 - 108mm ISIS Drive BB (p.15)
 - 109.5mm Octalink BB
- Chainline: 43.5mm
- Double BB connection styles/Compactx170mm
 - 110.5mm JIS Square BB (p.14)
 - 111mm ISO Square BB (p.14)
- Chainline: 46mm
- Weight: 560g (M15 Alloy Bolts included)

MONO-Q
Shuriken
CHAINBLADES



TK905 Mono-Q Compact Carbon Double Crankset

- New patented compact spider type carbon/alloy construction
- Length: 170, 172.5, 175mm
- Shuriken 7075 T6 CNC 9/10 speeds 50/36, 50/34, 48/34 chainrings (P.22), BCD 110mm
- Double BB connection style/Road
 - 102mm ISO Square BB (p.14)
 - 108mm ISIS Drive BB (p.15)
 - 109.5mm Octalink BB
- Chainline: 43.5mm
- Double BB connection styles/Compactx170mm
 - 110.5mm JIS Square BB (p.14)
 - 111mm ISO Square BB (p.14)
- Chainline: 46mm
- Weight: 575g (M15 Alloy Bolts included)

MONO-Q
Shuriken
CHAINBLADES



ISO/JIS Square Axle Bottom Brackets

TK838HAL JIS Square BB

- 10B21 Hollow Satin Axle
- Alloy body, alloy cold forged cups
- 2pcs high rolling sealed bearings
- Combined with 68, 70, 73mm width BB shell
- JIS 2" Square Interface only
- Axle Lengths: 107.5, 110.5, 113.5, 116, 119, 122.5, 127.5mm with BSA 1.37" X 24T R/L Cups
- Weight: 225g (110.5mm, w/o bolts)



TK836AL JIS Square BB

- 10B21 solid black axle
- Steel body, alloy cold forged cups
- 2pcs high rolling sealed bearings
- combined with 68, 70, 73mm width BB shell
- JIS 2" square interface only
- Axle lengths: 107.5, 110.5, 113.5, 116, 119, 122.5, 127.5, 132mm with BSA 1.37"x24T R/L cups
- Weight: 260g (110.5mm, w/o bolts)



TK834 JIS Square Cromo BB for Exercise

- SCM4140 CNC machined solid black axle
- Steel body, alloy cold forged cups
- 2pcs high rolling sealed bearings
- JIS 2" square for 68mm width BB shell only
- Axle length: 122mm with BSA 1.37"x 24T R/L cups
- Weight: 360g



TK832W JIS Square BB

- 10B21 Solid black axle
- Steel body, steel water seal cups
- 2pcs high rolling sealed bearings
- Combined with 68, 70, 73mm width BB shell
- JIS 2" square interface only
- Axle lengths: 107.5, 110.5, 113.5, 116, 119, 122.5, 127.5, 132mm with BSA 1.37"x 24T R/L cups
- Weight: 315g (110.5mm, w/o bolts)



TK868CT ISO/JIS Square Titanium BB

- CNC machined hollow 6/4 Ti axle
- Carbon body, alloy cold forged cups
- 2pcs high rolling sealed bearings
- ISO 1.8" Square axle lengths
 - 102mm with BSA 1.37"x24T R/L cups for 68mm width BB shell
 - 102,111mm with BSC/Ita, 36mm x 24T R/R cups for 70mm width BB shell
- Chainline: 43.5mm/Double, 46mm/Triple & Compact
- JIS 2" Square axle lengths
 - 103, 107.5, 110.5, 113.5, 116, 119, 122.5, 127.5mm with BSA 1.37"x24T R/L cups for 68mm width BB shell
- Weight: 154g (102mm, w/o bolts)
165g (111mm, w/o bolts)



-CNS patent #216105

TK868CTW White ISO/JIS Square Titanium BB

- Same as TK868CT but white carbon body



TK866CM ISO/JIS Square Cromo BB

- CNC machined hollow SCM4140 satin axle
- Carbon body, alloy cold forged cups
- 2pcs high rolling sealed bearings
- ISO 1.8" Square axle lengths
 - 102mm with BSA 1.37"x24T R/L cups for 68mm width BB shell
 - 102,111mm with BSC/Ita, 36mm x 24T R/R cups for 70mm BB shell
- JIS 2" Square axle lengths
 - 103, 107.5, 110.5, 113.5, 116, 119, 122.5, 127.5mm with BSA 1.37"x 24T R/L cups for 68mm width BB shell
 - 110.5, 113.5, 116, 119, 122.5, 127.5mm with BSA 1.37"x24T R/L cups for 73mm width BB shell
- Weight: 210g (102mm w/o bolts)



-CNS patent #216105

TK851AL New SUJ2 IBT JIS Square BB

- CNC machined hollow SUJ2 black axle
- SUJ2 Integrated bearing technology (IBT) durable construction
- SUJ2 chrome steel ball Ø3/16"x9pcs, bigger & stronger
- BSA1.37"x 24T alloy cold forged cups
- JIS 2" square interface only
- Axle lengths: 107.5, 110.5, 113.5, 116, 119, 122.5, 127.5, 132mm
- Weight: 290g (110.5mm, w/o bolts)



TK872AL Cromo ISIS Drive BB

- CNC machined hollow SCM4140 spindle with M15 threaded
- Alloy body, alloy cold forged cups
- 2 pcs high rolling sealed bearings
- 108mm ISIS drive for Double Road
 - 68xBSA 1.37"x 24T, R/L cups
 - 70xBSC/Ita. 36mmx24T, R/R cups
 - Chainline: 43.5mm/Double Road
 - Weight: 205g (108mm, w/o bolts)
- TK873AL 113mm for MTB XC, 3 Bearings
Chainline: 48mm
- TK874AL 118mm for Down Hill, 4 Bearings
Chainline:50.5mm



TK875BC New SUJ2 IBT ISIS Drive BB

- CNC Machined hollow SUJ2 spindle
- SUJ2 Integrated bearing technology (IBT) durable construction
- Alloy cold forged cups
- 108mm ISIS drive for Double Road
- 113mm ISIS Drive for MTB, XC
- 118mm ISIS Drive for Triple Road & DH
 - 68xBSA 1.37"x 24T, R/L cups
 - 70xBSC/Ita. 36mmx24T, R/R cups
 - 73xBSA 1.37"x 24T, R/L cups
 - Chainline: 43.5mm/Double
46mm./Triple Road
48mm/MTB
50.5mm/DH
- Weight:215g (113mm, w/o bolts)



TK876AL New Multipurpose Cromo ISIS Drive BB

- CNC machined hollow SCM4140 spindle with M15 threaded
- Alloy 68~73mm body, alloy cold forged cups
- 2 pcs X-Long high rolling sealed bearings
- 113mm ISIS Drive for MTB, XC
- 118mm ISIS Drive for Triple Road, DH
- 123mm ISIS Driver for Trial
- 68, 73mm x BSA1.37"x 24T, R/L cups
- Chainline: 46mm/Triple Road
48mm/MTB, XC
50.5mm/DH
- Weight: 270g(113mm, w/o bolts)



XL-01

- X-Long, High Rolling Sealed Bearings
- Ø21.5x14x31 for ISIS drive BB
- Durability & longevity

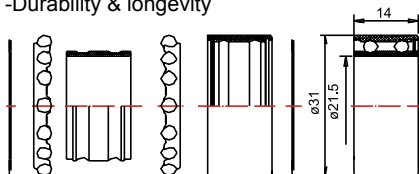

TK872SC New Scandium ISIS Drive BB

- CNC machined hollow scandium spindle with M14 7075 X-Long bolts
- Alloy body, alloy cold forged cups
- 2pcs high rolling sealed bearings
- 108mm ISIS drive for Double Road
 - 68xBSA 1.37"x 24T, R/L cups
 - 70xBSC/Ita. 36mm x 24T, R/R cups
 - Chainline: 43.5mm/Double Road
 - Weight: 128g (108mm, w/o bolts)



TK873SC New Scandium ISIS drive BB

- CNC machined hollow scandium spindle with M12 7075 X-Long Bolts
- Alloy body, alloy cold forged cups
- 3pcs high rolling sealed bearings
- 113mm ISIS Drive for MTB, XC
- 118mm ISIS Drive for Triple Road, DH
 - 68xBSA 1.37" x 24 T, R/L cups
 - 73xBSA 1.37" x 24T, R/L cups
- Chainline: 46mm/Triple Road
48mm/MTB, XC
50.5mm/DH
- Weight: 140g (113mm, w/o bolts)
162g (118mm, w/o bolts)



TK873CT Titanium ISIS Drive BB

- CNC machined hollow 6/4Ti spindle with M15 threaded
- Carbon body, alloy cold forged cups
- Right cup X-Long™ High Rolling sealed bearing, Left cup normal high rolling sealed bearing
- 108mm ISIS Drive for Double Road
- 113mm ISIS Drive for MTB, XC
- 118mm ISIS Drive for Triple Road, DH
 - 68x BSA 1.37"x24T, R/L cups
 - 70x BSC/Ita. 36mmx24T, R/R cups
 - 73xBSA 1.37"x 24T, R/L cups
- Chainline: 43.5mm/ Double Road
46mm/Triple Road
48mm/MTB.XC
50.5mm/DH
- Weight: 185g (108mm, w/o bolts)



Left & Right Cups with Water seal to prevent Dust & Water into bearings.



Cycle Cross & MTB Handlebar

TK979SC Mono-Q Carbon Matrix Scandium Flat Bar for MTB

- Black carbon matrix on scandium bar
- Bend: 5°
- Width: 580, 600mm
- Bar bore: Ø31.8mm (1-1/4")
- Weight: 150g

MONO-Q™

- TK979AC Carbon Matrix 7050 Flat Bar for MTB



TK979 Mono-Q Carbon Flat Bar for XCMTB

- Monocoque carbon construction
- Bend: 6°
- Bar bore: Ø31.8mm (1-1/4")
- Width: 580, 600mm
- Weight: 125g (600mm)

MONO-Q™



TK970 Carbon Integrated Flat Bar for XCMTB

- Monocoque carbon construction, Integrated type
- Steerer clamp dia: Ø28.6mm
- Width: 580mm
- Extension: 90, 100, 110, 120, 130mm
- Weight: 290g

MONO-Q™



TK979SCW Mono-Q White Carbon Matrix Scandium Flat Bar for MTB

- White fiber glass matrix on scandium bar
- Bend: 5°
- Width: 580, 600mm
- Bar bore: Ø31.8mm (1-1/4")
- Weight: 158g

MONO-Q™

- TK979ACW White Carbon Matrix 7075 Flat Bar for MTB



TK979W Mono-Q White Carbon Flat Bar for XCMTB

- White fiber glass matrix on carbon bar
- Bend: 6°
- Bar bore: Ø31.8mm (1-1/4")
- Width: 580, 600mm
- Weight: 155g (600mm)

MONO-Q™



TK971 Carbon Integrated Hiriser Bar for XCMTB

- Monocoque carbon construction, Integrated type
- Rise: 1.5"
- Steerer Clamp dia: Ø28.6mm
- Width: 660mm
- Extension: 90, 100, 110, 120, 130mm
- Weight: 300g (110mm)

MONO-Q™



TK978 Mono-Q Carbon Flat Bar for XCMTB

- Monocoque Carbon Construction, Oblique profile design for stability and rigidity
- Bar bore: Ø31.8mm
- Width: 580mm
- weight: 142g

MONO-Q™

- TK978B 1" (Ø25.4mm), 138g



TK972 Mono-Q Carbon Hiriser Bar for XCMTB

- Monocoque carbon construction, Oblique profile design for stability and rigidity, Rise 1"
- Bar bore: Ø31.8mm
- Width: 660mm
- Weight: 170g

MONO-Q™



TK972B 1" Mono-Q Carbon Hiriser Bar for XCMTB

- Monocoque carbon construction, Oblique profile design for stability and rigidity, Rise 1"
- Bar bore: Ø25.4mm
- Width: 660mm
- Weight: 185g

MONO-Q™



TK974A Mono-Q Alloy Handle Bar

- Monocoque Alloy 2014, 7050 construction
- Width: 400, 420, 440mm C-C
- Bar bore: Ø31.8mm
- Drop: 145mm C-C
- Weight: 300g



MONO-Q™

TK973 Mono-Q Carbon Handle Bar

- Monocoque carbon construction
- Width: 400, 420, 440mm C-C
- Bar bore: Ø 31.8mm
- Shimano & Campy Compatible
- Weight: 230g (420mm)



MONO-Q™

TK977 Carbon Integrated Handlebar for Racing

- Monocoque carbon construction, Integrated type
- Homogeneous design provides maximum stiffness and strength
- Dual groove design for unified cable routing
- Computer bracket OD 26mm
- Width: 400, 420mm C-C
- Stem length: 90, 100, 110, 120, 130mm
- Drop: 145mm C-C
- Steerer clamp dia: 28.6mm
- Tightening torque 10Nm
- Weight: 405g, 420x120w/computer bracket



MONO-Q™

TK975A MONO-Q Alloy Handle Bar

- Monocoque alloy 2014, 7050 construction
- Aero wing with Ergo oversized hand holding
- Dual groove for integrated cable routing
- Width: 400, 420, 440mm C-C
- Bar bore: Ø31.8mm
- Drop: 145mm C-C
- Weight: 285g/420mm



MONO-Q™

TK975AC Mono-Q Carbon Matrix Alloy Handle Bar

- Carbon matrix on monocoque alloy 2014, 7050
- Aero wing with Ergo oversized hand holding
- Dual groove for integrated cable routing
- Width: 400, 420, 440mm C-C
- Bar bore: Ø31.8mm
- Drop: 145mm C-C
- Weight: 295g



MONO-Q™

TK975ACW Mono-Q White Carbon Matrix Alloy Handle Bar

- White fiber glass matrix on monocoque alloy 2014, 7050
- Aero wing with Ergo oversized hand holding
- Dual groove for integrated cable routing
- Width: 400, 420, 440mm C-C
- Bar bore: Ø31.8mm
- Drop: 145mm C-C
- Weight: 315g



MONO-Q™

TK976A Mono-Q Alloy Handle Bar

- Monocoque alloy 2014, 7050 Construction with maximum comfort design
- Aero wing with Ergo oversized hand holding
- Dual groove for integrated cable routing
- Width: 400, 420, 440mm C-C
- Bar bore: Ø31.8
- Drop: 145mm C-C
- Weight: 270/400mm



MONO-Q™

TK976 Mono-Q Carbon Handle Bar

- Monocoque carbon construction with maximum comfort design
- Aero wing with Ergo oversized hand holding
- Dual groove for integrated cable routing, Shimano & Campy Compatible
- Width: 400, 420, 440mm C-C
- Bar bore: Ø 31.8mm
- Drop: 143mm C-C
- Weight: 200g/400mm



MONO-Q™



Dual Cable routing for TK976

Bar Ends, Grips, Ti bolts & Carbon Patches

Titanium Bolts

Ti-K051 M5x16, 2.0g
Ti-K052 M5x21, 2.5g
Ti-K060 M6x9, 2.0g



Ti-K051

AL-K150

-M15x14 Alloy bolt with alloy cover
-Weight: 9g/1pcs



CM-K082

-M8x20 Crmo bolt with plastic cover
-Weight: 15.5g/1pcs



Ti-K083

-Titanium bolt/nut for chainring & crank assembling
-Weight: 3 g/set



AL-K083

-Alloy bolt/nut for chainring & crank assembling
-Weight: 1.75g/set



Ti-K061 M6x14, 2.5g
Ti-K062 M6x17, 3.0g
Ti-K063 M6x22, 4.0g



Ti-K061

Ti-K150

-M15x14 6/4 Ti bolt with Ti cover
-Weight: 16g/1pcs



Ti-K082

-M8x20 Ti bolt with plastic cover or Ti cover
-Weight: 8.5g/1pcs



TK980 Mono-Q Carbon Bar Ends

-Monocoque alloy main body laminated with carbon fiber
-Durability and longevity
-Weight: 150g/prs



TK980W MONO-Q White Carbon Bar Ends

-Monocoque alloy main body laminated with white fiber glass
-Durability and longevity
-Weight: 160g/prs



TK981 PYROTEC Carbon Bar Ends

-Big profile carbon tube/bonded with 6061 T6 alloy clamp
-With 6061 T6 alloy clamp
-Weight: 157g/prs



TK982 PYROTEC Carbon Bar Ends

-Carbon tube/bonded with 6061 T6 alloy clamp
-Weight: 126g/prs



TK983 PYROTEC Carbon Bar Ends

-New Carbon Bar Ends in ergo shape for nice holding, bonded with alloy clamp
-Weight: 120g



TK986GT New EPOCH Triple Colors Grip

-Firm main body covered with Gel
-Easy to put on & take off
-Alloy lock clamp 100% non-slip
-Weight: 82g/prs



TK987GC New EPOCH Carbon Grip

-Firm main body covered with Carbon
-Easy to put on & take off
-Alloy lock clamp 100% non-slip
-Weight: 110g/prs



TK987GCW New EPOCH White Carbon Grip

-Firm main body covered with white fiber glass
-Easy to put on & take off
-Alloy lock clamp 100% non-slip
-Weight: 110g/prs



Carbon Patches

TK-CP301
-30mmx30mm for Head Tube, 0.5g

TK-CP401
-40mmx40mm for Down Tube, 1.0g

TK-CP501
-20x28mmx230mm for Chainstay, 4.5g



CP401



CP301



CP501

TK935AC Mono-Q Carbon Matrix 7075 for Road

- Black carbon matrix on onepiece CNC 7075 alloy stem
- Bar bore: Ø31.8mm
- Steerer Clamp Dia: Ø28.6mm
- Ti bolts
- Extension: 80, 90, 100, 110, 120mm
- Angle: 5°
- Weight: 120g/100mm
- TK934AC Bar bore Ø26mm

MONO-Q



TK935ACW Mono-Q White Carbon Matrix 7075 for Road

- White fiber glass matrix on onepiece CNC 7075 alloy stem
- Bar bore: Ø31.8mm
- Steerer Clamp Dia: Ø28.6mm
- Ti bolts
- Extension: 80, 90, 100, 110, 120mm
- Angle: 5°
- Weight: 125g/100mm
- TK934ACW Bar bore Ø26mm

MONO-Q



TK933ACW Mono-Q white Carbon Matrix 6061 for Road & XCMTB

- White fiber glass matrix on onepiece CNC 6061 alloy stem
- Bar bore: Ø31.8mm
- Steerer Clamp Dia: Ø28.6mm
- Cromo bolts
- Extension: 80, 90, 100, 110, 120mm
- Angle: 5°
- Weight: 145g/100mm
- TK932ACW Bar bore Ø26mm

MONO-Q



TK933AC Mono-Q Carbon matrix 6061 for Road & XCMTB

- Black Carbon Matrix on onepiece CNC 6061 alloy stem
- Bar bore: Ø31.8mm
- Steerer Clamp Dia: Ø28.6mm
- Cromo bolts
- Extension: 80, 90, 100, 110, 120mm
- Angle: 5°
- Weight: 145g/100mm
- TK932AC Bar bore Ø26mm

MONO-Q



TK938 MONO-Q Stem for Road & XCMTB

- Alloy Steerer clamp is molded into cylindrical body for a seamless finish
- Precise CNC machined alloy clamps
- Bar bore: Ø31.8mm
- Steerer Clamp Dia: Ø28.6mm
- Extension: 90, 100, 110, 120, 130mm
- Extension angle: 80° (-10°)
- Tightening torque: 8Nm front, 10 Nm rear
- Weight: 158g (100mm)
- TK938Ti with Ti bolt

MONO-Q



TK937 Mono-Q Stem for Road & XCMTB

- High-modulus carbon fiber main body & front cap to increase structural strength but reduce weight.
- Oblique profile design for increased strength and rigidity.
- Bar bore: 31.8mm
- Steerer Clamp Dia: 28.6mm
- Extension: 90, 100, 110, 120, 130mm
- Extension angle: 80° (-10°)
- Tightening torque: 8Nm front, 10Nm rear
- Weight: 150g (100mm)
- TK937Ti with Ti bolt

MONO-Q



TK936 PYROTEC Stem for Road

- Precise CNC machined alloy clamps/bonded to carbon fiber tube
- Bar bore: Ø31.8mm
- Steerer Clamp Dia: Ø28.6mm
- Extension: 90, 100, 110, 120, 130mm
- Extension angle: 80° (-10°)
- Tightening torque: 8Nm front, 10 Nm rear
- Weight: 173g (100mm)
- TK936Ti with Ti bolt

PYROTEC



TK930 Mono-Q Carbon Stem for Road

- High-modulus carbon fiber main body & front cap to increase structural strength but reduce weight
- Oblique profile design for increased strength and rigidity
- Bar Bore: 26mm
- Steerer Clamp Dia: Ø28.6mm
- Extension: 90, 100, 110, 120, 130mm
- Extension angle: 80° (-10°)
- Tightening torque: 8Nm front, 10Nm rear
- Weight: 155g (110mm)
- TK930Ti with Ti bolts

MONO-Q



Carbon Clincher Wheelsets for Road & MTB

TK966WS/TOKEN MONO-Q C1

- 38mm height, Clincher type, 700C Carbon Rim
- Equipped with
- Super light weight Hubs & Stainless steel spokes
- Front: 20Hx2pcs sealed bearings
- Rear: 24Hx4pcs sealed bearings
- Shimano or Campy Freewheel body for options
- 1,530g/set (w/o tires)

• Carbon Hub available

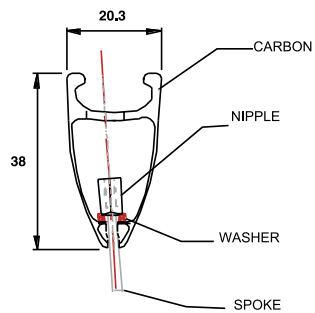

TK969WS/TOKEN PYROTEC C2

- 38mm height, Clincher Type, with alloy braking surface, 700C Carbon Rim
- Equipped with
- Super light weight Hubs & Stainless steel spokes
- Front: 20Hx2pcs sealed bearings
- Rear: 24Hx4pcs sealed bearings
- Shimano or Campy Freewheel body for options
- 1,700g/set (w/o tires)

• Carbon Hub available

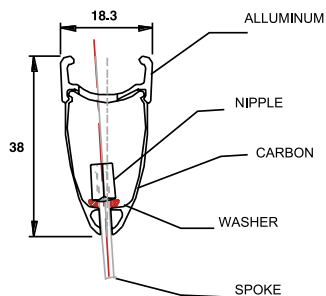

TK962WS/TOKEN MONO-Q CVX

- 24mm height, Tubular type, 24" Carbon Rim for MTB V brakes
- Equipped with:
- Super lightweight Hubs & Stainless steel spokes
- Front: 24Hx2pcs sealed bearings
- Rear: 24Hx4pcs sealed bearings
- Shimano freewheel body
- 1690g/set (w/o tires)

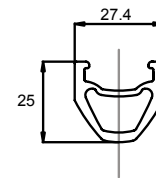

TK963WS/TOKEN MONO-Q CDX

- 25mm height, clincher type, 24" carbon rim for MTB Disc brakes
- Equipped with
- Super lightweight Hubs & Stainless steel spokes
- Front: 24Hx2pcs sealed bearings
- Rear: 24Hx4pcs sealed bearings
- Shimano Freewheel body
- 1570g/set (w/o tires)

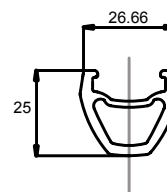

TK965WS/TOKEN MONO-Q T1

- 50mm height, Tubular Type, 700C Carbon Rim
- Equipped with:
 - Super light weight Hubs & Stainless steel spokes
 - Front: 20Hx2pcs sealed bearings
 - Rear: 24Hx4pcs sealed bearings
 - Shimano or Campy Freewheel body for options
 - 1560g/set (w/o tires)
- Carbon Hubs available



TK967WS/TOKEN MONO-Q T2

- 38mm height Hubs & Stainless steel spokes
- Front: 20Hx2pcs sealed bearings
- Rear: 24Hx4pcs sealed bearings
- Shimano or Campy freewheel body for options
- 1470g/set (w/o tires)
- Carbon Hubs available



New 2Ti+4SC+4Alloy CNC Cassettes

- Two titanium sprockets, four scandium sprockets and four 7075 hard anodized sprockets make these the ultimate performance of Shimano and campy 10 speed cassettes for options
- 10,000km warranty



Various Ratios chart

Model#	Ratio	Description	Weight
TK1310S	11-23T	Shimano 10 Speed	101g
TK2510S	12-25T	Shimano 10 Speed	130g
TK2710S	12-27T	Shimano 10 Speed	135g
TK1110C	11-21T	Campy 10 Speed	110g
TK2510C	12-25T	Campy 10 Speed	142g
TK2610C	12-26T	Campy 10 Speed	145g

New Improved Super lightweight 7075T6 CNC Cassettes

- Super lightweight for competition
- One piece, precise CNC 7075 T6 alloy construction
- Quick, super precise shifting
- Shimano, campy 9/10 speeds for options
- 3000km warranty

Various Ratios chart

Model#	Ratio	Description	Weight
TK91S	11-21T	Shimano 9 Speed	90g
TK103S	11-23T	Shimano 10 Speed	96g
TK105S	11-25T	Shimano 10 Speed	99g
TK107S	11-27T	Shimano 10 Speed	105g
TK103C	11-23T	Campy 10 Speed	105g
TK105C	11-25T	Campy 10 Speed	108g
TK107C	11-27T	Campy 10 Speed	115g
TK109C	11-29T	Campy 10 Speed	124g



Shuriken® 7075 CNC Chainblades



Shuriken Chainblades

-7075 T6 deadly precise CNC machined with anodization and laser engraved chainrings
-Smooth chain shifting SCS™ function

Shuriken®
CHAINBLADES

Model#	Teeth	Spider	BCD	For	Weight
MTB01	44-32-22T	5Arm	94/58mm	MTB Triple	146g
MTB02	42-32-22T	5Arm	94/58mm	MTB Triple	138g
MTB03	44-32-22T	4Arm	104/64mm	MTB Triple	143g
MTB04	46-34-24T	4Arm	104/64mm	MTB Triple	160g
RR01	53-39T	5Arm	130 or 135mm	Road Double	145/140g
RR02	53-42T	5Arm	130mm	Road Double	150g
RR03	52-39T	5Arm	130mm	Road Double	140g
RR04	52-42T	5Arm	130mm	Road Double	158g
RR05	50-42T	5Arm	130mm	Road Double	148g
RR06	52-42-30T	5Arm	130/74mm	Road Triple	190g
XM01	50-36	5Arm	110mm	Racing, XC, Trekking	130g
XM02	48-24	5Arm	110mm	Racing, XC, Trekking	119g
XM03	50-34T	5Arm	110mm	Racing, XC, Trekking	125g

TK943

New Central pull carbon bottle cage with screws, 33.5g



TK948

New Mono-Q Central pull super light weight carbon bottle cage with screws 24.5g



TK947

New Mono-Q central pull super lightweight Carbon bottle cage with screws, 15g



TK945

New MONO-Q Central pull carbon bottle cage with screws, 30g



TK946

New Mono-Q Central pull super lightweight, Carbon bottle cage with screws, 25g



TK945W

New Mono-Q central pull white fiber glass, bottle cage with screws, 39g



TK946W

New Mono-Q Central pull white fiber glass, super lightweight bottle cage with screws, 30g



TK-AL01

New Mono-Q Alloy Central pull bottle cage with screws, 35g



TK942

New Mono-Q Central pull Carbon bottle cage with screws, 25g



TK928HM

New OSCAR Helmets for MTB
-Size: 57cm-61cm for L/M
53cm-57cm for M/S
-Retention System: Easy fit gear
-In Mold Construction Safety
Standard:CE. EN 1078, CPSC
-Weight: 339g



TK929HR

New OSCAR Helmets for Racing
-Size: 57cm-61cm for L/M
53cm-57cm for M/S
-Retention system: Easy fit gear
-In Mold Construction Safety
Standard:CE. CN 1078, CPSC
-Weight: 307g



TK958

New AMIGO Water Bottle
-Contents 500cc
-LDPE Injection, printing logo
-Weight: 87g



TK959

New AMIGO Water Bottle
-Contents 600CC
-LDPE Injection, printing logo
-Weight: 87g



TOKEN
TOKEN
TOKEN
TOKEN
TOKEN
High Rolling Bike Products

www.tokenproducts.com

Token Products Inc.
No.120, Chung-Hua Road
Wujih, 414 Taichung, Taiwan
Tel: 886(0)4 2338 6600
Fax: 886(0)4 2338 9900
Email: token@tokenproducts.com

