



2007 Pedals\\Headsets\\Bottom Brackets

VP COMPONENTS



FOCUS 2007

Pedals

- 03 \ CLIP-IN MTB / ROAD
- 04 \ CLIP-IN MTB
- 05 \ MTB
- 07 \ ROAD / SPORT
- 08 \ BMX
- 10 \ BMX / CRUISER
- 11 \ TREKKING / COMFORT / CITY
- 14 \ COMFORT / CITY
- 15 \ FOLDING / ACCESSORIES
- 16 \ EXERCISE
- 18 \ CHILDREN'S
- 19 \ TOE CLIPS / STRAPS

Headsets

- 20 \ HEAD TUBE COMPATIBILITY
- 21 \ THREADLESS INTEGRATED / SEMI-INTEGRATED HEADSETS
- 22 \ THREADLESS SLIMSTAK HEADSETS
- 23 \ THREADLESS HEADSETS
- 24 \ I.5 HEADSET / HEADSET ACCESSORIES
- 25 \ HEADSET CAPS
- 26 \ THREADED HEADSETS

Bottom Brackets

- 28 \ BOTTOM BRACKETS
- 31 \ B/B AXLES & SPECIFICATIONS

The outlook for increased international fuel prices creates a perfect opportunity for the bicycle industry to encourage new riders in the enjoyment of cycling for its lifestyle rewards.

In this environment VP intends to focus even more intensely on adding value to our products so those who are new to cycling, and those who are old hands on two wheels, can enjoy riding a machine equipped with superior parts that are reasonably priced.

Our ongoing drive for excellence in design will continue in partnership with our customers and end consumers and we look forward to playing our part in making the environment a friendlier place as cycling becomes more popular because of economic and lifestyle choices.



**VP-R70**

ROAD

•Replaceable cartridge axle mechanism.

Body \ Coated aluminum, gray. **Axle** \ Cartridge type / CNC Machined Cr-Mo. **Bearings** \ LSL & Sealed. **Binding** \ Fiber-glass reinforced thermoplastic, adjustable tension (80-140kgf.cm). **Cleat** \ VP-ARC1 or VP-BLK1 (optional). **Corner** \ 36°. **Size** \ 85 x 91 mm. **Weight** \ 348 g/pr. **Reflector** \ Optional (VP-R2: black). TW

**VP-R80**

ROAD

•Closed binding design •Cartridge axle mechanism.

Body \ Coated aluminum, gray. **Axle** \ Cartridge type / CNC machined Cr-Mo. **Bearings** \ LSL & Sealed ball bearings. **Binding** \ Fiber-glass reinforced thermoplastic, adjustable tension (80-140 kgf.cm). **Cleat** \ VP-ARC1 or VP-BLK1 (Optional). **Corner** \ 36°. **Size** \ 75 x 96 mm. **Weight** \ 378 g/pr. **Reflector** \ Optional (VP-R2: Black). TW

**VP-M31**

MTB

•Lightweight.

Body \ Barrel polished aluminum. **Axle** \ CNC machined Cr-Mo. **Bearings** \ Ball bearings. **Binding** \ Dual-sided steel, adjustable tension (80-140kgf.cm) **Cleat** \ VP-C01. **Corner** \ 36°. **Size** \ 78 x 59 mm. **Weight** \ 350 g/pr. **Reflector** \ Optional (VP-R5). TW

**VP-R61**

ROAD

Body \ Hand polished aluminum. **Axle** \ CNC Machined Cr-Mo. **Bearings** \ LSL & Sealed. **Binding** \ Single-sided, adjustable tension (80-140kgf.cm). **Cleat** \ VP-C01. **Corner** \ 36°. **Size** \ 81 x 71 mm. **Weight** \ 292 g/pr. **Reflector** \ Optional (VP-R2: gray). TW

**VP-M11**

MTB

•Super light.

Body \ Hand polished aluminum. **Axle** \ CNC machined Cr-Mo. **Bearings** \ LSL & Sealed. **Binding** \ Dual-sided steel, adjustable tension (80-140kgf.cm) **Cleat** \ VP-C01. **Corner** \ 36°. **Size** \ 80 x 55 mm. **Weight** \ 320 g/pr. **Reflector** \ Optional (VP-R5). TW

**VP-X83****MTB MULTI-FUNCTION**

•Inlaid non-slip TPE tread.

Body \ Barrel polished aluminum w/TPE non-slip insert. **Cage** \ ED black aluminum. **Axle** \ CNC Machined Cr-Mo. **Bearings** \ LSL & Sealed. **Binding** \ Single-sided steel, adjustable tension (80-140kgf.cm). **Cleat** \ VP-C01. **Corner** \ 36°. **Size** \ 103 x 63 mm. **Weight** \ 410 g/pr. **Reflector** \ Optional. TW

**VP-X92****MTB MULTI-FUNCTION**

Body \ Barrel polished aluminum. **Cage** \ ED black aluminum. **Axle** \ CNC Machined Cr-Mo. **Bearings** \ Ball bearings. **Binding** \ Single-sided steel, adjustable tension (80-140kgf.cm). **Cleat** \ VP-C01. **Corner** \ 36°. **Size** \ 103 x 63 mm. **Weight** \ 446 g/pr. **Reflector** \ Optional. TW

**VP-X93****MTB MULTI-FUNCTION**

•Inlaid non-slip TPE tread.

Body \ Barrel polished aluminum w/TPE non-slip insert. **Cage** \ ED black aluminum. **Axle** \ CNC Machined Cr-Mo. **Bearings** \ Ball Bearings. **Binding** \ Single-sided steel, adjustable tension (80-140kgf.cm). **Cleat** \ VP-C01. **Corner** \ 36°. **Size** \ 103 x 63 mm. **Weight** \ 466 g/pr. **Reflector** \ Optional. TW

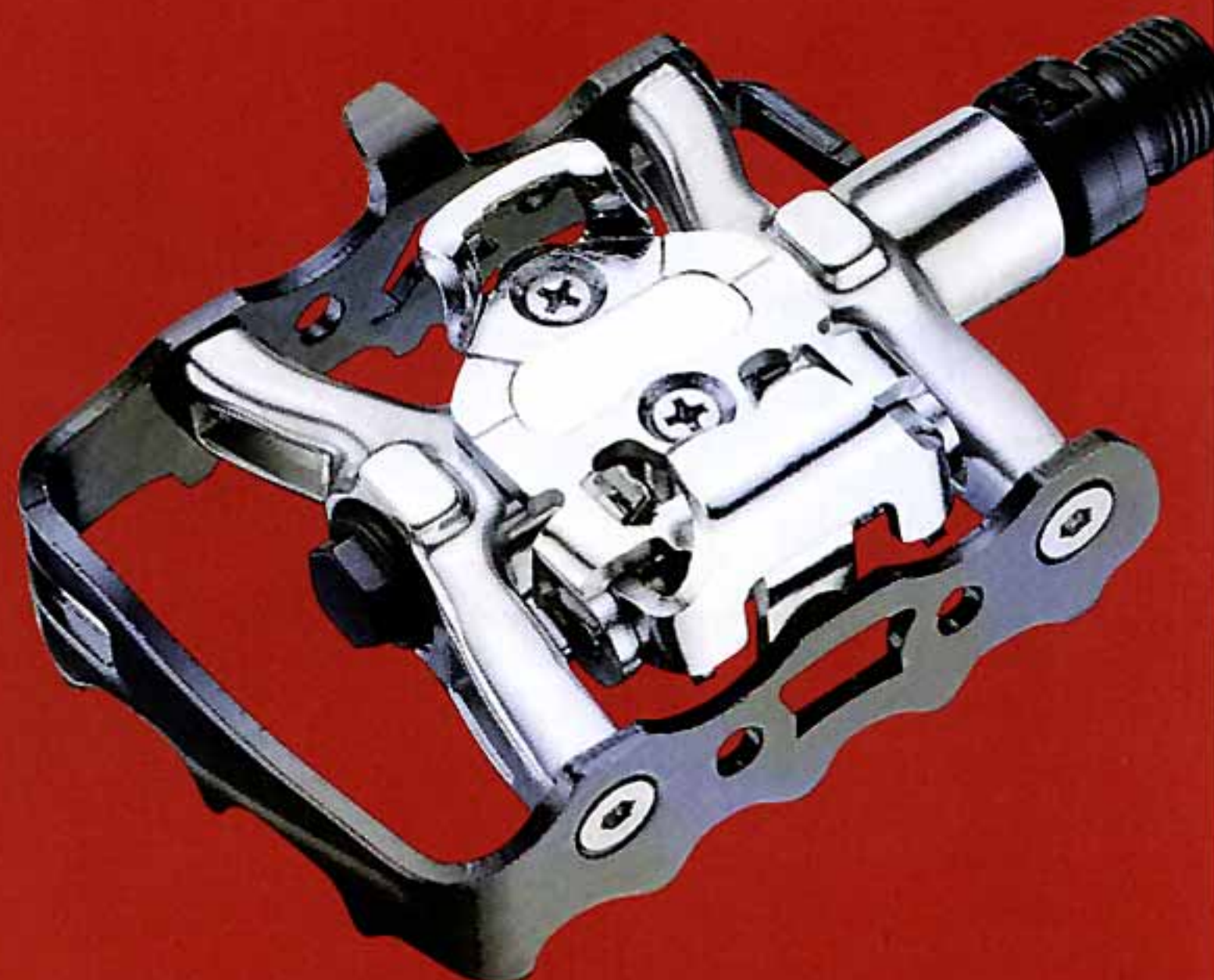
**VP-X82****MTB MULTI-FUNCTION**

Body \ Barrel polished aluminum. **Cage** \ ED black aluminum. **Axle** \ CNC Machined Cr-Mo. **Bearings** \ LSL & Sealed. **Binding** \ Single-sided steel, adjustable tension (80-140kgf.cm). **Cleat** \ VP-C01. **Corner** \ 36°. **Size** \ 103 x 63 mm. **Weight** \ 390 g/pr. **Reflector** \ Optional. TW

**VP-196**

MTB

•Super light.

Body \ Barrel polished aluminum. Cage \ ED black aluminum, cage flip. Axle \ CNC Machined Cr-Mo. Bearings \ LSL & Sealed. Size \ 98 x 64 mm. Weight \ 255 g/pr. Toe Clip \ Attachable. Reflector \ Optional. TW

**VP-199**

COMFORT

•Low profile.

Body \ Barrel polished aluminum. Cage \ ED black aluminum. Axle \ CNC Machined Cr-Mo. Bearings \ Ball bearings. Size \ 97 x 63 mm. Weight \ 250 g/pr. Toe Clip \ Attachable. Reflector \ Optional. TW

**VP-197**

MTB / COMFORT

•Super light •Cold forged one-piece body/cage.

Body \ Cold-forged one piece aluminum, bead blasted, black or silver. Axle \ CNC-machined Cr-Mo. Bearings \ LSL & Sealed. Size \ 98 x 62 mm. Weight \ 250 g/pr. Toe Clip \ Attachable. Reflector \ Optional. TW

**VP-320**

MTB / BMX

•One-piece body/cage.

Body \ One-piece body/cage, barrel polished aluminum. Axle \ Boron steel. Bearings \ Ball bearings. Size \ 87 x 95 mm. Weight \ 380 g/pr. Toe Clip \ Attachable. Reflector \ Optional. TW

**VP-467**

MTB

•One-piece body/cage.

Body \ Barrel polished aluminum. Axle \ Boron steel. Bearings \ Ball bearings. Size \ 102 x 66 mm. Weight \ 400 g/pr. Toe Clip \ Attachable. Reflector \ Optional. TW/CN

**VP-468**

MTB / COMFORT

•One-piece body/cage.

Body \ Barrel polished aluminum. Axle \ Boron steel. Bearings \ Ball bearings. Size \ 105 x 73 mm. Weight \ 396 g/pr. Toe Clip \ Attachable. Reflector \ Optional. TW/CN

**VP-515A**

MTB

Body \ Barrel polished aluminum. Cage \ ED black aluminum. Axle \ Boron steel. Bearings \ Ball bearings. Size \ 103 x 65 mm. Weight \ 370 g/pr. Toe Clip \ Attachable. Reflector \ Optional. Option \ VP-515S steel cage, 430 g/pr. TW/CN

**VP-349A**

MTB

Body \ Barrel polished aluminum. Cage \ Anodized silver or ED black, beveled aluminum, cage flip. Axle \ Boron steel. Bearings \ Ball bearings. Size \ 107 x 75 mm. Weight \ 360 g/pr. Toe Clip \ Attachable. Reflector \ Optional. Option \ VP-349S steel cage, 440 g/pr. TW/CN

**VP-518S**

MTB / SPINNING

Body \ Ball burnished aluminum. Cage \ ED black steel w/double sided tread. Spindle \ Boron. Size \ 102.5 x 63 mm. Weight \ 458 g/pr. TW/CN

**VP-519A**

MTB

•Low Profile

Body \ Barrel polished aluminum. Cage \ Anodized silver or ED black aluminum. Axle \ Boron steel. Bearings \ Ball bearings. Size \ 102 x 63 mm. Weight \ 348 g/pr. Toe Clip \ Attachable. Reflector \ Optional. Option \ VP-519S steel cage, 420 g/pr. TW/CN

**VP-990A**

MTB

Body \ Black PP. Cage \ ED black aluminum, cage flip. Axle \ Boron steel. Bearings \ Ball bearings. Size \ 102 x 63 mm. Weight \ 300 g/pr. Toe Clip \ Attachable. Reflector \ Optional. Option \ VP-990S steel cage, 372 g/pr. TW/CN

**VP-992A**

MTB

Body \ Black PP. Cage \ ED black aluminum, dual-sided tread. Axle \ Boron steel. Bearings \ Ball bearings. Size \ 100 x 63 mm. Weight \ 307 g/pr. Toe Clip \ Attachable. Reflector \ Optional. Option \ VP-992S steel cage, 382 g/pr. TW/CN

**VP-332A**

ROAD

Body \ Hand polished aluminum. **Cage** \ ED black aluminum, cage flip. **Axle** \ Boron steel. **Bearings** \ Ball bearings. **Size** \ 98 x 64mm. **Weight** \ 348 g/pr. **Toe Clip** \ Attachable. **Reflector** \ Optional. **Option** \ **VP-383** P/P body, 354 g/pr. TW

**VP-396**

ROAD

Body \ Barrel polished aluminum. **Cage** \ Anodized silver aluminum, cage flip. **Axle** \ Boron steel. **Bearings** \ Ball bearings. **Size** \ 86 x 90 mm. **Weight** \ 330 g/pr. **Toe Clip** \ Attachable. **Reflector** \ Optional. **Option** \ **VP-396T** assembled black nylon toe-clips VP-709 & strap VP-702N. TW

**VP-397**

ROAD

Body \ Black nylon. **Cage** \ Anodized silver aluminum, cage flip. **Axle** \ Boron steel. **Bearings** \ Ball bearings. **Size** \ 85 x 63 mm. **Weight** \ 265 g/pr. **Toe Clip** \ Attachable. **Reflector** \ Optional. **Option** \ **VP-397T** assembled black nylon toe-clips VP-709 & strap VP-702N. TW

**VP-398T**

ROAD

•Integrated road pedal & toe-clip.

Body \ Hand polished aluminum. **Axle** \ CNC machined Cr-Mo. **Bearings** \ Ball bearings. **Size** \ 140 x 90 mm. **Weight** \ 420 g/pr inc toe clips & straps. **Toe clip** \ Nylon VP-710 & strap VP-702N. **Reflector** \ VP-R3 gray. TW

**VP-399T**

ROAD

•Integrated road pedal & toe-clip.

Body \ One-piece PP. **Axle** \ Boron steel. **Bearings** \ Ball bearings. **Size** \ 140 x 95 mm. **Weight** \ 376 g/pr inc toe clips & straps. **Toe clip** \ Nylon VP-710 & strap VP-702N. **Reflector** \ VP-R3 black. TW

**VP-181** SPORT / FITNESS / TREKKING / COMMUTER

•Lightweight contemporary design.

Body \ Hand Polished aluminum. **Cage** \ ED black aluminum. **Axle** \ CNC Machined Cr-Mo. **Bearings** \ LSL and sealed bearing. **Size** \ 101.5 x 64.5 mm. **Weight** \ 350 g/pr. **Reflector** \ Optional. TW



VP-569

BMX ELITE

- Aggressive gripping surface / replaceable pins.

Body \ Die cast aluminum w/knurling & grip nodes. Axle \ Cr-Mo. Bearings \ Ball bearings. Size \ 105 x 100 mm. Weight \ 570 g/pr. Reflector \ Optional. TW



VP-55

BMX ELITE

- Extruded/CNC machined •LSL bearings
- Replaceable grip pins.

Body \ Extruded/CNC machined aluminum, replaceable grip Pins. Axle \ CNC Machined Cr-Mo. Bearings \ LSL & Sealed. Size \ 110 x 110 mm. Weight \ 480 g/pr. Reflector \ Optional. TW



VP-56

BMX ELITE

- Extruded/CNC machined •LSL bearings
- Replaceable grip pins.

Body \ Extruded/CNC machined aluminum, replaceable grip Pins. Axle \ CNC Machined Cr-Mo. Bearings \ LSL & Sealed. Size \ 111 x 107 mm. Weight \ 580 g/pr. Reflector \ Optional. Option \ VP-56E (ball bearings) 540 g/pr. TW



VP-511

BMX

Body \ Barrel polished aluminum, w/grip nodes. Axle \ Boron steel. Bearings \ Ball bearings. Size \ 110 x 110 mm. Weight \ 560 g/pr. Reflector \ Optional. TW/CN



VP-558

BMX

Body \ Barrel polished aluminum, w/grip nodes. Axle \ Cr-Mo. Bearings \ Ball bearings. Size \ 110 x 110 mm. Weight \ 570 g/pr. Reflector \ Optional. Option \ VP-559 w/replacable screw-in pins. TW/CN



VP-559

BMX

- Replaceable grip pins.

Body \ Barrel polished aluminum, replaceable grip pins. Axle \ Cr-Mo. Bearings \ Ball bearings. Size \ 110 x 110 mm. Weight \ 580 g/pr. Reflector \ Optional. TW/CN



VP-560

BMX

Body \ One-piece black PP, w/grip nodes. Axle \ Boron steel. Bearings \ Ball bearings. Size \ 112 x 98 mm. Weight \ 348 g/pr. Reflector \ Included. TW/CN



VP-561

BMX

•Large platform w/grip nodes.

Body \ One-piece black PP, w/grip nodes. Axle \ Boron steel. Bearings \ Ball bearings. Size \ 111 x 96 mm. Weight \ 400 g/pr. Reflector \ Included. TW



VP-563

BMX

•Large platform w/grip nodes.

Body \ One-piece black PP, w/grip nodes. Axle \ Boron steel. Bearings \ Ball bearings. Size \ 110 x 110 mm. Weight \ 334 g/pr. Reflector \ Included. CN



VP-565

BMX

Body \ Barrel polished aluminum, w/grip nodes. Axle \ Boron steel. Bearings \ Ball bearings. Size \ 111 x 106 mm. Weight \ 510 g/pr. Reflector \ Optional. Option \ VP-566 (replaceable screw-in pins) 520 g/pr. TW/CN



VP-570

BMX JUNIOR

•Smaller platform for 16" bike.

Body \ One-piece black PP, w/grip nodes. Axle \ Boron steel. Bearings \ Ball bearings. Size \ 102 x 97 mm. Weight \ 320 g/pr. Reflector \ Included. TW/CN



VP-505

BMX JUNIOR

•Smaller platform for 16" bike.

Body \ Barrel polished aluminum, w/grip nodes. Axle \ Boron steel. Bearings \ Ball bearings. Size \ 102 x 93 mm. Weight \ 420 g/pr. Reflector \ Optional. TW



VP-568

BMX

•Aggressive gripping surface.

Body \ Die cast aluminum w/knurling & grip nodes. Axle \ Cr-Mo. Bearings \ Ball bearings. Size \ 105 x 100 mm. Weight \ 570 g/pr. Reflector \ Optional. TW



VP-580

BMX JUNIOR

•Smaller platform for 14"/16" bikes.

Body \ One-piece black PP, w/grip nodes. Axle \ Boron steel. Bearings \ Ball bearings. Size \ 92 x 80mm. Weight \ 290 g/pr. Reflector \ Included. VN



VP-585

BMX

Body \ One-piece black PP, w/grip nodes. Axle \ Boron steel. Bearings \ Ball bearings. Size \ 105 x 101 mm. Weight \ 336 g/pr. Reflector \ Included. CN



VP-747

BMX

•Sealed mechanism.

Body \ Barrel polished aluminum, w/grip nodes. Cage \ Anodized silver or ED black aluminum. Axle \ Boron steel. Bearings \ Ball bearings. Size \ 109 x 99 mm. Weight \ 416 g/pr. Reflector \ Optional. TW/CN



VP-610

CRUISER / COMFORT

•Unique retro styling •All-weather non-slip tread.

Body \ Barrel polished aluminum, inlaid gray TPE tread. Axle \ Boron steel. Bearings \ Ball bearings. Size \ 95 x 76 mm. Weight \ 460 g/pr. Reflector \ Included. TW/CN



VP-813

CRUISER / COMFORT

•Traditional styling.

Body \ CP steel, black PVC rubber blocks. Axle \ Boron steel. Bearings \ Ball bearings. Size \ 119 x 80 mm. Weight \ 620 g/pr. Reflector \ Included. TW

**VP-193**

TREKKING / COMFORT / CITY

•Lightweight, low profile, non-slip tpe.

Body \\ Hand polished aluminum Cage, P/P and TPE.
Cage \\ P/P and TPE. Axle \\ CNC Machined Cr-Mo.
Bearings \\ LSL and Sealed. Size \\ 98 x 72 mm. Weight
\\ 288 g/pr. Reflector \\ Built in. TW

**VP-618**

TREKKING / COMFORT / CITY

•Lightweight, non-slip tread.

Body \\ Barrel Polished one-piece aluminum, inlaid
TPE tread. Axle \\ Boron steel. Bearings \\ Ball
bearings. Size \\ 108 x 84.5 mm. Weight \\ 390 g/pr.
Reflector \\ Included. TW/CN

**VP-191**

TREKKING / COMFORT / CITY

•Lightweight •All-weather non-slip tread •LSL
bearings •Sealed mechanism.

Body \\ Barrel polished aluminum w/PP cage & inlaid TPE
tread. Axle \\ CNC Machined Cr-Mo. Bearings \\ LSL &
Sealed. Size \\ 96 x 72 mm. Weight \\ 290 g/pr. Reflector
\\ Included. TW

**VP-607**

COMFORT / CITY

•All-weather non-slip tread.

Body \\ Barrel polished aluminum, inlaid black TPE tread.
Axle \\ Boron steel. Bearings \\ Ball bearings. Size \\ 113
x 72 mm. Weight \\ 508 g/pr. Reflector \\ Included. TW/
CN

**VP-611**

TREKKING / COMFORT / CITY

•All-weather non-slip tread •Low profile barrel
polished aluminum. Body \\ Ball burnished aluminum
w/pp cage, inlaid TPE tread. Axle \\ Cr-Mo. Bearings \\
Ball bearings. Size \\ 97 x 70 mm. Weight \\ 290 g/pr.
Reflector \\ Included. TW



VP-302 COMFORT / CITY

Body \ One-piece black PP, w/grip nodes. Axle \ Boron steel. Bearings \ Ball bearings. Size \ 110 x 72 mm. Weight \ 346 g/pr. Reflector \ Included. TW/CN



VP-308 COMFORT

Body \ One-piece black PP, w/grip nodes. Axle \ Boron steel. Bearings \ Ball bearings. Size \ 111 x 74 mm. Weight \ 344 g/pr. Reflector \ Included. VN



VP-309 COMFORT

Body \ One-piece black PP, grip nodes. Axle \ Boron steel. Bearings \ Ball bearings. Size \ 110 x 72 mm. Weight \ 340 g/pr. Reflector \ Included. TW/CN



VP-313 COMFORT

•Traditional styling.
Body \ One-piece black PP. Axle \ Boron steel. Bearings \ Ball bearings. Size \ 112 x 75 mm. Weight \ 340 g/pr. Reflector \ Included. CN



VP-327 COMFORT

•Traditional styling
Body \ CP steel, black PVC tread blocks. Axle \ Boron steel. Bearings \ Ball bearings. Size \ 122 x 69 mm. Weight \ 510 g/pr. Reflector \ Included. CN



VP-808 COMFORT

•All-weather non-slip tread.
Body \ One-piece black or gray PP, inlaid TPE tread. Axle \ Boron steel. Bearings \ Ball bearings. Size \ 114 x 84 mm. Weight \ 410 g/pr. Reflector \ Included. CN



VP-608 TREKKING / COMFORT / CITY

•Non-slip TPE tread
Body \ Barrel polished one-piece aluminum, inlaid TPE tread. Axle \ Boron steel. Bearings \ Ball bearings. Size \ 108 x 69 mm. Weight \ 420 g/pr. Reflector \ Included. TW/CN



VP-819 TREKKING / COMFORT / CITY

•Non-slip tread.

Body \ One-piece PP, inlaid TPE tread. Axle \ Boron steel. Bearings \ Ball bearings. Size \ 106 x 84.5 mm. Weight \ 290 g/pr. Reflector \ Included. TW/CN



VP-818 TREKKING / COMFORT / CITY

•Super lightweight •All-weather non-slip TPE tread. Body \ One-piece PP, inlaid TPE tread. Axle \ Boron steel. Bearings \ Ball bearings. Size \ 106 x 70 mm. Weight \ 290 g/pr. Reflector \ Included. TW/CN



VP-809 COMFORT

•All-weather non-slip tread. Body \ One-piece black or gray PP, inlaid TPE tread. Axle \ Boron steel. Bearings \ Ball bearings. Size \ 111 x 74 mm. Weight \ 384 g/pr. Reflector \ Included. Option \ VP-809B (w/o bearing, steel axle 310 g/pr CN only). TW/CN



VP-810 COMFORT

•All-weather non-slip tread. Body \ One-piece black or gray PP, inlaid TPE tread. Axle \ Boron steel. Bearings \ Ball bearings. Size \ 109 x 72 mm. Weight \ 392 g/pr. Reflector \ Included. TW/CN



VP-816 COMFORT

•All-weather non-slip tread. Body \ One-piece black or gray PP, inlaid TPE tread. Axle \ Boron steel. Bearings \ Ball bearings. Size \ 111 x 89 mm. Weight \ 420 g/pr. Reflector \ Included. TW/CN



VP-817 COMFORT

•All-weather non-slip tread. Body \ One-piece black PP, inlaid TPE tread. Axle \ Boron steel. Bearings \ Ball bearings. Size \ 112 x 82 mm. Weight \ 370 g/pr. Reflector \ Included. TW/CN

**VP-872****COMFORT**

Body \ One-piece black PP, grip nodes. **Axle** \ Boron steel. **Bearings** \ Ball bearings. **Size** \ 108 x 86 mm. **Weight** \ 309 g/pr. **Reflector** \ Included. **Option** \ **VP-872N** (toe-clip not attachable) 322 g/pr. **VP-872B** (w/o bearings; steel axle) 282 g/pr. TW/CN

**VP-877****COMFORT**

Body \ Rigid, one-piece black PP, grip nodes. **Axle** \ Boron steel. **Bearings** \ Ball bearings. **Size** \ 110 x 79 mm. **Weight** \ 360 g/pr. **Reflector** \ Included. **Option** \ **VP-877B** (w/o bearings; steel axle 320 g/pr CN only). TW/CN

**VP-882****COMFORT**

Body \ Angled, low-profile, one-piece black PP. **Axle** \ Boron steel. **Bearings** \ Ball bearings. **Size** \ 102 x 77 mm. **Weight** \ 340 g/pr. **Reflector** \ Included. **Option** \ **VP-882N** (toe-clip not attachable VN only). TW/CN

**VP-892****COMFORT**

•Sealed mechanism. **Body** \ One-piece black PP, cage flip. **Axle** \ Boron steel, hex axle head. **Bearings** \ Ball bearings. **Size** \ 113 x 81 mm. **Weight** \ 268 g/pr. **Reflector** \ Included. **Option** \ **VP-892N** (toe-clip not attachable 280 g/pr CN only). TW/CN

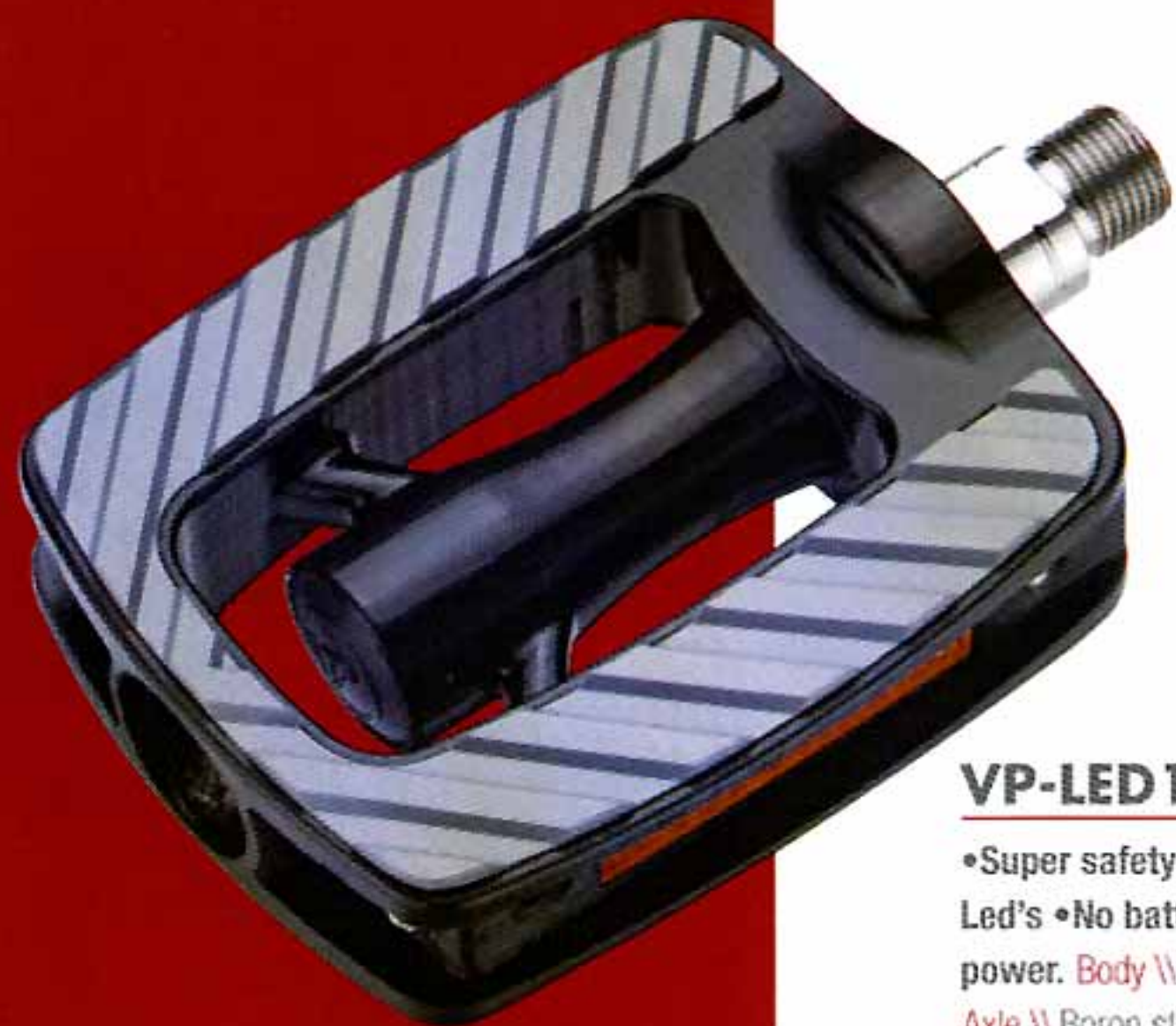
**VP-LED1****COMFORT / CITY**

•Super safety front, rear and side flashing Led's •No batteries •Self generating power. **Body** \ one-piece PP, inlaid TPE tread. **Axle** \ Boron steel. **Bearings** \ Ball bearings. **Size** \ 98 x 82 mm. **Weight** \ 446 g/pr. **Reflector** \ Included. TW

**VP-893****COMFORT**

•Sealed mechanism. **Body** \ One-piece black PP, cage flip. **Axle** \ Boron steel, hex axle head. **Bearings** \ Ball bearings. **Size** \ 113 x 81 mm. **Weight** \ 295 g/pr. **Reflector** \ Included. **Option** \ **VP-893N** (toe-clip not attachable) 286 g/pr. TW/CN

**VP-896****COMFORT**

•Reinforced for strength & rigidity **Body** \ One-piece black PP, cage flip. **Axle** \ Boron steel. **Bearings** \ Ball bearings. **Size** \ 112 x 78 mm. **Weight** \ 335 g/pr. **Reflector** \ Included. **Option** \ **VP-896N** (toe-clip not attachable) 386 g/pr. **VP-896B** (w/o bearings; steel axle) 298 g/pr. TW/CN

**VP-115****FOLDING**

•Compact folded size •Double sided 2 way folding.
 Body \\\ Fiberglass reinforced nylon. Axle \\\ Boron steel.
 Bearings \\\ Ball bearings. Size \\\ 107 x 69.5 mm (49
 x 69.5 mm folded). Weight \\\ 424 g/pr. Reflector \\\
 Included. TW/CN.

**VP-F50****FOLDING**

•Compact folded size.
 Body \\\ Glass reinforced nylon. Cage \\\ Nylon. Axle \\\
 Boron steel. Bearings \\\ Ball. Size \\\ 108.4 x 70 mm (50
 x 70 folded). Weight \\\ 396 g/pr. Reflector \\\ Included.
 TW/CN

**VP-ARC1**

•9° float.

Compatible with \\\ VP-R70, VP-R80 and LOOK pedals.

VP-BLK1

•Fixed Mode

Compatible with \\\ VP-R70, VP-R80 and LOOK pedals.

VP-C01

•Single release.

Compatible with \\\ VP-M11, VP-M31, VP-R61, VP-X82, VP-X83, VP-X92, VP-X93,
 VP-D73, VP-D74, VP-D68, VP-103, VP-104, VP-106, VP-109, VP-120AQ, VP-131,
 VP-920AQ, VP-162

VP-R2

Black for VP-R50, VP-R52, VP-R70, VP-R80, E-7, E-12, Gray for VP-162, VP-R60,
 VP-R61

VP-R3

Gray for VP-398T, black for VP-399T

**VP-117A****FOLDING**

•Mono-directional folding •Two-sided pedal •Cold-
 forged mechanism. Body \\\ Cold-forged anodized silver
 aluminum. Cage \\\ ED black aluminum. Axle \\\ Boron
 steel. Bearings \\\ Ball bearings. Size \\\ 103 x 75 mm (39
 x 75 mm folded). Weight \\\ 460 g/pr. Reflector \\\ Included.
 Option \\\ VP-117S steel cage, 520 g/pr. TW



VP-S1

TRIPLE FUNCTION FITNESS

- Dual compatibility for both Look and VP-C01 cleats
- Tough strong oversize axle •Servicable.

Body \ Coated aluminum body. **Axle** \ Oversize 8 mm CNC Machined Cr-Mo. **Bearings** \ Oversize 5/32" ball bearings. **Binding** \ FRP & Single sided adjustable tension. **Size** \ 85 x 91 mm. **Weight** \ 480 g/pr. **Option** \ VP-CA1T Cleat adapter. **VP-S1P** Ball burnished aluminum.



±15° Transverse tilt

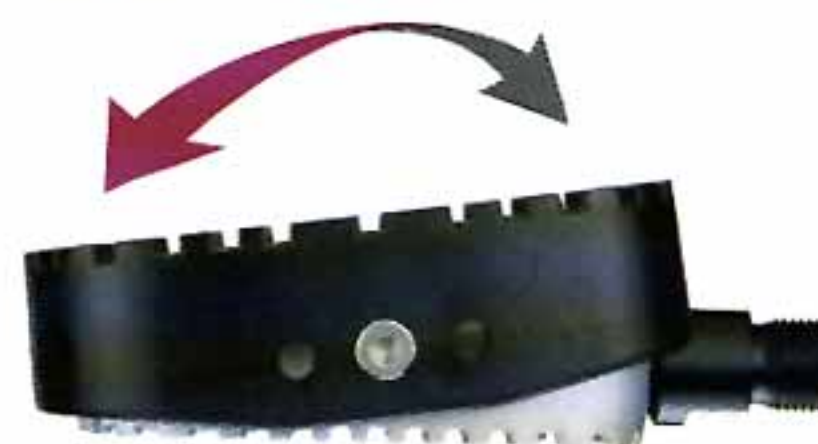

FX-001

FITNESS

- Unique flexped for sports training, rehabilitation. Calorie burning.

Body \ Coated one-piece aluminum. **Flexped platform** \ Fiberglass reinforced thermoplastic. **Axle** \ CNC Machined Cr-Mo. **Bearings** \ LSL & sealed. **Size** \ 106 x 76 mm. **Weight** \ 552g. TW



VP-518ST

MTB / SPINNING

- Dual cage grip profiles.

Body \ Barrel polished aluminum. **Cage** \ ED black steel. **Toe Clip** \ VP-792 & Strap VP-702N. **Axle** \ Boron steel. **Bearings** \ Ball bearings. **Size** \ 102 x 63 mm. **Weight** \ 458 g/pr. **Reflector** \ Optional. TW

**VP-408**

EXERCISE

•Self-righting •Adjustable foot strap.

Body \\ One-piece black PVC. Axle \\ Boron steel.

Bearings \\ Ball bearings. Size \\ 110 x 70 mm. Weight \\ 648 g/pr. CN

**VP-420**

EXERCISE

•Large platform •Self-righting •Two-side adjustable foot strap.

Body \\ Wide one-piece black PP. Axle \\ Boron steel.

Bearings \\ Ball bearings. Size \\ 156 x 119 mm. Weight \\ 928 g/pr. TW/CN

**VP-430**

EXERCISE

•Large Platform •Self-righting •Adjustable foot strap.

Body \\ Wide one-piece black PP. Axle \\ Boron steel.

Bearings \\ Ball bearings. Size \\ 116 x 128 mm. Weight \\ 860 g/pr. CN

**VP-450**

EXERCISE

•Large Platform •Self-righting •Two-side adjustable foot strap.

Body \\ Wide one-piece black PP. Axle \\ Boron steel.

Bearings \\ Ball bearings. Size \\ 120 x 130 mm. Weight \\ 874 g/pr. CN

**VP-455**

EXERCISE

•Large Platform •Self-righting •Adjustable foot strap.

Body \\ Wide one-piece black PP. Axle \\ Boron steel.

Bearings \\ Ball bearings. Size \\ 140 x 135 mm. Weight \\ 880 g/pr. CN

**VP-S2**

DUAL FUNCTION FITNESS

•Tough durable oversize axle and bearings.

Body \\ Barrel Polished one-piece aluminum. Cage \\ ED black aluminum. Axle \\ Oversize CNC Machined Cr-Mo.

Bearings \\ Oversize ball bearings. Binding \\ Single sided adjustable. Size \\ 153 x 100 mm. Weight \\ 534 g/pr. Toe clip \\ Attachable. Reflector \\ Attachable. TW



VP-213

CHILDREN'S

Body \ One-piece black PP. **Axle** \ Boron steel. **Bearings** \ Ball bearings. **Size** \ 90 x 65 mm. **Weight** \ 280 g/pr. **Reflector** \ Included. **Option** \ **VP-213B** (w/o bearings CN only); TW/CN



VP-209B

CHILDREN'S

•Without Bearings.
Body \ One-piece black PP. **Axle** \ Steel, hex axle head. **Bearings** \ Without bearings. **Size** \ 95 x 62 mm. **Weight** \ 214 g/pr. **Reflector** \ Included. TW/CN



VP-210

CHILDREN'S

Body \ One-piece black PP. **Axle** \ Boron steel. **Bearings** \ Ball bearings. **Size** \ 94 x 63 mm. **Weight** \ 308 g/pr. **Reflector** \ Included. **Option** \ **VP-210B** (w/o bearings; steel axle 268 g/pr). CN



VP-220

CHILDREN'S

Body \ One-piece black or gray PP, inlaid TPE tread. **Axle** \ Boron steel. **Bearings** \ Ball bearings. **Size** \ 91 x 61 mm. **Weight** \ 331 g/pr. **Reflector** \ Included. **Option** \ **VP-220B** (w/o bearings; steel axle 292 g/pr CN only). **VP-221** (one-piece black PP; 305 g/pr TW only). **VP-221B** (one-piece black PP; w/o bearings; 266 g/pr CN only). VN



VP-250B

CHILDREN'S

•Without bearings.
Body \ One-piece black PP. **Axle** \ Steel, hex axle head. **Bearings** \ Without bearings. **Size** \ 90 x 70 mm. **Weight** \ 224 g/pr. **Reflector** \ Included. **Option** \ **VP-270N** (for 20" bike; ball bearings 300 g/pr CN only). **VP-270B** (for 20" bike; w/o bearings; 280 g/pr CN only). TW/CN



VP-260

CHILDREN'S

Body \ One-piece black PP. **Axle** \ Boron steel, hex axle head. **Bearings** \ Ball bearings. **Size** \ 95 x 66 mm. **Weight** \ 246 g/pr. **Option** \ **VP-260N** (toe-clip not attachable 242 g/pr). TW/CN



VP-700 MTB / COMFORT TOE CLIP

•Recreational cycling toe clip.
Strapless design, Platform Tread, durable nylon. 62 g/pr.



VP-700F MTB / COMFORT TOE CLIP

•In-built reflector.
Strapless design, Platform Tread, durable nylon. 64 g/pr.



VP-706 ROAD TOE CLIP

•Lightweight.
Durable nylon. Med/Lge. Med: 32 g/pr, Lge: 34 g/pr



VP-702N MTB / ROAD TOE STRAP

Flexible woven nylon, Chrome-plated fastener.
Med: 12 x 400 mm, **VP-702NL** lge: 12 x 450 mm.
47 g/pr.



VP-732 MTB TOE CLIP

•Large platform.
Durable nylon. Med/Lge. Med: 64 g/pr, Lge: 76 g/pr



VP-742 ROAD TOE CLIP

Durable Nylon. Lge. 66 g/pr



VP-786 MTB TOE CLIP

•In-built reflector •Left & right foot ergo design
•Minimalist, lightweight design.
Durable nylon. Med/Lge. Med: 64 g/pr, Lge: 70 g/pr



VP-704W MTB / ROAD TOE STRAP

Soft flexible woven nylon, Chrome-plated fastener.
Med: 12 x 400 mm, **VP-704WL** lge: 12 x 450 mm.
52 g/pr.



VP-792 MTB TOE CLIP

•Three sizes.
Durable nylon. Sm/Med/Lge.
Sm: 54 g/pr Med: 56 g/pr. Lge: 58 g/pr



VP-796 MTB TOE CLIP

•In-built reflector.
Durable nylon. Med/Lge. Med: 62 g/pr, Lge: 64 g/pr.



VP-50 SHOE PROTECTOR

•Prevents strap buckle chaffing shoe.
Black or gray TPE. 4 g/pr

The drawings show general specifications and are a guide only. The drawings should not be used for detailed frame specifications.

Types covered are:
1.5 standard
Slimstak
Stepstak
Semi-integrated
integrated

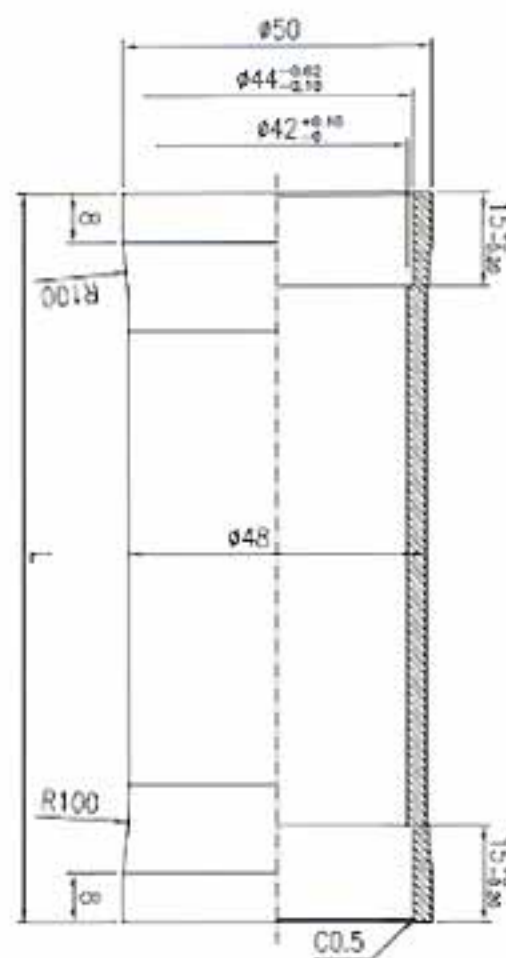

SEMI-INTEGRATED ALLOY HEAD TUBE FOR DOWNHILL
1 1/8" STEERER.
CANE CREEK®
US PAT#509S770
VP-A49F

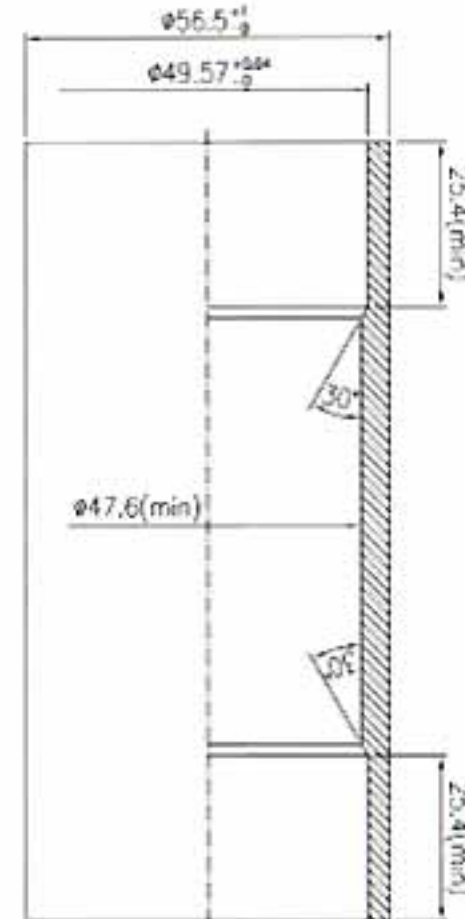

1.5 STANDARD ALLOY HEAD TUBE FOR MTB FREERIDE / DOWNHILL
1.5 and 1 1/8" STEERER
CANE CREEK®
US PAT#509S770
VP-A93C
VP-A93CS



SLIMSTAK ALLOY HEAD TUBE FOR MTB/ROAD
1 1/8" STEERER
CANE CREEK®
US PAT#509S770
VP-A77C
VP-A77CK
VP-A79
VP-A56AC
VP-A56ACK
VP-A57A
MH-504
MH-505C

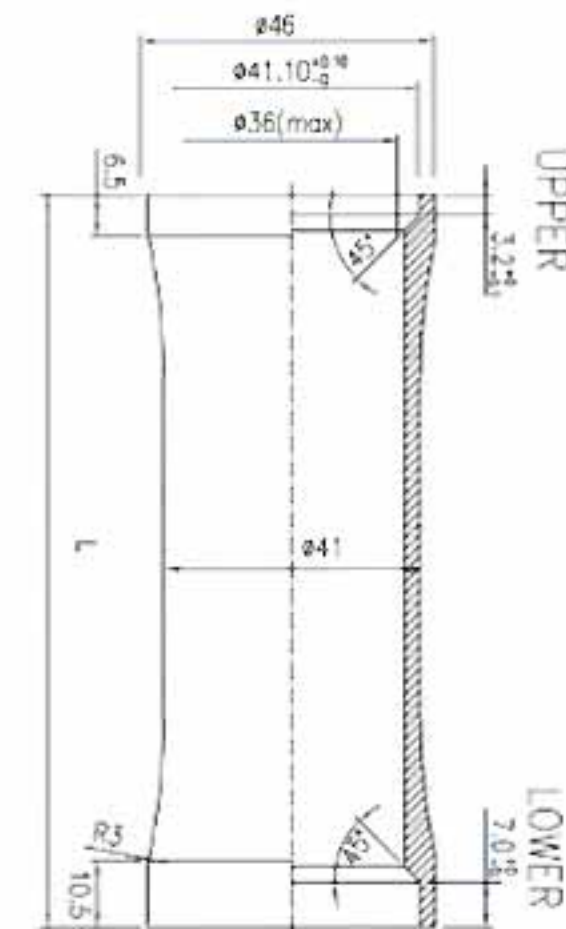

INTEGRATED ALLOY HEAD TUBE FOR ROAD
1" and 1 1/8" STEERER
CANE CREEK®
US PAT#509S770
VP-A46RCK
VP-A46ACK
VP-A06ACK
VP-A61ACK

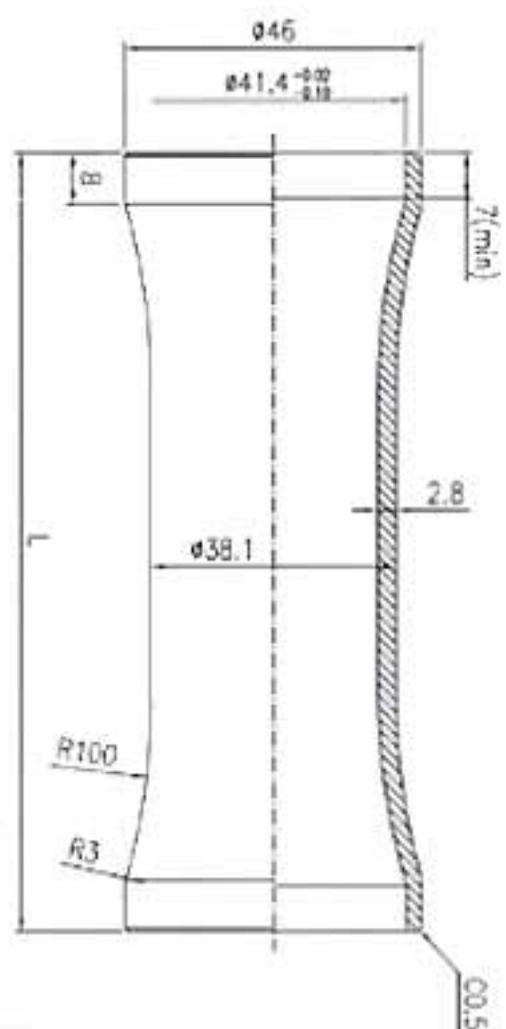

SEMI-INTEGRATED ALLOY HEAD TUBE FOR ROAD/MTB
1" and 1 1/8" STEERER
CANE CREEK®
US PAT#509S770
VP-A01ACG
VP-A01E
VP-A02AC
VP-A03RC
VP-A05AC
MH-003C
MH-004C

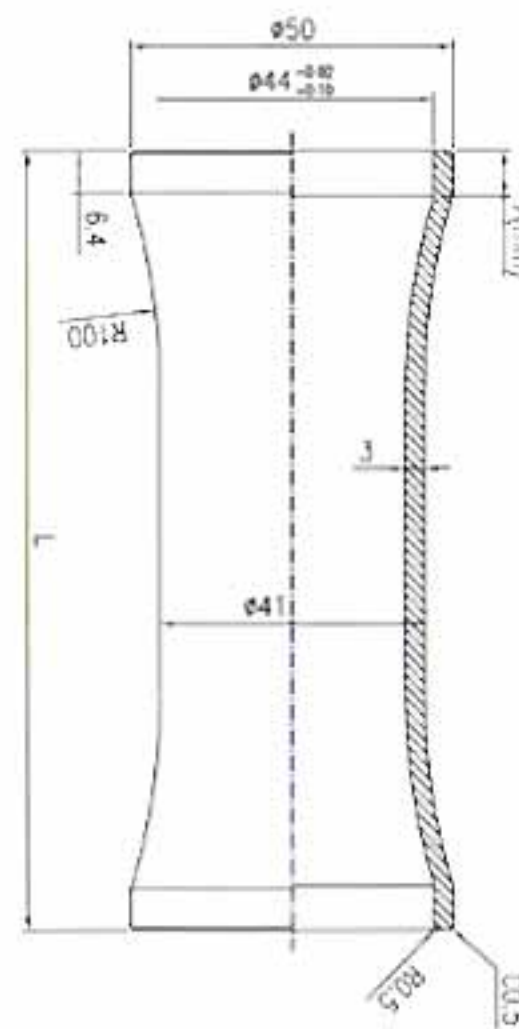

SEMI-INTEGRATED ALLOY HEAD TUBE FOR MTB
1 1/8" STEERER
CANE CREEK®
US PAT#509S770
VP-A41AC
VP-A42E
VP-A45AC
VP-A48A
VP-A48E
VP-A50AC
MH-305C
MH-306AC
MH-307AC
MH-308E
MH-309A

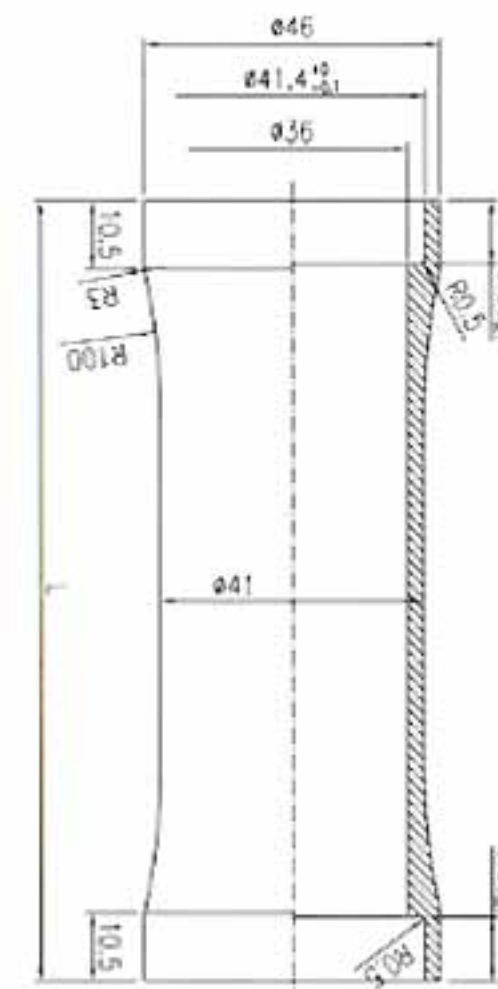

STEPSTAK ALLOY HEAD TUBE FOR ROAD
1" and 1 1/8" STEERER
CANE CREEK®
US PAT#509S770
VP-A07AC
VP-A08AC
VP-A09RC

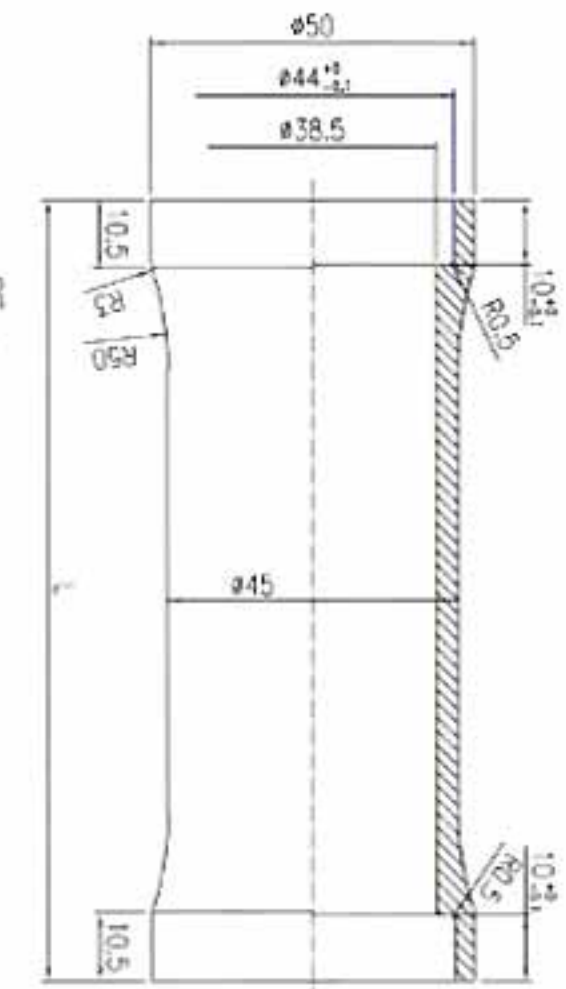

STEPSTAK ALLOY HEAD TUBE FOR MTB
1 1/8" STEERER
CANE CREEK®
US PAT#509S770
VP-A47AC



VP-A01ACG

SEMI-INTEGRATED, THREADLESS ROAD

•Semi-cartridge bearings.

Size \backslash 1-1/8". Material \backslash Aluminum. Finish \backslash Anodized silver or black. Diameter \backslash 28.6/41.4/30. Stack height \backslash 7+2.5=9.5. Bearings \backslash Semi cartridge (MH-P02). Set \backslash 5 pc. Weight \backslash 76g. Option \backslash VP-A02AC 25.4/41.4/27 or 1" / 26.4, 80 g. MH-S74A (spacer option). TW



VP-A05AC

SEMI-INTEGRATED, THREADLESS ROAD

•Aluminum conical cover w/integrated seal •Aluminum crown race w/seal. Size \backslash 1-1/8". Material \backslash Aluminum cover, steel cup. Finish \backslash Anodized Black or silver. Diameter \backslash 28.6/41.4/30. Stack height \backslash 18.2+4.9=23.1. Bearings \backslash Sealed cartridge (MH-P04). Set \backslash 7 PC. Weight \backslash 73 g. Option \backslash VP-A01E (Caged bearing). TW

STEP STAK



VP-A07AC

INTEGRATED, THREADLESS ROAD

•Easy drop-in assembly •Low stack height •Sealed cartridge bearing. Size \backslash 1-1/8". Material \backslash Aluminum. Finish \backslash Anodized silver or black. Diameter \backslash 28.6/41/30. Stack height \backslash 6.3+0.6=6.9. Bearings \backslash Sealed cartridge (MH-P03). Set \backslash 7 pc. Weight \backslash 73 g. Option \backslash VP-A09RC carbon cover. TW



VP-A61ACK

INTEGRATED, THREADLESS ROAD

•Semi-cartridge bearings.

Size \backslash 1 1/8. Material \backslash Aluminum cover. Finish \backslash Anodized Black or silver. Diameter \backslash 28.6/41/30. Stack height \backslash 11.25+0.65=11.9. Bearings \backslash Semi-cartridge (MH-P03M). Set \backslash 5 pc. Weight \backslash 58 g. Option \backslash VP-A61ACM 28.6/41.8/30 equivalent to Campagnolo spec. TW



VP-A41AC

SEMI-INTEGRATED, THREADLESS MTB

•Semi-cartridge bearings.

Size \backslash 1-1/8". Material \backslash Aluminum. Finish \backslash Anodized silver or black. Diameter \backslash 28.6/44/30. Stack height \backslash 5.5+3=8.5. Bearings \backslash Semi-cartridge (MH-P12: 5/32" x 22A). Set \backslash 5 pc. Option \backslash MH-S73A (spacer option) 117 g. VP-A42E caged bearing (5/32" x 20A). TW/CN.



VP-A45AC

SEMI-INTEGRATED, THREADLESS MTB

•Sealed cartridge bearings.

Size \backslash 1-1/8". Material \backslash Aluminum. Finish \backslash Anodized silver or black. Diameter \backslash 28.6/44/30. Stack height \backslash 7.3+2.0=9.3. Bearings \backslash Sealed cartridge (MH-P03: 41 x 6.5 x 45) Set \backslash 8pc. Weight \backslash 80 g. Option \backslash MH-S73LA spacer. TW



VP-A46ACK

INTEGRATED, THREADLESS ROAD

•Easy Drop-in assembly •Low stack height •Equivalent to Cane Creek spec.

Size \backslash 1-1/8". Material \backslash Aluminum cover. Finish \backslash Anodized Black or black. Diameter \backslash 28.6/41/30. Stack height \backslash 11.05+0.65=11.7. Bearings \backslash Sealed cartridge (MH-P03). Set \backslash 5 pc. Weight \backslash 58 g. Option \backslash VP-A06ACK: 1" 25.4/41/27 or 26.4, 60 g; VP-A46ACM: 1-1/8" 28.6/41/30 equivalent to Campagnolo spec; VP-A06ACM. 1" 25.4/41.8/27 or 26.4, equivalent to Campagnolo spec. TW



VP-A46RCK

INTEGRATED, THREADLESS ROAD

Size \backslash 1-1/8". Material \backslash Carbon fiber. Finish \backslash black. Diameter \backslash 28.6/41/30. Stack height \backslash 19.25+0.65=19.9. Bearings \backslash Sealed cartridge (MH-P03). Set \backslash 6 pc. Weight \backslash 64 g. Option \backslash VP-A46RCM 28.6/41.8/30 equivalent to Campagnolo. TW



VP-A48A

SEMI-INTEGRATED, THREADLESS ROAD

•Aluminum conical cover w/integrated steel •Steel crown race with seal.

Size \backslash 1-1/8". Material \backslash Aluminum. Finish \backslash Anodized silver or black. Diameter \backslash 28.6/44/30. Stack height \backslash 17.5+2.6=20.1. Bearings \backslash Caged bearing (1/8"x25B). Set \backslash 8 pc. Weight \backslash 98 g. Option \backslash VP-A48E (Caged bearing & steel cup, 129g). TW



VP-A50AC

SEMI-INTEGRATED, THREADLESS BMX

Size \backslash 1 1/8. Material \backslash Aluminum cover, steel cups. Finish \backslash Anodized black or silver. Diameter \backslash 28.6/44/30. Stack height \backslash 7.8+2.5=10.3. Bearings \backslash Sealed cartridge (MH-P08). Set \backslash 7 pc. Weight \backslash 110 g. TW



VP-A56ACK

THREADLESS MTB / ROAD

Size \ 1-1/8". Material \ Aluminum. Finish \ Anodized silver or black. Diameter \ 28.6/34/30. Stack height \ 27.7+11.5=39.2. Bearings \ Sealed cartridge (MH-P04). Set \ 6 pc. Weight \ 90 g. Option \ VP-A56AC Standard cover. TW



VP-A57A

THREADLESS MTB / ROAD

Size \ 1-1/8". Material \ Aluminum. Finish \ Anodized silver or black. Diameter \ 28.6/34/30. Stack height \ 31.7+12.7=44.4. Bearings \ caged bearings (5/32" x 22A). Set \ 9 pc. Weight \ 107 g. TW



VP-A15AC

THREADLESS ROAD

Size \ 1". Material \ Aluminum. Finish \ Anodized silver or black. Diameter \ 25.4/30/27. Stack height \ 26.7+14.5=41.2. Bearings \ Semi cartridge. Set \ 7 pc. Weight \ 102 g. Option \ VP-A16AC (25.4/30.2/26.4). TW



VP-A13A

THREADLESS ROAD

Size \ 1". Material \ Aluminum. Finish \ Anodized silver or black. Diameter \ 25.4/30/27. Stack height \ 14 + 11.5 = 25.5. Bearings \ Caged (5/32" x 16A). Set \ 9 pc. Weight \ 91 g. Option \ VP-A14A: 25.4/30.2/26.4 VP-A13AE steel upper cup, 93 g. TW/CN

Threadless headsets are manufactured under license from Cane Creek Cycling Components Pat # 5095770



SLIMSTAK

VP-A77CK

THREADLESS MTB / ROAD

•Semi-cartridge bearings •Conical top cover.

Size \ 1-1/8". Material \ Steel. Finish \ ED black or CP. Diameter \ 28.6/34/30. Stack height \ 26.1+10.2=36.3 w/15mm conical cover. Bearings \ Semi-cartridge (1/8" x 25B) Set \ 5 pc. Weight \ 110 g. Option \ VP-A79 Standard cover, caged bearing (1/8" x 25B), 11.4+10=21.4. 8 pc, 100 g. VP-A77C Standard cover. TW



VP-A31

THREADLESS MTB / COMFORT

Size \ 1". Material \ Steel. Finish \ ED black, CP or satin. Diameter \ 25.4/30/27. Stack height \ 11.5+1 = 22.5. Bearings \ Caged (5/32" x 16A). Set \ 9 pc. Weight \ 95 g. Option \ VP-A32: 25.4/30.2/26.4; VP-A33C Semi-cartridge 25.4/30/27; VP-A34C Semi-cartridge 25.4/30.2/26.4, 6pc, 101 g. TW/CN



VP-A49F

SEMI-INTEGRATED, THREADLESS JUMPING

Size \backslash 1 1/8". Material \backslash Cro-Mo cups, aluminum cover. Finish \backslash Anodized Black or silver. Diameter \backslash 28.6/44/30. Stack height \backslash 10.1+5.5=15.6. Bearings \backslash Caged, lower bearing 3/16 x 20 balls. Set \backslash 10 pc. Weight \backslash 130 g. TW



VP-A51A

THREADLESS MTB / ROAD

Size \backslash 1-1/8". Material \backslash Aluminum. Finish \backslash Anodized silver or black. Diameter \backslash 28.6/34/30. Stack height \backslash 14.8+12.4=27.2. Bearings \backslash Caged (5/32" x 22A). Set \backslash 8 pc. Weight \backslash 101 g. Option \backslash VP-A52ACG Semi-cartridge bearings, 15.4+11.8=27.2, 7 pc, 112 g. VP-A51AE Steel upper cup, 14+12.4=26.4, 104 g. VP-A51AS Steel upper/lower cups, 14+11=25, 108 g. TW/CN



VP-A53AC

THREADLESS MTB

Size \backslash 1 1/8". Material \backslash Aluminum. Finish \backslash Ano. Black or silver. Diameter \backslash 28.6/34/30. Stack height \backslash 16.7+13.8=30.5. Bearings \backslash Stainless sealed cartridge (MH-P03KS). Set \backslash 4 PC. Weight \backslash 95 g. TW

Threadless headsets are manufactured under license from Cane Creek Cycling Components Pat # 5095770



MONSTA VP-A75F

THREADLESS FREERIDE / BMX / JUMPING

•Heavy duty Cr-Mo lower cup (4mm) •Extended 12 mm cups for rotor •Super oversized 1/4" lower caged bearing •Threadless. Size \backslash 1-1/8". Material \backslash Cro-Mo, aluminum cover. Finish \backslash ED black or CP. Diameter \backslash 28.6/34/30. Stack height \backslash 17+13.5=30.5. Bearings \backslash Caged, lower bearing 1/4 x 15 balls. Set \backslash 10 pc. Weight \backslash 200 g. TW



VP-A71

THREADLESS MTB

Size \backslash 1-1/8"; Material \backslash Steel. Finish \backslash ED black or CP. Diameter \backslash 28.6/34/30. Stack height \backslash 12+11=23. Bearings \backslash Caged (5/32" x 20A) Set \backslash 9 pc. Weight \backslash 112 g. Option \backslash VP-A76CG Semi-cartridge 14.7+11=25.7, 5 pc, 139 g. TW/CN



VP-A74F

THREADLESS BMX FREESTYLE

•Heavy duty steel cups (2.8mm) •Extended cups for rotor. Size \backslash 1-1/8". Material \backslash Steel. Finish \backslash ED black, CP or satin. Diameter \backslash 28.6/34/30. Stack height \backslash 16.5+11.5=28. Bearings \backslash Caged (5/32" x 22A). Set \backslash 9 pc. Weight \backslash 130 g. Option \backslash VP-A73F (Economical version) 12.5+11.5=24. TW/CN



onepointfive
interface standard

VP-A93C

THREADLESS MTB FREERIDE / DOWNHILL

- 1.5 Interface standard
- Sealed cartridge bearings.

Size \ 1.5". Material \ Cr- Mo. Finish \ ED black or CP. Diameter \ 38.1/49.7/39.8. Stack height \ 17+14.1=31.1. Bearings \ Sealed cartridge (MH-P16: 52 x 7 x 45"). Set \ 7 pc. Option \ A93CS for 1-1/8" steerer. TW



MH-P31

THREADLESS BMX FREESTYLE / MTB DOWNHILL

- Heavy-duty Cr-Mo cups.

Material \ Cr-Mo. Finish \ ED black, CP or satin. Diameter \ 34/30. Weight \ 93 g. TW



SPACERS CARBON & ALLOY

STRAIGHT WALL SPACERS

Straight wall carbon spacers are available in heights: 3/5/10/15 mm

Straight wall alloy spacers are available in heights

2/3/4/5/6/7/8/9/10/12/15 mm

MH-S61A 1-1/8" aluminum (OD 34mm)

MH-S64R 1-1/8" carbon (OD 34mm)

MH-S41A 1" aluminum (OD 30mm)

MH-S44R 1" carbon (OD 30mm)



CONICAL TOP COVER

We now include a range of top covers that function as spacers.

Available in 15mm & 20mm heights the spacer completely replaces the top cover and gives a clean functional look.

CONICAL TOP COVER NO.	HEADSET MODEL NO.
MH-S73A	A41AC / A41ACM
MH-S73LA	A41ACG / A45AC / A41ACL
MH-S73SA	A42E
MH-S74A	A01ACG

DOUBLE STAR-NUT



M-1D

DOUBLE STAR-NUT Hollow brake cable tube



M-8D

CARBON



M-6R

SPRING / EXPANSION NUT



M-6S

SPRING / GROOVED EXPANSION NUT For carbon fork



M-6XL

MODEL	STEERER	STEERER ID	FIXING DEVICE	CAP	WEIGHT
M-1D	1-1/8" steel	25.4	double star-nut	cold-forged Al CNC machined	28g
M-1DS	1-1/8" AL	22.2	double star-nut	cold-forged Al CNC machined	26g
M-3D	1" steel	22.2	double star-nut	cold-forged Al CNC machined	22.2g
MD-1D	1-1/8" steel	25.4	double star-nut	die-cast Al	32g
MD-1DS	1-1/8" AL	22.2	double star-nut	die-cast Al	30g
MD-3D	1" steel	22.2	double star-nut	die-cast Al	28g
M-6	1-1/8" steel	25.4	spring/expansion nut	cold-forged Al CNC machined	50g
M-6S	1-1/8" steel	22.2	spring/expansion nut	cold-forged Al CNC machined	42g
M-7	1" steel	22.2	spring/expansion nut	cold-forged Al CNC machined	38g
MD-6	1-1/8" steel	25.4	spring/expansion nut	die-cast Al	50g
MD-6S	1-1/8" aluminum	22.2	spring/expansion nut	die-cast Al	42g
MD-7	1" steel	22.2	spring/expansion nut	die-cast Al	38g
M-8D[BMX]	1-1/8" steel	25.4	double star-nut	cold-forged Al CNC machined	44g
MD-8D[BMX]	1-1/8" steel	25.4	double star-nut	die-cast Al	44g
M-6XL	1-1/8" carbon	23.6	spring/grooved expansion nut	cold-forged Al CNC machined	42g
M-6XS	1-1/8" carbon	22.2	spring/grooved expansion nut	cold-forged Al CNC machined	35g
M-7XL	1" carbon	20	spring/grooved expansion nut	cold-forged Al CNC machined	32g
M-6R	1-1/8" Co-Mo	25.4	spring/expansion nut	carbon	39g
M-6RL	1-1/8" carbon	23.6	spring/grooved expansion nut	carbon	27g
M-6RS	1-1/8" carbon	22.2	spring/grooved expansion nut	carbon	24g
M-7R	1" Co-Mo	22.2	spring/grooved expansion nut	carbon	31g
M-7RL	1" carbon	20	spring/grooved expansion nut	carbon	21g
M-15	1.5"	34.8-35.6	double star-nut	cold-forged Al CNC machined	50g

All assorted colours except MD-1, MD-1DS, MD-3D, MD-6, MD-6S, MD-7, MD-8D (ED black or silver only) MD=die cast M=CNC machined D (after number) = double star nut



MH-309A

SEMI-INTEGRATED, THREADED MTB / COMFORT

Size \backslash 1-1/8" x 26 TPI. Material \backslash Aluminum. Finish \backslash Anodized. Diameter \backslash 25.4/44/30. Stack height \backslash 15.2+3=18.2. Bearings \backslash Caged. Set \backslash 10 pc. Weight \backslash 167 g. Option \backslash MH-307AC (Semi-cartridge bearing) TW



MH-201AC

THREADED ROAD

• Cartridge bearing • Water resistant • Sealed mechanism.

Size \backslash BC1" x 24 TPI. Material \backslash Aluminum. Finish \backslash Anodized. Diameter \backslash 22.2/30/27. Stack height \backslash 25.8+11.7=37.5. Bearings \backslash Semi-cartridge (1/8" x 34). Set \backslash 6 pc. Weight \backslash 110 g. Option \backslash MH-202AC 22.2/30.2/26.4. TW



MH-203C

THREADED COMFORT

• Double sealed mechanism.

Size \backslash 1" x 24 TPI. Material \backslash Steel. Finish \backslash ED black or CP. Diameter \backslash 22.2/30/27. Stack height \backslash 25.5+11=36.5. Bearings \backslash Semi-cartridge (1/8" x 34). Set \backslash 6 pc. Weight \backslash 150 g. Option \backslash MH-204C 22.2/30.2, 26.4. TW/CN



MH-501

THREADED MTB

• Water-resistant • Sealed mechanism.

Size \backslash BC1-1/8" x 26 TPI. Material \backslash Steel. Finish \backslash ED black or CP. Diameter \backslash 25.4/34/30. Stack height \backslash 23.5+10.5=34. Bearings \backslash Caged (5/32" x 20A). Set \backslash 9 pc. Weight \backslash 160 g. Option \backslash MH-503C Semi-cartridge bearing. TW/CN



MH-505C

THREADED, MTB / COMFORT

• Slimstak.

Size \backslash 1-1/8" x 26 TPI. Material \backslash Steel. Finish \backslash ED black or CP. Diameter \backslash 25.4/34/30. Stack height \backslash 24.2+10.2=34.4. Bearings \backslash Semi-cartridge (1/8" x 25B). Set \backslash 7 pc. Weight \backslash 136 g. Option \backslash MH-504 caged bearings (1/8" x 25B) 10 pc. TW



MH-306AC

SEMI-INTEGRATED, THREADED MTB / COMFORT

• Sealed mechanism • Semi-cartridge bearings.

Size \backslash 1-1/8" x 26 TPI. Material \backslash Aluminum. Finish \backslash Anodized silver or black. Diameter \backslash 25.4/44/30. Height \backslash 32+3=35. Bearings \backslash Semi-cartridge (MH-P12: 5/32" x 22A). Set \backslash 6 pc. Weight \backslash 145 g. TW/CN



MH-308E

SEMI-INTEGRATED, THREADED MTB / COMFORT

• Sealed mechanism • Caged bearings. Size \backslash BC1-1/8" x 26 TPI. Material \backslash Steel. Finish \backslash ED black or CP. Diameter \backslash 25.4/44/30. Stack height \backslash 15.2+3=18.2. Bearings \backslash Caged (5/32" x 22A). Set \backslash 9 pc. Weight \backslash 153 g. Option \backslash MH-003C Size: 1" 22.2/41.4/27 or 26.4. MH-305C semi-cartridge bearings (5/32" x 22A). TW/CN



VP-H732

THREADED COMFORT

•Threaded washer.

Size \ BC1" x 24 TPI. Material \ Steel. Finish \ ED black or CP. Diameter \ 22.2/30/27. Stack height \ 24.5+10.5=35. Bearings \ Caged (5/32" x 16). Set \ 8 pc. Weight \ 126 g. Option \ VP-H733 Key Washer. TW/CN



VP-H692W

THREADED COMFORT

•Water-resistant. Size \ BC1" x 24 TPI. Material \ Steel. Finish \ ED black or CP. Diameter \ 22.2/30/27. Stack height \ 23+10.5=33.5. Bearings \ Caged (5/32" x 16). Set \ 9 pc. Weight \ 136 g. Option \ VP-H692 25.5+10.5=36.TW/CN



VP-H693FW

THREADED COMFORT

Size \ BC1" x 24 TPI. Material \ Steel. Finish \ ED black or CP. Diameter \ 22.2/34/26.4. Stack height \ 24+9.5=33.5. Bearings \ Caged (5/32" x 16A). Set \ 8 pc. Weight \ 160 g. Option \ MH-693HW: 22.2/34/27. MH-903C Semi-cartridge bearing, 22.2/34/27 or 26.4, 25.5+11=36.5. CN



VP-H724

THREADED COMFORT

Size \ BC1" x 24 TPI. Material \ Steel. Finish \ ED black or CP. Diameter \ 22.2/30/27. Stack height \ 24+10.5=34.5. Bearings \ Caged (5/32" x 16). Set \ 8 pc. Weight \ 152 g. TW/CN



VP-H738F

THREADED BMX / FREESTYLE

Size \ BC1" x 24 TPI. Material \ Steel. Finish \ ED black or CP. Diameter \ 21.1/32.5/27. Stack height \ 25.5+10.5=36. Bearings \ Caged (3/16" x 15B). Set \ 8 pc. Weight \ 155 g. Option \ VP-H738FH 10 mm threaded washer. TW/CN



VP-H755

THREADED BMX / FREESTYLE

Size \ BC1" x 24 TPI. Material \ Steel. Finish \ ED black or CP. Diameter \ 21.1/32.5/27. Stack height \ 30+10.5=40.5. Bearings \ Caged (3/16" x 15A). Set \ 8 pc. Weight \ 170 g. TW/CN



MB-609

CI DRIVE

•Compatible with Tracer CI drive cranksets.

Axle \ SCM4130 Cr-Mo, L 108,113.2,118 mm.

Sizes \ BC1.37"x24T. Cups \ Forged steel. Weight \ 325 g. TW



MB-602

CARTRIDGE / MTB

•ISIS drive splined BB •sealed bearing with Cr-Mo axle •cold-forged alloy cups.

Thread \ BC1.37"x24T. Axle \ SCM 4130 hollow Cr-Mo.

Finish \ Anodized chromica aluminum sheath and cups.

Weight \ 225 g. Option \ MB-604 4 sealed bearings for downhill. TW



MB-603

CARTRIDGE / MTB

•ISIS drive splined BB •High-performance, quiet, smooth-turning •Sealed bearing •Cold-forged steel cups.

Thread \ BC1.37" x 24T. Axle \ hollow Cr-Mo. Finish \ Phosphated Sheath and cups. Weight \ 291 g. Option \ MB-603A Alloy anodized cup. TW



MB-604

CARTRIDGE DOWNHILL / SPINNING

•ISIS drive spline •4 sealed bearings with hollow Cr-Mo axle •Cold-forged alloy cups.

Thread \ BC1.37" x 24T. Axle \ SCM 4130 hollow Cr-Mo. Finish \ anodized gold sheath, anodized chromica cups. Weight \ 290g. TW



MB-606

CARTRIDGE / MTB / ROAD

•ISIS drive splined BB •Sealed bearings with hollow titanium axle •Cold-forged alloy cups.

Thread \ BC1.37" x 24T. Axle \ Titanium 6Al/4V.

Finish \ anodized aluminum sheath, anodized cups. Weight \ 165 g. TW



VP-BC55P

SEMI-CARTRIDGE

•Sealed mechanism with plastic sheath •Cold-forged steel cups. **Thread** \ BC1.37" x 24T. **Axle** \ boron steel. **Finish** \ phosphated cups. **Weight** \ 325g. **Option** \ VP-BC55PCI For chainguard mount plate 70+1.5mm, M36X24T. VP-BC55PE For front derailleur BB mount plate 68+3mm. VP-BC55PEI For front derailleur BB mount plate 70+3mm M36 x 24T. VP-BC55PC For chainguard mount plate 70+1.5mm. TW/CN/VN



VP-BC73

CARTRIDGE / MTB

•Sealed bearing w/aluminum sheath • Cold-forged steel cups. **Thread** \ BC1.37" x 24T. **Axle** \ boron steel. **Finish** \ phosphated cups, anodized sheath. **Weight** \ 280 g. **Options** \ VP-BC73C for chain guard stay mount plate. VP-BC73A cold forged aluminum cups. VP-BC73E for front derailleur BB mount plate. TW/CN



VP-BC75T

CARTRIDGE / MTB

•Aluminum sheath designed for internally wired frames • Sealed bearing •Cold-forged steel cups. **Thread** \ BC1.37" x 24T. **Axle** \ boron steel. **Finish** \ Barrel polished sheath, phosphated cups. **Weight** \ 290g. TW/CN



VP-BC80

CARTRIDGE MTB

•Double-sealed mechanism with durable SUJ2 steel sheath •High-performance, quiet, smooth-turning BB •Cold-forged steel cups. **Thread** \ BC1.37" x 24T. **Axle** \ Cr-Mo. **Finish** \ satin cups. **Weight** \ 340 g. **Options** \ VP-BC80E For derailleur BB mount plate. VP-BC80C For chainguard mount plate. TW



VP-BC82

CARTRIDGE / MTB

•High-performance, quiet, smooth-turning BB. **Thread** \ BC 1.37" x 24T. **Axle** \ Boron steel. **Finish** \ Phosphated Sheath and cups. **Weight** \ 300 g. **Option** \ VP-BC82PS Left side plastic cup, 245 g. TW



MB-608

EXTERNAL B/B

•Sealed external bearings. **Axle** \ SCM 4130 hollow Cr-Mo, L 127,135 mm. **Sizes** \ BC1.37"x24T. **Cups** \ Aluminum. **Weight** \ 230 g. TW

AXLES

Cold-forged and heat-treated for maximum strength and durability



Bracket Width	A	B	Axle Length
68	27.5	32	127.5
68	27	31	126
68	27	29.5	124.5
68	26.5	28	122.5
68	25	27	120
68	25	25	118
68	23.5	23.5	115
68	22	23	113
68	22	20.5	110.5
68	18.5	20.5	107

Model	Bracket Width	A	B	C	Axle Length
3EB	★			28	110.5
3CB	★	30.5		32	114.5
3HB	★			30.5	113
3JB	★			31	115
3LB	★			32	116
3AB	★			33.5	117.5
3PB	★	32	52	35	119
3NB	★			36	120
3SSB	★			37.5	121.5
3PLB	★			35	122
3SB	★			37.5	124.5
3TB	★	35		39	126
3UB	★			40.5	127.5
3RB	★			42	129
68B	★	30		33.5	117.5
5LB	★	32	54	30	116
5PB	★			35	121
68B	★	35		37.5	126.5
5TB	★	35		39	128
6UB	★			40.5	129.5
7NL	★			33.5	122.5
7N	★			35	124
7SB	★	32		36	125
7SS	★			37.5	126.5
7S	★	35	57	37.5	129.5
7T	★			39	131
7U	★			40.5	132.5
7R	★			42	134

Model	Bracket Width	A	B	C	Axle Length
3M	★	28		28	108
3K	★	29		29	110
3E	★			28	110.5
3H	★	30.5		30.5	113
3C	★			32	114.5
3L	★			32	116
3A	★			33.5	117.5
3P	★	32		35	119
3N	★			36	120
3SS	★			37.5	121.5
3Z	★	33.5	52	33.5	119
3PL	★			35	122
3S	★			37.5	124.5
3T	★	35		39	126
3U	★			40.5	127.5
3R	★			42	129
3V	★			44	131
3X	★	35.5		36.5	124
3NN	★	36		36	124
3RM	★	37.5		42	131.5
3RMC	★	40.5		42	134.5
5M	★	28		28	110
5B	★	30		33.5	117.5
5L	★			30	116
5A	★			33.5	119.5
5P	★	32		35	121
5N	★			36	122
5SS	★			37.5	123.5
5S	★			37.5	126.5
5T	★	35		39	128
5U	★			40.5	129.5
5R	★			42	131
5RM	★	37.5		42	133.5

Bottom Brackets

Cr-Mo \ chromium molybdenum steel

I \ Italian thread

Axles \ cold-forged & heat-treated

Axle Lengths \ made to order

Packaging

Headsets \ 100 sets per carton

Bottom Brackets \ 50 units per carton (axles),

100 sets per carton (components)

CAGED BEARINGS



Model	A/Left	B/Middle	C/Right	Length
3311	43	52	48	143
3313	43	52	46	141
3314	45	52	52	149
3315	43	52	51	146
3321	45	52	51	148
3322	50	52	50	152
3323	48	52	48	148
3330	41	52	48.5	141.5
3331	43	52	47	142
3358	33	52	41	125
3369	36.5	52	44.5	133
3526	43	54	48	145
3528	45	54	53	152
3513	37	54	44	135
3501	43	55	47	145
3503	41	55	45	141
3504	43	55	51	149
3512	36	55	44	135
3524	46	55	50	151

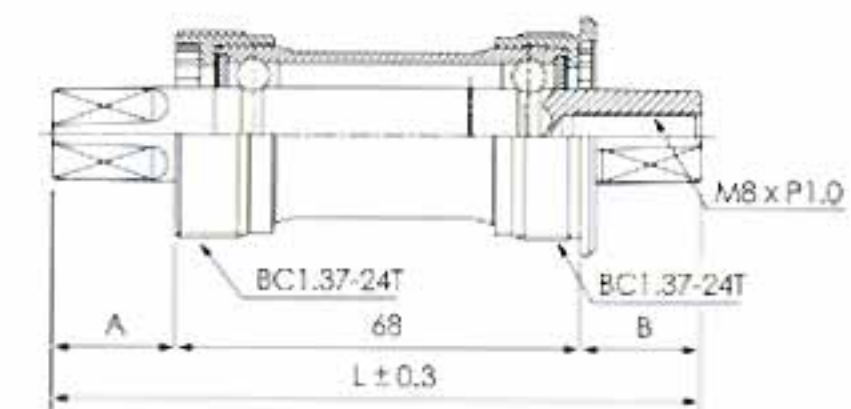

VP COMPONENTS

VP COMPONENTS CO., LTD.

816 Chang Sheng Rd, Waipu 438,
Taichung County, Taiwan
Tel: 04 2683 5001 Fax: 886 4 2683 5838
E-mail: sales@vpcomponents.com
www.vpcomponents.com

HUNG KUANG BICYCLE COMPONENTS (SHENZHEN) CO., LTD.

220, Renmin North Rd, 4th Industrial District,
Longhua Town, Shenzhen City, Guangdong, China
Tel: 755 2770 3845-7 Fax: 86 755 2770 2644
E-mail: szvphgco@public.szptt.net.cn

VP BICYCLE COMPONENTS (TAICANG) CO., LTD.

Liutai Road, Ludu Town, Taicang City, Jiangsu, China
Tel: 512 5345 9088 Fax: 86 512 5345 7792
E-mail: tchgco01@pub.sz.jsinfo.net

VP COMPONENTS (TIANJIN) CO., LTD.

108, Jinbao Highway, Shuangkou Development
Area, Beichen District, Tianjin, China.
Tel: 228 683 8988 Fax: 86 228 683 8898
E-mail: vpzpl@vpcomponents.com.cn

VP COMPONENTS (VIETNAM) CO., LTD.

104/2-1 Amata Road 2, Amata Modern
Industrial Park, Long Binh Ward, Bien Hoa City,
Dong Nai Province, Vietnam
Tel: 61 893 786 Fax: 84 61 893 488
E-mail: vpcomponents@hcm.vnn.vn