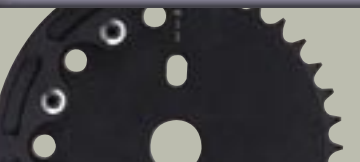

**GRINDER**

Super heavy duty with adjustable bash guard • Fits 22mm (7/8") spindle hole • Left hand drive compatible • Reducing shim included • Sizes: 36, 39, 44T

**GRINDER 104**

Super heavy duty with adjustable bash guard • Fits 104mm BCD cranks • Sizes: 38, 40, 42T

**FIVE HOLE**

CNC'd from 8mm thick 6061/T6 aluminum plate • Heavy duty design for dirt jumping • Fits 22mm (7/8") spindle hole • Reducing shim included • Sizes: 36, 39, 42, 43, 44, 45T • Black anodized finish

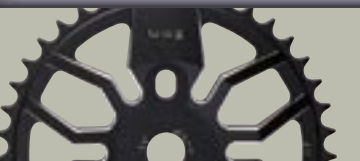
**STELLA**

CNC'd from 8mm thick 6061/T6 aluminum plate • Light, beautiful & built for speed • Fits 19mm (3/4") spindle hole • Sizes: 36, 39, 41, 42, 43, 44, 45T • Black anodized finish

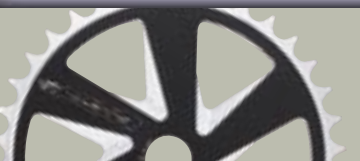
**SPOKE**

Modern styling • Always round and straight • CNC'd 19mm (3/4") spindle hole (not stamped) • 6061/T6 aluminum with CNC'd details • Sizes: 36, 39, 41, 42, 43, 44, 45T • Black anodized finish

**R-WAY**

CNC'd from 8mm thick 6061/T6 aluminum plate • Light, beautiful & built for speed • Fits 19mm (3/4") spindle hole • Sizes: 36, 39, 41, 42, 43, 44, 45T • Black anodized finish

**110MM BCD CHAINWHEEL**

7075/T6 aluminum plate • For 5 bolt, 110mm BCD spider • Chaining bolts recess on both sides • 5.5mm thickness • Sizes: 38-52T • Black anodized finish

**SPIDERS, BOLTS & TOOLS****BMX SPIDER**

110mm BCD • For 19mm (3/4") • 6061/T6 aluminum • Black anodized finish

**ALLOY CHAINRING BOLTS**

Forged and CNC'd 7075/T6 aluminum • Black or silver anodized finish • Includes Torx T-30 wrench

**BMX STAR NUT ASSEMBLY**

For 1-1/8" steerer • Alloy top cap • Hollow CroMo bolt • Gyro compatible • Black or silver anodized

**HUCKER**

The latest in 3D styling • Always round & straight • CNC'd 22mm center hole (not stamped) • 6061/T6 aluminum with CNC'd details • Sizes: 39, 42, 43, 44, 45T • Black anodized finish

**BOTTOM BRACKETS****PLATINUM BB**

All-Purpose – Strong and Stiff • Forged hollow CroMo spindle for ISIS Drive • Titanium Nitride coated spindle • Integrated large ball bearing design • Cold forged aluminum cups • Silver satin steel body with red printed logo • Composite anti-creak sleeve • New improved external water seals • Weight: 225 grams

**BB-522**

22mm (7/8") 48T hollow CroMo spindle • Oversized industrial sealed cartridge bearings • Alloy cups and spacer sleeve • Scallop aluminum bearing covers

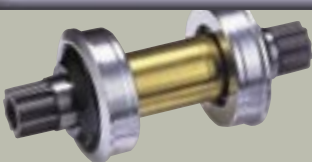
**BB-522 IS**

ISIS Drive hollow CroMo spindle • Oversized industrial sealed cartridge bearings • Alloy cups and spacer sleeve • Scallop aluminum bearing covers

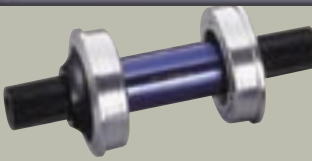
**BB-511**

19mm (3/4") 48T CroMo spindle • Oversized industrial sealed cartridge bearings • Alloy cups and spacer sleeve • Scallop aluminum bearing covers

**X-DRIVE EUROPEAN BB**

19mm (3/4") 48T CroMo spindle • Oversized industrial sealed cartridge bearings • Steel cups and alloy spacer sleeve • Scallop aluminum bearing covers

**TI SPINDLE**

100% CNC machined 6/4 titanium • 48T • Sizes: 19x140mm or 22x140mm

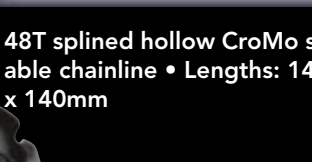
**EUROPRO BB**

48T splined hollow CroMo spindle • 4 sealed cartridge bearings • 2014 alloy cups • Adjustable chainline • Lengths: 140, 155mm • Available in 19mm x 48T x 140mm or 22mm x 48T x 140mm

**ORBIT MX**

Forged and CNC'd 6061/T6 aluminum cups • Patented alignment tip for increased durability and performance • TH brand 36° micro angular contact bearings • 7075 aluminum crown race • Black or silver anodized

**SKY PILOT PRO**

Forged and CNC'd 6061/T6 aluminum cups • Patented alignment tip for increased durability and performance • TH brand 36° micro angular contact bearing (upper) and precision tapered roller bearing with grease port (lower) • Forged CroMo crown race • Gyro compatible • Black anodized or bright silver finish

**SKY PILOT**

Forged CroMo lower cup, 6061/T6 upper cup • TH brand 36° micro angular contact bearing (upper) and precision tapered roller bearing with grease port (lower) • Forged CroMo crown race • Gyro compatible • Black anodized or bright silver finish

**THE PIG**

Forged CroMo 12mm deep cups • Super oversized 1/4" ball bearings (lower), Caged 5/32" ball bearings (upper) • CroMo crown race • Black anodized, bright silver anodized or red, yellow, or blue powdercoat finish

**THE PIG DH PRO**

Forged CroMo lower cup, 6061/T6 upper cup • TH brand 36° micro angular contact bearing (upper) and industrial cartridge bearing (lower) • Forged CroMo crown race • Gyro compatible • Laser etched aluminum top cap • Black anodized or bright silver finish

**THE PIG DH PRO - DEEP CUPS**

6061/T6 upper cup, forged CroMo lower cup • 22mm deep upper & lower cup insertion • Black or silver anodized finish • Laser etched alloy top cap • Sealed cartridge lower bearing • TH brand 36° micro angular contact upper bearing • CroMo crown race • Gyro compatible • Size: 1-1/8" • Stack height: 15x16=31mm • Weight: 176g

**STEMS AND SEATPOSTS****BLACK EYE DIRT JUMPING STEM**

Cold forged 6061/T6 aluminum for optimum grain alignment • 100% CNC'd finish • Fits ø1-1/8" steerers • 4-bolt ø22.2mm CNC'd AL2014 handlebar clamp • Cromoly M8 hardware • 30mm stack height • Length: 48mm • Blast black anodized with CNC'd silver detail • Weight: 299 grams (10.5 oz)

**OZZIE BMX RACING STEM**

Cold forged Al7050/T6 aluminum for optimum grain alignment • 100% CNC'd finish • Fits ø1-1/8" steerers • 4-bolt ø22mm CNC'd AL2014 handlebar clamp • Cromoly M6 hardware • Lengths: 45, 60mm • Blast black anodized with CNC'd silver detail • Weight: 162 grams (45mm), 184 grams (60mm)

**POWDER KEG**

CNC'd from solid billet • 6061/T6 aluminum • CroMo hardware • Fits ø22.2mm diameter bar • Size: 28.6 x 50mm • Black anodized

**SEAT POLE**

3-D forged and CNC'd AL2014 aluminum • Super durable 1-piece mast and head • Directionally butted shaft (thicker fore & aft) • Zero setback for maximum strength • Sizes: 300mm x 25.4 or 26.8mm • Blast black anodized • Weight: 215 grams

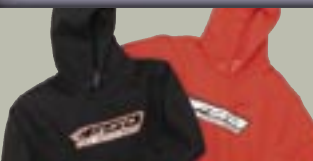

Threadless headsets manufactured under license from Cane Creek Cycling Components, Pat# 5095770

**SOFT GOODS****HOODIES**

Super heavyweight Fruit of the Loom™ • 90% Cotton • Black, Red • Sizes: M, L, XL, XXL

**T-SHIRTS**

100% Heavyweight cotton • FSA Logo shirt: Logo on front and back, navy blue • BMX Jump shirt: Logo on front and back, black • BMX Stripe: Logo on front, navy blue • All t-shirts in M, L, XL

**HATS & SOCKS**

Hats: 100% Cool Max™ material, preformed, mid-rise • Black • One size fits all

Socks: Made by DeFeet™ • Terry padded foot bottom for extra long riding sessions • Silver or white with red and black trim • Sizes: M, L, XL

**BMX JERSEY**

Made by Hot Shoppe • Padded elbows • Sizes: S, M, L, XL

For warranty and technical information about Full Speed Ahead products, please see our website: WWW.FULLSPEEDAHEAD.COM. All rider photography by Karl Buchanan except racing photo, by Gork.



FULL SPEED AHEAD  
12810 NE 178TH ST. #102  
WOODINVILLE, WA 98072

FULL SPEED AHEAD - EUROPE  
VIA DEI CHIOBI, 11  
20040 CAVENAGO BRIANZA, (MI) ITALY

**BMX CRANKSETS****CARBON PRO BMX**

Patented carbon composite crankarms • Octalink™ or ISIS Drive • 7075/T6 CNC'd 5-bolt spider • 110mm BCD • Bottom bracket and chainwheel not included • Lengths: 170, 175mm • Weight: 414 grams

**SMACK DADDY**

Designed for dirt jumping • Crankarms made using 38mm diameter SCM 4130 tubular CroMo • Fits 22mm (7/8") 48 tooth splined spindle • Left-hand drive compatible • Lengths: 175, 180mm • Black powdercoat finish • Weight: 1494 grams

**WILD CHILD**

Great size for racing or dirt jumping • Crankarms made using 38mm diameter SCM 4130 tubular CroMo • Fits 22mm (7/8") 48 tooth splined spindle • Left-hand drive compatible • Lengths: 175, 180mm • Black powdercoat finish • Weight: 1317 grams

**X-DRIVE**

Great size & weight for racing • Crankarms made using 35mm diameter SCM 4130 tubular CroMo • Fits 19mm (3/4") 48 tooth splined spindle • Left-hand drive compatible • Lengths: 175, 180mm • Black powdercoat finish • Weight: 1337 grams

**FLATLAND**

Great shape for flatland riding • Crankarms made using 35mm diameter SCM 4130 tubular CroMo • Fits 19mm (3/4") 48 tooth splined spindle • Left-hand drive compatible • Length: 160mm • Black powdercoat finish • Weight: 1262 grams

**NASTY BOY**

Great size and weight • Crankarms made using 35mm diameter SCM 4130 tubular CroMo • Fits 19mm (3/4") 48 tooth splined spindle • Lengths: 175, 180mm • Black powdercoat finish • Weight: 1337 grams

**NEWTRON**

Forged 6061/T6 alloy crankarms • 110mm BCD • Lengths: 160, 165, 170, 175, 180mm • Weight: 600-680 grams





1. JACK MERDOCK, TURN DOWN  
CANT C PRODUCT, REAL GOOD THIE  
2. TEST, OVER ICE, TIGHT SHOT  
3. JACK GOOD EVERYTHING  
4. DAN MONTGOMERY GOOD EVERYTHING  
5. DAN GOOD EVERY THING  
6. NICK HALSEY GOOD EVERYTHING  
7. NICK FOOT DAM TAIL WHIP ALL GOOD

