



For exploded diagram and part number information, refer to the Spare Parts Catalog available on our website at www.rockshox.com.

Contact your local distributor or visit the RockShox website at www.rockshox.com for ordering information.

Information contained in this publication is subject to change at anytime without prior notice.

For the latest technical information, visit our website at www.rockshox.com.

Names used in this manual may be trademarks or registered trademarks of others.

TOOLS NEEDED

- Safety Glasses
- 24mm 6-point Socket
- Plastic Faced Mallet
- Biodegradable Solvent
- RockShox 5 wt. Oil
- Shock Pump
- Football-style pump needle
- 5mm Hex Wrench
- 12" long, 1 1/4" diameter soft bristle bottle brush
- Long cylindrical rod
- Torque Wrench

After every 100 hours of riding, or less depending on riding conditions and riding style, the following service should be performed. This service should be performed by a qualified mechanic, using proper tools.

REMOVE SPRING STACK

HINT: RIGHT AND LEFT IS DETERMINED FROM THE RIDER'S PERSPECTIVE.

1. Remove the air cap from the left side of the fork (fig. 1A). Insert a lightly lubricated football-style pump needle into the air valve and remove the air from the Air Assist chamber

IMPORTANT: THE FOOTBALL NEEDLE MUST BE LUBRICATED BEFORE INSERTION INTO THE RUBBER AIR VALVE. THE AIR VALVE MAY BE DAMAGED IF THE NEEDLE IS INSERTED DRY.

UPGRADE KIT AVAILABLE: THE 03-04 SCHRADER VALVE/ALUMINUM TOP CAP ASSEMBLY IS COMPATIBLE WITH THE 2002 JUDY XC/SL. AVAILABLE KITS ARE: 11.4306.446.000 (SILVER TOP CAP) AND 11.4306.446.001 (BLACK TOP CAP)

2. Using a 24mm socket wrench, remove the top caps (part numbers: 11.4306.206.000 for non-adjust and 11.4306.446.000 or 11.4306.446.001 for air assist side).

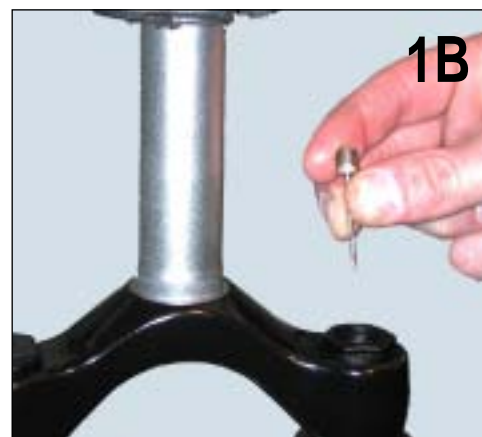

3. Remove the spring guide and coil spring from the left side of the fork (coil spring/spacer kit 11.4306.208.000).



LOWER LEG REMOVAL

4. **Judy SL Only:** Gently pull downward to remove the rebound adjuster knob from the right shaft bolt (external rebound adjuster knob kit 11.4304.960.000).
5. Loosen shaft bolts five turns (fig. 5A) and tap firmly with a plastic faced mallet to separate the shafts from the lower tubes (fig. 5B). Keep a bucket nearby to catch the oil. Inspect the condition of removed oil. If the oil is opaque and/or milky (water contamination), the lower tube assembly should be cleaned. Remove the shaft bolts completely.



6. Carefully slide the lower tube assembly off of the upper tubes.
7. Use a biodegradable solvent (Simple Green, Pedros, or equivalent) and a 12" long, 1 1/4" diameter soft bristle bottle brush to clean the lower tube internals. Dry thoroughly.



REMOVAL OF DAMPER AND PLUNGER SHAFT

8. Using a long cylindrical rod, push the air assist plunger until the lower spring guide protrudes from the crown (Air Assist Plunger Assembly Kit 11.4306.207.000). Unthread the spring guide/plunger assembly until the rubber u-cup has passed the top cap threads.

NOTE: YOU WILL NEED TO REPLACE THE U-CUP WITH THE IMPROVED O-RING AIR SEAL UPON REINSTALLATION (11.4307.208.010).

9. Using the long cylindrical rod, push the damper assembly through and out the top of the upper tubes.

NOTE: USE CARE NOT TO DAMAGE THE PISTON GLIDE RING!



ALL TRAVEL SPACER CONFIGURATION

10. Note the all travel spacer on the plunger and damper assembly. For 100 mm of travel, remove the all travel spacer from the damper shaft. Move the all travel spacer on the plunger assembly so that it sits between the spring and the plunger (see fig. 10).

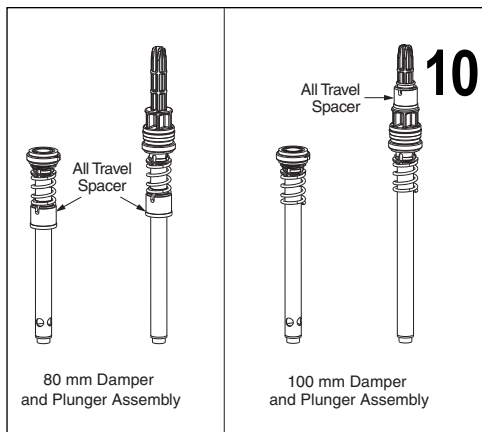

DAMPER AND PLUNGER SHAFT INSTALLATION

11. Do not confuse the damper assembly with the air assist plunger assembly. The damper assembly can be easily identified by the series of washers below the piston.

12. Install the damper assembly (right leg) and plunger assembly (left leg) through the top of the upper tubes.

IMPORTANT: BEFORE INSTALLING THE PLUNGER ASSEMBLY, YOU MUST REPLACE THE U-CUP. DO NOT DAMAGE THE U-CUP SEAL ON THE THREADS OF THE UPPER TUBE.

13. Reinstall the spring (with spring guide) into the left side. Install the air assist and non-adjust top caps lightly by hand.

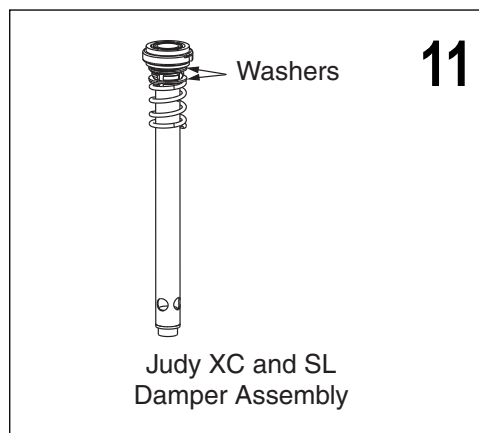

LOWER TUBE INSTALLATION

14. Slide the lower tube assembly onto the upper tube assembly until just before the lower bushing engages with the upper tube.

IMPORTANT: ENSURE THE GREY DUST SEALS ARE PROPERLY SEATED IN THE LOWER LEGS.



REFILL FLUIDS

15. Invert the fork and fill the left leg with 30 cc RockShox 10 wt. oil. Use 5 wt. oil for faster rebound or 15 wt. for slower rebound).

TUNING TIP: YOU CAN USE A LIGHTER OR HEAVIER WEIGHT OIL TO ADJUST THE AMOUNT OF DAMPING.

16. Slide the lower tubes completely onto the upper tubes until the shaft fully engages the lower tubes.

17. Inspect the nylon crush washers for wear or damage and replace if necessary.

18. **Judy SL:** BEFORE installing the rebound adjuster knob into the hollow shaft bolt, insert the knob into the damper and turn the rebound valve to the full clockwise position. Then remove the knob. **THIS PREVENTS DAMAGE TO THE PLASTIC REBOUND ASSEMBLY IN THE SHAFT.**



19. Using the spring to hold the plunger and damper shafts in place, install lower shaft bolts and torque to 60 in-lb.

Judy SL: Firmly press the rebound adjuster knob into the right hollow shaft bolt.



20. Turn the fork right-side up. Extend the fork and fill the right upper tube (fig. 20A) with 160 cc RockShox 10 wt. oil (5 or 15 wt. optional). Then pour 10 cc 10 wt. oil into the left upper tube (fig. 20B). Cycle the fork to circulate the oil through the damper.

TUNING TIP: YOU CAN USE A LIGHTER OR HEAVIER WEIGHT OIL TO ADJUST THE AMOUNT OF DAMPING.



COIL SPRING AND TOP CAP INSTALLATION

21. Reinstall the top caps using a 24 mm socket wrench. Torque the top caps to 40 in-lb.

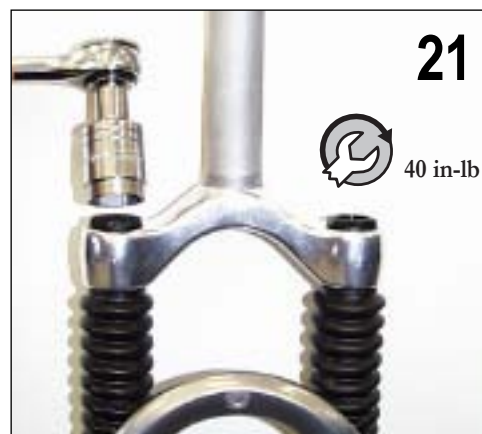

AIR PRESSURE

22. **Rubber Air Valve:** Lubricate football needle and insert pump into rubber air valve. Add the recommended air pressure (see Air Pressure Guidelines"). Carefully remove the football needle and re-install the air cap.

Schrader Valve: Thread pump valve onto schrader valve and add the recommended air pressure.

AIR PRESSURE GUIDELINES

<u>Rider Weight (lb)</u>	<u>Air Pressure</u>
--------------------------	---------------------

<140 (63 kg)	—
140-160 (63-72 kg)	0-5 psi
160-180 (72-81 kg)	5-10 psi
180-200 (81-90 kg)	10-15 psi
>220 (99 kg)	15-20 psi

