



HB-M800A

Front hub

General Safety Information

WARNING

- **Off-road bicycle riding and extreme mountain bike riding, represented in part by North Shore style riding, "trials riding", or urban stunt riding is an inherently dangerous activity. There is a risk of being involved in an accident that can result in a serious injury or even death. It is strongly recommended that riders wear protective head and body gear and perform thorough safety checks of their bicycles before riding. Please remember that you are riding at your own risk and that you have to consider your experience and your skills very carefully.**
- The HB-M800A front hub are designed for off-road bicycle riding and extreme mountain bike riding, that are represented in part by North Shore style riding, "trials riding", or urban stunt riding. However, depending on the riding condition, The hub axle could develop a crack, which may result in failure of the hub axle. This can lead to an accident that could result in serious injury or even death.
Before riding, you should carefully check your hubs to make sure that there are no cracks in the axles, and if you find any sign of a crack or any other unusual condition, do NOT use the bicycle.
- The securing method and tightening torque for the front wheel both vary depending on the type of front suspension fork being used. When installing the front wheel to the front suspension fork, always be sure to follow the directions given in the Service Instructions for the front suspension fork. If the directions are not followed, the front wheel may fall out of the front suspension fork and serious injury may result. If the front wheel is tightened onto the front suspension fork in accordance with the tightening torque given in the Service Instructions for the front suspension fork, the front wheel may turn more stiffly, but the directions given in the Service Instructions must always be followed.
- Check that the wheels are fastened securely before riding the bicycle. If the wheels are loose in any way, they may come off the bicycle and serious injury may result.
- Obtain and read the service instructions carefully prior to installing the parts. Loose, worn, or damaged parts may cause injury to the rider. We strongly recommend only using genuine Shimano replacement parts.
- Read these Technical Service Instructions carefully, and keep them in a safe place for later reference.

Note

- Use the TL-HB80 when attaching the HB-M800A front hub to the wheel truing tool.
- If the wheel becomes stiff and difficult to turn, you should lubricate it with grease.
- Do not apply any lubricant to the inside of the hub, otherwise the grease will come out.
- You should periodically wash the sprockets in a neutral detergent and then lubricate them again. In addition, cleaning the chain with neutral detergent and lubricating it can be a effective way of extending the useful life of the sprockets and the chain.
- If the chain keeps coming off the sprockets during use, replace the sprockets and the chain.
- This product is not warranted against damage resulting from use such as jumping while riding or if the bicycle falls over, except if such malfunctions result from non conforming materials or manufacturing methods.
- Parts are not guaranteed against natural wear or deterioration resulting from normal use.
- For maximum performance we highly recommend Shimano lubricants and maintenance products.

In order to realize the best performance, we recommend that the following combination be used.

| | |
|----------------------|-------------------|
| Series | SAINT |
| DUAL CONTROL lever | ST-M965 / ST-M765 |
| Outer casing | SIS-SP41 |
| Rear derailleur | RD-M800 |
| Type | SGS / GS / SS |
| Freehub | FH-M800 |
| Front hub | HB-M800A |
| Gears | 9 |
| Cassette sprocket | CS-M960 |
| Chain | CN-HG93 |
| Bottom bracket guide | SM-SP17 / SM-BT17 |

Specifications

Front hub

| | |
|--------------------|----------|
| Model No. | HB-M800A |
| No. of spoke holes | 36 / 32 |

Wheel spoke lacing

Check that the spokes have been laced as shown in the illustration.
A radial assembly cannot be used.

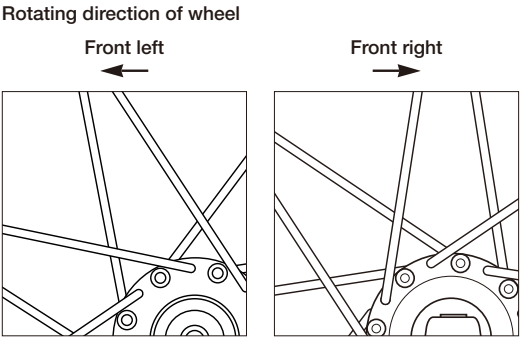

Installation of the rotor

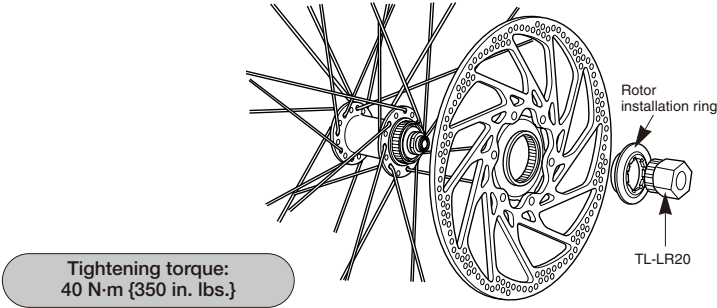

Maintenance

These units can be disassembled as shown in the illustrations. Grease should be applied to each part at periodic intervals.

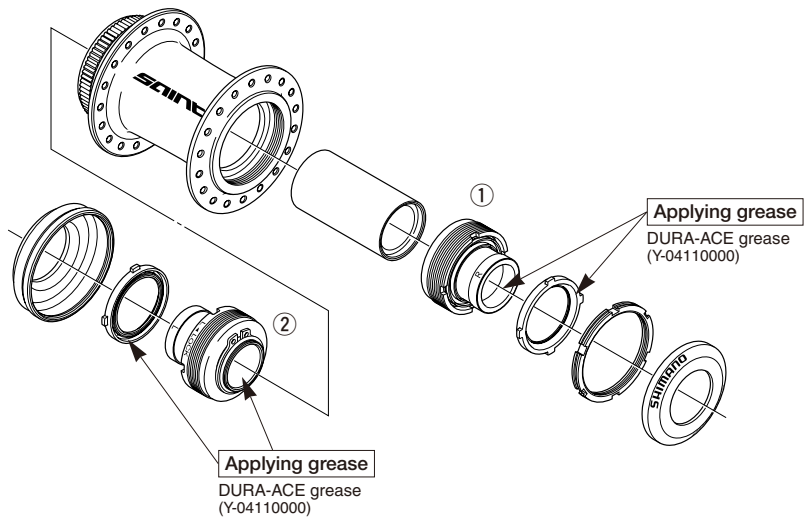

| Part name | Thread type | Special tool |
|-----------------------|-------------------|--------------|
| ① Right hand cup unit | Right hand thread | TL-HA20 |
| ② Left hand cup unit | Left hand thread | TL-HA20 |

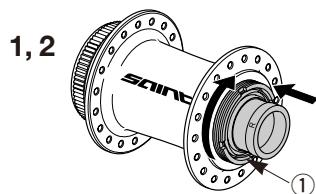

<Assembly>

1. Install ②.

Tightening torque:
40 - 50 N·m {350 - 435 in. lbs.}

2. Tighten ① as far as it goes.

3. Set the TL-HB80.

4. Return ① until the play in the axle is eliminated.

5. Tighten the lock nut to double lock ① using the TL-HA20 and TL-FC31 special tools.

Tightening torque:
49 - 54 N·m {428 - 470 in. lbs.}

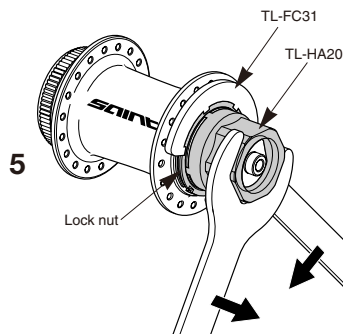
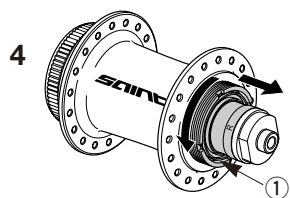
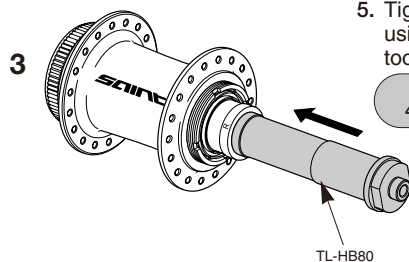

SHIMANO

SHIMANO AMERICAN CORPORATION
One Holland, Irvine, California 92618, U.S.A. Phone: +1-949-951-5003

SHIMANO EUROPE HOLDING B.V.
Industrieweg 24, 8071 CT Nunspeet, The Netherlands Phone: +31-341-272222

SHIMANO INC.
3-77 Oimatsu-cho, Sakai, Osaka 590-8577, Japan

Please note: specifications are subject to change for improvement without notice. (English)
© Apr. 2004 by Shimano Inc. XBC SZK Printed in Japan

